

# SMH CONSULTANTS

November 10, 2022

SCS Engineers  
Leah Meyer  
6161 S. Syracuse Way, Suite 210  
Greenwood Village, Colorado 80111

RE: Project No. 2211-0446

Leah,

The following is the information requested on a Monitoring Well Site, Former Bodens 66 Service, Attica, Harper County, Kansas.

Point	North Coord.	East Coord.	Distance SE Cor. North	From S.19 West	Elev. Top Of Rim or PK Nail	Elev. Top of PVC Pipe	Latitude North	Longitude West
SE Corner S.19-T32S-R8W	40000	40000						
MW14	40909.93	38381.88	909.93	1618.12	1460.91	1460.56	37.24211	98.22596
MW15	40698.70	38411.47	698.70	1588.53	1459.61	1459.25	37.24153	98.22585
MW16	40693.17	38603.86	693.17	1396.14	1461.64	1461.23	37.24152	98.22518
MW17	40957.47	38510.16	957.47	1489.84	1463.69	1463.21	37.24225	98.22552
Site BM	41098.95	38936.52	1098.95	1063.48		SBM Elevation = 1472.88		

Description: "□" Square cut on East edge of sidewalk 43 feet North of Highway 160 and 41 feet East of Logan Street.

MW14, MW15, MW16 and MW17 are in the: SE¼ NE¼ SW¼ SE¼ S.19-T32S-R8W

If you have any questions, please do not hesitate in giving us a call.

Sincerely,

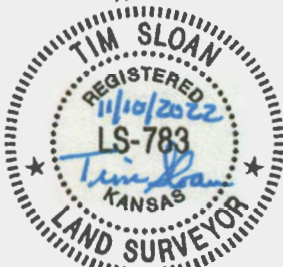

Tim Sloan, L.S.  
SMH CONSULTANTS



- LEGEND:**
- PROPOSED MONITORING WELL
  - EXISTING MONITORING WELL
  - ABANDONED MONITORING WELL
  - - - SUBJECT SITE BOUNDARY
  - - - PROPERTY LINE/OWNERS
  - FORMER UST BASH/PUMP ISLANDS
  - - - OVERHEAD ELECTRIC/TELEPHONE LINE
  - - - GAS LINE (APPROX. 1.5-3")
  - - - SANITARY SEWER LINE (APPROX. 2-8')
  - - - STORM SEWER LINE (APPROX. 2 TO 6')
  - - - FIBER OPTICS LINE (APPROX. 1.5 TO 3')
  - - - WATER LINE (APPROX. 2-8')
  - - - GROUNDWATER FLOW DIRECTION
  - CNL COULD NOT LOCATE
  - ND NOT DETECTED ABOVE LABORATORY REPORTING LIMITS
  - 70 CONCENTRATION IN UG/L
  - - - ISOCONCENTRATION LINE
- WELLS SAMPLED ON APRIL 20, 2022

- NOTES:**
- PROPOSED WELL LOCATIONS DEPENDENT UPON UNMARKED UTILITIES AND ACCESS.
  - MW-17 TO BE INSTALLED ONLY IF MW-11 CANNOT BE LOCATED.

REV	DATE	BY	DESC
05			
04			
03			
02			
01			
00			

**SCS ENGINEERS**  
 8575 West 110th Street, Suite 100  
 Overland Park, Kansas 66210

PROJECT NAME: FORMER BODENS 66 SERVICE (U2-039-00767)  
 201 AVENUE C  
 ATTIKA, KANSAS

DATE: 6/4/2022

PROJECT NUMBER: 27222102.00

SCALE: 6.1

PROPOSED MONITORING WELL LOCATIONS



WATER WELL RECORD Form WWC-5

Division of Water Resources App. No.

MW-16

Original Record Correction Change in Well Use

Well ID

1 LOCATION OF WATER WELL: County: Harper Fraction SE 1/4 NE 1/4 SW 1/4 SE 1/4 Section Number 19 Township Number T 32 S Range Number R 8 E W

2 WELL OWNER: Last Name: KDHE Business: KDHE Address: 1000 SW Jackson St., Suite 420 City: Topeka State: KS ZIP: 66612-1367 Street or Rural Address where well is located (if unknown, distance and direction from nearest town or intersection): Approximately 150' W & 150' S of SW corner of intersection of East Avenue C & North Blaine Street, Attica, Ks.

3 LOCATE WELL WITH "X" IN SECTION BOX: N W E S 1 mile

4 DEPTH OF COMPLETED WELL: 19.5 ft. Depth(s) Groundwater Encountered: 1) 19.5 ft. 2) ft. 3) ft. or 4) Dry Well WELL'S STATIC WATER LEVEL: 1.73 ft. below land surface, measured on (mo-day-yr) 10-25-2022

5 Latitude: 37.24152 (decimal degrees) Longitude: 98.22518 (decimal degrees) Horizontal Datum: WGS 84 NAD 83 NAD 27 Source for Latitude/Longitude: GPS (unit make/model) (WAAS enabled? Yes No) Land Survey Topographic Map Online Mapper

6 Elevation: 1461.23 ft. Ground Level TOC Source: Land Survey GPS Topographic Map Other

7 WELL WATER TO BE USED AS: 1. Domestic: Household Lawn & Garden Livestock Irrigation Feedlot Industrial 5. Public Water Supply: well ID 6. Dewatering: how many wells? 7. Aquifer Recharge: well ID 8. Monitoring: well ID MW-16 9. Environmental Remediation: well ID Air Sparge Soil Vapor Extraction Recovery Injection 10. Oil Field Water Supply: lease 11. Test Hole: well ID Cased Uncased Geotechnical 12. Geothermal: how many bores? a) Closed Loop Horizontal Vertical b) Open Loop Surface Discharge Inj. of Water 13. Other (specify):

Was a chemical/bacteriological sample submitted to KDHE? Yes No If yes, date sample was submitted: Water well disinfected? Yes No

8 TYPE OF CASING USED: Steel PVC Other CASING JOINTS: Glued Clamped Welded Threaded Casing diameter 2 in. to 9.5 ft., Diameter in. to ft., Diameter in. to ft. Casing height above land surface 0 in. Weight lbs./ft. Wall thickness or gauge No. sch 40

TYPE OF SCREEN OR PERFORATION MATERIAL: Steel Stainless Steel Fiberglass PVC Other (Specify) Brass Galvanized Steel Concrete tile None used (open hole)

SCREEN OR PERFORATION OPENINGS ARE: Continuous Slot Mill Slot Gauze Wrapped Torch Cut Drilled Holes Other (Specify) Louvered Shutter Key Punched Wire Wrapped Saw Cut None (Open Hole)

SCREEN-PERFORATED INTERVALS: From 9.5 ft. to 19.5 ft., From ft. to ft., From ft. to ft. GRAVEL PACK INTERVALS: From 7.5 ft. to 19.5 ft., From ft. to ft., From ft. to ft.

9 GROUT MATERIAL: Neat cement Cement grout Bentonite Other cement pad Grout Intervals: From 1 ft. to 7.5 ft., From 0 ft. to 1 ft., From ft. to ft.

Nearest source of possible contamination: Septic Tank Lateral Lines Pit Privy Livestock Pens Insecticide Storage Sewer Lines Cess Pool Sewage Lagoon Fuel Storage Abandoned Water Well Watertight Sewer Lines Seepage Pit Feedyard Fertilizer Storage Oil Well/Gas Well Other (Specify) Direction from well? northeast Distance from well? 150 ft.

Table with 6 columns: FROM, TO, LITHOLOGIC LOG, FROM, TO, LITHO. LOG (cont.) or PLUGGING INTERVALS. Rows: 0-1 Brown soil, 1-7 Silty Clay, light brown, dry, 7-15.5 Sandy Clay, brown, soft, damp, 15.5-19.5 Sand, tan to brown, fine, damp

Notes:

11 CONTRACTOR'S OR LANDOWNER'S CERTIFICATION: This water well was constructed, reconstructed, or plugged under my jurisdiction and was completed on (mo-day-year) 10-17-2022... and this record is true to the best of my knowledge and belief. Kansas Water Well Contractor's License No. 604 This Water Well Record was completed on (mo-day-year) 11/15/22 under the business name of Environmental Priority Service, Inc. Signature [Signature]