

SMH CONSULTANTS

November 10, 2022

SCS Engineers
Leah Meyer
6161 S. Syracuse Way, Suite 210
Greenwood Village, Colorado 80111

RE: Project No. 2211-0446

Leah,

The following is the information requested on a Monitoring Well Site, Former Bodens 66 Service, Attica, Harper County, Kansas.

Point	North Coord.	East Coord.	Distance SE Cor. North	From S.19 West	Elev. Top Of Rim or PK Nail	Elev. Top of PVC Pipe	Latitude North	Longitude West
SE Corner S.19-T32S-R8W	40000	40000						
MW14	40909.93	38381.88	909.93	1618.12	1460.91	1460.56	37.24211	98.22596
MW15	40698.70	38411.47	698.70	1588.53	1459.61	1459.25	37.24153	98.22585
MW16	40693.17	38603.86	693.17	1396.14	1461.64	1461.23	37.24152	98.22518
MW17	40957.47	38510.16	957.47	1489.84	1463.69	1463.21	37.24225	98.22552
Site BM	41098.95	38936.52	1098.95	1063.48		SBM Elevation = 1472.88		

Description: "□" Square cut on East edge of sidewalk 43 feet North of Highway 160 and 41 feet East of Logan Street.

MW14, MW15, MW16 and MW17 are in the: SE¼ NE¼ SW¼ SE¼ S.19-T32S-R8W

If you have any questions, please do not hesitate in giving us a call.

Sincerely,

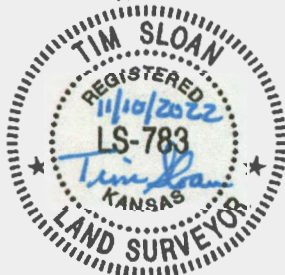

Tim Sloan, L.S.
SMH CONSULTANTS



- LEGEND:**
- PROPOSED MONITORING WELL
 - EXISTING MONITORING WELL
 - ABANDONED MONITORING WELL
 - - - SUBJECT SITE BOUNDARY
 - - - PROPERTY LINE/OWNERS
 - - - FORMER LUST BASIN/PUMP ISLANDS
 - - - OVERHEAD ELECTRIC/TELEPHONE LINE
 - - - GAS LINE (APPROX. 1.5-3')
 - - - SANITARY SEWER LINE (APPROX. 2-6')
 - - - STORM SEWER LINE (APPROX. 2 TO 6')
 - - - FIBER OPTICS LINE (APPROX. 1.5 TO 3')
 - - - WATER LINE (APPROX. 2-6')
 - - - GROUNDWATER FLOW DIRECTION
 - CNL COULD NOT LOCATE
 - ND NOT DETECTED ABOVE LABORATORY REPORTING LIMITS
 - 78 CONCENTRATION IN UG/L
 - - - ISOCONCENTRATION LINE
- WELLS SAMPLED ON APRIL 29, 2022

NOTES:

1. PROPOSED WELL LOCATIONS DEPEND UPON UNMARKED UTILITIES AND ACCESS.
2. MW-17 TO BE INSTALLED ONLY IF MW-11 CANNOT BE LOCATED.



REV.	DATE	BY	DESCRIPTION
1	5/2/2022	SCS	ISSUE FOR PERMIT
2	5/2/2022	SCS	REVISED PER COMMENTS
3	5/2/2022	SCS	REVISED PER COMMENTS
4	5/2/2022	SCS	REVISED PER COMMENTS
5	5/2/2022	SCS	REVISED PER COMMENTS
6	5/2/2022	SCS	REVISED PER COMMENTS
7	5/2/2022	SCS	REVISED PER COMMENTS
8	5/2/2022	SCS	REVISED PER COMMENTS
9	5/2/2022	SCS	REVISED PER COMMENTS
10	5/2/2022	SCS	REVISED PER COMMENTS

SCS ENGINEERS	
8575 West 110th Street, Suite 100 Overland Park, Kansas 66210	
PROJECT NAME	FORMER BODENS 66 SERVICE (U2-039-00767) 201 AVENUE C ATTIKA, KANSAS
PROJECT NUMBER	27222102.00
DATE	5/2/2022
SCALE	AS SHOWN
PROJECT NUMBER	27222102.00
DATE	5/2/2022
SCALE	AS SHOWN

WATER WELL RECORD Form WWC-5

Division of Water Resources App. No.

Well ID MW-17

Original Record Correction Change in Well Use

1 LOCATION OF WATER WELL: County: Harper	Fraction SE ¼ NE ¼ SW ¼ SE ¼	Section Number 19	Township Number T 32 S	Range Number R 8 <input type="checkbox"/> E <input checked="" type="checkbox"/> W
---	---------------------------------	-----------------------------	----------------------------------	---

2 WELL OWNER: Last Name: First: Business: KDHE Address: 1000 SW Jackson St., Suite 420 Address: City: Topeka State: KS ZIP: 66612-1367	Street or Rural Address where well is located (if unknown, distance and direction from nearest town or intersection): If at owner's address, check here: <input type="checkbox"/> NW corner of intersection of East Avenue C & North Blaine Street, Attica, Ks.
---	---

3 LOCATE WELL WITH "X" IN SECTION BOX:
N

NW	NE
SW	SE

S

-----1 mile-----

4 DEPTH OF COMPLETED WELL:**15**..... ft.
Depth(s) Groundwater Encountered: 1) ft.
2) ft. 3) ft., or 4) Dry Well
WELL'S STATIC WATER LEVEL:**8.88**..... ft.
 below land surface, measured on (mo-day-yr) **10-25-2022**
 above land surface, measured on (mo-day-yr).....
Pump test data: Well water was ft.
after..... hours pumping gpm
Well water was ft.
after..... hours pumping gpm
Estimated Yield: gpm
Bore Hole Diameter: **8.75** in. to **15** ft. and
..... in. to ft.

5 Latitude:**37.24225**.....(decimal degrees)
Longitude:**98.22552**.....(decimal degrees)
Horizontal Datum: WGS 84 NAD 83 NAD 27
Source for Latitude/Longitude:
 GPS (unit make/model:)
(WAAS enabled? Yes No)
 Land Survey Topographic Map
 Online Mapper:

6 Elevation: **1461.21**.....ft. Ground Level TOC
Source: Land Survey GPS Topographic Map
 Other

7 WELL WATER TO BE USED AS:

1. Domestic: <input type="checkbox"/> Household <input type="checkbox"/> Lawn & Garden <input type="checkbox"/> Livestock	5. <input type="checkbox"/> Public Water Supply: well ID	10. <input type="checkbox"/> Oil Field Water Supply: lease
2. <input type="checkbox"/> Irrigation	6. <input type="checkbox"/> Dewatering: how many wells?	11. Test Hole: well ID
3. <input type="checkbox"/> Feedlot	7. <input type="checkbox"/> Aquifer Recharge: well ID	<input type="checkbox"/> Cased <input type="checkbox"/> Uncased <input type="checkbox"/> Geotechnical
4. <input type="checkbox"/> Industrial	8. <input checked="" type="checkbox"/> Monitoring: well ID MW-17	12. Geothermal: how many bores?
	9. Environmental Remediation: well ID	a) Closed Loop <input type="checkbox"/> Horizontal <input type="checkbox"/> Vertical
	<input type="checkbox"/> Air Sparge <input type="checkbox"/> Soil Vapor Extraction	b) Open Loop <input type="checkbox"/> Surface Discharge <input type="checkbox"/> Inj. of Water
	<input type="checkbox"/> Recovery <input type="checkbox"/> Injection	13. <input type="checkbox"/> Other (specify):

Was a chemical/bacteriological sample submitted to KDHE? Yes No If yes, date sample was submitted:

Water well disinfected? Yes No

8 TYPE OF CASING USED: Steel PVC Other CASING JOINTS: Glued Clamped Welded Threaded
Casing diameter**2**..... in. to**5**..... ft., Diameter in. to ft., Diameter in. to ft.
Casing height above land surface**0**..... in. Weight lbs./ft. Wall thickness or gauge No. **sch 40**.....

TYPE OF SCREEN OR PERFORATION MATERIAL:
 Steel Stainless Steel Fiberglass PVC Other (Specify)

Brass Galvanized Steel Concrete tile None used (open hole)

SCREEN OR PERFORATION OPENINGS ARE:
 Continuous Slot Mill Slot Gauze Wrapped Torch Cut Drilled Holes Other (Specify)

Louvered Shutter Key Punched Wire Wrapped Saw Cut None (Open Hole)

SCREEN-PERFORATED INTERVALS: From **5**..... ft. to **15**..... ft., From ft. to ft., From ft. to ft.

GRAVEL PACK INTERVALS: From **3**..... ft. to **15**..... ft., From ft. to ft., From ft. to ft.

9 GROUT MATERIAL: Neat cement Cement grout Bentonite Other **cement pad**.....
Grout Intervals: From **1**..... ft. to **3**..... ft., From **0**..... ft. to **1**..... ft., From ft. to ft.

Nearest source of possible contamination:
 Septic Tank Lateral Lines Pit Privy Livestock Pens Insecticide Storage
 Sewer Lines Cess Pool Sewage Lagoon Fuel Storage Abandoned Water Well
 Watertight Sewer Lines Seepage Pit Feedyard Fertilizer Storage Oil Well/Gas Well
 Other (Specify)

Direction from well? **east**..... Distance from well? **50**..... ft.

10 FROM	TO	LITHOLOGIC LOG	FROM	TO	LITHO. LOG (cont.) or PLUGGING INTERVALS
0	1	Brown soil			
1	7	Sandy Clay, red brown, dry			
7	12	Silty Clay, red, damp			
12	15	Clay, red brown, damp			

Notes:

11 CONTRACTOR'S OR LANDOWNER'S CERTIFICATION: This water well was constructed, reconstructed, or plugged under my jurisdiction and was completed on (mo-day-year) **10-17-2022**... and this record is true to the best of my knowledge and belief. Kansas Water Well Contractor's License No. **604**..... This Water Well Record was completed on (mo-day-year) **10/15/22**..... under the business name of **Environmental Priority Service, Inc.** Signature **Pat [Signature]**.....