

SMH CONSULTANTS

November 10, 2022

SCS Engineers
Leah Meyer
6161 S. Syracuse Way, Suite 210
Greenwood Village, Colorado 80111

RE: Project No. 2211-0447

Leah,

The following is the information requested on a Monitoring Well Site, Wright-Price #1, Attica, Harper County, Kansas.

Point	North Coord.	East Coord.	Distance SE Cor. North	From S.30 West	Elev. Top Of Rim or PK Nail	Elev. Top of PVC Pipe	Latitude North	Longitude West
SE Corner S.30-T32S-R8W	40000	40000						
MW17	45016.27	38716.86	5016.27	1283.14	1453.59	1453.08	37.23868	98.22497
MW18	44941.80	38904.98	4941.80	1095.02	1453.94	1453.40	37.23847	98.22433
MW19	44855.90	38864.63	4855.90	1135.37	1451.54	1451.19	37.23824	98.22447
MW20	44594.38	38738.26	4594.38	1261.74	1451.56	1451.13	37.23752	98.22492
MW21	44581.88	38626.61	4581.88	1373.39	1451.27	1450.82	37.23749	98.22530
MW22	44611.54	38515.77	4611.54	1484.23	1450.33	1449.89	37.23758	98.22568
Site BM	45168.34	38537.43	5168.34	1462.57		SBM Elevation = 1454.17		

Description: "X" cut on north bolt on top of fire hydrant on East side of property.

MW17 is in the:	NW¼	NW¼	NE¼	NE¼	S.30-T32S-R8W
MW18 and MW19 are in the:	SW¼	NW¼	NE¼	NE¼	S.30-T32S-R8W
MW20 is in the:	NW¼	SW¼	NE¼	NE¼	S.30-T32S-R8W
MW21 and MW22 are in the:	NE¼	SE¼	NW¼	NE¼	S.30-T32S-R8W

If you have any questions, please do not hesitate in giving us a call.

Sincerely,

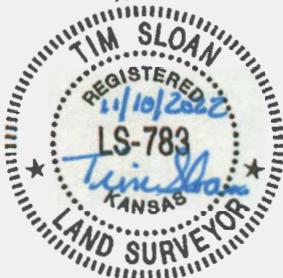

Tim Sloan, L.S.
SMH CONSULTANTS

COLORADO SPRINGS
411 South Tejon Street, Suite 100
Colorado Springs, CO 80903
P: 719-465-2145

DODGE CITY
707 3rd Avenue, Suite A
Dodge City, KS 67801
P: 620-255-1952

MANHATTAN - HQ
2017 Vanesta Place, Suite 110
Manhattan, KS 66503
P: 785-776-0541

KANSAS CITY
5201 Johnson Drive, Suite 405
Mission, KS 66205
P: 913-444-9615

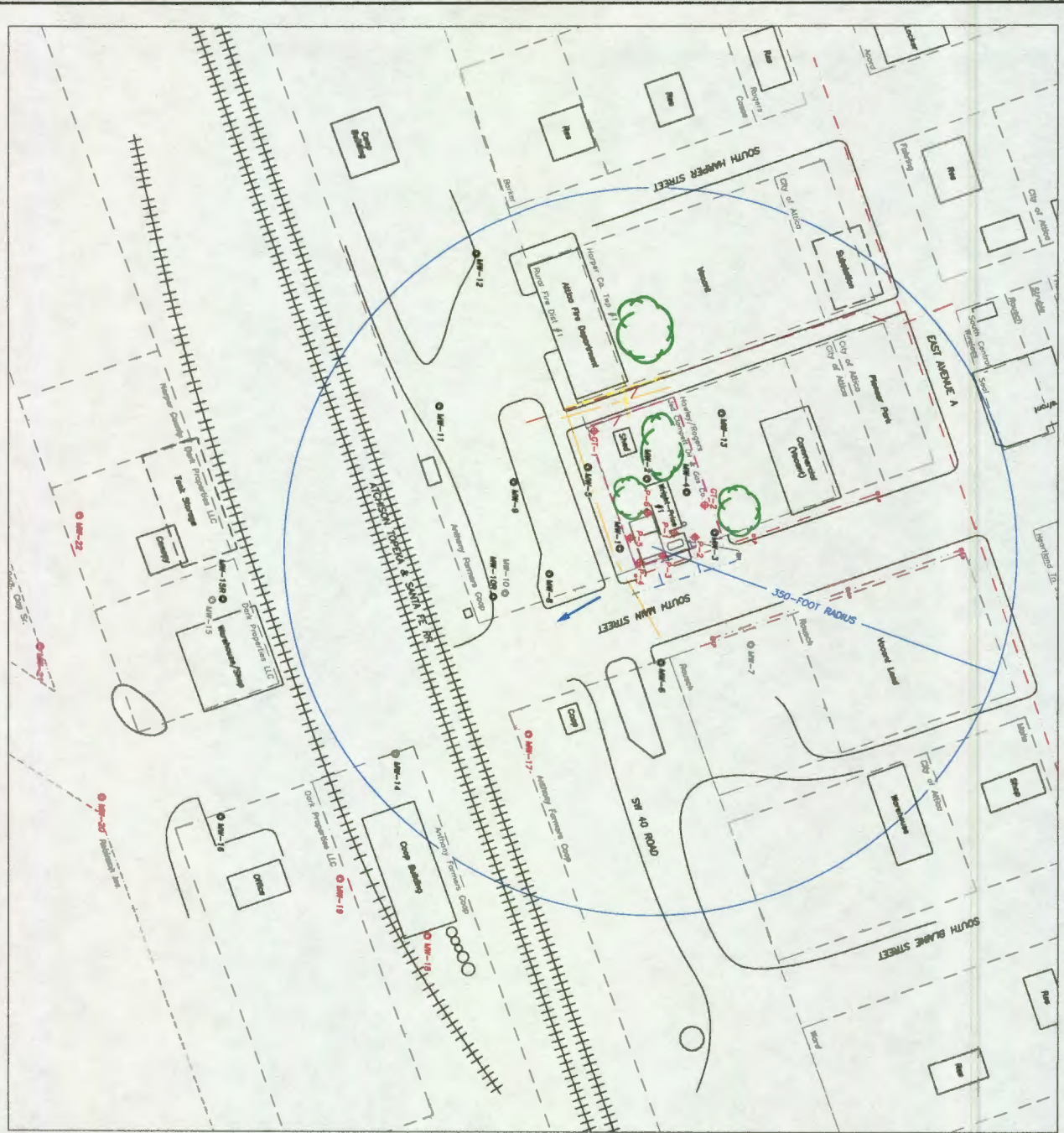

- LEGEND:**
- ◆ RQBA SOIL BORING
 - NEW MONITORING WELL
 - EXISTING MONITORING WELL
 - ABANDONED MONITORING WELL
 - SUBJECT SITE BOUNDARY
 - PROPERTY LINE/OWNERS
 - UST BASIN/PUMP ISLANDS
 - OVERHEAD ELECTRIC/TWIDPOLE LINE
 - SANITARY SEWER LINE (APPROX. 1.5-3')
 - STORM SEWER LINE (APPROX. 2-6')
 - FIBER OPTICS LINE (APPROX. 2 TO 6')
 - WATER LINE (APPROX. 1.5 TO 3')
 - GROUNDWATER FLOW DIRECTION
- NOTES:**
1. THE LOCATION OF THE UST BASIN, PRODUCT LINES & PUMP ISLANDS ARE APPROXIMATE, BASED ON SITE OBSERVATIONS AND PHOTO MAPS PROVIDED BY KAMEL.
 2. UTILITY LOCATIONS AND DEPTHS ARE APPROXIMATE, BASED ON PHOTO MAPS PROVIDED BY KAMEL.
 3. UTMED SITE OBSERVATIONS AND PHOTO MAPS PROVIDED BY KAMEL.



FIGURE 2.1 - AREA BASE MAP (350-FOOT RADIUS)

DRAWN BY: LAM CHECKED BY: WRIGHT PRICE #1 DATE: 11/2/2022	DESIGNED BY: LAM PROJECT NAME: SLM DATE: 11/2/2022	SCS ENGINEERS 8575 West 110th Street, Suite 100 Overland Park, Kansas 66210	<table border="1"> <tr><td>RS</td><td>5BY</td></tr> <tr><td>R4</td><td>4BY</td></tr> <tr><td>R3</td><td>3BY</td></tr> <tr><td>R2</td><td>2BY</td></tr> <tr><td>R1</td><td>1BY</td></tr> <tr><td>RO</td><td>0BY</td></tr> <tr><td>REV</td><td>DATE</td><td>BY</td><td>DESCRIPTION</td></tr> </table>	RS	5BY	R4	4BY	R3	3BY	R2	2BY	R1	1BY	RO	0BY	REV	DATE	BY	DESCRIPTION
RS	5BY																		
R4	4BY																		
R3	3BY																		
R2	2BY																		
R1	1BY																		
RO	0BY																		
REV	DATE	BY	DESCRIPTION																
DWG NO: 0 DRAWING NUMBER: 2.1 PROJECT NUMBER: 27222103.00	CLIENT: WRIGHT PRICE #1 PROJECT: SLM																		

WATER WELL RECORD Form WWC-5

Division of Water Resources App. No.

MW-22

Original Record Correction Change in Well Use

Well ID

1 LOCATION OF WATER WELL: County: Harper Fraction NE 1/4 SE 1/4 NW 1/4 NE 1/4 Section Number 30 Township Number T 32 S Range Number R 8 E W

2 WELL OWNER: Last Name: KDHE Business: KDHE Address: 1000 SW Jackson St., Suite 420 City: Topeka State: KS ZIP: 66612-1367 Street or Rural Address where well is located (if unknown, distance and direction from nearest town or intersection): Approximately 250 ft. W. of the NW corner of the intersection of S. Main Street & Attica Road, Attica, Ks.

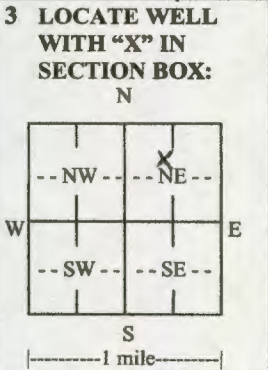

3 LOCATE WELL WITH 'X' IN SECTION BOX: N, S, E, W, 1 mile scale. 4 DEPTH OF COMPLETED WELL: 13.5 ft. Depth(s) Groundwater Encountered: 1) 13.5 ft. 2) ... ft. 3) ... ft., or 4) Dry Well. WELL'S STATIC WATER LEVEL: 10.75 ft. below land surface, measured on (mo-day-yr) 10-26-2022. Pump test data: Well water was ... ft. after ... hours pumping ... gpm. Estimated Yield: ... gpm. Bore Hole Diameter: 8.75 in. to 13.5 ft. and ... in. to ... ft.

5 Latitude: 37.23758 (decimal degrees) Longitude: 98.22568 (decimal degrees) Horizontal Datum: WGS 84 NAD 83 NAD 27 Source for Latitude/Longitude: GPS (unit make/model: ... (WAAS enabled? Yes No) Land Survey Topographic Map Online Mapper. 6 Elevation: 1449.89 ft. Ground Level TOC Source: Land Survey GPS Topographic Map Other

7 WELL WATER TO BE USED AS: 1. Domestic: Household Lawn & Garden Livestock Irrigation Feedlot Industrial. 2. Public Water Supply: well ID. 3. Dewatering: how many wells? 4. Aquifer Recharge: well ID. 5. Monitoring: well ID MW-22. 6. Environmental Remediation: well ID. Air Sparge Soil Vapor Extraction Recovery Injection. 7. Oil Field Water Supply: lease. 8. Test Hole: well ID. Cased Uncased Geotechnical. 9. Geothermal: how many bores? a) Closed Loop Horizontal Vertical b) Open Loop Surface Discharge Inj. of Water. 10. Other (specify):

Was a chemical/bacteriological sample submitted to KDHE? Yes No If yes, date sample was submitted: Water well disinfected? Yes No

8 TYPE OF CASING USED: Steel PVC Other CASING JOINTS: Glued Clamped Welded Threaded. Casing diameter 2 in. to 3.5 ft., Diameter in. to ... ft., Diameter in. to ... ft. Casing height above land surface 0 in. Weight lbs./ft. Wall thickness or gauge No. sch 40.

TYPE OF SCREEN OR PERFORATION MATERIAL: Steel Stainless Steel Fiberglass PVC Other (Specify) Brass Galvanized Steel Concrete tile None used (open hole)

SCREEN OR PERFORATION OPENINGS ARE: Continuous Slot Mill Slot Gauze Wrapped Torch Cut Drilled Holes Other (Specify) Louvered Shutter Key Punched Wire Wrapped Saw Cut None (Open Hole)

SCREEN-PERFORATED INTERVALS: From 3.5 ft. to 13.5 ft., From ... ft. to ... ft., From ... ft. to ... ft. GRAVEL PACK INTERVALS: From 2.5 ft. to 13.5 ft., From ... ft. to ... ft., From ... ft. to ... ft.

9 GROUT MATERIAL: Neat cement Cement grout Bentonite Other cement pad. Grout Intervals: From 1 ft. to 2.5 ft., From 0 ft. to 1 ft., From ... ft. to ... ft.

Nearest source of possible contamination: Septic Tank Lateral Lines Pit Privy Livestock Pens Insecticide Storage Sewer Lines Cess Pool Sewage Lagoon Fuel Storage Abandoned Water Well Watertight Sewer Lines Seepage Pit Feedyard Fertilizer Storage Oil Well/Gas Well Other (Specify) Direction from well? south Distance from well? 450 ft.

Table with 6 columns: FROM, TO, LITHOLOGIC LOG, FROM, TO, LITHO. LOG (cont.) or PLUGGING INTERVALS. Rows: 0-1 Gravel & Soil, brown; 1-4 Sandy Clay, dark brown, damp; 4-9 Sand, tan-brown, fine, damp; 9-10.8 Sand, tan-brown, coarse, damp, clayey in; 10.8-13.5 Sand, tan-brown, coarse, wet.

Notes:

11 CONTRACTOR'S OR LANDOWNER'S CERTIFICATION: This water well was constructed, reconstructed, or plugged under my jurisdiction and was completed on (mo-day-year) 10-18-2022 and this record is true to the best of my knowledge and belief. Kansas Water Well Contractor's License No. 604 This Water Well Record was completed on (mo-day-year) 11/25/22 under the business name of Environmental Priority Service, Inc. Signature [Signature]