

**WATER WELL RECORD**

**Form WWC-5**

Division of Water Resources App. No.

24240

<b>1 LOCATION OF WATER WELL:</b> County: Seward	Fraction ¼ SE ¼ NE ¼ SW ¼	Section Number 23	Township No. T 33 S	Range Number R 33 <input type="checkbox"/> E <input checked="" type="checkbox"/> W
--	------------------------------	----------------------	------------------------	---

Street/Rural Address of Well Location; if unknown, distance & direction from nearest town or intersection: If at owner's address, check here .  
approx 7 miles northeast of Liberal, KS

**Global Positioning System (GPS) information:**  
 Latitude: 37.16111 (in decimal degrees)  
 Longitude: 100.87808 (in decimal degrees)  
 Elevation: 2781  
 Datum:  WGS 84,  NAD 83,  NAD 27  
 Collection Method:  
 GPS unit (Make/Model: .....)  
 Digital Map/Photo,  Topographic Map,  Land Survey  
 Est. Accuracy:  <3 m,  3-5 m,  5-15 m,  >15 m

**2 WATER WELL OWNER:** Clint Thomason  
 RR#, Street Address, Box #: PO Box 1068  
 City, State, ZIP Code : Elkhart, KS 67950

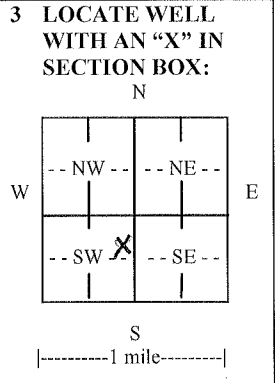

**4 DEPTH OF COMPLETED WELL** 477 ft.

Depth(s) Groundwater Encountered (1)..... ft. (2)..... ft. (3)..... ft.

WELL'S STATIC WATER LEVEL 212 ft. below land surface measured on mo/day/yr. 5/3/2011

Pump test data: Well water was 267 ft. after 4 hours pumping 136.4 gpm

EST. YIELD.....gpm. Well water was.....ft. after..... hours pumping..... gpm

Bore Hole Diameter 24 in. to 477 ft., and .....in. to .....ft.

WELL WATER TO BE USED AS:  Public water supply  Geothermal  Injection well  
 Domestic  Feedlot  Oil field water supply  Dewatering  Other (Specify below)  
 Irrigation  Industrial  Domestic-lawn & garden  Monitoring well .....

Was a chemical/bacteriological sample submitted to Department?  Yes  No

If yes, mo/day/yr sample was submitted.....

Water well disinfected?  Yes  No

**5 TYPE OF CASING USED:**  Steel  PVC  Other .....

CASING JOINTS:  Glued  Clamped  Welded  Threaded

Casing diameter 16 in. to 477 ft., Diameter ..... in. to ..... ft., Diameter ..... in. to ..... ft.

Casing height above land surface 12 in., Weight 42.09 lbs./ft., Wall thickness or gauge No. 0.250

**TYPE OF SCREEN OR PERFORATION MATERIAL:**

Steel  Stainless Steel  PVC  Other (Specify) .....

Brass  Galvanized Steel  None used (open hole)

**SCREEN OR PERFORATION OPENINGS ARE:**

Continuous slot  Mill slot  Gauze wrapped  Torch cut  Drilled holes  None (open hole)  
 Louvered shutter  Key punched  Wire wrapped  Saw cut  Other (specify) .....

**SCREEN-PERFORATED INTERVALS:** From 242 ft. to 292 ft., From 292 ft. to 472 ft. ft.

From ..... ft. to ..... ft., From ..... ft. to ..... ft.

**GRAVEL PACK INTERVALS:** From 20 ft. to 295 ft., From 295 ft. to 477 ft.

From ..... ft. to ..... ft., From ..... ft. to ..... ft.

**6 GROUT MATERIAL:**  Neat cement  Cement grout  Bentonite  Other .....

Grout Intervals: From 0 ft. to 20 ft., From ..... ft. to ..... ft., From ..... ft. to ..... ft.

What is the nearest source of possible contamination:

Septic tank  Lateral lines  Pit privy  Livestock pens  Insecticide storage  Other (specify below)  
 Sewer lines  Cesspool  Sewage lagoon  Fuel storage  Abandoned water well  
 Watertight sewer lines  Seepage pit  Feedyard  Fertilizer storage  Oil well/gas well  None Detected

Direction from well ..... Distance from well .....

FROM	TO	LITHOLOGIC LOG	FROM	TO	LITHO. LOG (cont.) or PLUGGING INTERVALS
0	2	top soil	472	477	red bed
2	45	brwn sndy clv, some fine snd beds			
45	83	brwn sndy clv, some calicho mix			
83	220	fine to med sand			
220	231	fine to small med sand			
231	239	brown sndy clay mix, fine sand beds			
239	305	fine sand some med			
305	330	fine sand			
330	350	fine sand mix with clay			
350	472	clean fine sand			

**7 CONTRACTOR'S OR LANDOWNER'S CERTIFICATION:** This water well was  constructed,  reconstructed, or  plugged under my jurisdiction and was completed on (mo/day/year) 5/14/11 and this record is true to the best of my knowledge and belief.

Kansas Water Well Contractor's License No. 145 This Water Well Record was completed on (mo/day/year) 6/9/11 under the business name of Hydro Resources by (signature) [Signature]

**INSTRUCTIONS:** Use typewriter or ball point pen. PLEASE PRESS FIRMLY and PRINT clearly. Please fill in blanks and check the correct answers. Send three copies (white, blue, pink) to Kansas Department of Health and Environment, Bureau of Water, Geology Section, 1000 SW Jackson St., Suite 420, Topeka, Kansas 66612-1367. Telephone 785-296-5522. Send one copy to WATER WELL OWNER and retain one for your records. Include fee of \$5.00 for each constructed well. Visit us at <http://www.kdheks.gov/waterwell/index.html>.