

WATER WELL RECORD Form WWC-5

Original Record Correction Change in Well Use

Division of Water Resources App. No.

Well ID MW-13

1 LOCATION OF WATER WELL: County: Stevens	Fraction NW ¼ SE ¼ NW ¼ NW ¼	Section Number 16	Township Number T 33 S	Range Number R 37 <input type="checkbox"/> E <input checked="" type="checkbox"/> W
---	---------------------------------	----------------------	---------------------------	---

2 WELL OWNER: Last Name: First: Business: Halliburton Energy Services Address: 3000 N Sam Houston Pkwy E Address: City: Houston State: TX ZIP: 77032	Street or Rural Address where well is located (if unknown, distance and direction from nearest town or intersection): If at owner's address, check here: <input type="checkbox"/> 210 S. Polk Street, Hugoton, KS 67951
---	--

3 LOCATE WELL WITH "X" IN SECTION BOX: N <table style="width: 100%; text-align: center; border-collapse: collapse;"> <tr> <td style="border: 1px solid black; width: 25px; height: 25px;"></td> <td style="border: 1px solid black; width: 25px; height: 25px;"></td> </tr> <tr> <td style="border: 1px solid black; width: 25px; height: 25px; text-align: center;">X</td> <td style="border: 1px solid black; width: 25px; height: 25px;"></td> </tr> <tr> <td style="border: 1px solid black; width: 25px; height: 25px;"></td> <td style="border: 1px solid black; width: 25px; height: 25px;"></td> </tr> </table> W E S ----- mile -----			X				4 DEPTH OF COMPLETED WELL: 195 ft. Depth(s) Groundwater Encountered: 1) ft. 2) ft. 3) ft., or 4) <input type="checkbox"/> Dry Well WELL'S STATIC WATER LEVEL: 175.98 ft. <input checked="" type="checkbox"/> below land surface, measured on (mo-day-yr) 3/27/18 <input type="checkbox"/> above land surface, measured on (mo-day-yr) Pump test data: Well water was ft. after hours pumping gpm Well water was ft. after hours pumping gpm Estimated Yield: gpm Bore Hole Diameter: 8.5 in. to 198 ft. and in. to ft.	5 Latitude: 37.18196 (decimal degrees) Longitude: 101.35469 (decimal degrees) Horizontal Datum: <input type="checkbox"/> WGS 84 <input checked="" type="checkbox"/> NAD 83 <input type="checkbox"/> NAD 27 Source for Latitude/Longitude: <input checked="" type="checkbox"/> GPS (unit make/model:) (WAAS enabled? <input type="checkbox"/> Yes <input checked="" type="checkbox"/> No) <input type="checkbox"/> Land Survey <input type="checkbox"/> Topographic Map <input type="checkbox"/> Online Mapper:
X								
6 Elevation: 3109.10 ft. <input type="checkbox"/> Ground Level <input checked="" type="checkbox"/> TOC Source: <input checked="" type="checkbox"/> Land Survey <input type="checkbox"/> GPS <input type="checkbox"/> Topographic Map <input type="checkbox"/> Other								

7 WELL WATER TO BE USED AS:

1. Domestic: <input type="checkbox"/> Household <input type="checkbox"/> Lawn & Garden <input type="checkbox"/> Livestock 2. Irrigation 3. Feedlot 4. Industrial	5. <input type="checkbox"/> Public Water Supply: well ID 6. <input type="checkbox"/> Dewatering: how many wells? 7. <input type="checkbox"/> Aquifer Recharge: well ID 8. <input checked="" type="checkbox"/> Monitoring: well ID MW-13 9. Environmental Remediation: well ID <input type="checkbox"/> Air Sparge <input type="checkbox"/> Soil Vapor Extraction <input type="checkbox"/> Recovery <input type="checkbox"/> Injection	10. <input type="checkbox"/> Oil Field Water Supply: lease 11. Test Hole: well ID <input type="checkbox"/> Cased <input type="checkbox"/> Uncased <input type="checkbox"/> Geotechnical 12. Geothermal: how many bores? a) Closed Loop <input type="checkbox"/> Horizontal <input type="checkbox"/> Vertical b) Open Loop <input type="checkbox"/> Surface Discharge <input type="checkbox"/> Inj. of Water 13. <input type="checkbox"/> Other (specify):
--	---	---

Was a chemical/bacteriological sample submitted to KDHE? Yes No If yes, date sample was submitted:
 Water well disinfected? Yes No

8 TYPE OF CASING USED: Steel PVC Other **CASING JOINTS:** Glued Clamped Welded Threaded
 Casing diameter 4 in. to 155 ft., Diameter in. to ft., Diameter in. to ft.
 Casing height above land surface 4 in. Weight lbs./ft. Wall thickness or gauge No.
TYPE OF SCREEN OR PERFORATION MATERIAL:
 Steel Stainless Steel Fiberglass PVC Other (Specify)
 Brass Galvanized Steel Concrete tile None used (open hole)
SCREEN OR PERFORATION OPENINGS ARE:
 Continuous Slot Mill Slot Gauze Wrapped Torch Cut Drilled Holes Other (Specify)
 Louvered Shutter Key Punched Wire Wrapped Saw Cut None (Open Hole)
SCREEN-PERFORATED INTERVALS: From 155 ft. to 195 ft., From ft. to ft., From ft. to ft.
GRAVEL PACK INTERVALS: From 146 ft. to 195 ft., From ft. to ft., From ft. to ft.

9 GROUT MATERIAL: Neat cement Cement grout Bentonite Other
 Grout Intervals: From 1 ft. to 146 ft., From ft. to ft., From ft. to ft.
Nearest source of possible contamination:
 Septic Tank Lateral Lines Pit Privy Livestock Pens Insecticide Storage
 Sewer Lines Cess Pool Sewage Lagoon Fuel Storage Abandoned Water Well
 Watertight Sewer Lines Seepage Pit Feedyard Fertilizer Storage Oil Well/Gas Well
 Other (Specify)
 Direction from well? Distance from well? ft.

10 FROM	TO	LITHOLOGIC LOG	FROM	TO	LITHO. LOG (cont.) or PLUGGING INTERVALS
0	0.5	Asphalt			
0.5	27	Clay with caliche			
27	40	Sand with clay			
40	78	Sand with caliche			
78	87	Caliche, clay, and gravelly sand			
87	142	Caliche and clay with sandy clay			
142	182	Caliche and clay with sand			
182	198	Gravelly sand with caliche and clay			

Notes:
KDHE Project Code: U1-095-11019

11 CONTRACTOR'S OR LANDOWNER'S CERTIFICATION: This water well was constructed, reconstructed, or plugged under my jurisdiction and was completed on (mo-day-year) 3/23/18 and this record is true to the best of my knowledge and belief.
 Kansas Water Well Contractor's License No. 881 This Water Well Record was completed on (mo-day-year) 4/30/18
 under the business name of Woofter Pump and Well Signature: *[Signature]*

STEVENS

SE NW NW

16-33-37W

PLOTTED: 5/1/2018 5:52 AM SAVED: 5/1/2018 5:52 AM Brian S. Fahrenbruch G:\Projects\435-P2-02\Quarterly\Figure A.dwg

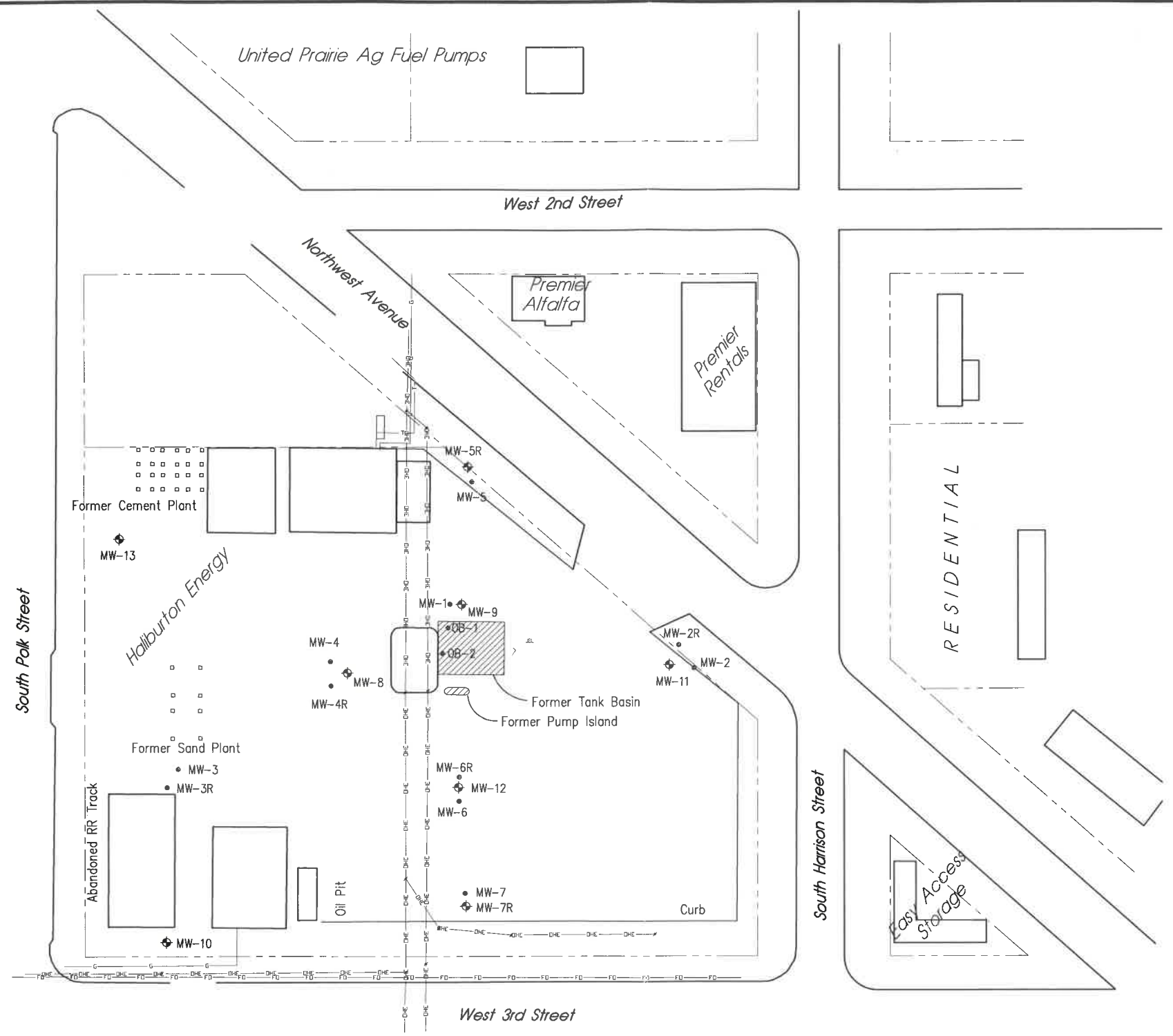

LEGEND

- ◆ = MONITORING WELL
- = PLUGGED WELL
- FO—FO— = FIBER OPTIC
- OHE— = OVERHEAD ELECTRIC
- G— = UNDERGROUND GAS
- T— = UNDERGROUND TELEPHONE

NOTE:
FORMER PRODUCT LINE
LOCATIONS ARE UNKNOWN.

RECEIVED
MAY 07 2018
BUREAU OF WATER

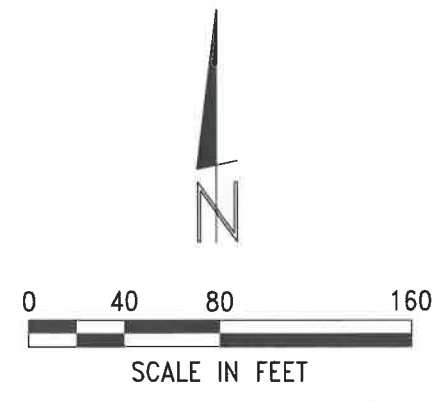

Point Designation	Latitude	Longitude
MW-11	37.18176	101.35356
MW-12	37.18155	101.35399
MW-13	37.18196	101.35469

REVISIONS	BY
MILCO Environmental Services, Inc.	
Kearney, NE (308) 237-5923 McCook, NE (308) 345-4741 Colby, KS (785) 460-1956	
HALIBURTON ENERGY SERVICES SITE MAP	
210 SOUTH POLK STREET. - HUGOTON, KANSAS U1-095-11019	
RECEIVED MAY 07 2018 BUREAU OF WATER	
SCALE:	PROJECT NO. M435-P2-02
DATE: MAY, 2018	FIELD BOOK M&A DWG NO.
DRAWN BY: BSF	APRVD BY:
SHEET	FIGURE A