

**WATER WELL PLUGGING RECORD Form WWC-5P KSA 82a-1212 ID NO.**

**1 LOCATION OF WATER WELL:** Fraction 1/4 SW 1/4 SE 1/4 Section Number 36 Township Number T 34 S Range Number 25  E  W  
 County: Clark  
 Street/Rural Address of Well Location; if unknown, distance & direction from nearest town or intersection: If at owner's address, check here  3rd St + W Mulberry in Englewood. North 130 feet + west 55 feet.  
**Global Positioning Systems (GPS) information:**  
 Latitude: 37.035620 (in decimal degrees)  
 Longitude: -99.987518 (in decimal degrees)  
 Elevation: \_\_\_\_\_  
 Horizontal Datum:  WGS84,  NAD83,  NAD27  
 Collection Method: \_\_\_\_\_

**2 WATER WELL OWNER:** City of Englewood  
 RR#, St. Address, Box #: PO Box 46  
 City, State ZIP Code: Englewood, KS 67840  
 GPS unit (Make/Model: \_\_\_\_\_)  
 Digital Map/Photo,  Topographic Map,  Land Survey  
 Est. Accuracy:  < 3 m,  3-5 m,  5-15 m,  > 15 m

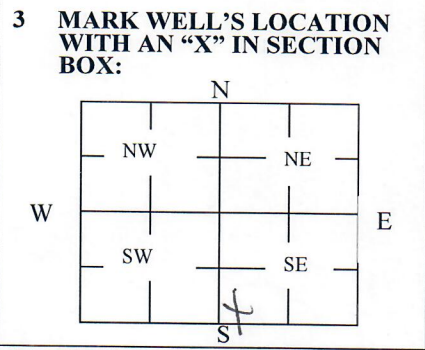

**4 DEPTH OF WELL** 39 ft.  
 WELL'S STATIC WATER LEVEL 24 ft.  
 WELL WAS USED AS:  
 Domestic  Public Water Supply  Dewatering  
 Irrigation  Oil Field Water Supply  Monitoring  
 Feedlot  Domestic (Lawn & Garden)  Injection Well  
 Industrial  Air Conditioning  Other \_\_\_\_\_  
 Was a chemical/bacteriological sample submitted to Department? Yes  No

**5 TYPE OF BLANK CASING USED:**  
 Steel  RMP (SR)  Wrought  Fiberglass  Other (Specify below) \_\_\_\_\_  
 PVC  ABS  Asbestos-Cement  Concrete Tile  
 Blank casing diameter \_\_\_\_\_ in. Was casing pulled? Yes  No  If yes, how much \_\_\_\_\_  
 Casing height above or below land surface 24 in.

**6 GROUT PLUG MATERIAL:**  Neat cement  Cement grout  Bentonite  Other \_\_\_\_\_  
 Grout Plug Intervals: From 24 ft. to 2 ft., From \_\_\_\_\_ ft. to \_\_\_\_\_ ft., From \_\_\_\_\_ ft. to \_\_\_\_\_ ft.  
 What is the nearest source of possible contamination:  
 Septic tank  Seepage pit  Fuel storage  Other (specify below) \_\_\_\_\_  
 Sewer lines  Pit privy  Fertilizer storage \_\_\_\_\_  
 Watertight sewer lines  Sewage lagoon  Insecticide storage \_\_\_\_\_  
 Lateral lines  Feedyard  Abandoned water well  Direction from well? \_\_\_\_\_  
 Cess pool  Livestock pens  Oil well/Gas well  How many feet? \_\_\_\_\_

FROM	TO	PLUGGING MATERIALS	FROM	TO	PLUGGING MATERIALS
39	24	Sand			
24	2	Bentonite			
2	0	Neat Cement			

**7 CONTRACTOR'S OR LANDOWNER'S CERTIFICATION:** This water well was plugged under my jurisdiction and was completed on (mo/day/year) 5/26/23 and this record is true to the best of my knowledge and belief. Kansas Water Well Contractor's License No. 672. This Water Well Record was completed on (mo/day/year) 5/30/23 under the business name of Crawdillo Water Well by (signature) \_\_\_\_\_

Send one white copy to Kansas Department of Health & Environment, Geology Section, 1000 SW Jackson Street, Ste. 420, Topeka, KS 66612-1367. Send one copy to WATER WELL OWNER and retain one for your records.  
 Visit us at <http://www.kdheks.gov/waterwell/index.html> Telephone 785-296-5524.