

County: Seward Fraction NW NW SE Sec. 26 T 34 S R 33 E/W

CORRECTION(S) TO WATER WELL COMPLETION RECORD (WWC-5)
(to rectify lacking or incorrect information)

Owner: Mary Taylor

Location was listed as: _____

Section-Township-Range: 26-34S-33W

Fraction (1/4 1/4 1/4): None Given

Location changed to:
26-34S-33W
NW NW SE

Other changes: Initial statements: _____

Changed to: _____

Comments: _____

Verification method: Written & legal descriptions, Seward County
online parcel search, and mapping tool & aerial photos
on KGS website.

Submitted by: _____ initials: ORA date: 10/30/2013
to: Kansas Geological Survey, Data Resources Library, 1930 Constant Ave., Lawrence, KS 66047-3726
to: Kansas Dept of Health & Environment, Bureau of Water, 1000 SW Jackson, Suite 420, Topeka, KS 66612-1367.

WATER WELL RECORD

Form WWC-5

Division of Water Resources App. No.

1 LOCATION OF WATER WELL: County: Seward Co ks	Fraction 1/4 1/4 1/4 1/4	Section Number 26	Township No. T 34 S	Range Number R 33 <input type="checkbox"/> E <input checked="" type="checkbox"/> W
--	--------------------------------------	----------------------	------------------------	---

Street/Rural Address of Well Location; if unknown, distance & direction from nearest town or intersection: If at owner's address, check here .
 Liberal Ks., int of hwy 54&83 go on 54 2.1, S of hwy 54 go 90' to 11518 S 40 to flag

Global Positioning System (GPS) information:
 Latitude: (in decimal degrees)
 Longitude: (in decimal degrees)
 Elevation:
 Datum: WGS 84, NAD 83, NAD 27
 Collection Method:
 GPS unit (Make/Model:)
 Digital Map/Photo, Topographic Map, Land Survey
 Est. Accuracy: <3 m, 3-5 m, 5-15 m, >15 m

2 WATER WELL OWNER: MARY TAYLOR
 RR#, Street Address, Box #: 11518 HWY 54
 City, State, ZIP Code : LIBERAL, KS 67901

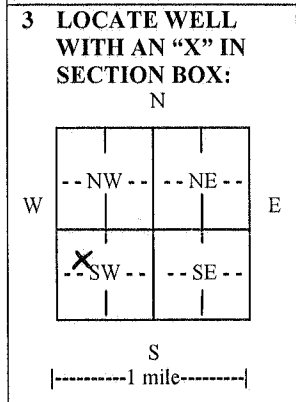

4 DEPTH OF COMPLETED WELL 300 ft.
 Depth(s) Groundwater Encountered (1) 200 ft. (2) ft. (3) ft.
 WELL'S STATIC WATER LEVEL 200 ft. below land surface measured on mo/day/yr. 9-20-13
 Pump test data: Well water was 240 ft. after 1 hours pumping, 65 gpm
 EST. YIELD 65 gpm. Well water was ft. after hours pumping gpm
 Bore Hole Diameter 9.75 in. to 300 ft., and in. to ft.
 WELL WATER TO BE USED AS: Public water supply Geothermal Injection well
 Domestic Feedlot Oil field water supply Dewatering Other (Specify below)
 Irrigation Industrial Domestic-lawn & garden Monitoring well
 Was a chemical/bacteriological sample submitted to Department? Yes No
 If yes, mo/day/yr sample was submitted.....
 Water well disinfected? Yes No

5 TYPE OF CASING USED: Steel PVC Other
 CASING JOINTS: Glued Clamped Welded Threaded
 Casing diameter 5" in. to ft., Diameter in. to ft., Diameter in. to ft.
 Casing height above land surface 300 in., Weight 3.706 lbs./ft., Wall thickness or gauge No. SDR 21-316
 TYPE OF SCREEN OR PERFORATION MATERIAL:
 Steel Stainless Steel PVC Other (Specify)
 Brass Galvanized Steel None used (open hole)
 SCREEN OR PERFORATION OPENINGS ARE:
 Continuous slot Mill slot Gauze wrapped Torch cut Drilled holes None (open hole)
 Louvered shutter Key punched Wire wrapped Saw cut Other (specify)
 SCREEN-PERFORATED INTERVALS: From 240 ft. to 300 ft., From ft. to ft.
 GRAVEL PACK INTERVALS: From 110 ft. to 300 ft., From ft. to ft.
 From ft. to ft., From ft. to ft.

6 GROUT MATERIAL: Neat cement Cement grout Bentonite Other
 Grout Intervals: From 1 ft. to 25 ft., From ft. to ft., From ft. to ft.
 What is the nearest source of possible contamination:
 Septic tank Lateral lines Pit privy Livestock pens Insecticide storage Other (specify below)
 Sewer lines Cesspool Sewage lagoon Fuel storage Abandoned water well
 Watertight sewer lines Seepage pit Feedyard Fertilizer storage Oil well/gas well
 Direction from well Distance from well

FROM	TO	LITHOLOGIC LOG	FROM	TO	LITHO. LOG (cont.) or PLUGGING INTERVALS
0	3	TOP SOIL	291	305	TAN, BROWN/BLUE CLAY
3	23	CLAY			
23	35	CALICHE/SANDY CLAY			
35	64	SANDY CLAY			
64	84	MED. SAND			
84	126	SANDY CLAY			
126	148	CLAY			
148	169	SANDY CLAY			
169	210	CLAY/SAND STREAKS			
210	291	MED. SAND			

7 CONTRACTOR'S OR LANDOWNER'S CERTIFICATION: This water well was constructed, reconstructed, or plugged under my jurisdiction and was completed on (mo/day/year) 9-20-13 and this record is true to the best of my knowledge and belief.
 Kansas Water Well Contractor's License No. 430 This Water Well Record was completed on (mo/day/year) 9-20-13
 under the business name of Howard Ding Co Box 806 Beaver Ok 73932 by (signature) *Phil Howard*

INSTRUCTIONS: Use typewriter or ball point pen. PLEASE PRESS FIRMLY and PRINT clearly. Please fill in blanks and check the correct answers. Send one copy to Kansas Department of Health and Environment, Bureau of Water, Geology Section, 1000 SW Jackson St., Suite 420, Topeka, Kansas 66612-1367. Telephone 785-296-5524. Send one copy to WATER WELL OWNER and retain one for your records. Include fee of \$5.00 for each constructed well. Visit us at <http://www.kdheks.gov/waterwell/index.html>