

1 LOCATION OF WATER WELL: County: Seward Fraction: NE 1/4 NW 1/4 NW 1/4 Section Number: 9 Township Number: 34 Range Number: 34 EW

Distance and direction from nearest town or city street address of well if located within city?

4 Miles North & 6 Miles West of Liberal

2 WATER WELL OWNER: Randy Malin
 RR#, St. Address, Box #: RR1 Box 139
 City, State ZIP Code: Liberal, KS 67901

Global Positioning Systems (decimal degrees, min. of 4 digits)
 Latitude: _____
 Longitude: _____
 Elevation: _____
 Datum: _____
 Data Collection Method: _____

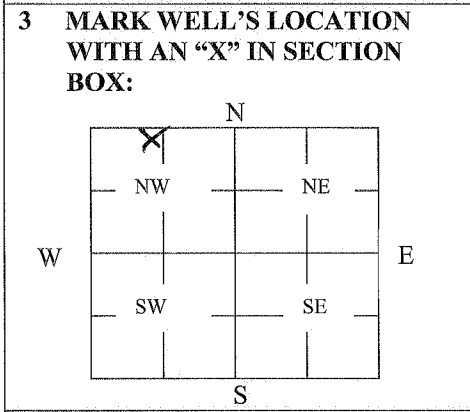

4 DEPTH OF WELL 287 ft.
WELL'S STATIC WATER LEVEL 213 ft.
WELL WAS USED AS:

<input checked="" type="checkbox"/> 1 Domestic	5 Public Water Supply	9 Dewatering
2 Irrigation	6 Oil Field Water Supply	10 Monitoring
3 Feedlot	7 Domestic (Lawn & Garden)	11 Injection Well
4 Industrial	8 Air Conditioning	12 Other _____

Was a chemical/bacteriological sample submitted to Department? Yes _____ No

5 TYPE OF BLANK CASING USED:

<input checked="" type="checkbox"/> 1 Steel	3 RMP (SR)	5 Wrought	7 Fiberglass	9 Other (Specify below) _____
2 PVC	4 ABS	6 Asbestos-Cement	8 Concrete Tile	

Blank casing diameter 5 in. Was casing pulled? Yes _____ No If yes, how much _____
 Casing height above or below land surface 60 in.

6 GROUT PLUG MATERIAL: 1 Neat cement 2 Cement grout 3 Bentonite 4 Other _____

Grout Plug Intervals: From 6 ft. to 12 ft., From _____ ft. to _____ ft., From _____ to _____ ft.

What is the nearest source of possible contamination:

1 Septic tank	6 Seepage pit	11 Fuel Storage	16 Other (specify below) _____
2 Sewer lines	7 Pit privy	12 Fertilizer storage	
3 Watertight sewer lines	8 Sewage lagoon	13 Insecticide storage	
4 Lateral lines	9 Feedyard	<input checked="" type="checkbox"/> 14 Abandoned water well	Direction from well? <u>South</u>
5 Cess pool	10 Livestock pens	15 Oil well/Gas well	How many feet? <u>20</u>

FROM	TO	PLUGGING MATERIALS	FROM	TO	PLUGGING MATERIALS
287	213	chlorinated sand			
213	12	Clay/Sub soil			
12	6	Bentonite			
6	-	cut off casing			

7 CONTRACTOR'S OR LANDOWNER'S CERTIFICATION: This water well was plugged under my jurisdiction and was completed on (mo/day/year) 9-4-13 and this record is true to the best of my knowledge and belief. Kansas Water Well Contractor's License No. 805. This Water Well Record was completed on (mo/day/year) 9-5-13 under the business name of Southeast Windmill by (signature) David Ems

INSTRUCTIONS: Use typewriter or ballpoint pen. Please press firmly and print clearly. Please fill in blanks, underline or circle the correct answers. Send top three copies to Kansas Department of Health and Environment, Bureau of Water, Geology Section, 1000 SW Jackson St., Ste. 420, Topeka, Kansas 66612-1367. Telephone: 785/296-5522. Send one to Water Well Owner and retain one for your records. Visit us at <http://www.kdheks.gov/geo/waterwells>.