

USE TYPEWRITER OR BALL POINT PEN-PRESS FIRMLY, PRINT CLEARLY.

WATER WELL RECORD  
KSA 82a-1201-1215

Kansas Department of Health and Environment-Division of Environment  
(Water well Contractors)  
Topeka, Kansas 66620

**CW 16768** **Summers Trust A-1**

1. Location of well:	County <b>Seward</b>	Fraction <b>1/4 C-SW SE 1/4</b>	Section number <b>15</b>	Township number <b>T 34 S R 34</b>	Range number <b>34</b>	<b>E/W</b>
----------------------	-------------------------	------------------------------------	-----------------------------	---------------------------------------	---------------------------	------------

2. Distance and direction from nearest town or city: **From the Western Mobil Home Park North West of Liberal**  
Street address of well location if in city: **go 1 mi North 3/4 mi West north into loc.**

Owner of well: **Anadarko Production**  
R.R. or street: **c/o P. Gatlin Box 351**  
City, state, zip code: **Liberal, Kansas 67901**

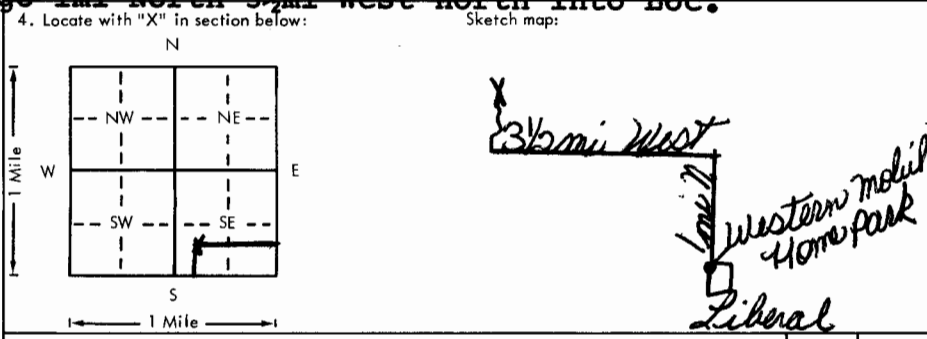

6. Bore hole dia. **9** in. Completion date \_\_\_\_\_  
Well depth **280** ft. **2-15-80**

7.  Cable tool  Rotary  Driven  Dug  
 Hollow rod  Jetted  Bored  Reverse rotary

8. Use:  Domestic  Public supply  Industry  
 Irrigation  Air conditioning  Stock  
 Lawn  Oil field water  Other

9. Casing: Material \_\_\_\_\_ Height: Above or below  
Threaded \_\_\_\_\_ Welded \_\_\_\_\_ Surface **28** in.  
RMP \_\_\_\_\_ PVC  Weight **2.78** lbs./ft.  
Dia. **5** in. to **180** ft. depth Wall Thickness: inches or  
Dia. \_\_\_\_\_ in. to \_\_\_\_\_ ft. depth gage No. **.56**

5. Type and color of material	From	To
<b>Surface</b>	<b>0</b>	<b>2</b>
<b>Clay</b>	<b>2</b>	<b>87</b>
<b>Fine sand &amp; medium to large sand</b>	<b>87</b>	<b>109</b>
<b>70% clay &amp; 30% fine sand</b>	<b>109</b>	<b>213</b>
<b>40% clay &amp; 60% fine sand</b>	<b>213</b>	<b>223</b>
<b>Fine sand</b>	<b>223</b>	<b>280</b>
(Use a second sheet if needed)		

10. Screen: Manufacturer's name \_\_\_\_\_  
Type **PVC Sawn** Dia. **5"**  
Slot/gauze **.030** Length **100'**  
Set between **180** ft. and **280** ft.  
ft. and \_\_\_\_\_ ft.  
Gravel pack? **Yes** Size range of material **1/8-3/16**

11. Static water level: \_\_\_\_\_ mo./day/yr.  
**120** ft. below land surface Date **2-15-80**

12. Pumping level below land surfaces:  
\_\_\_\_\_ ft. after \_\_\_\_\_ hrs. pumping \_\_\_\_\_ g.p.m.  
\_\_\_\_\_ ft. after \_\_\_\_\_ hrs. pumping \_\_\_\_\_ g.p.m.  
Estimated maximum yield **60** g.p.m.

13. Water sample submitted: \_\_\_\_\_ mo./day/yr.  
Yes  No  Date \_\_\_\_\_

14. Well head completion:  
 Pitless adapter **28** Inches above grade

15. Well grouted? **Yes**  
With:  Neat cement  Bentonite  Concrete  
Depth: From **0** ft. to **10** ft.

16. Nearest source of possible contamination:  
ft. **100** Direction **N.E.** Type **Oil well**  
Well disinfected upon completion?  Yes  No

17. Pump:  Not installed  
Manufacturer's name \_\_\_\_\_  
Model number \_\_\_\_\_ HP \_\_\_\_\_ Volts \_\_\_\_\_  
Length of drop pipe \_\_\_\_\_ ft. capacity \_\_\_\_\_ g.p.m.  
Type:  
 Submersible  Turbine  
 Jet  Reciprocating  
 Centrifugal  Other

18. Elevation:

Topography:  
 Hill  
 Slope  
 Upland  
 Valley

19. Remarks:

20. Water well contractor's certification:  
This well was drilled under my jurisdiction and this report is true to the best of my knowledge and belief. **#118**  
**Carlile Water Well Service**  
Business name License No. \_\_\_\_\_  
Address **Box AA Liberal, Kansas**  
Signed **Edward & Meane** Date **2-26-80**  
Authorized representative

34  
 34  
 15  
 Sec  
 1/4  
 1/4  
 C 8085E