

WATER WELL RECORD

Form WWC-5

Division of Water Resources App. No.

1 LOCATION OF WATER WELL: County: Comanche	Fraction ¼ NE ¼ SW ¼ NE ¼	Section Number 12	Township No. T 35 S	Range Number R 18 <input type="checkbox"/> E <input checked="" type="checkbox"/> W
Street/Rural Address of Well Location; if unknown, distance & direction from nearest town or intersection: If at owner's address, check here <input type="checkbox"/> Fro the intersection of HWY 1 and W Rd, 5 1/2 miles East, South 1 1/2 miles into.		Global Positioning System (GPS) information: Latitude: (in decimal degrees) Longitude: (in decimal degrees) Elevation: Datum: <input type="checkbox"/> WGS 84, <input type="checkbox"/> NAD 83, <input type="checkbox"/> NAD 27 Collection Method: <input type="checkbox"/> GPS unit (Make/Model:) <input type="checkbox"/> Digital Map/Photo, <input type="checkbox"/> Topographic Map, <input type="checkbox"/> Land Survey Est. Accuracy: <input type="checkbox"/> <3 m, <input type="checkbox"/> 3-5 m, <input type="checkbox"/> 5-15 m, <input type="checkbox"/> >15 m		
2 WATER WELL OWNER: Ernest Oller RR#, Street Address, Box #: 301 W. 3rd St. City, State, ZIP Code : Coldwater, KS 67029				

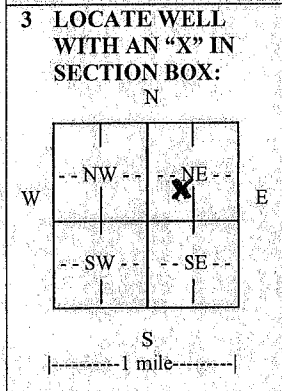

4 DEPTH OF COMPLETED WELL 113 ft.
 Depth(s) Groundwater Encountered (1) 70 ft. (2) ft. (3) ft.
 WELL'S STATIC WATER LEVEL 70 ft. below land surface measured on mo/day/yr. 7/12/11
 Pump test data: Well water was ft. after hours pumping gpm
 EST. YIELD 5 gpm. Well water was ft. after hours pumping gpm
 Bore Hole Diameter 10 5/8 in. to ft., and in. to ft.
 WELL WATER TO BE USED AS: Public water supply Geothermal Injection well
 Domestic Feedlot Oil field water supply Dewatering Other (Specify below)
 Irrigation Industrial Domestic-lawn & garden Monitoring well
 Was a chemical/bacteriological sample submitted to Department? Yes No
 If yes, mo/day/yr sample was submitted.....
 Water well disinfected? Yes No

5 TYPE OF CASING USED: Steel PVC Other
CASING JOINTS: Glued Clamped Welded Threaded
 Casing diameter 5 in. to 93 ft., Diameter in. to ft., Diameter in. to ft.
 Casing height above land surface 30 in., Weight SDR:17 lbs./ft., Wall thickness or gauge No.
TYPE OF SCREEN OR PERFORATION MATERIAL:
 Steel Stainless Steel PVC Other (Specify)
 Brass Galvanized Steel None used (open hole)
SCREEN OR PERFORATION OPENINGS ARE:
 Continuous slot Mill slot Gauze wrapped Torch cut Drilled holes None (open hole)
 Louvered shutter Key punched Wire wrapped Saw cut Other (specify)
SCREEN-PERFORATED INTERVALS: From 113 ft. to 93 ft., From ft. to ft.
GRAVEL PACK INTERVALS: From 113 ft. to 20 ft., From ft. to ft.
 From ft. to ft., From ft. to ft.

6 GROUT MATERIAL: Neat cement Cement grout Bentonite Other
 Grout Intervals: From 20 ft. to 0 ft., From ft. to ft., From ft. to ft.
 What is the nearest source of possible contamination:
 Septic tank Lateral lines Pit privy Livestock pens Insecticide storage Other (specify below)
 Sewer lines Cesspool Sewage lagoon Fuel storage Abandoned water well
 Watertight sewer lines Seepage pit Feedyard Fertilizer storage Oil well/gas well
 Direction from well West Distance from well 20 f.....

FROM	TO	LITHOLOGIC LOG	FROM	TO	LITHO. LOG (cont.) or PLUGGING INTERVALS
0	113	Red and Gray Layered Shale			

7 CONTRACTOR'S OR LANDOWNER'S CERTIFICATION: This water well was constructed, reconstructed, or plugged under my jurisdiction and was completed on (mo/day/year) 5/18/2011 and this record is true to the best of my knowledge and belief. Kansas Water Well Contractor's License No. 665 This Water Well Record was completed on (mo/day/year) 1/23/2012 under the business name of Pratt Well Service by (signature) *Pratt Well Service*

INSTRUCTIONS: Use typewriter or ball point pen. PLEASE PRESS FIRMLY and PRINT clearly. Please fill in blanks and check the correct answers. Send three copies (white, blue, pink) to Kansas Department of Health and Environment, Bureau of Water, Geology Section, 1000 SW Jackson St., Suite 420, Topeka, Kansas 66612-1367. Telephone 785-296-5522. Send one copy to WATER WELL OWNER and retain one for your records. Include fee of \$5.00 for each constructed well. Visit us at <http://www.kdheks.gov/waterwell/index.html>.