

WATER WELL RECORD Form WWC-5

Division of Water Resources App. No.

Well ID MW-5

Original Record Correction Change in Well Use

1 LOCATION OF WATER WELL: County: Seward	Fraction SE ¼ SE ¼ SE ¼ NE ¼	Section Number 5	Township Number T 35 S	Range Number R 33 <input type="checkbox"/> E <input checked="" type="checkbox"/> W
-----------------------------------------------------------	---------------------------------	----------------------------	----------------------------------	----------------------------------------------------------------------------------------------

2 WELL OWNER: Last Name: Circle K Stores Business: Circle K Stores Address: 1100 Situs Court, Suite 100 City: Raleigh State: NC ZIP: 27606	Street or Rural Address where well is located (if unknown, distance and direction from nearest town or intersection): If at owner's address, check here: <input type="checkbox"/> 440 S. Kansas Avenue - Liberal, KS
------------------------------------------------------------------------------------------------------------------------------------------------------------------------------------------------------	--------------------------------------------------------------------------------------------------------------------------------------------------------------------------------------------------------------------------------

3 LOCATE WELL WITH "X" IN SECTION BOX: N <table style="width: 100%; text-align: center; border-collapse: collapse;"> <tr><td style="border: 1px solid black; width: 25px; height: 25px;">NW</td><td style="border: 1px solid black; width: 25px; height: 25px;">NE</td></tr> <tr><td style="border: 1px solid black; width: 25px; height: 25px;">SW</td><td style="border: 1px solid black; width: 25px; height: 25px;">SE</td></tr> </table> W E S 1 mile	NW	NE	SW	SE	4 DEPTH OF COMPLETED WELL: 199 ft. Depth(s) Groundwater Encountered: 1) ft. 2) ft. 3) ft., or 4) <input type="checkbox"/> Dry Well WELL'S STATIC WATER LEVEL: 176.53 ft. <input checked="" type="checkbox"/> below land surface, measured on (mo-day-yr) 12-19-17 <input type="checkbox"/> above land surface, measured on (mo-day-yr) Pump test data: Well water was ft. after hours pumping gpm Well water was ft. after hours pumping gpm Estimated Yield: gpm Bore Hole Diameter: 8.5 in. to 207 ft. and in. to ft.	5 Latitude: 37.03290 (decimal degrees) Longitude: 100.92289 (decimal degrees) Horizontal Datum: <input type="checkbox"/> WGS 84 <input checked="" type="checkbox"/> NAD 83 <input type="checkbox"/> NAD 27 Source for Latitude/Longitude: <input checked="" type="checkbox"/> GPS (unit make/model: EPOCH) (WAAS enabled? <input type="checkbox"/> Yes <input checked="" type="checkbox"/> No) <input type="checkbox"/> Land Survey <input type="checkbox"/> Topographic Map <input type="checkbox"/> Online Mapper: 6 Elevation: 2840.73 ft. <input type="checkbox"/> Ground Level <input checked="" type="checkbox"/> TOC Source: <input checked="" type="checkbox"/> Land Survey <input type="checkbox"/> GPS <input type="checkbox"/> Topographic Map <input type="checkbox"/> Other
NW	NE					
SW	SE					

7 WELL WATER TO BE USED AS:

1. Domestic: <input type="checkbox"/> Household <input type="checkbox"/> Lawn & Garden <input type="checkbox"/> Livestock 2. <input type="checkbox"/> Irrigation 3. <input type="checkbox"/> Feedlot 4. <input type="checkbox"/> Industrial	5. <input type="checkbox"/> Public Water Supply: well ID 6. <input type="checkbox"/> Dewatering: how many wells? 7. <input type="checkbox"/> Aquifer Recharge: well ID 8. <input checked="" type="checkbox"/> Monitoring: well ID MW-5 9. Environmental Remediation: well ID <input type="checkbox"/> Air Sparge <input type="checkbox"/> Soil Vapor Extraction <input type="checkbox"/> Recovery <input type="checkbox"/> Injection	10. <input type="checkbox"/> Oil Field Water Supply: lease 11. Test Hole: well ID <input type="checkbox"/> Cased <input type="checkbox"/> Uncased <input type="checkbox"/> Geotechnical 12. Geothermal: how many bores? a) Closed Loop <input type="checkbox"/> Horizontal <input type="checkbox"/> Vertical b) Open Loop <input type="checkbox"/> Surface Discharge <input type="checkbox"/> Inj. of Water 13. <input type="checkbox"/> Other (specify):
---------------------------------------------------------------------------------------------------------------------------------------------------------------------------------------------------------------------------------------------------------------	---------------------------------------------------------------------------------------------------------------------------------------------------------------------------------------------------------------------------------------------------------------------------------------------------------------------------------------------------------------------------------------------------------------------------------------------------------------------------------------	-----------------------------------------------------------------------------------------------------------------------------------------------------------------------------------------------------------------------------------------------------------------------------------------------------------------------------------------------------------------------------------------------------------------------------------------------------------------------------------------------------

Was a chemical/bacteriological sample submitted to KDHE? Yes No If yes, date sample was submitted:

Water well disinfected? Yes No

8 TYPE OF CASING USED: Steel PVC Other CASING JOINTS: Glued Clamped Welded Threaded
 Casing diameter **4** in. to **169** ft., Diameter in. to ft., Diameter in. to ft.
 Casing height above land surface **6.2** in. Weight lbs./ft. Wall thickness or gauge No. **Sch. 40**

TYPE OF SCREEN OR PERFORATION MATERIAL:
 Steel Stainless Steel Fiberglass PVC Other (Specify)
 Brass Galvanized Steel Concrete tile None used (open hole)

SCREEN OR PERFORATION OPENINGS ARE:
 Continuous Slot Mill Slot Gauze Wrapped Torch Cut Drilled Holes Other (Specify)
 Louvered Shutter Key Punched Wire Wrapped Saw Cut None (Open Hole)

SCREEN-PERFORATED INTERVALS: From **169** ft. to **199** ft., From ft. to ft., From ft. to ft.
GRAVEL PACK INTERVALS: From **167** ft. to **199** ft., From ft. to ft., From ft. to ft.

9 GROUT MATERIAL: Neat cement Cement grout Bentonite Other
 Grout Intervals: From **0.5** ft. to **167** ft., From ft. to ft., From ft. to ft.

Nearest source of possible contamination:
 Septic Tank Lateral Lines Pit Privy Livestock Pens Insecticide Storage
 Sewer Lines Cess Pool Sewage Lagoon Fuel Storage Abandoned Water Well
 Watertight Sewer Lines Seepage Pit Feedyard Fertilizer Storage Oil Well/Gas Well
 Other (Specify)
 Direction from well? Distance from well? ft.

10 FROM	TO	LITHOLOGIC LOG	FROM	TO	LITHO. LOG (cont.) or PLUGGING INTERVALS
0	0.5	Concrete			
0.5	24	Silty Sand with clay			
24	72	Sandy Clay and caliche			
72	84	Sand			
84	137	Clay and caliche with sandy clay, sand			
137	178	Caliche and clay with sandy clay			
178	199	Sand with clay and caliche			
Notes: The Pantry #1621; KDHE project code: U1-088-14791					

11 CONTRACTOR'S OR LANDOWNER'S CERTIFICATION: This water well was constructed, reconstructed, or plugged under my jurisdiction and was completed on (mo-day-year) **12/14/17** and this record is true to the best of my knowledge and belief. Kansas Water Well Contractor's License No. **881** This Water Well Record was completed on (mo-day-year) **2/1/18** under the business name of **Woolter Pump & Well** Signature *[Signature]*

PLOTTED: 2/5/2018 1:50 PM
 SAVED: 2/5/2018 1:50 PM
 Brian S. Fahrenbruch
 G:\Projects\286\286-P\286-P3-01\LSA 11-2017\Figure 2.1.dwg

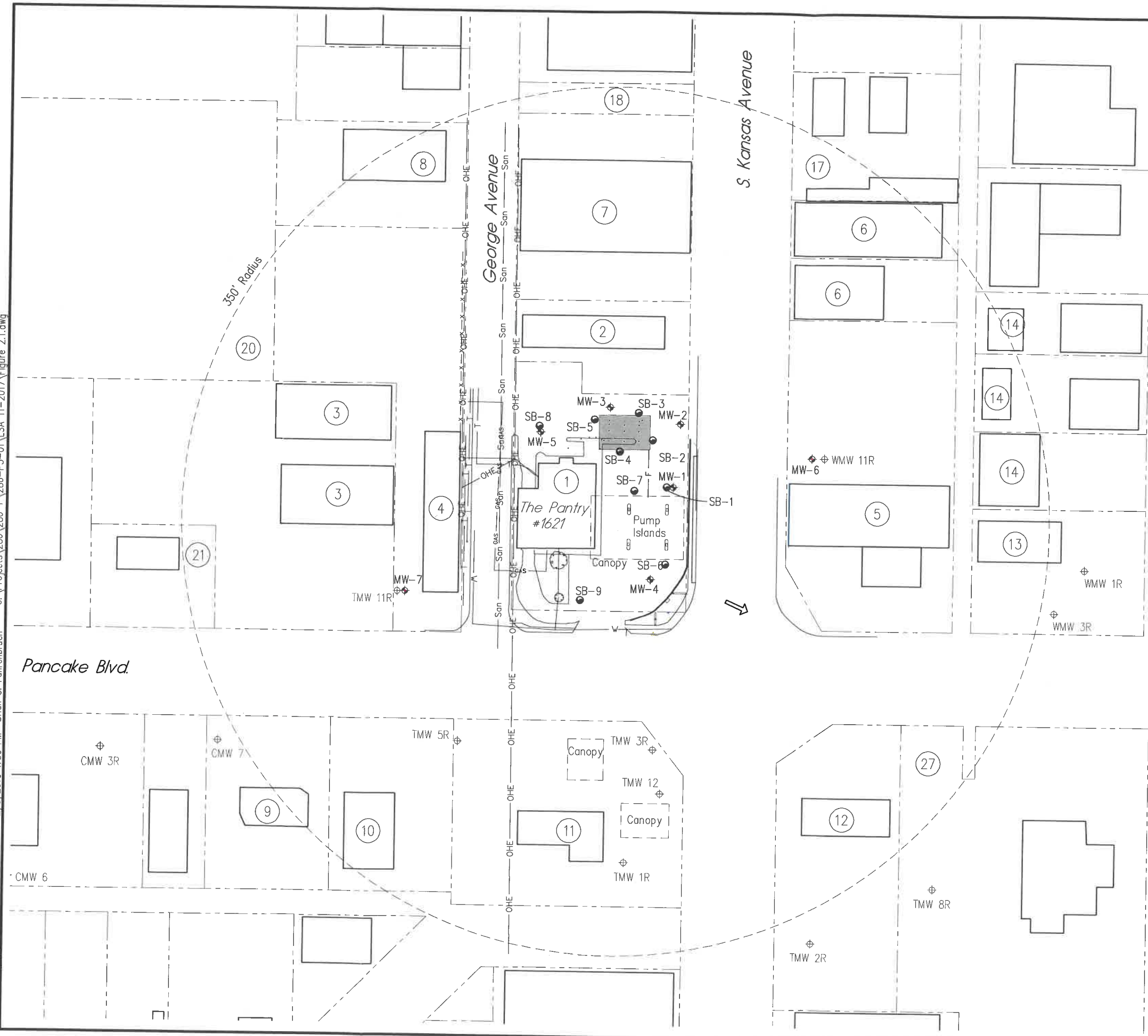

LEGEND

- = MONITOR WELL
- = SOIL BORING
- = MONITORING WELL NOT SAMPLED
- = FUEL LINES
- = UNDERGROUND GAS
- = UNDERGROUND WATER
- = OVERHEAD ELECTRIC
- = SANITARY SEWER
- = TELEPHONE
- = FENCE
- = TANK BASIN
- = APPROXIMATE ROW LINES
- = GROUNDWATER FLOW DIRECTION

NOTE:
 LOCATION OF SEWER LINE IS UNKNOWN ON SITE.
 LOCATION OF FUEL LINES IS ESTIMATED BASED ON
 WHERE CONCRETE IS CUT.

Point Designation	Latitude	Longitude
MW-1	37.03278	100.92252
MW-2	37.03292	100.92251
MW-3	37.03296	100.92270
MW-4	37.03258	100.92259
MW-5	37.03290	100.92289
MW-6	37.03285	100.92214
MW-7	37.03255	100.92326

REVISIONS	BY

MILCO
 Environmental Services, Inc.
 Kearney, NE (308) 237-5923
 McCook, NE (308) 345-4741

THE PANTRY #1621
SITE BASE MAP - 350' RADIUS
 440 S. KANSAS AVE., LIBERAL, KANSAS - U1-088-14791

This document, and the areas and designs incorporated herein, as an instrument of professional service, is the property of MILCO and is not to be used in whole or in part, for any other project without the written authorization of © 2009 MILCO.

RECEIVED
 FEB 12 2018
 BUREAU OF WATER

SCALE: AS SHOWN
 PROJECT NO. M286-P3-01
 DATE: FEBRUARY, 2018
 FIELD BOOK M&A DWG NO.
 DRAWN BY: BSF
 APRVD BY:
 SHEET

0 40 80 160
 SCALE IN FEET

FIGURE 2.1