

**WATER WELL RECORD Form WWC-5**

Division of Water Resources App. No.

MW-9

Original Record  Correction  Change in Well Use

Well ID

**1 LOCATION OF WATER WELL:**  
County: **Seward**

Fraction  
SE ¼ SE ¼ SE ¼ NE ¼

Section Number  
**5**

Township Number  
**T 35 S**

Range Number  
**R 33**  E  W

**2 WELL OWNER:** Last Name: **Cruz**  
Business:  
Address: **1211 N. Prospect Ave**  
Address:  
City: **Liberal** State: **KS** ZIP: **67901**

First: **Carlos & Luz**

Street or Rural Address where well is located (if unknown, distance and direction from nearest town or intersection): If at owner's address, check here:   
**422 S. Kansas Ave, Liberal**

**3 LOCATE WELL WITH "X" IN SECTION BOX:**  
N

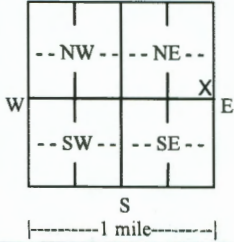

**4 DEPTH OF COMPLETED WELL:** ... **200** ... ft.  
Depth(s) Groundwater Encountered: 1) ..... ft.  
2) ..... ft. 3) ..... ft., or 4)  Dry Well  
WELL'S STATIC WATER LEVEL: ..... **183.70** ... ft.  
 below land surface, measured on (mo-day-yr) **8-5-2020**  
 above land surface, measured on (mo-day-yr) .....  
Pump test data: Well water was ..... ft.  
after ..... hours pumping ..... gpm  
Well water was ..... ft.  
after ..... hours pumping ..... gpm  
Estimated Yield: ..... gpm  
Bore Hole Diameter: **8.5** in. to **200** ft. and  
..... in. to ..... ft.

**5 Latitude:** ..... **37.03323** ..... (decimal degrees)  
**Longitude:** ..... **100.92256** ..... (decimal degrees)  
Horizontal Datum:  WGS 84  NAD 83  NAD 27  
Source for Latitude/Longitude:  
 GPS (unit make/model: **EPOCH**)  
(WAAS enabled?  Yes  No)  
 Land Survey  Topographic Map  
 Online Mapper: .....

**6 Elevation:** **2840.26** ..... ft.  Ground Level  TOC  
Source:  Land Survey  GPS  Topographic Map  
 Other .....

**7 WELL WATER TO BE USED AS:**

- |  |  |                                     |  |  |   |   |  |   |  |  |                              |                                       |   |
|--|--|-------------------------------------|--|--|---|---|--|---|--|--|------------------------------|---------------------------------------|---|
| 1. Domestic:<br><input type="checkbox"/> Household<br><input type="checkbox"/> Lawn & Garden<br><input type="checkbox"/> Livestock | 2. <input type="checkbox"/> Irrigation | 3. <input type="checkbox"/> Feedlot | 4. <input type="checkbox"/> Industrial | 5. <input type="checkbox"/> Public Water Supply: well ID ..... | 6. <input type="checkbox"/> Dewatering: how many wells? ..... | 7. <input type="checkbox"/> Aquifer Recharge: well ID ..... | 8. <input checked="" type="checkbox"/> Monitoring: well ID <b>MW-9</b> ..... | 9. Environmental Remediation: well ID ..... | <input type="checkbox"/> Air Sparge <input type="checkbox"/> Soil Vapor Extraction<br><input type="checkbox"/> Recovery <input type="checkbox"/> Injection | 10. <input type="checkbox"/> Oil Field Water Supply: lease ..... | 11. Test Hole: well ID ..... | 12. Geothermal: how many bores? ..... | 13. <input type="checkbox"/> Other (specify): ..... |
|--|--|-------------------------------------|--|--|---|---|--|---|--|--|------------------------------|---------------------------------------|---|

Was a chemical/bacteriological sample submitted to KDHE?  Yes  No If yes, date sample was submitted: .....  
Water well disinfected?  Yes  No

**8 TYPE OF CASING USED:**  Steel  PVC  Other ..... CASING JOINTS:  Glued  Clamped  Welded  Threaded  
Casing diameter ..... **4** ..... in. to **170** ..... ft., Diameter ..... in. to ..... ft., Diameter ..... in. to ..... ft.  
Casing height above land surface ..... **-3.1** ..... in. Weight ..... lbs./ft. Wall thickness or gauge No. **Sch 40** .....

TYPE OF SCREEN OR PERFORATION MATERIAL:  
 Steel  Stainless Steel  Fiberglass  PVC  Other (Specify) .....  
 Brass  Galvanized Steel  Concrete tile  None used (open hole)

SCREEN OR PERFORATION OPENINGS ARE:  
 Continuous Slot  Mill Slot  Gauze Wrapped  Torch Cut  Drilled Holes  Other (Specify) .....  
 Louvered Shutter  Key Punched  Wire Wrapped  Saw Cut  None (Open Hole)

SCREEN-PERFORATED INTERVALS: From **170** ..... ft. to **200** ..... ft., From ..... ft. to ..... ft., From ..... ft. to ..... ft.  
GRAVEL PACK INTERVALS: From **167** ..... ft. to **200** ..... ft., From ..... ft. to ..... ft., From ..... ft. to ..... ft.

**9 GROUT MATERIAL:**  Neat cement  Cement grout  Bentonite  Other .....  
Grout Intervals: From **0.5** ..... ft. to **167** ..... ft., From ..... ft. to ..... ft., From ..... ft. to ..... ft.

Nearest source of possible contamination:  
 Septic Tank  Lateral Lines  Pit Privy  Livestock Pens  Insecticide Storage  
 Sewer Lines  Cess Pool  Sewage Lagoon  Fuel Storage  Abandoned Water Well  
 Watertight Sewer Lines  Seepage Pit  Feedyard  Fertilizer Storage  Oil Well/Gas Well  
 Other (Specify) .....

Direction from well? ..... Distance from well? ..... ft.

10 FROM	TO	LITHOLOGIC LOG	FROM	TO	LITHO. LOG (cont.) or PLUGGING INTERVALS
0	0.5	Concrete			
0.5	8	Silt with trace sand			
8	34	Sandy clay			
34	56	Clay and caliche			
56	76	Clay and caliche with sand			
76	100	Sandy clay with sand and caliche			
100	144	Clay with trace sand and caliche			
144	178	Clay and caliche, trace sand, sandy clay			
178	200	Sand with sandy clay and trace caliche			

Notes: The Pantry #1621; KDHE project code: U1-088-14791

**11 CONTRACTOR'S OR LANDOWNER'S CERTIFICATION:** This water well was  constructed,  reconstructed, or  plugged under my jurisdiction and was completed on (mo-day-year) **7/31/2020** ..... and this record is true to the best of my knowledge and belief. Kansas Water Well Contractor's License No. **881** ..... This Water Well Record was completed on (mo-day-year) **8/26/2020** ..... under the business name of **Woofter Pump & Well** ..... Signature *[Signature]*

Mail 1 white copy along with a fee of \$5.00 for each constructed well to: Kansas Department of Health and Environment, Bureau of Water, GWTS Section, 1000 SW Jackson St., Suite 420, Topeka, Kansas 66612-1367. Mail one to Water Well Owner and retain one for your records. Telephone 785-296-5524.  
Visit us at <http://www.kdheks.gov/waterwell/index.html> KSA 82a-1212 Revised 7/10/2015

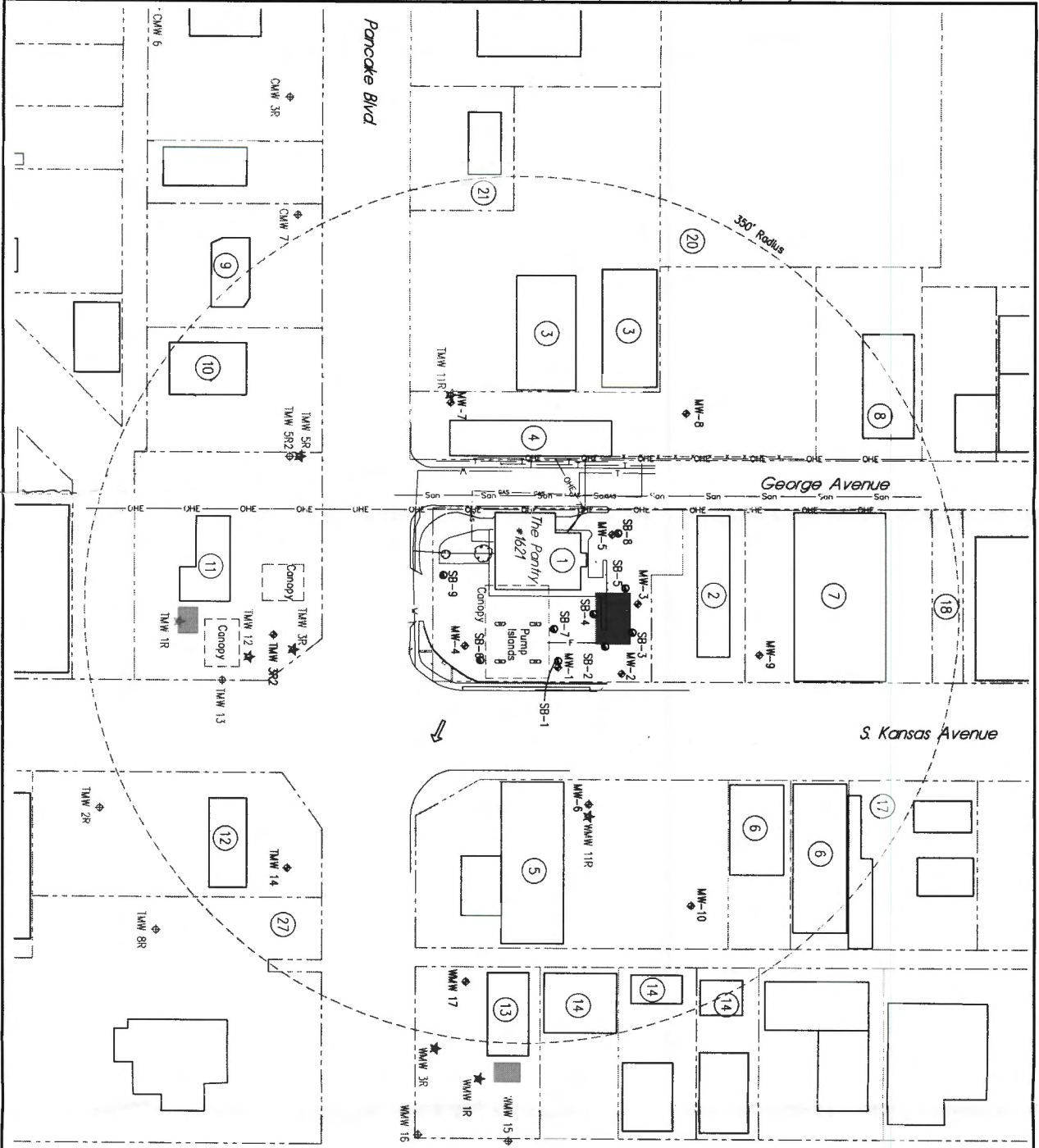

NOTE:  
 LOCATION OF SEWER LINE IS UNKNOWN ON SITE  
 LOCATION OF FUEL LINES IS ESTIMATED BASED ON WHERE CONCRETE IS CUT.  
 RESIDENTIAL PROPERTIES ARE NOTED WITH AN ASTERISK \*

LEGEND	
	MONITOR WELL
	SOIL BORING
	MONITORING WELL NOT SAMPLED
	FUEL LINES
	UNDERGROUND GAS
	UNDERGROUND ELECTRIC
	SANITARY SEWER
	TELEPHONE
	FENCE
	TANK BASIN
	APPROXIMATE ROW LINES
	GROUNDWATER FLOW DIRECTION

1. Circle K Stores, Inc. (The Pantry #1621 site)
2. Tron, Dao Anh; Ly, Hien Kim - Santa Fe Liquor
3. Liberal Society Lane Inc. - Liberal Society Lane
4. Liberal Society Lane Inc. - Kai Tunz
5. Almaraz, Adolfo & Lina - Camerillo
6. Cruz, Luz; Camerillo la Conso LLC - DKK Party Room
7. Sweet Cactus Properties LLC - unnamed commercial
8. Schindler, Rick - Reg's Muller
9. Rodriguez, Arnoldo & Mario H. - El Tule Auto Sales
10. Schindler, Rick; Madden, James Ronald Living Trust - Rick's Auto Sales
11. The Liberal Lube Center LLC - Premium Lube
12. Rottengrass Real Estate LLC - Subway
13. Weaver, Larry V. - unnamed commercial
14. Waco's Alignment & The LLC - Weaver's Alignment
15. RODO Builders LLC - Sammi H's Cafe
16. Pasa, Charles and Connie R ET TR - Aqua Shield & ABC Storage
17. Redburn-Campes, Eduardo - vacant commercial lot
18. Chedra, Emory R. & Jilison E. - Ramo's Auto Service
19. City of Liberal - vacant lot
20. Napolis, Delviano & Rita - Napolis Auto Sales
21. Dunham, GC Living Trust - Windtree Management
22. Garcia, Nestor & Martina \*
23. Richardson, Maurice & Dora - RR Auto Repair
24. Herr, Larry M. - Furniture Mart
25. Sherwin Williams Realty Holding Inc. - Sherwin Williams
26. McDonnells Real Estate Company - McDonnells
27. Chedra, Emory R. & Miriam E. - Tres Hermanos Tortilleria
28. Vitales, Margarita - La Herradura Restaurant
29. Smith, Ben W. - Vagueros Y Broncos Discoteo
30. Camerillo la Conso LLC - unnamed commercial
31. Mouton LLC - Super 7 Inn
32. Chacon, Francisco & Edmaria \*
33. Oringon, Robert Walter & Margaret Frances- Michelin Tire



**THE PANTRY #1621**  
**SITE BASE MAP - 350' RADIUS**  
 440 S. KANSAS AVE., LIBERAL, KANSAS - U1-088-14791

SCALE	AS SHOWN
PROJECT	LIB-21-01
DATE	AUGUST 2020
FIELD BOOK	LIB-21-01
DRAWN BY	BRUNO BR
CHECKED BY	BRUNO BR
SHEET	FIGURE 2.1

**MILCO**  
 Environmental  
 2000 S. 10th St.  
 Liberal, MO 67043