

County: Smith Fraction SW NE SW SW Sec. 22 T 3 S R 13 E (W)

CORRECTION(S) TO WATER WELL COMPLETION RECORD (WWC-5)

(to rectify lacking or incorrect information)

Owner: Smith County Highway Dept.

Location was listed as:

Location changed to:

Section-Township-Range: _____

Fraction (1/4 1/4 1/4): _____

Other changes: Initial statements: Latitude: 89.77328

Changed to: Latitude: 39.77328°

Comments: _____

Verification method: written & legal descriptions, city street map, corrected latitude & longitude and KGS' "LEO" conversion tool, and mapping tool & aerial photos on KGS website initials: DRJ date: 12/6/2016

Submitted by: Kansas Geological Survey, Data Resources Library, 1930 Constant Ave., Lawrence, KS 660473726

to: Kansas Dept of Health & Environment, Bureau of Water, 1000 SW Jackson, Suite 420, Topeka, KS 66612-1367.



**WILSON
& COMPANY**

1700 East Iron Avenue
Salina, Kansas 67401
P.O. Box 1640 67402-1640
785-827-0433
785-827-5949 Fax

Albuquerque
Colorado Springs
Denver
Fort Worth
Houston
Kansas City
Lenexa
Omaha
Pasadena
Phoenix
Rio Rancho
Salina
San Bernardino
San Diego
Wilson & Company
Latin America, LLC

1 September 2015

Kansas Department of Health and Environment
Bureau of Water - Geology Section
1000 S.W. Jackson, Suite 420
Topeka, Kansas 66612-1367

Re: Request for Waiver to Install Flush-mount Well
Smith County Hiway Department - KDHE-BER Voluntary Cleanup Site,
Smith Center, Smith County, Kansas

Bureau of Water:

On behalf of Smith County, Wilson and Company, Inc. requests a waiver to install one flush mounted well cover at the above-referenced site in Smith Center, Kansas. This monitoring well will be installed for the above referenced KDHE-VCPRP site.

The flush-mount design is required in order to limit the impact of the monitor well installation on the accessibility and use of the properties where the well is located.

The well, MW-26, will be installed by Environmental Priority Services, Inc. (KDHE water well driller license no. 604). The well will be registered with the owner (to be listed on the completed WWC-5 form), as follows:

Smith County Hiway Department
Attention: Mitch Fritz
218 South Grant St.
Smith Center, Kansas 66967

The location of the specified monitor well is shown on the attached map. The well is located in the SW $\frac{1}{4}$ of the SW $\frac{1}{4}$ of Section 22, Township 3 South, Range 13 West, Smith County. The address of the facility follows:

Smith County Road Department yard
318 E. Francis St.
Smith Center, Kansas 66967

The well will be completed as shown on the KDHE "Flush-Mount Well Construction Detail" diagram, dated 10 September 1993. The well cover will be encased in concrete, sloped to allow

RECEIVED

SEP 11 2015

BUREAU OF WATER

page 2.

drainage away from the steel cover. The well will be provided with a lockable water-tight cap, such as also shown on the KDHE "Flush-Mount Well Construction Detail" diagram.

The well will be grouted from a maximum of 1 ft below ground surface to within 2 ft of the well screen. The well TD will be 35 ft bgs. The lithology in the local area is clay and silt to approximately 25 ft bgs, underlain by weathered shale. Water is typically encountered at 18 ft bgs.

The KDHE approval letter will be included with the completed WWC-5 form to KDHE-BOW.

When the project is finished, the well will be plugged in accordance with KDHE regulations.

Please send a copy of the approved waiver to:

Robert Hopkins
Wilson & Co.
1700 E. Iron St.
Salina, Kansas 67401

If you have any questions, please contact me at 785-819-2460 at your convenience. Thank you for your help!

WILSON & COMPANY

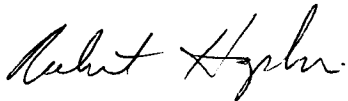

Robert Hopkins, L.G., C.P.G.
Geologist

cc: Tammy, Smith County Hiway Dept., Smith Center, Ks

enc.

SEP 11 2015

RECEIVED

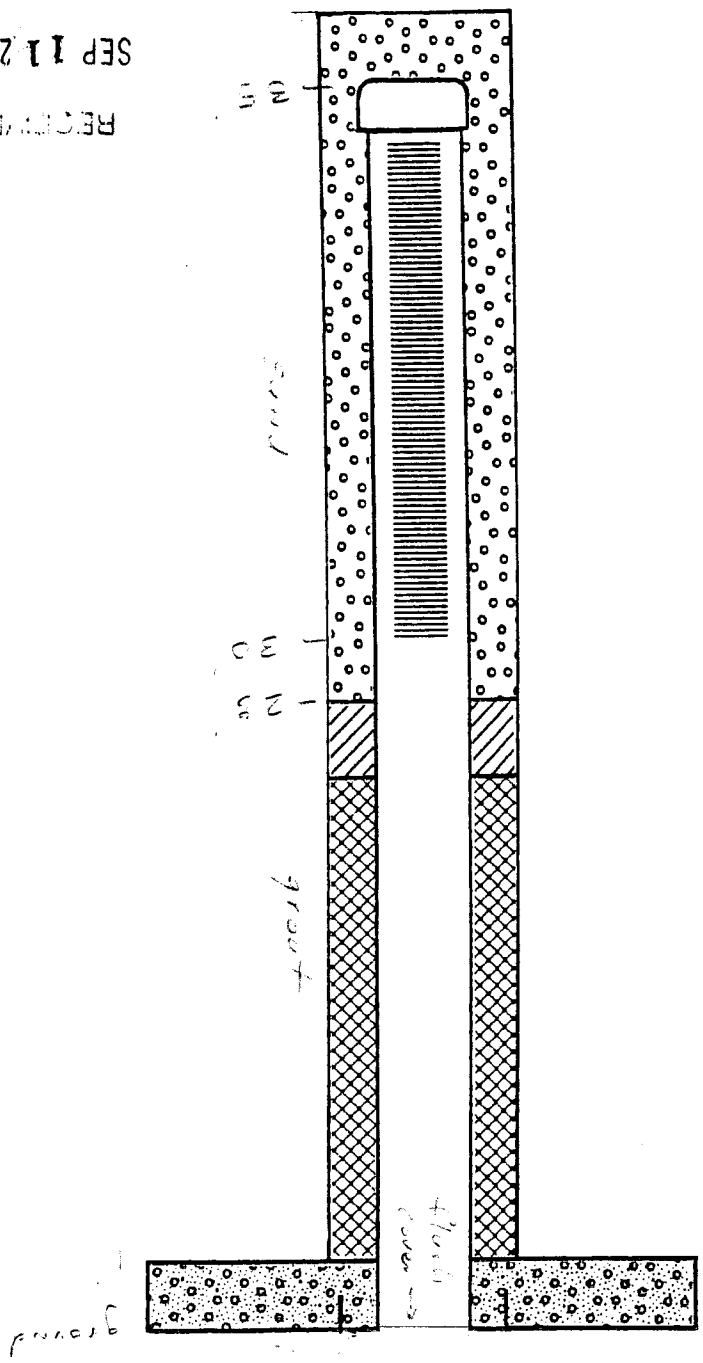

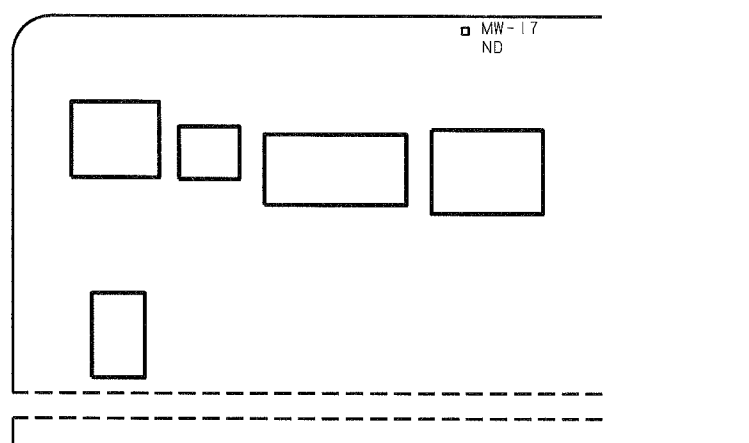
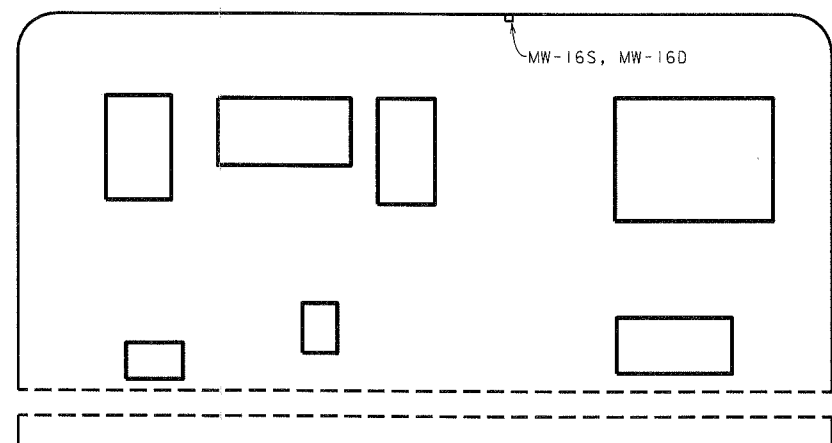
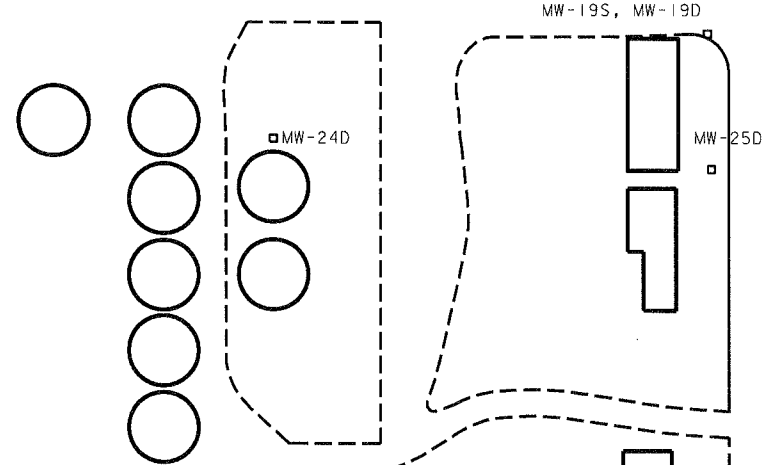
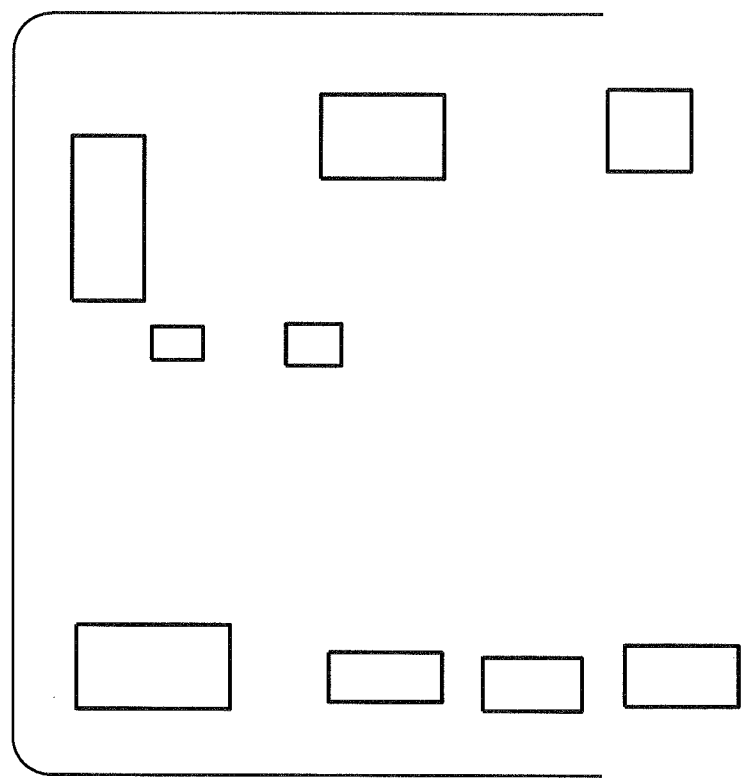
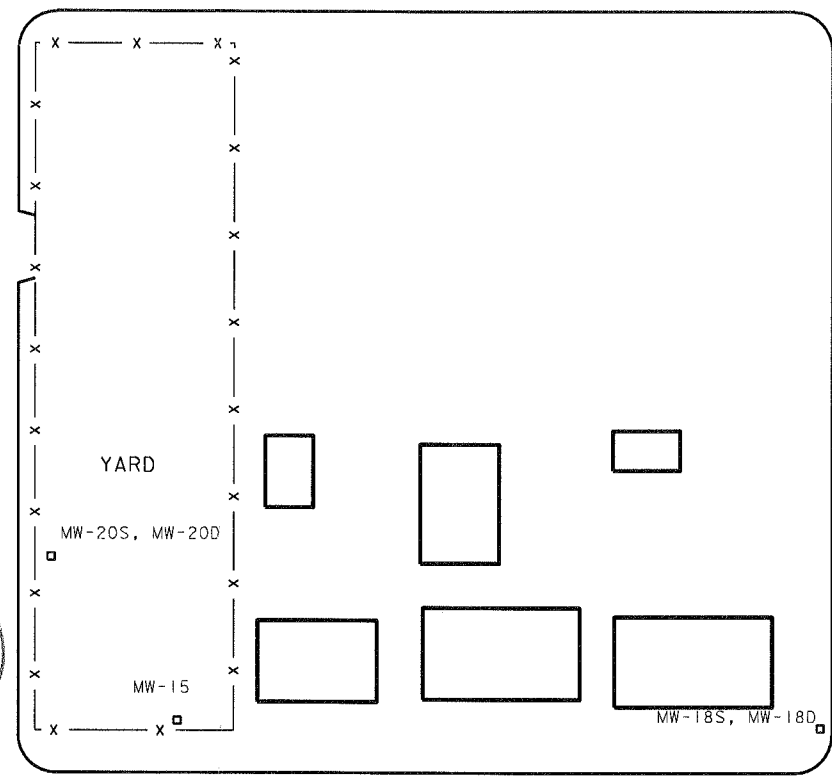
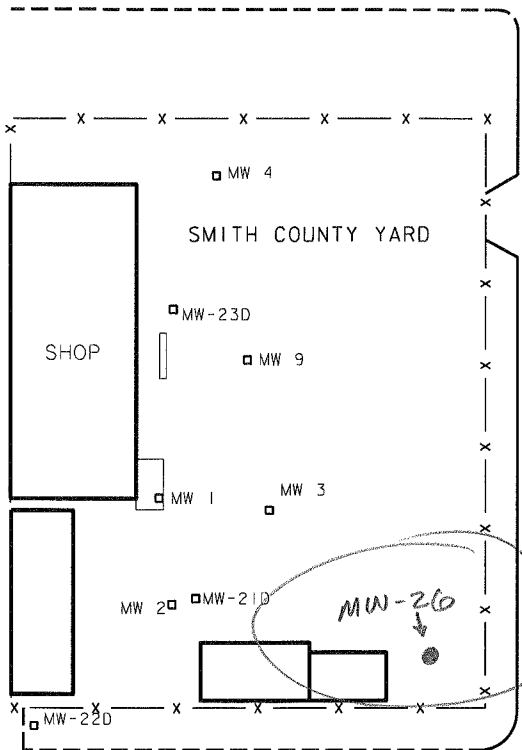
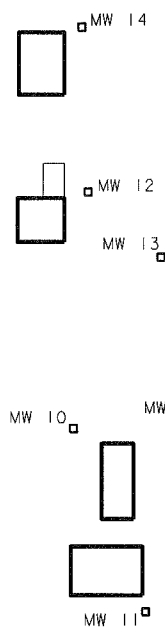
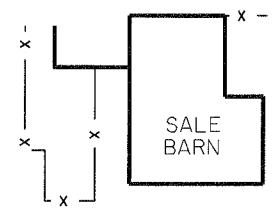
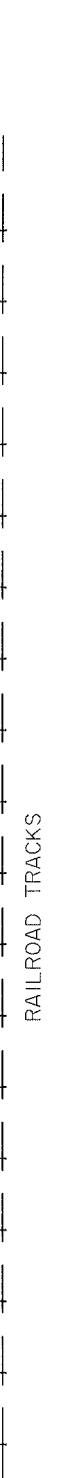
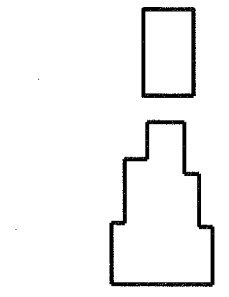
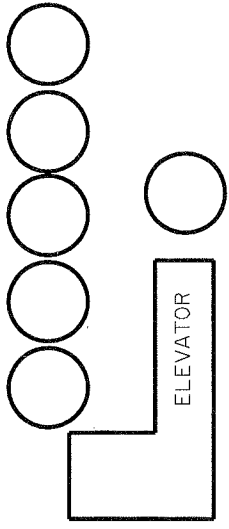
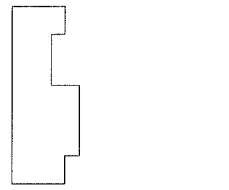

LEGEND

- PAVED ROAD
- UNPAVED ROADS
- FENCE
- BUILDING/TANK
- MONITORING WELL

RECEIVED
SEP 11 2015
BUREAU OF WATER

JEFFERSON ST.

FRANCIS ST.

PARLIAMENT ST.

GRANT ST.

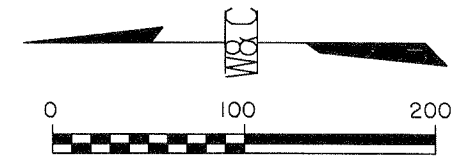

SCALE IN FEET
SCALE: 1" = 100'

ADDED PROPOSED MONITORING WELLS	7-2010	JWS
REVISION	DATE	BY

SMITH COUNTY
HIGHWAY DEPARTMENT
SMITH CENTER, KS

DESIGN RTH	DRAWN JWS	WILSON & COMPANY Engineers & Architects Salina, Kansas	DATE: 7/2015
			FILE NO. 08500030