

WATER WELL RECORD Form WWC-5

Division of Water Resources App. No.

[]

Well ID

MW3

Original Record Correction Change in Well Use

1 LOCATION OF WATER WELL: County: SMITH Fraction SW 1/4 SE 1/4 Section Number 15 Township Number T 03 S Range Number R 13 E W

2 WELL OWNER: Last Name: KDHE First: Address: 1000 SW JACKSON ST City: TOPEKA State: KS ZIP: 66612 Street or Rural Address where well is located: 616 E. HWY 36, SMITH CENTER, KS

3 LOCATE WELL WITH "X" IN SECTION BOX: [Diagram showing a 4-section grid with 'X' in the SW section]

4 DEPTH OF COMPLETED WELL: 30 ft. Depth(s) Groundwater Encountered: 1) 16 ft. 2) ... ft. 3) ... ft., or 4) Dry Well WELL'S STATIC WATER LEVEL: 18.83 ft. below land surface, measured on (mo-day-yr) 9/22/20 Pump test data: Well water was ... ft. after ... hours pumping ... gpm

5 Latitude: 39.78534 (decimal degrees) Longitude: 98.78083 (decimal degrees) Horizontal Datum: WGS 84 NAD 83 NAD 27 Source for Latitude/Longitude: GPS (unit make/model) Land Survey Topographic Map Online Mapper 6 Elevation: 1818.21 ft. Ground Level TOC Source: Land Survey GPS Topographic Map Other

7 WELL WATER TO BE USED AS: 1. Domestic: Household Lawn & Garden Livestock Irrigation Feedlot Industrial 2. Public Water Supply: well ID 3. Dewatering: how many wells? 4. Aquifer Recharge: well ID 5. Monitoring: well ID MW3 6. Environmental Remediation: well ID Air Sparge Soil Vapor Extraction Recovery Injection 7. Oil Field Water Supply: lease 8. Test Hole: well ID Cased Uncased Geotechnical 9. Geothermal: how many bores? a) Closed Loop Horizontal Vertical b) Open Loop Surface Discharge Inj. of Water 10. Other (specify):

Was a chemical/bacteriological sample submitted to KDHE? Yes No If yes, date sample was submitted: Water well disinfected? Yes No

8 TYPE OF CASING USED: Steel PVC Other CASING JOINTS: Glued Clamped Welded Threaded Casing diameter 2 in. to 30 ft., Diameter in. to ft., Diameter in. to ft. Casing height above land surface in. Weight lbs./ft. Wall thickness or gauge No. Sch. 40 TYPE OF SCREEN OR PERFORATION MATERIAL: Steel Stainless Steel Fiberglass PVC Other (Specify) Brass Galvanized Steel Concrete tile None used (open hole) SCREEN OR PERFORATION OPENINGS ARE: Continuous Slot Mill Slot Gauze Wrapped Torch Cut Drilled Holes Other (Specify) Louvered Shutter Key Punched Wire Wrapped Saw Cut None (Open Hole) SCREEN-PERFORATED INTERVALS: From 20 ft. to 30 ft., From ft. to ft., From ft. to ft. GRAVEL PACK INTERVALS: From 18 ft. to 30 ft., From ft. to ft., From ft. to ft.

9 GROUT MATERIAL: Neat cement Cement grout Bentonite Other CONCRETE 0-1 Grout Intervals: From 1 ft. to 18 ft., From ft. to ft., From ft. to ft.

Nearest source of possible contamination: Septic Tank Lateral Lines Pit Privy Livestock Pens Insecticide Storage Sewer Lines Cess Pool Sewage Lagoon Fuel Storage Abandoned Water Well Watertight Sewer Lines Seepage Pit Feedyard Fertilizer Storage Oil Well/Gas Well Other (Specify) Direction from well? West Distance from well? 1.322 ft.

Table with 6 columns: 10 FROM, TO, LITHOLOGIC LOG, FROM, TO, LITHO. LOG (cont.) or PLUGGING INTERVALS. Rows: 0-1 TOPSOIL, 1-30 Silty Clay (CL). Notes: U6-092-15171

11 CONTRACTOR'S OR LANDOWNER'S CERTIFICATION: This water well was constructed, reconstructed, or plugged under my jurisdiction and was completed on (mo-day-year) 9/8/20 and this record is true to the best of my knowledge and belief. Kansas Water Well Contractor's License No. 585 This Water Well Record was completed on (mo-day-year) 9/11/20 under the business name of ASSOCIATED ENVIRONMENTAL, INC. Signature [Signature]

PETERSON INDUSTRIES, INC.
618

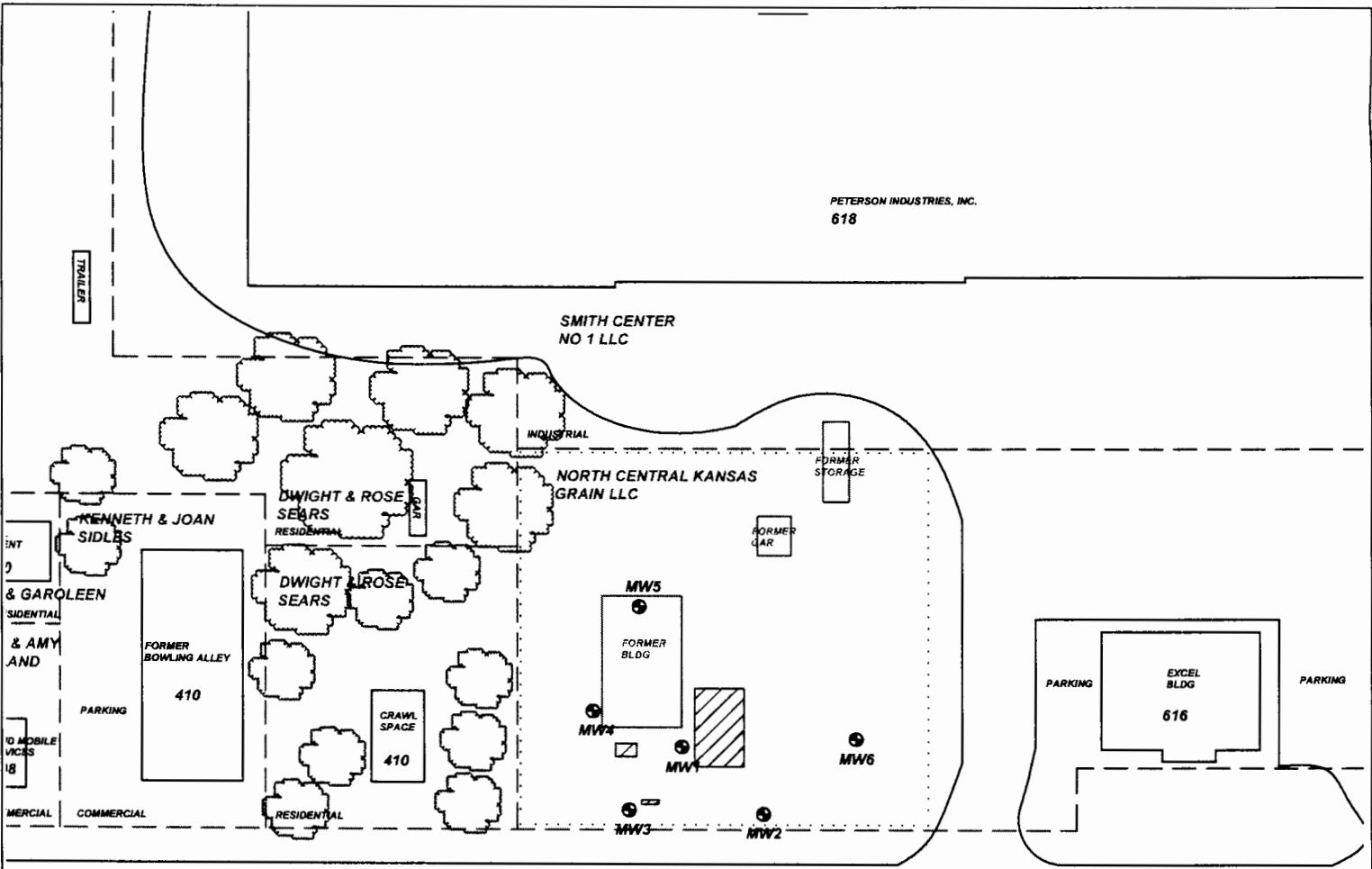

US HWY 36

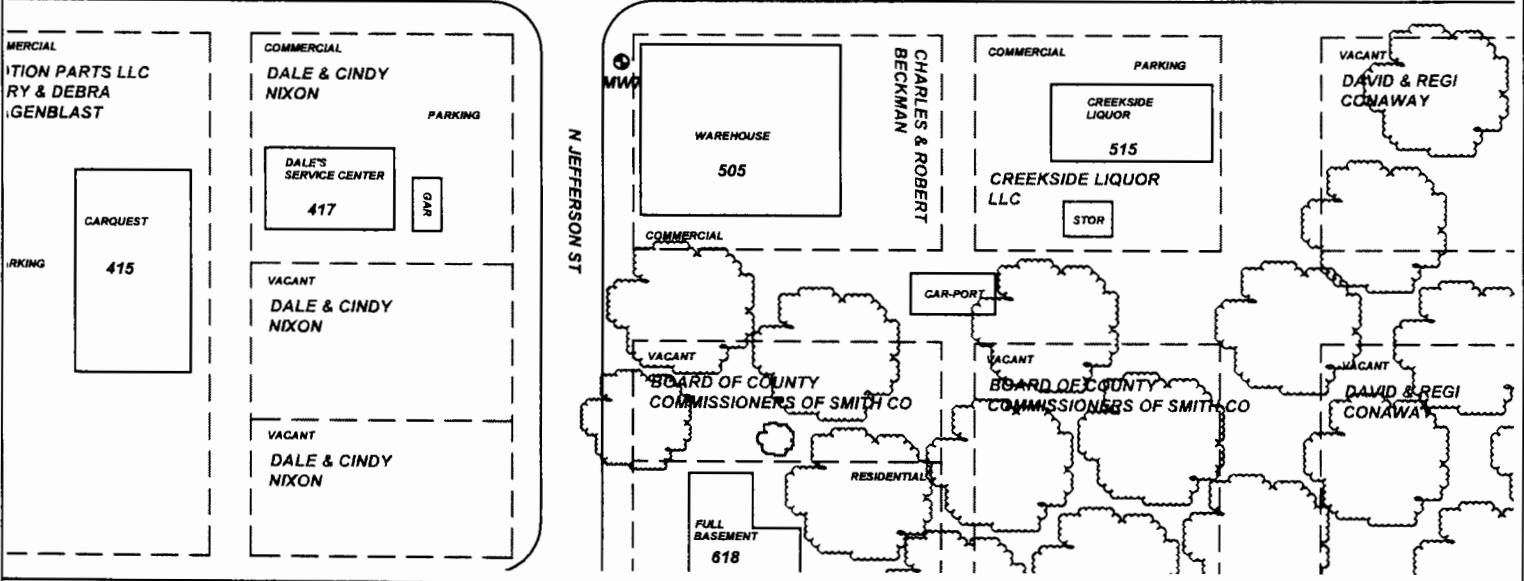

PROJECT: TRINITY AG, LLC
ADDRESS: 616 E. HWY 36
LOCATION: SMITH CENTER, KS
DRAWN BY: C. ROE **DATE:** 4/15/20
REVISED BY: C. ROE **DATE:** 1/14/21
AEI JOB #: TM251 **KDHE JOB #:** U6-092-15171

TITLE: **FIGURE 2.1**
AREA BASE MAP
350' RADIUS

ASSOCIATED ENVIRONMENTAL INC.

LEGEND:

- = FORMER USTS AND PUMP ISLAND
- = MONITORING WELL
- = SUBJECT PROPERTY
- = PARCEL BOUNDARY

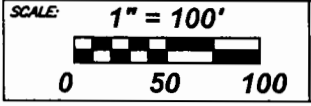

NOTES: