

| Well ID | Latitude | Longitude |
|---------|-----------|-----------|
| MW-8 | 39.75663N | 99.11516W |
| MW-9 | 39.75665N | 99.11378W |

NOTE:
 MW-9 IS LOCATED 387' EAST OF
 MW-8 AT THE NORTHWEST CORNER
 OF FRONTAGE ROAD & 6th STREET.

Main Street
 4th Street
 6th Street

FORMER SHAMROCK SERVICES
Highway 36

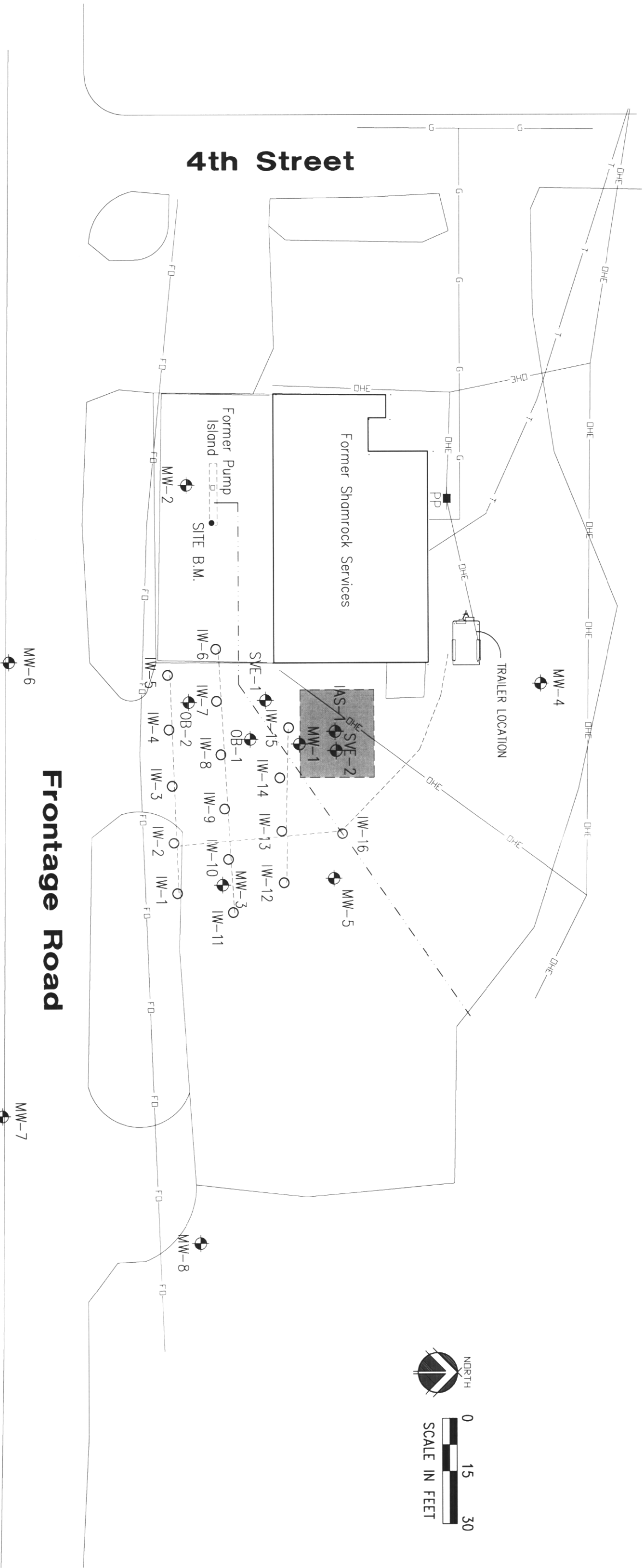

SITE BENCHMARK
 CHISLED SQUARE IN CONC. PUMP ISLAND
 ELEV. 1842.02

FORMER SHAMROCK SERVICES
SITE MAP
 AGRA, KANSAS

This document, and the ideas and designs incorporated herein, as an instrument of professional service, is the property of Miller & Associates and is not to be used in whole or in part, for any other project without the written authorization of Miller & Associates

MILCO
 Environmental
 Services, Inc.
 Kearney, NE (308) 237-9923
 McCook, NE (308) 345-4741

VERIFICATION SCALES
 BAR IS ONE INCH ON
 ORIGINAL DRAWING
 IF NOT ONE INCH ON THIS
 SHEET, VERIFY SCALES
 ACCORDINGLY.

SCALE: AS SHOWN

PROJECT NO. M287-P1-14

DATE: JUNE 2017

FIELD BOOK: M&A DWG NO. 82

DRAWN BY: APRVD BY:

SHEET: **FIGURE A**

| REVISIONS | BY |
|-----------|----|
| | |