

Corrected

WATER WELL RECORD

Form WWC-5

Division of Water Resources App. No.

IM-51

1 LOCATION OF WATER WELL: County: Phillips Fraction SW 1/4 SW 1/4 SW 1/4 NW 1/4 Section Number 26 Township No. T 3 S Range Number R 18 [] E [X] W

Street/Rural Address of Well Location; if unknown, distance & direction from nearest town or intersection: If at owner's address, check here []. Phillipsburg, KS Global Positioning System (GPS) information: Latitude: 39.763339 Longitude: 99.327463 Elevation: 1956.6

2 WATER WELL OWNER: Coffeville Resources Terminal RR#, Street Address, Box #: 1589 N Highway 183 City, State, ZIP Code : Phillipsburg, Kansas, 67661

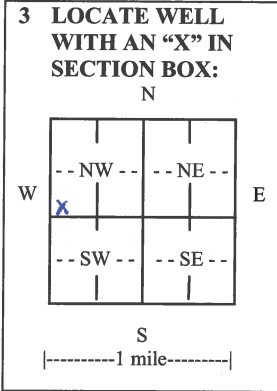

3 LOCATE WELL WITH AN 'X' IN SECTION BOX: 4 DEPTH OF COMPLETED WELL 57 ft. Depth(s) Groundwater Encountered (1) 52 ft. (2) ft. (3) ft. WELL'S STATIC WATER LEVEL 53 ft. below land surface measured on mo/day/yr. 9/25/2014

5 TYPE OF CASING USED: [] Steel [X] PVC [] Other CASING JOINTS: [] Glued [] Clamped [] Welded [X] Threaded Casing diameter 2 in. to 57 ft. Diameter in. to ft. Diameter in. to ft. Casing height above land surface 0 in., Weight lbs./ft., Wall thickness or gauge No. 40

6 GROUT MATERIAL: [] Neat cement [X] Cement grout [] Bentonite [] Other Grout Intervals: From 0 ft. to 40 ft. From ft. to ft. From ft. to ft. From ft. to ft.

Table with columns: FROM, TO, LITHOLOGIC LOG, FROM, TO, LITHO. LOG (cont.) or PLUGGING INTERVALS. Rows include soil, silt, sand, clay, shale.

7 CONTRACTOR'S OR LANDOWNER'S CERTIFICATION: This water well was [] constructed, [] reconstructed, or [] plugged under my jurisdiction and was completed on (mo/day/year) 09/25/2014

INSTRUCTIONS: Use typewriter or ball point pen. PLEASE PRESS FIRMLY and PRINT clearly. Please fill in blanks and check the correct answers. Send one copy to Kansas Department of Health and Environment, Bureau of Water, Geology Section, 1000 SW Jackson St., Suite 420, Topeka, Kansas 66612-1367.

Kimball, Greg

From: John McClure <jmclure@sunflower.com>
Sent: Thursday, February 05, 2015 9:47 AM
To: Kimball, Greg
Cc: John McClure
Subject: WWC-5 Corrections

Greg,

Please make the agreed on corrections to WWC-5 forms for IM-51 and IM-56 in Phillips County, Kansas, sign them for me as my agent and forward them to KDHE.

Thank You,

John McClure
DETECH, INC

Kansas License # 693