

**WATER WELL PLUGGING RECORD Form WWC-5P KSA 82a-1212 ID NO.**

GMW9

<b>1 LOCATION OF WATER WELL:</b> County: Phillips	Fraction NW ¼ NE ¼ NW ¼ NW ¼	Section Number 35	Township Number T 3 S	Range Number 18 <input type="checkbox"/> E <input checked="" type="checkbox"/> W
--	---------------------------------	----------------------	--------------------------	---

Street/Rural Address of Well Location; if unknown, distance & direction from nearest town or intersection: If at owner's address, check here

200 State Street, Phillipsburg

**Global Positioning Systems (GPS) information:**  
 Latitude: 39.75577 (in decimal degrees)  
 Longitude: 99.32576 (in decimal degrees)  
 Elevation: NA  
 Horizontal Datum  WGS84,  NAD83,  NAD27  
 Collection Method:

**2 WATER WELL OWNER:** KDHE (Gingerbread House Preschool)  
 RR#, St. Address, Box #: 6000 SW Jackson  
 City, State ZIP Code: Topeka, KS 66612

GPS unit (Make/model: \_\_\_\_\_)  
 Digital Map/Photo,  Topographic Map  Land Survey  
 Est. Accuracy:  <3 m,  3-5 m,  5-15 m,  >15 m

**3 MARK WELL'S LOCATION WITH AN "X" IN SECTION BOX:**

N	
X	
NW	NE
W	E
SW	SE
S	

**4 DEPTH OF WELL** 61.1 ft.

WELL'S STATIC WATER LEVEL NA ft

WELL WAS USED AS:

<input type="checkbox"/> Domestic	<input type="checkbox"/> Public Water Supply	<input type="checkbox"/> Dewatering
<input type="checkbox"/> Irrigation	<input type="checkbox"/> Oil Field Water Supply	<input checked="" type="checkbox"/> Monitoring
<input type="checkbox"/> Feedlot	<input type="checkbox"/> Domestic (Lawn & Garden)	<input type="checkbox"/> Injection Well
<input type="checkbox"/> Industrial	<input type="checkbox"/> Air Conditioning	<input type="checkbox"/> Other _____

Was a chemical/bacteriological sample submitted to Department? Yes  No

**5 TYPE OF BLANK CASING USED:**

<input type="checkbox"/> Steel	<input type="checkbox"/> RMP (SR)	<input type="checkbox"/> Wrought	<input type="checkbox"/> Fiberglass	<input type="checkbox"/> Other (Specific below)
<input checked="" type="checkbox"/> PVC	<input type="checkbox"/> ABS	<input type="checkbox"/> Asbestos-Cement	<input type="checkbox"/> Concrete Tile	_____

Blank casing diameter 2 in. Was casing pulled? Yes  No  If yes, how much 3'

Casing height above or below land surface NA in.

**6 GROUT PLUG MATERIAL:**  Neat cement  Cement grout  Bentonite  Other Concrete: 0-0.5; Soil: 0.5-3'

Grout Plug Intervals: From 3 ft to 61.1 ft, From \_\_\_\_\_ ft to \_\_\_\_\_ ft, From \_\_\_\_\_ ft to \_\_\_\_\_ ft.

What is the nearest source of possible contamination:

<input type="checkbox"/> Septic tank	<input type="checkbox"/> Seepage pit	<input type="checkbox"/> Fuel storage	<input type="checkbox"/> Other (specify below)
<input type="checkbox"/> Sewer lines	<input type="checkbox"/> Pit privy	<input type="checkbox"/> Fertilizer storage	_____
<input type="checkbox"/> Watertight sewer lines	<input type="checkbox"/> Sewage lagoon	<input type="checkbox"/> Insecticide storage	_____
<input type="checkbox"/> Lateral lines	<input type="checkbox"/> Feed yard	<input type="checkbox"/> Abandoned water well	Direction from well? _____
<input type="checkbox"/> Cess pool	<input type="checkbox"/> Livestock pens	<input type="checkbox"/> Oil well/Gas well	How many feet? _____

FROM	TO	PLUGGING MATERIALS	FROM	TO	PLUGGING MATERIALS
0	0.5	Concrete			
0.5	3	Soil			
3	61.1	Neat cement			
KDHE ID: Gingerbread House Preschool; U6-074-00720					

**7 CONTRACTOR'S OR LANDOWNER'S CERTIFICATION:** This water well was plugged under my jurisdiction and was completed on (mo/day/year) 9/19-20/22 and this record is true to the best of my knowledge and belief. Kansas Water Contractor's License No. 757. This Water Well Record was completed on (mo/day/year) 9/26/2022 under the business name of Larsen & Associates, Inc. By (signature) \_\_\_\_\_

Send one white copy to Kansas Department of Health & Environment, Geology Section, 1000 SW Jackson Street, Ste. 420, Topeka, KS 66612-1367. Send one copy to WATER WELL OWNER and retain one for your records  
 Visit us at <http://www.kdheks.gov/waterwell/index.html> Telephone 785-296-5524.

NOTE: Figures exhibited within this report are only to be used within the context of this report. Placement of property lines, wells, structures, and roads is based on the available information from county appraiser maps, surveys, site visits, and/or previous vendor reports and should be considered approximate.

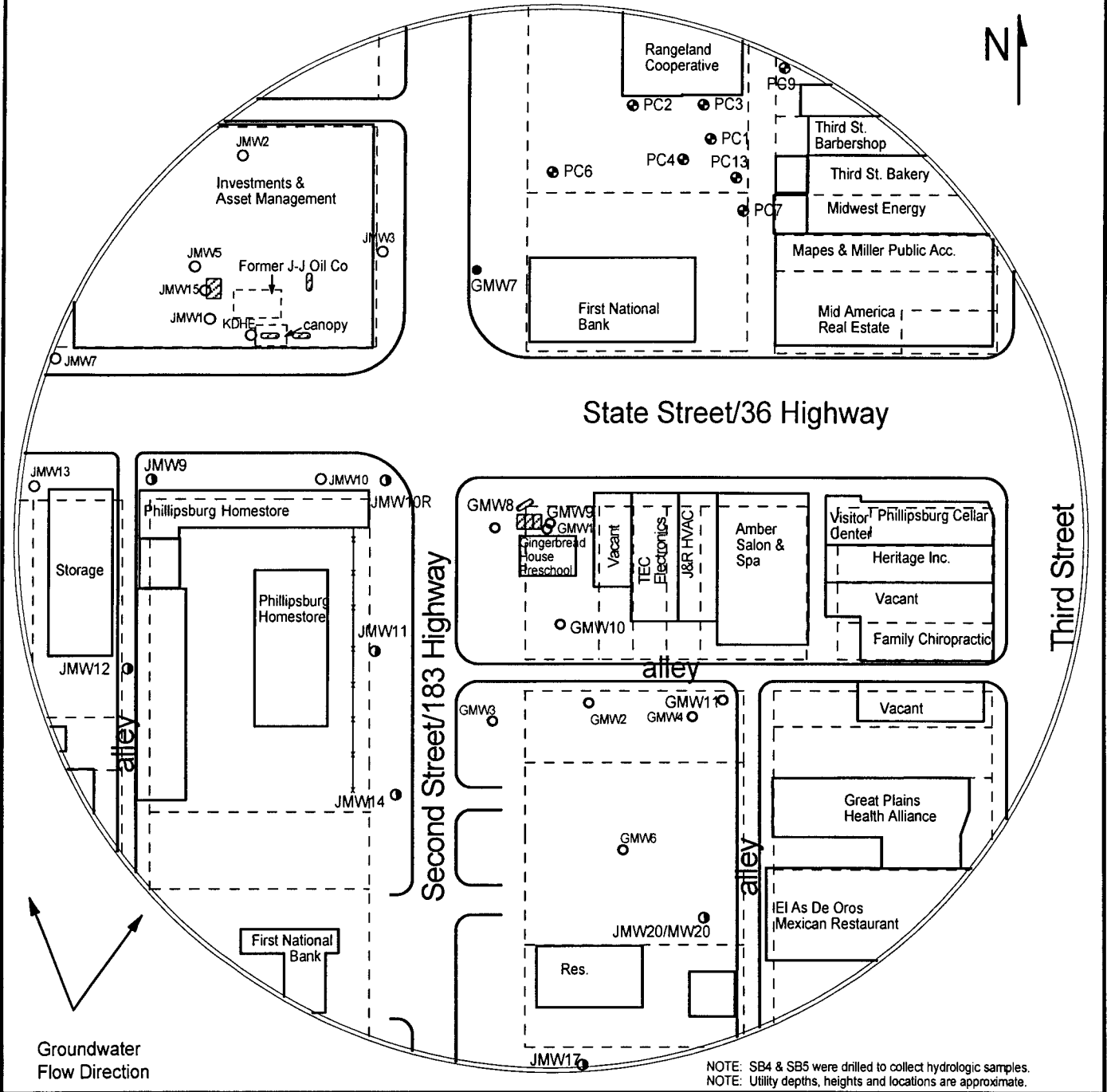

NOTE: SB4 & SB5 were drilled to collect hydrologic samples.  
NOTE: Utility depths, heights and locations are approximate.

FIGURE 1 - 350 FT RADIUS AREA BASE MAP



**PROJECT:**  
Gingerbread House Preschool  
200 State Street  
Phillipsburg, KS  
KDHE ID: U6-074-00720  
Date: 9/19-20/22

- LEGEND:**
- Approximate Location of Former UST Basin & Pump Island
  - Approximate Location of Property Line
  - Monitoring Well (Nearby site Phillips Coop Station U5-0074-00498)
  - Monitoring Well (J-J Oil U6-074-00607)
  - Existing Monitoring Well
  - Plugged Monitoring Well