

WATER WELL PLUGGING RECORD

Form WWC-5P

KSA 82a-1212

ID No.

MW-20

1 LOCATION OF WATER WELL: County: Phillips	Fraction NE ¼ NW ¼ NW ¼	Section Number 15	Township Number 3S	Range Number 19W
-----------------------------------------------	----------------------------	----------------------	-----------------------	---------------------

Distance and direction from nearest town or city street address of well if located within city?  
Main Street, Stuttgart, KS

2 WATER WELL OWNER: Stuttgart Oil Company  
RR#, St. Address, Box #  
City, State, ZIP Code : Stuttgart, KS 67670  
Board of Agriculture, Division of Water Resources  
Application Number:

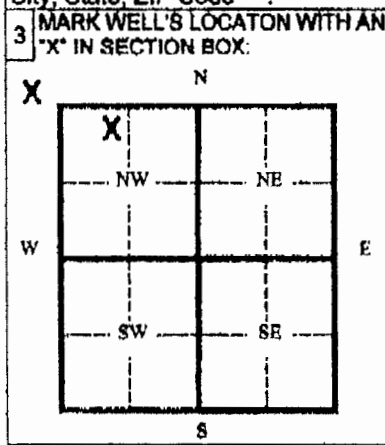

4 DEPTH OF WELL 30 ft.  
WELL'S STATIC WATER LEVEL dry ft.  
WELL WAS USED AS:  
1 Domestic 5 Public Water Supply 9 Dewatering  
2 Irrigation 8 Oil Field Water Supply 10 Monitoring Well  
3 Feedlot 7 Lawn and Garden (domestic) 11 Injection Well  
4 Industrial 8 Air Conditioning 12 Other \_\_\_\_\_  
Was a chemical/bacteriological sample submitted to Department? Yes \_\_\_ No \_\_\_  
If yes, mo/day/yr sample was submitted \_\_\_\_\_  
Water Well Disinfected: Yes \_\_\_ No \_\_\_

5 TYPE OF BLANK CASING USED:  
1 Steel 3 RMP (SR) 5 Wrought 7 Fiberglass 9 Other (specify below)  
2 PVC 4 ABC 6 Asbestos-Cement 8 Concrete Tile  
Blank casing diameter 2 in. Was casing pulled? Yes X No \_\_\_ If yes, how much removed 3 ft.  
Casing height above or below land surface -36 in.

6 GROUT PLUG MATERIAL: 1 Neat cement 2 Cement grout 3 Bentonite 4 Other \_\_\_\_\_  
Grout Plug Intervals From 0 ft. to 30 ft. From \_\_\_\_\_ ft. to \_\_\_\_\_ ft. From \_\_\_\_\_ ft. to \_\_\_\_\_ ft.  
What is the nearest source of possible contamination:  
1 Septic tank 6 Seepage pit 11 Fuel storage 15 Other (specify below)  
2 Sewer lines 7 Pit privy 12 Fertilizer storage  
3 Watertight sewer lines 8 Sewage lagoon 13 Insecticide storage  
4 Lateral lines 9 Feedyard 14 Abandoned water well  
5 Cess Pool 10 Livestock pens 15 Oil well/ Gas well  
Direction from well? \_\_\_\_\_ How many feet? \_\_\_\_\_

FROM	TO	CODE	PLUGGING MATERIALS
0	30		Bentonite grout

RECEIVED  
JAN 08 2009  
BUREAU OF WATER

7 CONTRACTOR'S OR LANDOWNER'S CERTIFICATION: This water well was plugged under my jurisdiction and was completed on (mo/day/yr) 10/9/08 and this record is true to the best of my knowledge and belief. Kansas Water Well Contractor's License No. 554 This Water Well Record was completed on (mo/day/yr) 10/22/08 under the business name of Bluestem Environmental Engineering, Inc. by (signature) *Nick Holt* *Jay C. Williams*

INSTRUCTIONS: Please fill in blanks and circle the correct answers. Send three copies to Kansas Department of Health and Environment, Bureau of Water, 1000 S W Jackson St., Ste. 420, Topeka, Kansas 66620-0001. Telephone: 785-298-3885. Send one to Water Well Owner and retain one for your records.