

WATER WELL RECORD

Form WWC-5

Division of Water Resources App. No.

1. LOCATION OF WATER WELL: Fraction 1/4 SE 1/4 SW 1/4 SW 1/4 Section Number 2 Township Number T 3 S Range Number R 25 E W
Street/Rural Address of Well Location: West of Clayton to Rd W 13, N 4 miles to Rd N, E 1 1/4 N on N side
WATER WELL OWNER: Matthew Stevenson
INSRR#, St. Address, Box # 4177 Rd N
City, State, ZIP Code Norton, Ks 67654
Global Positioning System (GPS) information: Latitude, Longitude, Elevation, Datum, Collection Method, Est. Accuracy

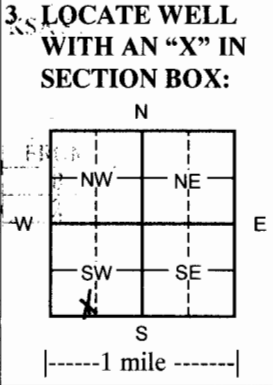

4. DEPTH OF COMPLETED WELL 210 ft.
Depth(s) Groundwater Encountered (1) 210 ft. (2) ft. (3) ft.
WELL'S STATIC WATER LEVEL 85 ft. below land surface measured on mo/day/yr
Pump test data: Well water was ft. after hours pumping gpm
EST. YIELD gpm: Well water was ft. after hours pumping gpm
WELL WATER TO BE USED AS: [X] Domestic [] Feedlot [] Oil field water supply [] Dewatering [] Other (Specify below)
Irrigation [] Industrial [] Domestic-lawn & garden [] Monitoring well
Was a chemical/bacteriological sample submitted to Department? [] Yes [X] No
If yes, mo/day/yr sample was submitted
Water Well Disinfected? [X] Yes [] No

5. TYPE OF CASING USED: [] Steel [X] PVC [] Other
CASING JOINTS: [X] Glued [] Clamped [] Welded [] Threaded
Casing diameter 4.5 in. to 170 ft., Diameter in. to ft., Diameter in. to ft.
Casing height above land surface 18 in., Weight 2.38 lbs./ft. Wall thickness or gauge No. 248
TYPE OF SCREEN OR PERFORATION MATERIAL: [] Steel [] Stainless Steel [X] PVC [] Other (Specify)
[] Brass [] Galvanized Steel [] None used (open hole)
SCREEN OR PERFORATION OPENINGS ARE: [] Continuous Slot [] Mill slot [] Gauze wrapped [] Torch cut [] Drilled holes [] None (open hole)
[] Louvered shutter [] Key punched [] Wire wrapped [X] Saw cut [] Other (specify)
SCREEN-PERFORATED INTERVALS: From 170 ft. to 210 ft., From ft. to ft.
GRAVEL PACK INTERVALS: From 20 ft. to 210 ft., From ft. to ft.
From ft. to ft., From ft. to ft.

6. GROUT MATERIAL: [] Neat cement Cement grout [X] Bentonite [] Other
Grout Intervals From 0 ft. to 20 ft. From ft. to ft. From ft. to ft.
What is the nearest source of possible contamination:
[] Septic tank [] Lateral lines [] Pit privy [] Livestock pens [] Insecticide storage [] Other (specify below)
[] Sewer lines [] Cesspool [] Sewage lagoon [] Fuel storage [X] Abandoned water well
[] Watertight sewer lines [] Seepage pit [] Feedyard [] Fertilizer storage [] Oil well/gas well
Direction from well SE Distance from well 25'

Table with 6 columns: FROM, TO, LITHOLOGIC LOG, FROM, TO, LITHO. LOG (cont.) or PLUGGING INTERVALS. Rows include Surface, Loess, Caliche & clay w/fine sand lenses, Yellow ochre, etc.

7. CONTRACTOR'S OR LANDOWNER'S CERTIFICATION: This water well was constructed, reconstructed, or [] plugged under my jurisdiction and was completed on (mo/day/year) 8-17-10 and this record is true to the best of my knowledge and belief.
Kansas Water Well Contractor's License No. 554 or 783. This Water Well Record was completed on (mo/day/year) 8-27-10 under the business name of Woofter Pump & Well Inc. by (signature)

INSTRUCTIONS: Please fill in blanks and check the correct answers. Send three copies (white, blue, pink) to Kansas Department of Health and Environment, Bureau of Water, Geology Section, 1000 SW Jackson St., Suite 420, Topeka, Kansas 66612-1367. Telephone 785-296-5522. Send one to WATER WELL OWNER and retain one for your records. Include fee of \$5.00 for each constructed well. Visit us at http://www.kdheks.gov/waterwell/index.html.