

WATER WELL RECORD Form WWC-5

Division of Water Resources App. No. [] Well ID []

Original Record Correction Change in Well Use

1 LOCATION OF WATER WELL: County: Decatur Fraction SW 1/4 SE 1/4 SE 1/4 Section Number 31 Township Number T3 S Range Number R20 E W

2 WELL OWNER: Last Name: Kelly First: DICK Street or Rural Address where well is located (if unknown, distance and direction from nearest town or intersection): If at owner's address, check here:
Business: 74 MLN
Address: Oberlin State: Ks ZIP: 67749

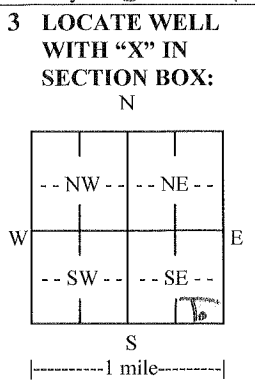

4 DEPTH OF COMPLETED WELL: 41 ft.
Depth(s) Groundwater Encountered: 1) 25 ft.
2) ft. 3) ft., or 4) Dry Well
WELL'S STATIC WATER LEVEL: 25 ft.
 below land surface, measured on (mo-day-yr).....
 above land surface, measured on (mo-day-yr).....
Pump test data: Well water was ft.
after..... hours pumping gpm
Well water was ft.
after..... hours pumping gpm
Estimated Yield: 10 gpm
Bore Hole Diameter: in. to ft. and
..... in. to ft.

5 Latitude: (decimal degrees)
Longitude: (decimal degrees)
Datum: WGS 84 NAD 83 NAD 27
Source for Latitude/Longitude:
 GPS (unit make/model:)
(WAAS enabled? Yes No)
 Land Survey Topographic Map
 Online Mapper:
6 Elevation: ft. Ground Level TOC
Source: Land Survey GPS Topographic Map
 Other

7 WELL WATER TO BE USED AS:
1. Domestic: Household Lawn & Garden Livestock
2. Irrigation
3. Feedlot
4. Industrial
5. Public Water Supply: well ID
6. Dewatering: how many wells?
7. Aquifer Recharge: well ID
8. Monitoring: well ID
9. Environmental Remediation: well ID
 Air Sparge Soil Vapor Extraction
 Recovery Injection
10. Oil Field Water Supply: lease
11. Test Hole: well ID
 Cased Uncased Geotechnical
12. Geothermal: how many bores?
a) Closed Loop Horizontal Vertical
b) Open Loop Surface Discharge Inj. of Water
13. Other (specify):

Was a chemical/bacteriological sample submitted to KDHE? Yes No If yes, date sample was submitted:
Water well disinfected? Yes No

8 TYPE OF CASING USED: Steel PVC Other CASING JOINTS: Glued Clamped Welded Threaded
Casing diameter 4 in. to 4 1/2 ft., Diameter in. to ft., Diameter in. to ft.
Casing height above land surface 12 in. Weight lbs./ft. Wall thickness or gauge No. 3.14
TYPE OF SCREEN OR PERFORATION MATERIAL:
 Steel Stainless Steel Fiberglass PVC Other (Specify)
 Brass Galvanized Steel Concrete tile None used (open hole)
SCREEN OR PERFORATION OPENINGS ARE:
 Continuous Slot Mill Slot Gauze Wrapped Torch Cut Drilled Holes Other (Specify)
 Louvered Shutter Key Punched Wire Wrapped Saw Cut None (Open Hole)
SCREEN-PERFORATED INTERVALS: From ft. to ft., From ft. to ft., From ft. to ft.
GRAVEL PACK INTERVALS: From ft. to ft., From ft. to ft., From ft. to ft.

9 GROUT MATERIAL: Neat cement Cement grout Bentonite Other
Grout Intervals: From 25 ft. to 40 ft., From ft. to ft., From ft. to ft.
Nearest source of possible contamination:
 Septic Tank Lateral Lines Pit Privy Livestock Pens Insecticide Storage
 Sewer Lines Cess Pool Sewage Lagoon Fuel Storage Abandoned Water Well
 Watertight Sewer Lines Seepage Pit Feedyard Fertilizer Storage Oil Well/Gas Well
 Other (Specify)
Direction from well? South Distance from well? 200' ft.

10 FROM	TO	LITHOLOGIC LOG	FROM	TO	LITHO. LOG (cont.) or PLUGGING INTERVALS
0	25	Top			
25	30	Clay			
30	36	SAND			
36	41	Fine SAND			
41		Shale			
Notes:					

11 CONTRACTOR'S OR LANDOWNER'S CERTIFICATION: This water well was constructed, reconstructed, or plugged under my jurisdiction and was completed on (mo-day-year) 12-27-14 and this record is true to the best of my knowledge and belief. Kansas Water Well Contractor's License No. 398 This Water Well Record was completed on (mo-day-year) 12-27-14 under the business name of Kelly Kelly Co.