

WATER WELL RECORD

Form WWC-5

Division of Water Resources App. No.

Empty box for application number

1 LOCATION OF WATER WELL: County: SMITH, Fraction NW 1/4 NE 1/4 1/4 1/4, Section Number 32, Township No. T 5 S, Range Number R 11 []E [X]W

Street/Rural Address of Well Location; if unknown, distance & direction from nearest town or intersection: If at owner's address, check here []. Global Positioning System (GPS) information: Latitude: (in decimal degrees), Longitude: (in decimal degrees), Elevation: Datum: [] WGS 84, [] NAD 83, [] NAD 27, Collection Method: [] GPS unit, [] Digital Map/Photo, [] Topographic Map, [] Land Survey, Est. Accuracy: [] <3 m, [] 3-5 m, [] 5-15 m, [] >15 m

2 WATER WELL OWNER: ALAN SCHWEITZER, RR#, Street Address, Box #: 30051 AA ROAD, City, State, ZIP Code: DOWNS, KS 67437

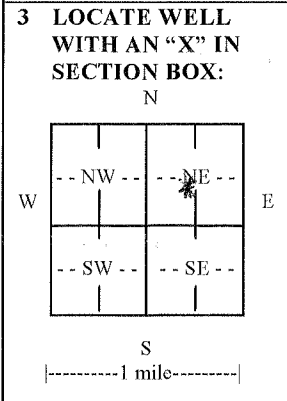

3 LOCATE WELL WITH AN "X" IN SECTION BOX: N, W, E, S. 4 DEPTH OF COMPLETED WELL: 20 ft. Depth(s) Groundwater Encountered (1)..... ft. (2)..... ft. (3)..... ft. WELL'S STATIC WATER LEVEL 3..... ft. below land surface measured on mo/day/yr. Pump test data: Well water was 5..... ft. after..... hours pumping, AIR. DVL. gpm, EST. YIELD. 30..... gpm. Well water was..... ft. after..... hours pumping..... gpm. Bore Hole Diameter 11.5..... in. to 20..... ft., and..... in. to..... ft. WELL WATER TO BE USED AS: [] Public water supply, [] Geothermal, [] Injection well, [X] Domestic, [] Feedlot, [] Oil field water supply, [] Dewatering, [] Other (Specify below), [] Irrigation, [] Industrial, [] Domestic-lawn & garden, [] Monitoring well. Was a chemical/bacteriological sample submitted to Department? [] Yes [X] No. If yes, mo/day/yr sample was submitted..... Water well disinfected? [X] Yes [] No

5 TYPE OF CASING USED: [] Steel [X] PVC [] Other. CASING JOINTS: [X] Glued [] Clamped [] Welded [] Threaded. Casing diameter 5..... in. to 5..... ft., Diameter 5..... in. to 20..... ft., Diameter..... in. to..... ft. Casing height above land surface 12..... in., Weight..... lbs./ft., Wall thickness or gauge No. 214. TYPE OF SCREEN OR PERFORATION MATERIAL: [] Steel [] Stainless Steel [X] PVC [] Other (Specify)..... [] Brass [] Galvanized Steel [] None used (open hole). SCREEN OR PERFORATION OPENINGS ARE: [] Continuous slot [] Mill slot [] Gauze wrapped [] Torch cut [] Drilled holes [] None (open hole), [] Louvered shutter [] Key punched [] Wire wrapped [X] Saw cut [] Other (specify)..... SCREEN-PERFORATED INTERVALS: From 5..... ft. to 15..... ft., From..... ft. to..... ft., From..... ft. to..... ft. GRAVEL PACK INTERVALS: From 5..... ft. to 20..... ft., From..... ft. to..... ft., From..... ft. to..... ft.

6 GROUT MATERIAL: [] Neat cement [] Cement grout [X] Bentonite [] Other. Grout Intervals: From 0..... ft. to 5..... ft., From..... ft. to..... ft., From..... ft. to..... ft. What is the nearest source of possible contamination: [] Septic tank [] Lateral lines [] Pit privy [] Livestock pens [] Insecticide storage [] Other (specify below), [] Sewer lines [] Cesspool [] Sewage lagoon [] Fuel storage [] Abandoned water well, [] Watertight sewer lines [] Seepage pit [] Feedyard [] Fertilizer storage [] Oil well/gas well NONE. Direction from well..... Distance from well.....

Table with columns: FROM, TO, LITHOLOGIC LOG, FROM, TO, LITHO. LOG (cont.) or PLUGGING INTERVALS. Rows: 0-4 TAN CLAY, 4-12 BROKEN LIMESTONE, 12-20 GRAY SHALE.

7 CONTRACTOR'S OR LANDOWNER'S CERTIFICATION: This water well was [X] constructed, [] reconstructed, or [] plugged under my jurisdiction and was completed on (mo/day/year) 08/17/2011..... and this record is true to the best of my knowledge and belief. Kansas Water Well Contractor's License No. 741..... This Water Well Record was completed on (mo/day/year) 08/21/2011..... under the business name of WATSON WELL DRILLING, INC. by (signature) [Signature]

INSTRUCTIONS: Use typewriter or ball point pen. PLEASE PRESS FIRMLY and PRINT clearly. Please fill in blanks and check the correct answers. Send three copies (white, blue, pink) to Kansas Department of Health and Environment, Bureau of Water, Geology Section, 1000 SW Jackson St., Suite 420, Topeka, Kansas 66612-1367. Telephone 785-296-5522. Send one copy to WATER WELL OWNER and retain one for your records. Include fee of \$5.00 for each constructed well. Visit us at http://www.kdheks.gov/waterwell/index.html.