

CORRECTION(S) TO WATER WELL RECORD (WWC-5)
(to rectify lacking or incorrect information)

Location listed as:

Section-Township-Range: 1-55-4 W

Fraction (1/4 1/4 1/4): SE SW SW SE

County: Smith

Location changed to:

1-55-14 W

SE SW SW SE

Other changes: Initial statements: _____

Changed to: _____

Comments: _____

verification method: Latitude & longitude, KGS' "LEO" conversion tool,
wellsite address, city street map, and mapping tool &
aerial photos on KGS website. initials: DR date: 3/8/2012

submitted by: Kansas Geological Survey, Data Resources Library, 1930 Constant Ave., Lawrence, KS 66047-3726
to: Kansas Dept of Health & Environment, Bureau of Water, 1000 SW Jackson, Suite 420, Topeka, KS 66612-1367.

WATER WELL RECORD

Form WWC-5

Division of Water Resources App. No.

1 LOCATION OF WATER WELL: Fraction SE 1/4 SW 1/4 SW 1/4 SE 1/4 Section Number 1 Township No. T 5 S Range Number R 4 E W
 County: Smith
 Street/Rural Address of Well Location; if unknown, distance & direction from nearest town or intersection: If at owner's address, check here
 325 S. 7th St.
 Gaylord, KS 67638

2 WATER WELL OWNER: Boettcher Enterprises
 RR#, Street Address, Box #: PO Box 486
 City, State, ZIP Code : Beloit, KS 67420

Global Positioning System (GPS) information:
 Latitude: .39° 38' 27.8"..... (in decimal degrees)
 Longitude: 098° 50' 55.89"..... (in decimal degrees)
 Elevation:
 Datum: WGS 84, NAD 83, NAD 27
 Collection Method:
 GPS unit (Make/Model: Garmin.....)
 Digital Map/Photo, Topographic Map, Land Survey
 Est. Accuracy: <3 m, 3-5 m, 5-15 m, >15 m

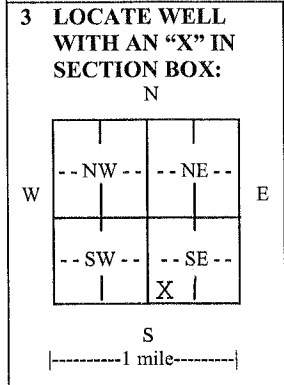

4 DEPTH OF COMPLETED WELL 30..... ft.
 Depth(s) Groundwater Encountered (1).20..... ft. (2)..... ft. (3)..... ft.
 WELL'S STATIC WATER LEVEL.23.....ft. below land surface measured on mo/day/yr. 04/21/09.....
 Pump test data: Well water was.....ft. after..... hours pumping..... gpm
 EST. YIELD.....gpm. Well water was.....ft. after..... hours pumping..... gpm
 Bore Hole Diameter ...7.....in. to 30.....ft., andin. toft.
 WELL WATER TO BE USED AS: Public water supply Geothermal Injection well
 Domestic Feedlot Oil field water supply Dewatering Other (Specify below)
 Irrigation Industrial Domestic-lawn & garden Monitoring well MW-9S
 Was a chemical/bacteriological sample submitted to Department? Yes No
 If yes, mo/day/yr sample was submitted.....
 Water well disinfected? Yes No

5 TYPE OF CASING USED: Steel PVC Other
CASING JOINTS: Glued Clamped Welded Threaded
 Casing diameter .2..... in. to .20..... ft., Diameter in. to ft.
 Casing height above land surface..0..... in., Weightlbs./ft., Wall thickness or gauge No. ...29".....
TYPE OF SCREEN OR PERFORATION MATERIAL:
 Steel Stainless Steel PVC Other (Specify)
 Brass Galvanized Steel None used (open hole)
SCREEN OR PERFORATION OPENINGS ARE:
 Continuous slot Mill slot Gauze wrapped Torch cut Drilled holes None (open hole)
 Louvered shutter Key punched Wire wrapped Saw cut Other (specify)
SCREEN-PERFORATED INTERVALS: From...20..... ft. to ...30..... ft., From ft. to ft.
 From ft. to ft., From ft. to ft.
GRAVEL PACK INTERVALS: From...18..... ft. to ...30..... ft., From ft. to ft.
 From ft. to ft., From ft. to ft.

6 GROUT MATERIAL: Neat cement Cement grout Bentonite Other
 Grout Intervals: From .0..... ft. to .18..... ft., From ft. to ft., From ft. to ft.
 What is the nearest source of possible contamination:
 Septic tank Lateral lines Pit privy Livestock pens Insecticide storage Other (specify below)
 Sewer lines Cesspool Sewage lagoon Fuel storage Abandoned water well
 Watertight sewer lines Seepage pit Feedyard Fertilizer storage Oil well/gas well
 Direction from well southwest Distance from well .400'.....

FROM	TO	LITHOLOGIC LOG	FROM	TO	LITHO. LOG (cont.) or PLUGGING INTERVALS
0	20	Topsoil and sandy silty clay			
20	21	Clay			
21	31	Fine and meidum sand			
31	40	Clay			

CORRECTED

7 CONTRACTOR'S OR LANDOWNER'S CERTIFICATION: This water well was constructed, reconstructed, or plugged under my jurisdiction and was completed on (mo/day/year) .12/08/2011.... and this record is true to the best of my knowledge and belief. Kansas Water Well Contractor's License No. .755..... This Water Well Record was completed on (mo/day/year) 01/24/2012..... under the business name of ..Sargent Drilling..... by (signature).....

INSTRUCTIONS: Use typewriter or ball point pen. PLEASE PRESS FIRMLY and PRINT clearly. Please fill in blanks and check the correct answers. Send three copies (white, blue, pink) to Kansas Department of Health and Environment, Bureau of Water, Geology Section, 1000 SW Jackson St., Suite 420, Topeka, Kansas 66612-1367. Telephone 785-296-5524. Send one copy to WATER WELL OWNER and retain one for your records. Include fee of \$5.00 for each constructed well. Visit us at <http://www.kdheks.gov/waterwell/index.html>.