

WATER WELL RECORD

Form WWC-5

Division of Water Resources; App. No. _____

1 LOCATION OF WATER WELL: Fraction **NW ¼ NE ¼ SE ¼** Section Number **11** Township Number **T 5 S** Range Number **R 14 E**
 County: **Nemaha**
 Distance and direction from nearest town or city street address of well if located within city? **316 1st St., Wetmore KS** **Global Positioning System** (decimal degrees, min. of 4 digits)
 Latitude: _____
 Longitude: _____
 Elevation: _____
 Datum: _____
 Data Collection Method: _____

2 WATER WELL OWNER: KDHE
 RR#, St. Address, Box # : **1000 SW Jackson Blvd**
 City, State, ZIP Code : **Topeka KS 66612**

3 LOCATE WELL'S LOCATON WITH AN "X" IN SECTION BOX:

N	
NW	NE
W	X
SW	SE
S	

4 DEPTH OF COMPLETED WELL 15.5 ft.
MW7
 Depth(s) Groundwater Encountered 1 _____ ft. 2 _____ ft. 3 _____ ft.
 WELL'S STATIC WATER LEVEL _____ ft. below land surface measured on mo/day/yr
 Pump test data: Well water was _____ ft. after _____ hours pumping _____ gpm
 Est. Yield _____ gpm: Well water was _____ ft. after _____ hours pumping _____ gpm
 WELL WATER TO BE USED AS: 5 Public water supply 8 Air conditioning 11 Injection well
 1 Domestic 3 Feed lot 6 Oil field water supply 9 Dewatering 12 Other (Specify below)
 2 Irrigation 4 Industrial 7 Domestic (lawn & garden) **10 Monitoring well**
 Was a chemical/bacteriological sample submitted to Department? Yes _____ No **X**; If yes, mo/day/yr
 Sample was submitted _____ Water Well Disinfected? Yes _____ No **X**

5 TYPE OF CASING USED: 5 Wrought Iron 8 Concrete tile CASING JOINTS: Glued _____ Clamped _____
 1 Steel 3 RMP (SR) 6 Asbestos-Cement 9 Other (specify below) Welded _____
2 PVC 4 ABS 7 Fiberglass Threaded **X**
 Blank casing diameter **2** in. to **3.5** ft., Dia _____ in. to _____ ft., Dia _____ in. to _____ ft.
 Casing height below land surface _____ ft., Weight _____ lbs./ft. Wall thickness or gauge No. _____

TYPE OF SCREEN OR PERFORATION MATERIAL:
 1 Steel 3 Stainless steel 5 Fiberglass **7 PVC** 9 ABS 11 Other (specify) _____
 2 Brass 4 Galvanized steel 6 Concrete tile 8 RM (SR) 10 Asbestos-Cement 12 None used (open hole)
SCREEN OR PERFORATION OPENINGS ARE:
 1 Continuous slot **3 Mill slot** 5 Gauze wrapped 7 Torch cut 9 Drilled holes 11 None (open hole)
 2 Louvered shutter 4 Key punched 6 Wire wrapped 8 Saw Cut 10 Other (specify) _____
SCREEN-PERFORATED INTERVALS: From **3.5** ft. to **15.5** ft. From _____ ft. to _____ ft.
 From _____ ft. to _____ ft. From _____ ft. to _____ ft.
GRAVEL PACK INTERVALS: From **2** ft. to **15.8** ft. From _____ ft. to _____ ft.
 From _____ ft. to _____ ft. From _____ ft. to _____ ft.

6 GROUT MATERIAL: 1 Neat cement 2 Cement grout **3 Bentonite** **4 Other Concrete: 0-1'**
 Grout Intervals From **1** ft. to **2** ft. From _____ ft. to _____ ft. From _____ ft. to _____ ft.
 What is the nearest source of possible contamination:
 1 Septic tank 4 Lateral lines 7 Pit privy 10 Livestock pens 13 Insecticide Storage 16 Other (specify below)
 2 Sewer lines 5 Cess pool 8 Sewage lagoon **11 Fuel storage** 14 Abandoned water well
 3 Watertight sewer lines 6 Seepage pit 9 Feedyard 12 Fertilizer storage 15 Oil well/ gas well
 Direction from well? **W** How many feet? **~160'**

FROM	TO	LITHOLOGIC LOG	FROM	TO	PLUGGING INTERVALS
0	15.8	Grass on top; Brown silty clay			

7 CONTRACTOR'S OR LANDOWNER'S CERTIFICATION: This water well was **1** constructed, **2** reconstructed, or **3** plugged under my jurisdiction and was completed on (mo/day/year) **6/18/14** and this record is true to the best of my knowledge and belief.
 Kansas Water Well Contractor's License No. **757**. This Water Well Record was completed on (mo/day/year) **7/16/14**
 under the business name of **Larsen & Associates, Inc.** by (signature) _____

INSTRUCTIONS: Please fill in blanks or circle the correct answers. Send top three copies to Kansas Department of Health and Environment, Bureau of Water, Geology Section, 1000 SW Jackson St., Suite 420, Topeka, Kansas 66612-1367. Telephone 785-296-5522. Send one to WATER WELL OWNER and retain one for your records. Fee of \$5.00 for each constructed well. Visit us at <http://www.kdheks.gov/waterwell>.

Wetmore

11-5-14E

~~VCS 088~~

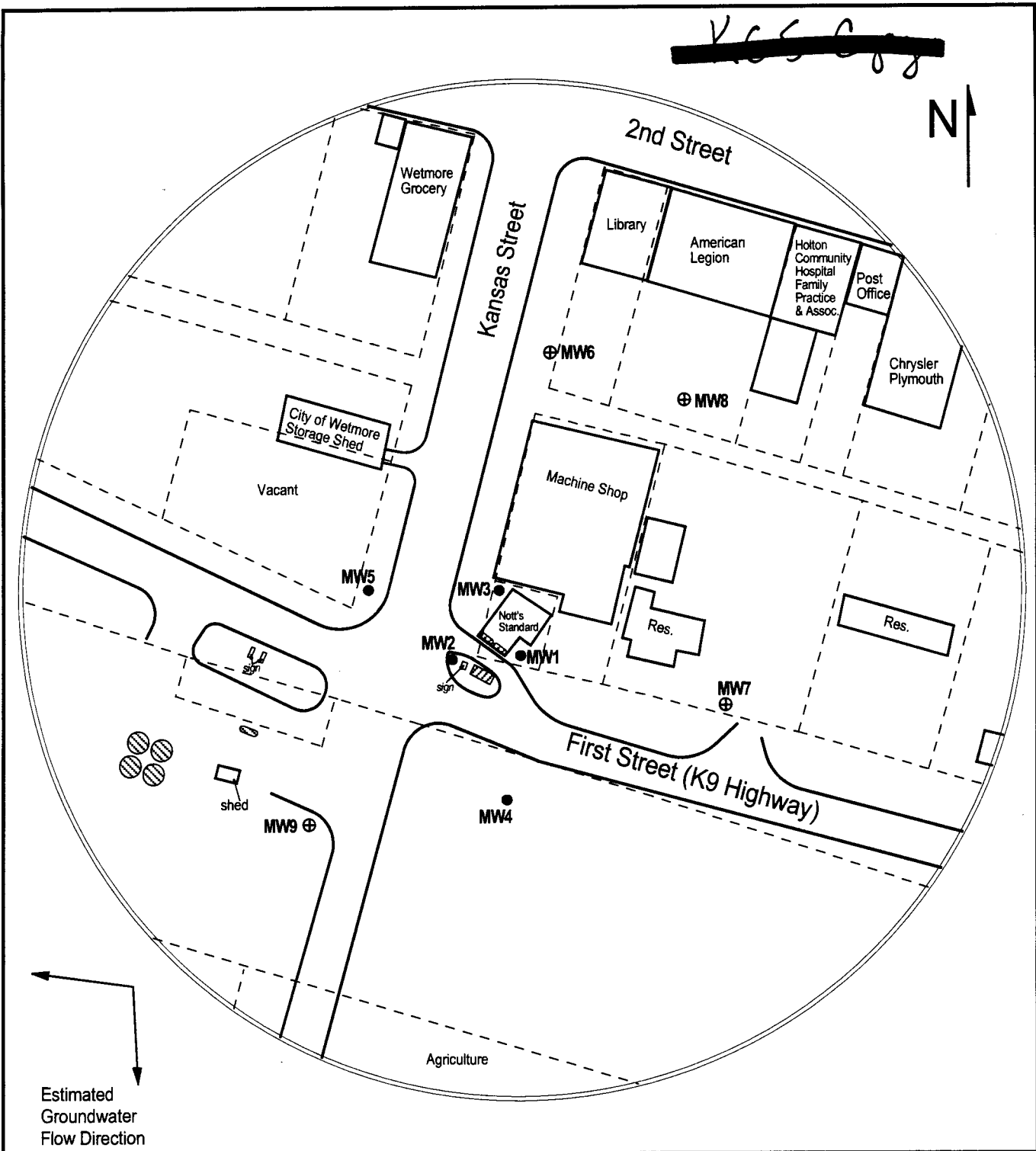

Estimated Groundwater Flow Direction

LEGEND:

- Approximate Location of Former UST Basin
- Approximate Location of Active AST and Pump Island
- Approximate Location of Property Line
- Monitoring Well
- Monitoring Well (Installed 3/4/14)



PROJECT:
 Nott's Standard
 1st & Kansas Ave
 Wetmore, KS
 KDHE ID: U4-066-12294
 Date: 3/4/14

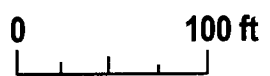

1311 E 25th St., Suite B (785) 841-8707 office
 Lawrence, KS 66046 (785) 865-4282 fax

NOTE: Approximate location of active and former product lines are unknown.
 NOTE: Monitoring wells have not been formerly surveyed by a licensed surveyor.
 The top of casing elevation is based on an onsite benchmark.