

WATER WELL RECORD

Form WWC-5

Division of Water Resources App. No.

1 LOCATION OF WATER WELL:	Fraction County: Rawlins $\frac{1}{4}$ SE $\frac{1}{4}$ SE $\frac{1}{4}$ NW $\frac{1}{4}$	Section Number 33	Township Number T 5 S	Range Number R 31 <input type="checkbox"/> E <input checked="" type="checkbox"/> W
----------------------------------	--	-----------------------------	---------------------------------	--

Street/Rural Address of Well Location; if unknown, distance & direction from nearest town or intersection: If at owner's address, check here .

Global Positioning System (GPS) information:
 Latitude: N 39 34.617 (in decimal degrees)
 Longitude: W 100 48.409 (in decimal degrees)
 Elevation: 2950
 Datum: WGS 84, NAD 83, NAD 27
 Collection Method:
 GPS unit (Make/Model: _____)
 Digital Map/Photo, Topographic Map, Land Survey
 Est. Accuracy: <3 m, 3-5 m, 5-15 m, >15 m

2 WATER WELL OWNER: **Pat Ryan**
 RR#, St. Address, Box # : 31067 Rd B25
 City, State, ZIP Code : Gem. KS 67734

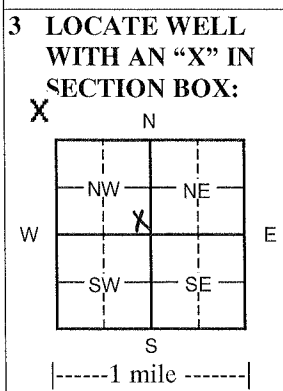

4 DEPTH OF COMPLETED WELL 140 ft.

Depth(s) Groundwater Encountered (1) _____ ft. (2) _____ ft. (3) _____ ft.

WELL'S STATIC WATER LEVEL _____ ft. below land surface measured on mo/day/yr _____

Pump test data: Well water was _____ ft. after _____ hours pumping _____ gpm

EST. YIELD _____ gpm: Well water was _____ ft. after _____ hours pumping _____ gpm

WELL WATER TO BE USED AS: Public water supply Geothermal Injection well
 Domestic Feedlot Oil field water supply Dewatering Other (Specify below)
 Irrigation Industrial Domestic-lawn & garden Monitoring well

Was a chemical/bacteriological sample submitted to Department? Yes No
 If yes, mo/day/yr sample was submitted _____
 Water Well Disinfected? Yes No

5 TYPE OF CASING USED: Steel PVC Other _____

CASING JOINTS: Glued Clamped Welded Threaded

Casing diameter 5 in. to 100 ft., Diameter _____ in. to _____ ft., Diameter _____ in. to _____ ft.
 Casing height above land surface 18 in., Weight 2.355 lbs./ft. Wall thickness or gauge No. .214

TYPE OF SCREEN OR PERFORATION MATERIAL:
 Steel Stainless Steel PVC Other (Specify) _____
 Brass Galvanized Steel None used (open hole)

SCREEN OR PERFORATION OPENINGS ARE:
 Continuous Slot Mill slot Gauze wrapped Torch cut Drilled holes None (open hole)
 Louvered shutter Key punched Wire wrapped Saw cut Other (specify) _____

SCREEN-PERFORATED INTERVALS:
 From 100 ft. to 140 ft., From _____ ft. to _____ ft.
 From _____ ft. to _____ ft., From _____ ft. to _____ ft.

GRAVEL PACK INTERVALS:
 From 20 ft. to 140 ft., From _____ ft. to _____ ft.
 From _____ ft. to _____ ft., From _____ ft. to _____ ft.

6 GROUT MATERIAL: Neat cement Cement grout Bentonite Other _____

Grout Intervals From 0 ft. to 20 ft. From _____ ft. to _____ ft. From _____ ft. to _____ ft.

What is the nearest source of possible contamination:
 Septic tank Lateral lines Pit privy Livestock pens Insecticide storage Other (specify below)
 Sewer lines Cesspool Sewage lagoon Fuel storage Abandoned water well
 Watertight sewer lines Seepage pit Feedyard Fertilizer storage Oil well/gas well **None**

Direction from well _____ Distance from well _____

FROM	TO	LITHOLOGIC LOG	FROM	TO	LITHO. LOG (cont.) or PLUGGING INTERVALS
0	2	Surface			
2	27	Fine & med sand w/caliche strks			
27	120	Fine sand w/clay & caliche strks			
120	140	Fine & med sand			
140	160	Black shale			

7 CONTRACTOR'S OR LANDOWNER'S CERTIFICATION: This water well was constructed, reconstructed, or plugged under my jurisdiction and was completed on (mo/day/year) 3/26/12 and this record is true to the best of my knowledge and belief. Kansas Water Well Contractor's License No. 554. This Water Well Record was completed on (mo/day/year) 3/27/12 under the business name of **Woofter Pump & Well Inc.** by (signature) *[Signature]*

INSTRUCTIONS: Please fill in blanks and check the correct answers. Send three copies (white, blue, pink) to Kansas Department of Health and Environment, Bureau of Water, Geology Section, 1000 SW Jackson St., Suite 420, Topeka, Kansas 66612-1367. Telephone 785-296-5522. Send one to WATER WELL OWNER and retain one for your records. Include fee of \$5.00 for each constructed well. Visit us at <http://www.kdheks.gov/waterwell/index.html>.

Original Returned to Sender
 Date: 4-6-12