



WATER WELL RECORD Form WWC-5 1203005

Division of Water Resources App. No.

20140428

Well ID

Original Record Correction Change in Well Use

1 LOCATION OF WATER WELL: County: Cheyenne	Fraction SW ¼ NE ¼ SE ¼ SE ¼	Section Number 35	Township Number T 5 S	Range Number R 37 <input type="checkbox"/> E <input checked="" type="checkbox"/> W
--	---------------------------------	----------------------	--------------------------	---

2 WELL OWNER: Last Name: Fisher First: AB Business: Address: 15360 Rd 3 Address: City: McDonald State: KS ZIP: 67745	Street or Rural Address where well is located (if unknown, distance and direction from nearest town or intersection): If at owner's address, check here: <input type="checkbox"/> Road A and Rd 34
---	---

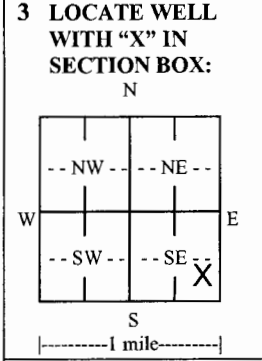

4 DEPTH OF COMPLETED WELL: 300 ft.
Depth(s) Groundwater Encountered: 1) 190 ft.
2) ft. 3) ft. or 4) Dry Well
WELL'S STATIC WATER LEVEL: 190 ft.
 below land surface, measured on (mo-day-yr) 05/01/2014
 above land surface, measured on (mo-day-yr).....
Pump test data: Well water was ft.
after hours pumping gpm
Well water was ft.
after hours pumping gpm
Estimated Yield: 55 gpm
Bore Hole Diameter: 8 in. to 320 ft. and
..... in. to ft.

5 Latitude: 39.5703 (decimal degrees)
Longitude: 101.4350 (decimal degrees)
Datum: WGS 84 NAD 83 NAD 27
Source for Latitude/Longitude:
 GPS (unit make/model:)
(WAAS enabled? Yes No)
 Land Survey Topographic Map
 Online Mapper:

6 Elevation: 3425 ft. Ground Level TOC
Source: Land Survey GPS Topographic Map
 Other KOLAR

7 WELL WATER TO BE USED AS:

1. Domestic: <input type="checkbox"/> Household <input type="checkbox"/> Lawn & Garden <input type="checkbox"/> Livestock	2. Irrigation	3. Feedlot	4. Industrial	5. <input type="checkbox"/> Public Water Supply: well ID	6. <input type="checkbox"/> Dewatering: how many wells?	7. <input type="checkbox"/> Aquifer Recharge: well ID	8. <input type="checkbox"/> Monitoring: well ID	9. Environmental Remediation: well ID	<input type="checkbox"/> Air Sparge <input type="checkbox"/> Soil Vapor Extraction <input type="checkbox"/> Recovery <input type="checkbox"/> Injection	10. <input checked="" type="checkbox"/> Oil Field Water Supply: lease ... Fisher 'A' 1-35 ...	11. Test Hole: well ID	<input type="checkbox"/> Cased <input type="checkbox"/> Uncased <input type="checkbox"/> Geotechnical	12. Geothermal: how many bores?	a) Closed Loop <input type="checkbox"/> Horizontal <input type="checkbox"/> Vertical b) Open Loop <input type="checkbox"/> Surface Discharge <input type="checkbox"/> Inj. of Water	13. <input type="checkbox"/> Other (specify):
--	---------------	------------	---------------	--	---	---	---	---	--	---	------------------------------	---	---------------------------------------	--	---

Was a chemical/bacteriological sample submitted to KDHE? Yes No If yes, date sample was submitted:

Water well disinfected? Yes No

8 TYPE OF CASING USED: Steel PVC Other CASING JOINTS: Glued Clamped Welded Threaded
Casing diameter 4.5 in. to 260 ft., Diameter in. to ft., Diameter in. to ft.
Casing height above land surface 18 in. Weight 2.38 lbs./ft. Wall thickness or gauge No. 237

TYPE OF SCREEN OR PERFORATION MATERIAL:
 Steel Stainless Steel Fiberglass PVC Other (Specify)
 Brass Galvanized Steel Concrete tile None used (open hole)

SCREEN OR PERFORATION OPENINGS ARE:
 Continuous Slot Mill Slot Gauze Wrapped Torch Cut Drilled Holes Other (Specify)
 Louvered Shutter Key Punched Wire Wrapped Saw Cut None (Open Hole)

SCREEN-PERFORATED INTERVALS: From 260 ft. to 300 ft., From ft. to ft., From ft. to ft.
GRAVEL PACK INTERVALS: From 20 ft. to 300 ft., From ft. to ft., From ft. to ft.

9 GROUT MATERIAL: Neat cement Cement grout Bentonite Other
Grout Intervals: From 0 ft. to 20 ft., From ft. to ft., From ft. to ft.

Nearest source of possible contamination:
 Septic Tank Lateral Lines Pit Privy Livestock Pens Insecticide Storage
 Sewer Lines Cess Pool Sewage Lagoon Fuel Storage Abandoned Water Well
 Watertight Sewer Lines Seepage Pit Feedyard Fertilizer Storage Oil Well/Gas Well
 Other (Specify)

Direction from well? Distance from well? ft.

10 FROM	TO	LITHOLOGIC LOG	FROM	TO	LITHO. LOG (cont.) or PLUGGING INTERVALS
0	2	surface	193	226	fine to some med sand w/caliche strks & cla
2	25	loess	226	310	fine sand w/clay & caliche lenses
25	71	clay & caliche w/sand lenses	310	320	blakc shale
71	82	fine & med sand w/clay & caliche strks			
82	126	clay & caliche w/sand lenses			
126	147	fine sand w/clay & caliche strks			
147	167	fine & med sand w/clay & caliche lenses			
167	181	clay & caliche w/sand strks			
181	193	fine & med sand w/clay & caliche lesnes			

Notes:

11 CONTRACTOR'S OR LANDOWNER'S CERTIFICATION: This water well was constructed, reconstructed, or plugged under my jurisdiction and was completed on (mo-day-year) 05/01/2014 and this record is true to the best of my knowledge and belief. Kansas Water Well Contractor's License No. 554 This Water Well Record was completed on (mo-day-year) 05/12/2014 under the business name of Woofert Pump & Well, Inc.



ASSIGNMENT OF WATER WELL TO LANDOWNER

COPY

I, AB Fisher of 15360 Road 3
(Landowner's address)

McDonald Kansas am the landowner on which a water well is located in
(City) (State)
the _____ quarter of the SE quarter of the SE quarter in Section 35, Township 5,
Range 37 E/W, in Cheyenne County, Kansas which is approximately
660 feet north south and 660 feet east/west of the apparent SE section
corner. The water well was drilled in May 2014 (month/year).

I hereby request that Murfin Drilling Company leave the water well,
(Operator name)

which was drilled by Temporary Water Permit # 20140428, unplugged, and I will
assume all responsibility for the plugging of said water well in accordance with the requirements
of the Kansas Department of Health and Environment regulation K.A.R. 28-30-7.

LANDOWNER:

A. B. Fisher
(Signature) (Date)

A. B. FISHER
(Print)

OPERATOR:

Christine Campbell 6/10/14
(Signature) (Date)

By: _____
(Agent)

IF ADDITIONAL LANDOWNER

(Signature) (Date)

(Print)

RECEIVED
JUN 23 2014
BUREAU OF WATER

WATER RESOURCES RECEIVED

File Copy **JRANS**

JUN 05 2014

WATER RESOURCES RECEIVED

FO 3
GMD 4
MEETS 9
A.R. 6 OK
DATE 5/12/14

Submit To:

CHIEF ENGINEER
Division of Water Resources
Kansas Department of Agriculture
109 SW 9th Street, 2nd Floor
Topeka, KS 66612-1283
www.kfda.gov/dwr

KS DEPT OF AGRICULTURE
APPLICATION FOR
TEMPORARY PERMIT

MAY 08 2014

11:40am

GROUNDWATER
 SURFACE WATER
(check one)

KS DEPT OF AGRICULTURE



State of Kansas

20140428

STATUTORY FILING FEE OF \$200.00 MUST ACCOMPANY THIS APPLICATION
(Make check payable to the Kansas Department of Agriculture)

1. Applicant: (Please print or type)

Name Cobalt Energy LLC
Street 115 S Belmont #12 - PO Box 2037
City and State Wichita KS
Zip Code 67208 Telephone No. (316) 201-4101
Social Security I.D. No. _____
and/or Taxpayer I.D. No. _____

6. Period of use (6 months maximum):

Commencing date: 5-12-14
Ending Date: 8-12-14

7. Location of the proposed point of diversion shall be indicated on the diagram below. Use the center section.

If surface water, indicate on the diagram the course of the stream, and its name.

2. Location of Point of Diversion:

Sec. 35 Twp. 5 Rng. 37 (E/W)
Cherokee County, Kansas.

Distance from Southeast Corner of Section:

660 feet North from Southeast Corner
660 feet West from Southeast Corner

Existing water right? Yes No
If yes, File No. _____
Pending application? Yes No
If yes, File No. _____

3. Water Use Data:

Proposed Max. Pumping Rate (gpm) 60
Amount Requested (gallons) 300000
(not to exceed one million gallons unless for dewatering)
Depth of Well (feet) 300' OR
Name of Stream _____

4. Water is to be used for (briefly describe proposed use)

Water Supply Well for Oil
Field Drilling

5. Location of piece of use:

Cherokee Co
Tract "A" 1-35
SE-SE
35-5-37
R. 2

The scale of the diagram is 2 inches = 1 mile
Each small square represents 10 acres

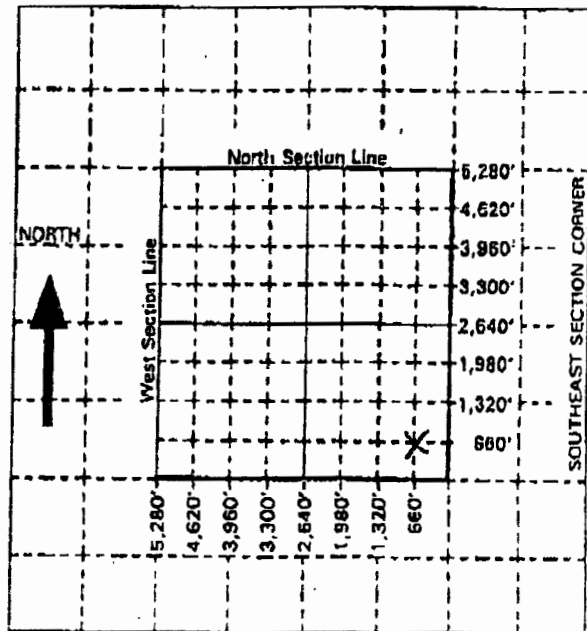

For Office Use Only: Code TWP Fee \$ 200 TR # _____ Receipt Date 5/12/14 Check # 44532

JUN 05 2014

8. For groundwater use, list below all wells within 1/4 mile of the proposed well, and plot locations upon the diagram on reverse side. If additional space is needed, attach sheet.

Other wells -

Well A Owner(s): _____ Address: _____

Well B Owner(s): _____ Address: _____

9. For surface water use, list below the names and addresses of all landowners from a point 1/2 mile upstream to a point 1/2 mile downstream of the tract of land upon which the point of diversion is located. If additional space is needed, attach sheet.

Tract A Owner(s): _____ Address: _____

Tract B Owner(s): _____ Address: _____

10. The owner of the point of diversion, if other than the applicant is (please print):

AB Fisher - 15360 Road 3 - McDonald KS 67745
(name, address and telephone number)

You must provide evidence of legal access to, or control of, the point of diversion from the landowner or the landowner's authorized representative. Provide a copy of a recorded deed, lease, easement or other document with this application. In lieu thereof, you may sign the following sworn statement:

I have legal access to, or control of, the point of diversion described in this application from the landowner or the landowner's authorized representative. I declare under penalty of perjury that the foregoing is true and correct.

Executed on _____, 20____

Applicant's Signature

11. The applicant states that the information set forth herein is true and accurate to the best of his/her knowledge.

Signature of Applicant

or

Robert Pump ~~Water~~
Authorized Representative
Karen D. Decker
Title

5-5-14
Date

Applicant's Name Printed

DO NOT WRITE BELOW THIS LINE

CONDITIONS OF APPROVAL:

The applicant shall maintain records from which the quantity of water actually diverted may be readily determined.

The use of water herein authorized shall not be made so as to impair any use under existing water rights or prejudicially and unreasonably affect the public interest.

K.S.A. 82a-728 states in part "(a) except for the appropriation of water for the purpose of domestic use, . . . It shall be unlawful for any person to appropriate or threaten to appropriate water from any source without first applying for and obtaining a permit to appropriate water."

Well(s) must be properly constructed by the well driller to comply with Article 30 of the Rules and Regulations as adopted by the Kansas Department of Health and Environment.

The Chief Engineer specifically retains jurisdiction in this matter with authority to make such reasonable reductions in the approved rate of diversion and quantity authorized, and such changes in other terms, conditions, and limitations set forth in this approval and permit to proceed as may be deemed to be in the public interest.

APPLICATION APPROVED

Permit Number: 20140428
Date Issued: May 8, 2014
Effective: May 12, 2014
Expiration Date: August 12, 2014

[Signature]

For: David W Barfield, P.E.
Chief Engineer
Division of Water Resources
Kansas Department of Agriculture

The point of diversion authorized by the approval of this application for temporary permit is more particularly described as being located near the center of the Southeast Quarter of the Southeast Quarter (SE 1/4 SE 1/4) of Section 35, Township 6 South, Range 37 West, Cheyenne County, Kansas.

This is a final agency action as defined in K.S.A. 77-607(b) (2). You may pursue judicial review of this order as provided in the Kansas Act for Judicial Review (K.S.A. 77-601 et seq.). A petition for judicial review must be filed in a Kansas court of competent jurisdiction within 30 days after service of this order as provided in K.S.A. 77-613. The agency official designated to receive service of a petition for judicial review on behalf of the Kansas Department of Agriculture is Chief Legal Counsel, Kansas Department of Agriculture, 109 SW 9th Street, 4th Floor, Topeka, Kansas 66612.

CERTIFICATE OF SERVICE

On this 9th day of May, 2014, I hereby certify that the attached Approval of Application for Temporary Permit, File No. 20140428, dated May 8, 2014, was mailed postage prepaid, first class, US mail to the following:

A B FISHER
15360 ROAD 3
MC DONALD KS 67745-4653

WOOFER PUMP AND WELL INC
PO BOX 689
HOXIE KS 67740-0689.



Staff

WATER RESOURCES
RECEIVED

JUN 05 2014

KS DEPT OF AGRICULTURE

Kansas
Department of Agriculture
Division of Water Resources

109 SW 9th Street, 2nd Floor
Topeka, Kansas 66612-1280

Jackie McClaskey, Secretary
David W. Barfield, Chief Engineer

Phone: (785) 296-3717
Fax: (785) 296-1176
www.agriculture.ks.gov
Sam Brownback, Governor

May 9, 2014

WOOFER PUMP AND WELL INC
PO BOX 689
HOXIE KS 67740-0689

RE: Temporary Permit
File No. 20140428

Dear Sir or Madam:

Your application for temporary permit to appropriate water for beneficial use has been examined, approved, and is being returned herewith for your records.

The approval of your application constitutes a temporary permit to appropriate water for beneficial use, as set forth in the application. This permit does not give authority to any right-of-way, or authorize injury to, or trespass upon public or private property, does not constitute authority under K.S.A. 82a 301 through 305 to construct any dam or other obstruction; nor does it obviate the necessity of assent from Federal or Local Governmental authorities, when necessary. Records must be maintained from which the quantity of water actually diverted may be readily determined.

Abandoned water wells must be plugged in accordance with the requirements of Article 30 of the Rules and Regulations as adopted by the Kansas Department of Health and Environment (KDHE). If the well is to be retained by the landowner for other purposes, a copy of the legal transfer of responsibility for maintenance of the well must be forwarded to the KDHE Geology Section, 1000 SW Jackson, Suite 420, Topeka, Kansas, 66612, telephone (785) 296-5524. More information is available online at: <http://kdheks.gov/waterwell>

K.S.A. 82a-728 sets forth, in essence, that it is unlawful to divert or threaten to divert water for the type of use you propose without first acquiring approval of the Chief Engineer of the Division of Water Resources. K.S.A. 82a-737 sets forth that violation of the Kansas Water Appropriation Act, any adopted rule or regulation, or any order of the Chief Engineer, may be subject to a civil penalty of up to \$1000, per violation. Each day that any such violation occurs can be considered a separate offense.

If you have any questions, please contact our office at (785) 296-3717.

Sincerely,



Kenneth A. Kopp, L.G.
Water Appropriation Program

WATER RESOURCES
RECEIVED

JUN 05 2014

Enclosures
per A. B. Fisher

KANSAS DEPARTMENT OF AGRICULTURE