

1) LOCATION OF WATER WELL: Fraction **SE SW 1/4 NW 1/4 SW 1/4** Section Number **9** Township Number **T 6 S** Range Number **R 29 EW**
 County: **Sheridan**

Distance and direction from nearest town or city street address of well if located within city?
Hi-Plains Coop; Seldon, Kansas

2) WATER WELL OWNER: **Hi-Plains Coop**
 RR#, St. Address, Box # : **P.O. Box 197**
 City, State, ZIP Code : **Seldon, Kansas 67757**
 Board of Agriculture, Division of Water Resources
 Application Number:

3) LOCATE WELL'S LOCATION WITH AN "X" IN SECTION BOX:
 N
 W E
 S

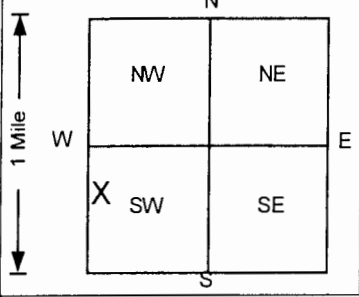

4) DEPTH OF COMPLETED WELL: **138.5** ft. ELEVATION: **2837.61**
 Depth(s) Groundwater Encountered 1. ft. 2. ft. 3. ft.
 WELL'S STATIC WATER LEVEL ft. below land surface measured on mo/day/yr
 Pump test data: Well water was **NA** ft. after hours pumping gpm
 Est. Yield **NA** gpm: Well water was ft. after hours pumping gpm
 Bore Hole Diameter **9.6** in. to **140.5** in. to in. to ft.
 WELL WATER TO BE USED AS: 5 Public water supply 8 Air conditioning 11 Injection well
 1 Domestic 3 Feedlot 6 Oil field water supply 9 Dewatering 12 Other (Specify below)
 2 Irrigation 4 Industrial 7 Lawn and garden only **10 Monitoring well**
 Was a chemical/bacteriological sample submitted to Department? Yes. No If yes, mo/day/yr sample was submitted
 Water Well Disinfected? Yes No

5) TYPE OF BLANK CASING USED: 5 Wrought iron 8 Concrete tile CASING JOINTS: Glued Clamped
 1 Steel 3 RMP (SR) 6 Asbestos-Cement 9 Other (specify below) Welded
2 PVC 4 ABS 7 Fiberglass Threaded.
 Blank casing diameter **4** in. to **117.5** ft. Dia. in. to ft. Dia. in. to ft.
 Casing height above land surface in., weight lbs./ft. Wall thickness or gauge No. **SCH. 40**

TYPE OF SCREEN OR PERFORATION MATERIAL **7 PVC** 10 Asbestos-cement
 1 Steel 3 Stainless steel 5 Fiberglass 8 RMP (SR) 11 Other (specify)
 2 Brass 4 Galvanized steel 6 Concrete tile 9 ABS 12 None used (open hole)

SCREEN OR PERFORATION OPENINGS ARE: 5 Gauzed wrapped 8 Saw cut 11 None (open hole)
 1 Continuous slot **3 Mill slot** 6 Wire wrapped 9 Drilled holes
 2 Louvered shutter 4 Key punched 7 Torch cut 10 Other (specify)

SCREEN-PERFORATED INTERVALS: From **117.5** ft. to **137.5** ft. From ft. to ft.
 From ft. to ft. From ft. to ft.
 GRAVEL PACK INTERVALS: From **114.5** ft. to **140.5** ft. From ft. to ft.
 From ft. to ft. From ft. to ft.

6) GROUT MATERIAL: 1 Neat cement **2 Cement grout** **3 Bentonite** 4 Other
 Grout Intervals: From **3.5** ft. to **108** ft. From **108** ft. to **114.5** ft. From ft. to ft.

What is the nearest source of possible contamination:
 1 Septic tank 4 Lateral lines 7 Pit privy 10 Livestock pens 14 Abandoned water well
 2 Sewer lines 5 Cess pool 8 Sewage lagoon 11 Fuel storage 15 Oil well/Gas well
 3 Watertight sewer lines 6 Seepage pit 9 Feedyard 12 Fertilizer storage 16 Other (specify below)
 13 Insecticide storage
 Direction from well? How many feet? **0**

| FROM | TO | LITHOLOGIC LOG | FROM | TO | PLUGGING INTERVALS |
|-------|-------|--------------------------------------|------|-----|-------------------------------|
| 0 | 10 | Clay with Gravel, Dark Yellow Orange | 125 | 135 | Clay Sand, Very Pale Orange |
| 10 | 15 | Clay Gravel, Dark Yellow Brown | 135 | 140 | Clay Sand, Very Pale Orange |
| 15 | 20 | Sand, Moderate Yellow Brown | | | |
| 20 | 25 | Clay Sand, Dark Yellow Orange | | | |
| 25 | 30 | Clay Sand, Very Pale Orange | | | |
| 30 | 35 | Clay Sand, Moderate Yellow Brown | | | |
| 35 | 50 | Sand, Dark Yellow Orange | | | |
| 50 | 80 | Sand, Orange Yellow | | | |
| 80 | 90 | Sand, Dark Yellow Orange | | | |
| 90 | 95 | Sand Clay, Gray Orange | | | |
| 95 | 110 | Clay Sand, Gray Orange | | | |
| 110 | 115 | Sand, Very Pale Orange | | | |
| 115 | 121.5 | Sand Clay, Gray Orange | | | MWB-1, Flushmount |
| 121.5 | 122 | Clay Sand, Dark Yellow Orange | | | Project Name: Golder - Seldon |
| 122 | 125 | Clay Sand, Dark Yellow Orange | | | GeoCore # 969, # |

7) CONTRACTOR'S OR LANDOWNER'S CERTIFICATION: This water well was **1** constructed, (2) reconstructed, or (3) plugged under my jurisdiction and was completed on (mo/day/year) **12/20/01** and this record is true to the best of my knowledge and belief.
 Kansas Water Well Contractor's License No. **527** This Water Well Record was completed on (mo/day/yr) **1/15/02**
 under the business name of **GeoCore Services, Inc.** by (signature) *Dale A. Ruff*

INSTRUCTIONS: Use typewriter or ball point pen. PLEASE PRESS FIRMLY and PRINT clearly. Please fill in blanks, underline or circle the correct answers. Send top three copies to Kansas Department of Health and Environment, Bureau of Water, Topeka, Kansas 66620-0001. Telephone: 913-296-5545. Send one to WATER WELL OWNER and retain one for your records.

OFFICE USE ONLY

T

R

EW

SEC.

1/4

1/4

1/4

C:\Projects\258\258-P1_258P1001\New Quarterly Reports 1-19-2010\fig4-1.dwg
 PLOTTED: 5/8/2017 2:33 PM
 SAVED: 5/8/2017 2:32 PM

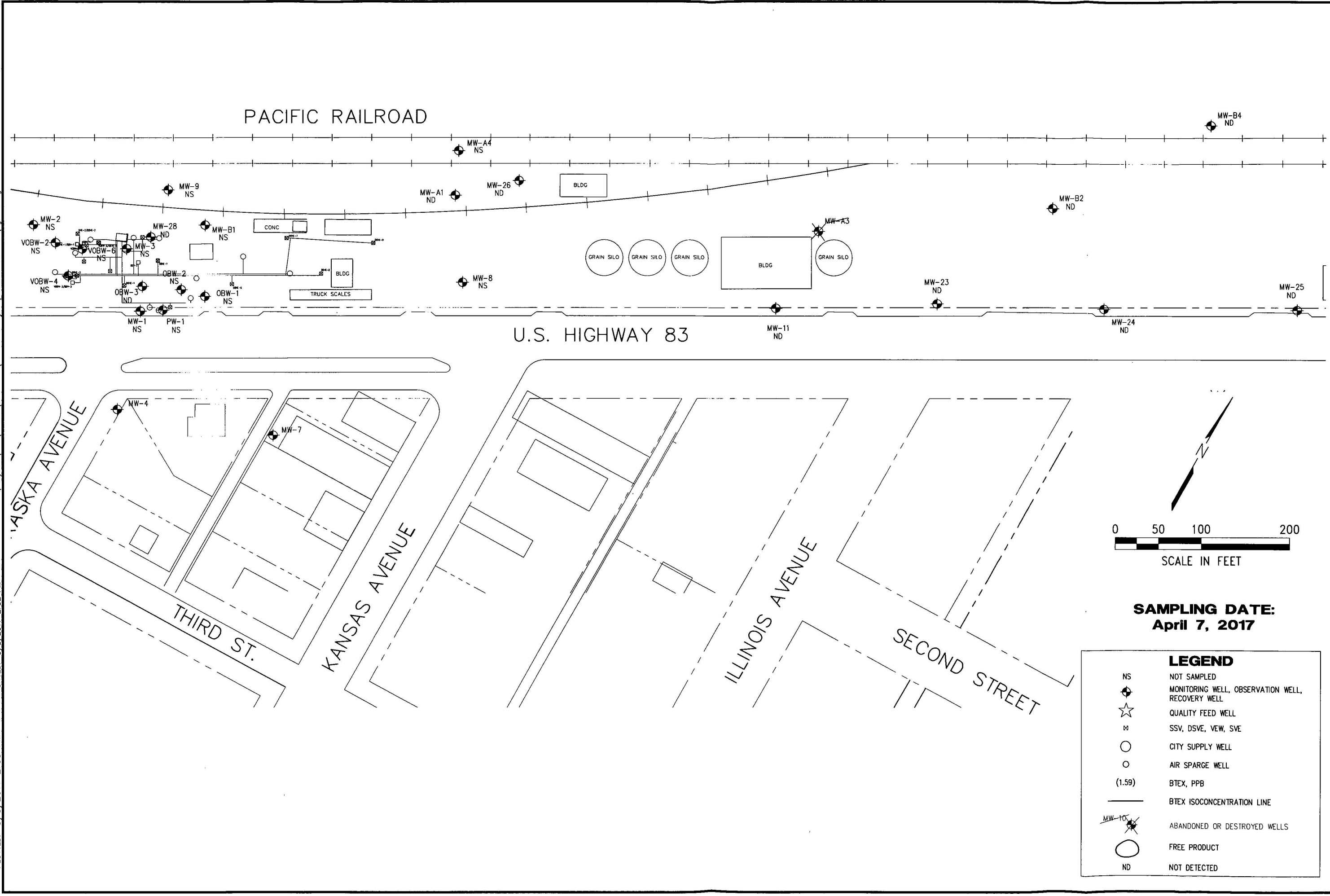

SAMPLING DATE:
April 7, 2017

LEGEND

- NS NOT SAMPLED
- ◆ MONITORING WELL, OBSERVATION WELL, RECOVERY WELL
- ☆ QUALITY FEED WELL
- M SSV, DSVE, VEW, SVE
- CITY SUPPLY WELL
- AIR SPARGE WELL
- (1.59) BTEX, PPB
- BTEX ISOCONCENTRATION LINE
- ◆ (with slash) ABANDONED OR DESTROYED WELLS
- FREE PRODUCT
- ND NOT DETECTED

| REVISIONS | BY |
|-----------|----|
| | |
| | |

MILCO
Environmental Services, Inc.
Kearney, NE (308) 237-5923
McCook, NE (308) 345-4741

HOME OIL
BTEX ISOCONCENTRATION MAP
 SELDEN, KANSAS U6-090-221

This document, and the ideas and designs incorporated herein, as an instrument of professional service, is the property of Miller & Associates and is not to be used in whole or in part for any other project without the written authorization of Miller & Associates.

VERIFY SCALES
 BAR IS ONE INCH ON ORIGINAL DRAWING
 0 1"
 IF NOT ONE INCH ON THIS SHEET, ADJUST SCALES ACCORDINGLY.

SCALE: 1" = 100'
 PROJECT NO. M258-P1-001
 DATE: MAY, 2017
 FIELD BOOK M&A DWG NO.
 DRAWN BY: BSF APRVD BY:
 SHEET

FIGURE 4-1