

Upper plugging record KGS/KDHE

WATER WELL RECORD

Form WWC-5

Division of Water Resources; App. No.

**1 LOCATION OF WATER WELL:** Fraction SW NE 1/4 NW 1/4 SW 1/4 Section Number 9 Township Number T 6 S Range Number R 29 E/W  
 County: Sheridan  
 Distance and direction from nearest town or city street address of well if located within city? Hwy 4, Nebraska Ave, Selden, KS **Global Positioning Systems** (decimal degrees, min. of 4 digits)  
 Latitude: 39.5436 N  
 Longitude: -100.5693 W  
**2 WATER WELL OWNER:** Home Oil  
 RR#, St. Address, Box # : 1629 Hillcrest Rd  
 City, State, ZIP Code : Lawrence, KS 66044  
 Elevation: \_\_\_\_\_  
 Datum: \_\_\_\_\_  
 Data Collection Method: USGS National Map

**3 LOCATE WELL'S LOCATION WITH AN "X" IN SECTION BOX:**

NW	NE
SW	SE

**4 DEPTH OF COMPLETED WELL** 144 ft.  
 Depth(s) Groundwater Encountered (1) 129.75 ft. (2) \_\_\_\_\_ ft. (3) \_\_\_\_\_ ft.  
 WELL'S STATIC WATER LEVEL 129.75 ft. below land surface measured on mo/day/yr 01-4-07  
 Pump test data: Well water was \_\_\_\_\_ ft. after \_\_\_\_\_ hours pumping \_\_\_\_\_ gpm  
 Est. Yield 2.0 gpm: Well water was \_\_\_\_\_ ft. after \_\_\_\_\_ hours pumping \_\_\_\_\_ gpm  
 WELL WATER TO BE USED AS: 5 Public water supply 8 Air conditioning  11 Injection well  
 1 Domestic 3 Feedlot 6 Oil field water supply 9 Dewatering 12 Other (Specify below)  
 2 Irrigation 4 Industrial 7 Domestic (lawn & garden) 10 Monitoring well AS-7  
 Was a chemical/bacteriological sample submitted to Department? Yes \_\_\_\_\_ No ; If yes, mo/day/yrs  
 Sample was submitted \_\_\_\_\_ Water well disinfected? Yes \_\_\_\_\_ No

**5 TYPE OF CASING USED:** 5 Wrought Iron 8 Concrete tile CASING JOINTS: Glued  Clamped \_\_\_\_\_  
 1 Steel 3 RMP (SR) 6 Asbestos-Cement 9 Other (specify below) Welded \_\_\_\_\_  
 2 PVC 4 ABS 7 Fiberglass Threaded \_\_\_\_\_  
 Blank casing diameter \_\_\_\_\_ in. to \_\_\_\_\_ ft., Diameter \_\_\_\_\_ in. to \_\_\_\_\_ ft., Diameter \_\_\_\_\_ in. to \_\_\_\_\_ ft.  
 Casing height above land surface 0.3 in., Weight 0.70 lbs./ft. Wall thickness or gauge No. Sch 40  
 TYPE OF SCREEN OR PERFORATION MATERIAL:  
 1 Steel 3 Stainless Steel 5 Fiberglass  7 PVC 9 ABS 11 Other (Specify) \_\_\_\_\_  
 2 Brass 4 Galvanized Steel 6 Concrete tile 8 RM (SR) 10 Asbestos-Cement 12 None used (open hole)  
 SCREEN OR PERFORATION OPENINGS ARE:  
 1 Continuous slot  3 Mill slot 0.0205 5 Guazed wrapped 7 Torch cut 9 Drilled holes 11 None (open hole)  
 2 Louvered shutter 4 Key punched 6 Wire wrapped 8 Saw Cut 10 Other (specify) \_\_\_\_\_  
 SCREEN-PERFORATED INTERVALS: From 140 ft. to 144 ft., From \_\_\_\_\_ ft. to \_\_\_\_\_ ft.  
 GRAVEL PACK INTERVALS: From 138 ft. to 144 ft., From \_\_\_\_\_ ft. to \_\_\_\_\_ ft.

**6 GROUT MATERIAL:** 1 Neat cement 2 Cement grout  3 Bentonite 4 Other \_\_\_\_\_  
 Grout Intervals: From 130 ft. to 1.5 ft., From \_\_\_\_\_ ft. to \_\_\_\_\_ ft., From \_\_\_\_\_ ft. to \_\_\_\_\_ ft.  
 What is the nearest source of possible contamination:  
 1 Septic tank 4 Lateral lines 7 Pit privy 10 Livestock pens 13 Insecticide Storage  6 Other (specify) \_\_\_\_\_  
 2 Sewer lines 5 Cess pool 8 Sewage lagoon 11 Fuel storage 14 Abandoned water well below  
 3 Watertight sewer lines 6 Seepage pit 9 Feedyard 12 Fertilizer Storage 15 Oil well/gas well former fuel storage  
 Direction from well? \_\_\_\_\_ How many feet? \_\_\_\_\_ at source \_\_\_\_\_

FROM	TO	LITHOLOGIC LOG	FROM	TO	PLUGGING INTERVALS
0	1	Topsoil			
1	40	Silt			
40	63	Sand			
63	84	Sandstone & Siltstone			
84	90	Sand			
90	100	Silty Sandstone			
100	143	Sandy Siltstone			
143	144	Sand-Sandstone			

**7 CONTRACTOR'S OR LANDOWNER'S CERTIFICATION:** This water well was  (1) constructed (2) reconstructed, or (3) plugged under my jurisdiction and was completed on (mo/day/year) 01-4-07 and this record is true to the best of my knowledge and belief.  
 Kansas Water Well Contractor's License No. 554 This Water Well Record was completed on (mo/day/year) 04-05-07  
 under the business name of Woolter Pump & Well, Inc. by (signature) Jay C. Woolter

INSTRUCTIONS: Use typewriter or ball point pen. PLEASE PRESS FIRMLY and PRINT clearly. Please fill in blanks, underline or circle the correct answers. Send top three copies to Kansas Department of Health and Environment, Bureau of Water, Geology Section, 1000 SW Jackson St., Suite 420, Topeka, Kansas 66612-1367. Telephone 785-296-5522. Send one to WATER WELL OWNER and retain one for your records. Fee of \$5.00 for each constructed well. Visit us at http://www.kdhe.state.ks.us/geo/waterwells.

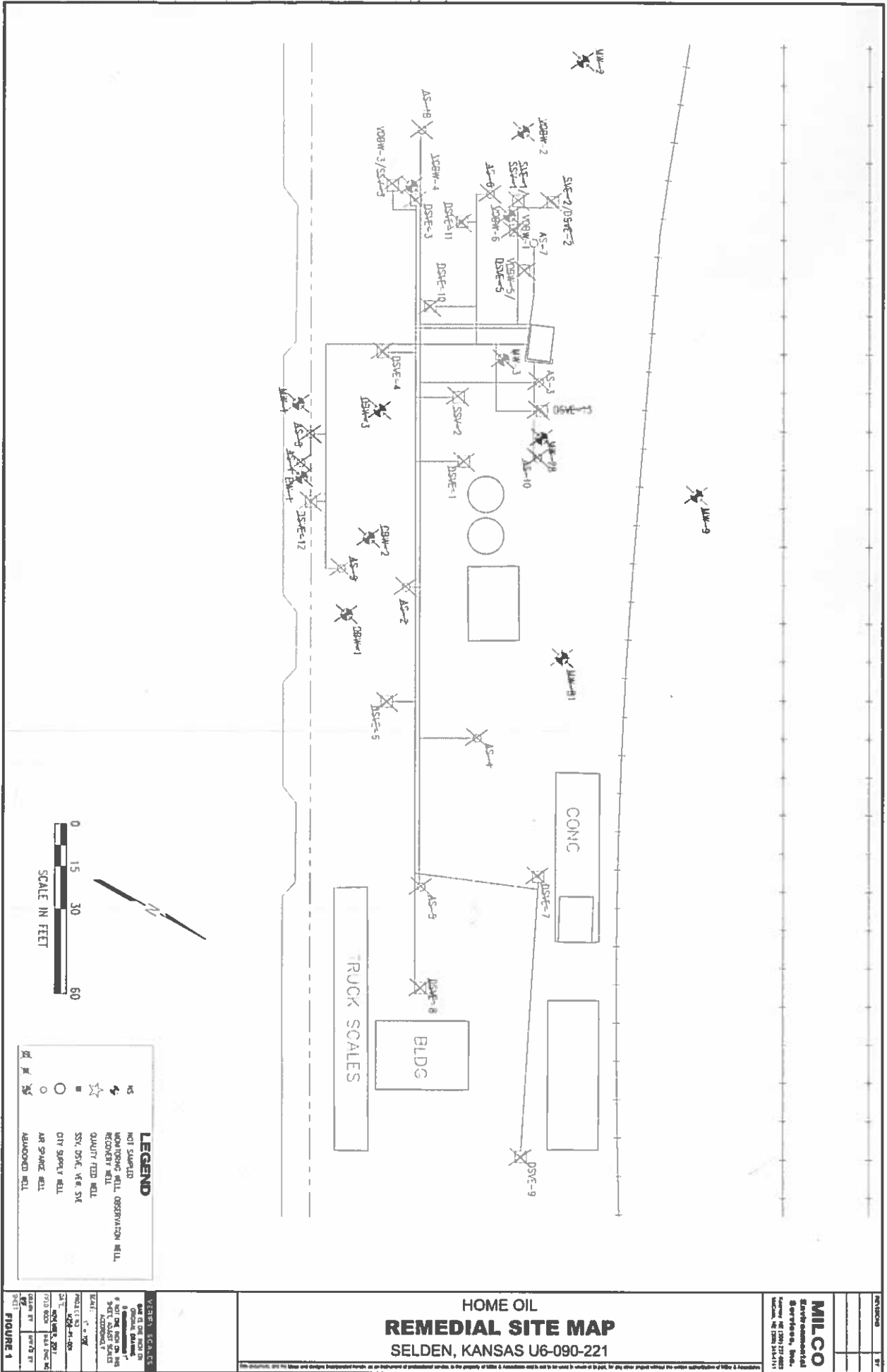

**LEGEND**

✕	MONITORING WELL
☆	QUALITY FEED WELL
○	CITY SUPPLY WELL
○	AIR SPARGE WELL
○	ABANDONED WELL
☆	NOT SAMPLED
☆	MONITORING WELL OBSERVATION WELL
☆	RECOVERY WELL
☆	SSV, DSAC, V&B SVE
☆	CITY SUPPLY WELL
☆	AIR SPARGE WELL
☆	ABANDONED WELL

**HOME OIL  
REMEDIAL SITE MAP  
SELDEN, KANSAS U6-090-221**

**MILCO**  
 Environmental  
 Services, Inc.  
 1000 West 10th Street  
 Selden, KS 67484-1411  
 Phone: 785.834.4111  
 Fax: 785.834.4112

DATE: 12/15/09  
 DRAWN BY: JLD  
 CHECKED BY: JLD  
 SCALE: 1" = 30'  
 PROJECT NO: U6-090-221  
 SHEET NO: 10  
 TOTAL SHEETS: 10  
 DATE: 12/15/09

**FIGURE 1**