

WATER WELL PLUGGING RECORD Form WWC-5P

KSA 82a-1212 ID NO.

MW-11

1 LOCATION OF WATER WELL: County: Sheridan	Fraction ¼ NW ¼ NE ¼ SW ¼	Section Number 9	Township Number T 6 S	Range Number 29 <input type="checkbox"/> E <input checked="" type="checkbox"/> W
---	-------------------------------------	----------------------------	---------------------------------	--

Street/Rural Address of Well Location; if unknown, distance & direction from nearest town or intersection: If at owner's address, check here <input type="checkbox"/>	Global Positioning Systems (GPS) information: Latitude: _____ (in decimal degrees) Longitude: _____ (in decimal degrees) Elevation: _____ Horizontal Datum: <input type="checkbox"/> WGS84, <input type="checkbox"/> NAD83, <input type="checkbox"/> NAD27 Collection Method: <input type="checkbox"/> GPS unit (Make/Model: _____) <input type="checkbox"/> Digital Map/Photo, <input type="checkbox"/> Topographic Map, <input type="checkbox"/> Land Survey Est. Accuracy: <input type="checkbox"/> < 3 m, <input type="checkbox"/> 3-5 m, <input type="checkbox"/> 5-15 m, <input type="checkbox"/> > 15 m
---	---

2 WATER WELL OWNER: Home Oil Co. RR#, St. Address, Box #: 212 W. Railroad City, State ZIP Code: Selden, KS 67757

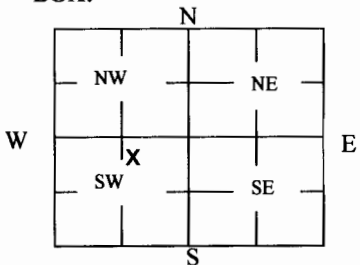
3 MARK WELL'S LOCATION WITH AN "X" IN SECTION BOX: 	4 DEPTH OF WELL <u>143.80</u> ft. WELL'S STATIC WATER LEVEL <u>130.10</u> ft. WELL WAS USED AS: <input type="checkbox"/> Domestic <input type="checkbox"/> Irrigation <input type="checkbox"/> Feedlot <input type="checkbox"/> Industrial <input type="checkbox"/> Public Water Supply <input type="checkbox"/> Oil Field Water Supply <input type="checkbox"/> Domestic (Lawn & Garden) <input type="checkbox"/> Air Conditioning <input checked="" type="checkbox"/> Dewatering <input type="checkbox"/> Monitoring MW-11 <input type="checkbox"/> Injection Well <input type="checkbox"/> Other _____ Was a chemical/bacteriological sample submitted to Department? Yes <input type="checkbox"/> No <input checked="" type="checkbox"/>
---	---

5 TYPE OF BLANK CASING USED:

Steel RMP (SR) Wrought Fiberglass Other (Specify below)
 PVC ABS Asbestos-Cement Concrete Tile

Blank casing diameter 4 in. Was casing pulled? Yes No If yes, how much 3'
 Casing height above or below land surface -36 in.

6 GROUT PLUG MATERIAL: Neat cement Cement grout Bentonite Other _____

Grout Plug Intervals: From 3 ft. to 143.80 ft., From _____ ft. to _____ ft., From _____ ft. to _____ ft.

What is the nearest source of possible contamination:
 Septic tank Seepage pit Fuel storage Other (specify below)
 Sewer lines Pit privy Fertilizer storage
 Watertight sewer lines Sewage lagoon Insecticide storage
 Lateral lines Feedyard Abandoned water well Direction from well? _____
 Cess pool Livestock pens Oil well/Gas well How many feet? _____

FROM	TO	PLUGGING MATERIALS	FROM	TO	PLUGGING MATERIALS
0	3	Native Soil			Notes:
3	143.80	Bentonite Grout			Fraction listed as NW SW NE on original well record
					Home Oil Bulk Plant: U6-090-00221

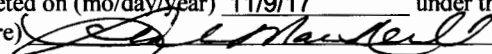
7 CONTRACTOR'S OR LANDOWNER'S CERTIFICATION: This water well was plugged under my jurisdiction and was completed on (mo/day/year) 8/31/17 and this record is true to the best of my knowledge and belief. Kansas Water Well Contractor's License No. 735. This Water Well Record was completed on (mo/day/year) 11/9/17 under the business name of MILCO Environmental Services, Inc. by (signature) 

Send one white copy to Kansas Department of Health & Environment, Geology Section, 1000 SW Jackson Street, Ste. 420, Topeka, KS 66612-1367. Send one copy to WATER WELL OWNER and retain one for your records.
 Visit us at <http://www.kdheks.gov/waterwell/index.html> Telephone 785-296-5524.

C:\Projects\258\258-P1\258P1001\New Quarterly Reports 1-19-2010\fig4-1.dwg
 SAVED: 5/8/2017 2:32 PM
 PLOTTED: 5/8/2017 2:33 PM

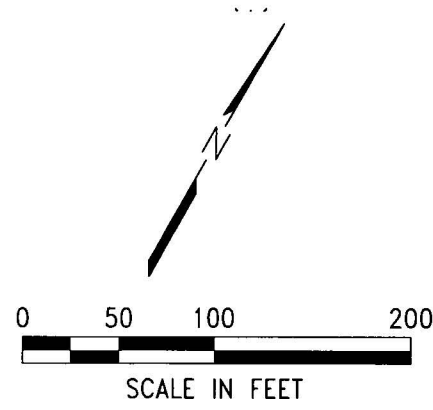
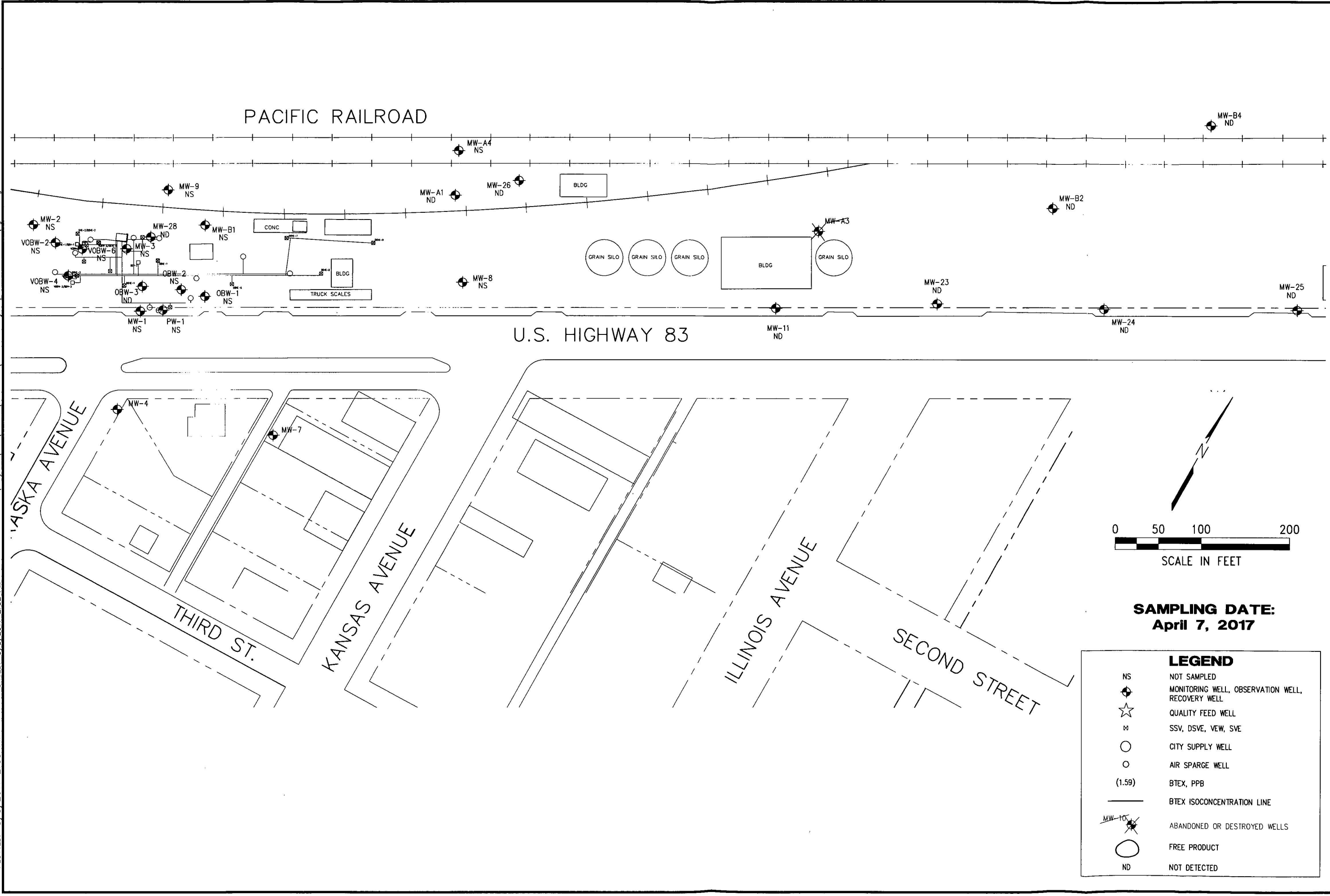

SAMPLING DATE:
April 7, 2017

LEGEND	
NS	NOT SAMPLED
◆	MONITORING WELL, OBSERVATION WELL, RECOVERY WELL
☆	QUALITY FEED WELL
M	SSV, DSVE, VEW, SVE
○	CITY SUPPLY WELL
○	AIR SPARGE WELL
(1.59)	BTEX, PPB
—	BTEX ISOCONCENTRATION LINE
◆ X	ABANDONED OR DESTROYED WELLS
○	FREE PRODUCT
ND	NOT DETECTED

REVISIONS

	BY

MILCO
Environmental Services, Inc.
Kearney, NE (308) 237-5923
McCook, NE (308) 345-4741

HOME OIL
BTEX ISOCONCENTRATION MAP
 SELDEN, KANSAS U6-090-221

This document, and the ideas and designs incorporated herein, as an instrument of professional service, is the property of Miller & Associates and is not to be used in whole or in part for any other project without the written authorization of Miller & Associates.

VERIFY SCALES	
BAR IS ONE INCH ON ORIGINAL DRAWING	
IF NOT ONE INCH ON THIS SHEET, ADJUST SCALES ACCORDINGLY.	
SCALE:	1" = 100'
PROJECT NO.	M258-P1-001
DATE:	MAY, 2017
FIELD BOOK	M&A DWG NO.
DRAWN BY:	APRVD BY:
BSF	
SHEET	

FIGURE 4-1