

**WATER WELL PLUGGING RECORD Form WWC-5P**

KSA 82a-1212 ID NO.

MW-26

**1 LOCATION OF WATER WELL:** Fraction ¼ NE ¼ NW ¼ SW ¼ Section Number 9 Township Number T 6 S Range Number 29  E  W  
 County: Sheridan

Street/Rural Address of Well Location; if unknown, distance & direction from nearest town or intersection: If at owner's address, check here

**Global Positioning Systems (GPS) information:**  
 Latitude: \_\_\_\_\_ (in decimal degrees)  
 Longitude: \_\_\_\_\_ (in decimal degrees)  
 Elevation: \_\_\_\_\_  
 Horizontal Datum:  WGS84,  NAD83,  NAD27  
 Collection Method: \_\_\_\_\_

**2 WATER WELL OWNER:** Home Oil Company  
 RR#, St. Address, Box #: \_\_\_\_\_  
 City, State ZIP Code: Selden, KS 67757

GPS unit (Make/Model: \_\_\_\_\_)  
 Digital Map/Photo,  Topographic Map,  Land Survey  
 Est. Accuracy:  < 3 m,  3-5 m,  5-15 m,  > 15 m

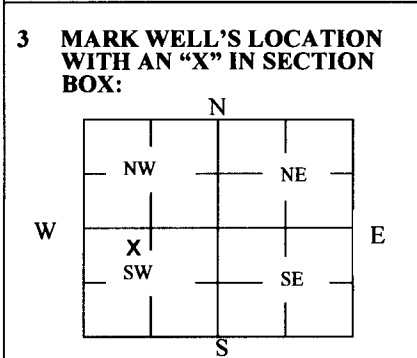

**4 DEPTH OF WELL** 149.15 ft.  
 WELL'S STATIC WATER LEVEL 135.48 ft.  
 WELL WAS USED AS:  
 Domestic  Public Water Supply  Dewatering  
 Irrigation  Oil Field Water Supply  Monitoring MW-26  
 Feedlot  Domestic (Lawn & Garden)  Injection Well  
 Industrial  Air Conditioning  Other \_\_\_\_\_  
 Was a chemical/bacteriological sample submitted to Department? Yes  No

**5 TYPE OF BLANK CASING USED:**

Steel  RMP (SR)  Wrought  Fiberglass  Other (Specify below) \_\_\_\_\_  
 PVC  ABS  Asbestos-Cement  Concrete Tile

Blank casing diameter 4 in. Was casing pulled? Yes  No  If yes, how much 3'  
 Casing height above or below land surface -36 in.

**6 GROUT PLUG MATERIAL:**  Neat cement  Cement grout  Bentonite  Other \_\_\_\_\_

Grout Plug Intervals: From 3 ft. to 149.15 ft., From \_\_\_\_\_ ft. to \_\_\_\_\_ ft., From \_\_\_\_\_ ft. to \_\_\_\_\_ ft.

What is the nearest source of possible contamination:  
 Septic tank  Seepage pit  Fuel storage  Other (specify below) \_\_\_\_\_  
 Sewer lines  Pit privy  Fertilizer storage \_\_\_\_\_  
 Watertight sewer lines  Sewage lagoon  Insecticide storage \_\_\_\_\_  
 Lateral lines  Feedyard  Abandoned water well Direction from well? \_\_\_\_\_  
 Cess pool  Livestock pens  Oil well/Gas well How many feet? \_\_\_\_\_

FROM	TO	PLUGGING MATERIALS	FROM	TO	PLUGGING MATERIALS
0	3	Native Soil			Notes:
3	149.15	Bentonite Grout			Fraction listed as NW SW NE on original well record
					Home Oil Bulk Plant: U6-090-00221

**7 CONTRACTOR'S OR LANDOWNER'S CERTIFICATION:** This water well was plugged under my jurisdiction and was completed on (mo/day/year) 8/31/17 and this record is true to the best of my knowledge and belief. Kansas Water Well Contractor's License No. 735. This Water Well Record was completed on (mo/day/year) 11/9/17 under the business name of MILCO Environmental Services, Inc. by (signature) *[Signature]*

Send one white copy to Kansas Department of Health & Environment, Geology Section, 1000 SW Jackson Street, Ste. 420, Topeka, KS 66612-1367. Send one copy to WATER WELL OWNER and retain one for your records.  
 Visit us at <http://www.kdheks.gov/waterwell/index.html> Telephone 785-296-5524.

C:\Projects\258\258-P1\_258P1001\New Quarterly Reports 1-19-2010\fig4-1.dwg  
 PLOTTED: 5/8/2017 2:33 PM  
 SAVED: 5/8/2017 2:32 PM

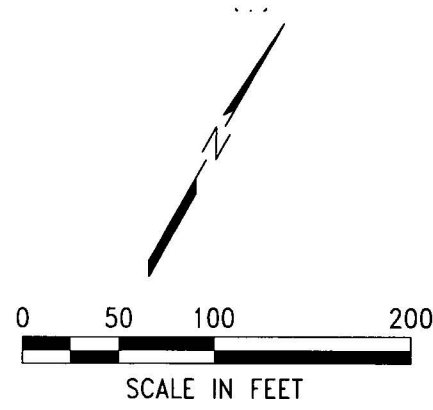
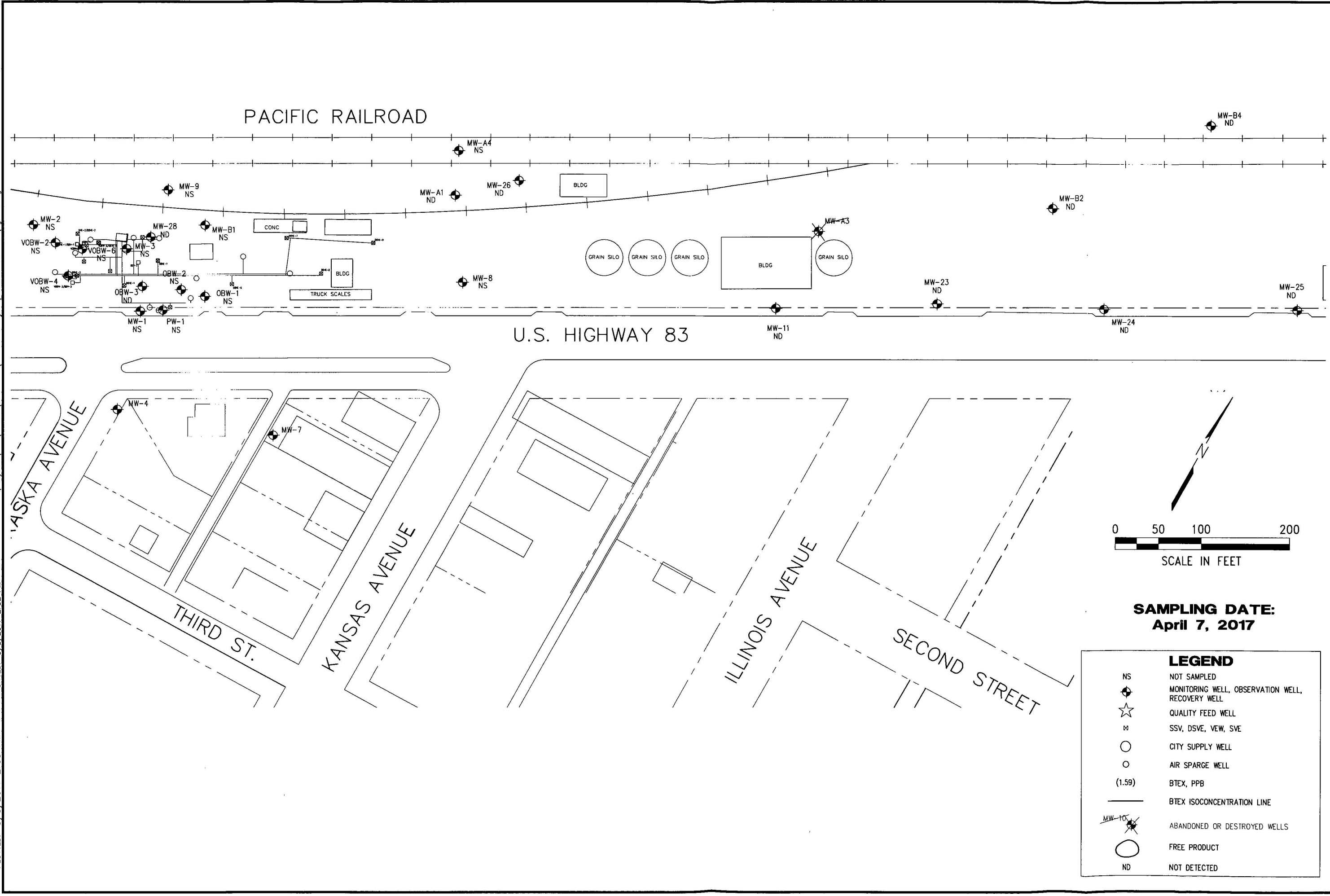

**SAMPLING DATE:**  
April 7, 2017

LEGEND	
NS	NOT SAMPLED
◆	MONITORING WELL, OBSERVATION WELL, RECOVERY WELL
☆	QUALITY FEED WELL
M	SSV, DSVE, VEW, SVE
○	CITY SUPPLY WELL
○	AIR SPARGE WELL
(1.59)	BTEX, PPB
—	BTEX ISOCONCENTRATION LINE
⊗	ABANDONED OR DESTROYED WELLS
○	FREE PRODUCT
ND	NOT DETECTED

REVISIONS

	BY

**MILCO**  
Environmental Services, Inc.  
Kearney, NE (308) 237-5923  
McCook, NE (308) 345-4741

HOME OIL  
**BTEX ISOCONCENTRATION MAP**  
 SELDEN, KANSAS U6-090-221

This document, and the ideas and designs incorporated herein, as an instrument of professional service, is the property of Miller & Associates and is not to be used in whole or in part for any other project without the written authorization of Miller & Associates.

VERIFY SCALES	
BAR IS ONE INCH ON ORIGINAL DRAWING	
IF NOT ONE INCH ON THIS SHEET, ADJUST SCALES ACCORDINGLY.	
SCALE:	1" = 100'
PROJECT NO.	M258-P1-001
DATE:	MAY, 2017
FIELD BOOK	M&A DWG NO.
DRAWN BY:	APRVD BY:
BSF	
SHEET	

**FIGURE 4-1**