

**WATER WELL PLUGGING RECORD Form WWC-5P**

KSA 82a-1212

ID NO.

OBW-1

<b>1 LOCATION OF WATER WELL:</b> County: <b>Sheridan</b>	Fraction <b>¼ SE ¼ NW ¼ SW ¼</b>	Section Number <b>9</b>	Township Number <b>T 6 S</b>	Range Number <b>29</b> <input type="checkbox"/> E <input checked="" type="checkbox"/> W
---	-------------------------------------	----------------------------	---------------------------------	--

Street/Rural Address of Well Location; if unknown, distance & direction from nearest town or intersection: If at owner's address, check here

**Global Positioning Systems (GPS) information:**

Latitude: \_\_\_\_\_ (in decimal degrees)  
 Longitude: \_\_\_\_\_ (in decimal degrees)  
 Elevation: \_\_\_\_\_  
 Horizontal Datum:  WGS84,  NAD83,  NAD27  
 Collection Method:

**2 WATER WELL OWNER:** Home Oil Company  
 RR#, St. Address, Box #:  
 City, State ZIP Code: **Selden, KS 67757**

GPS unit (Make/Model: \_\_\_\_\_)  
 Digital Map/Photo,  Topographic Map,  Land Survey  
 Est. Accuracy:  < 3 m,  3-5 m,  5-15 m,  > 15 m

**3 MARK WELL'S LOCATION WITH AN "X" IN SECTION BOX:**

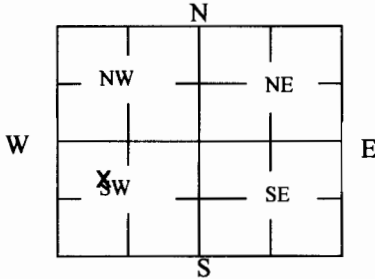

**4 DEPTH OF WELL** 146.15 **ft.**

WELL'S STATIC WATER LEVEL 132.00 ft

WELL WAS USED AS:

- |                                     |   |   |
|-------------------------------------|---|---|
| <input type="checkbox"/> Domestic   | <input type="checkbox"/> Public Water Supply      | <input type="checkbox"/> Dewatering                         |
| <input type="checkbox"/> Irrigation | <input type="checkbox"/> Oil Field Water Supply   | <input checked="" type="checkbox"/> Monitoring <b>OBW-1</b> |
| <input type="checkbox"/> Feedlot    | <input type="checkbox"/> Domestic (Lawn & Garden) | <input type="checkbox"/> Injection Well                     |
| <input type="checkbox"/> Industrial | <input type="checkbox"/> Air Conditioning         | <input type="checkbox"/> Other _____                        |

Was a chemical/bacteriological sample submitted to Department? Yes  No

**5 TYPE OF BLANK CASING USED:**

- Steel  RMP (SR)  Wrought  Fiberglass  Other (Specify below)  
 PVC  ABS  Asbestos-Cement  Concrete Tile

Blank casing diameter 4 in. Was casing pulled? Yes  No  If yes, how much \_\_\_\_\_  
 Casing height above or below land surface >-12 in.

**6 GROUT PLUG MATERIAL:**  Neat cement  Cement grout  Bentonite  Other \_\_\_\_\_

Grout Plug Intervals: From 4 ft. to 146.15 ft., From \_\_\_\_\_ ft. to \_\_\_\_\_ ft., From \_\_\_\_\_ ft. to \_\_\_\_\_ ft.

What is the nearest source of possible contamination:

- |   |   |  |  |
|---|---|--|--|
| <input type="checkbox"/> Septic tank            | <input type="checkbox"/> Seepage pit    | <input checked="" type="checkbox"/> Fuel storage | <input type="checkbox"/> Other (specify below) |
| <input type="checkbox"/> Sewer lines            | <input type="checkbox"/> Pit privy      | <input type="checkbox"/> Fertilizer storage      |  |
| <input type="checkbox"/> Watertight sewer lines | <input type="checkbox"/> Sewage lagoon  | <input type="checkbox"/> Insecticide storage     |  |
| <input type="checkbox"/> Lateral lines          | <input type="checkbox"/> Feedyard       | <input type="checkbox"/> Abandoned water well    | Direction from well? _____                     |
| <input type="checkbox"/> Cess pool              | <input type="checkbox"/> Livestock pens | <input type="checkbox"/> Oil well/Gas well       | How many feet? _____                           |

FROM	TO	PLUGGING MATERIALS	FROM	TO	PLUGGING MATERIALS
0	4	Native Soil			Notes:
4	146.15	Bentonite Grout			Well vault & pad were left in place, approx. 1' bgs per Pam Chaffee/BOW approval. Fraction listed as NW SW NE on original well record
					Home Oil Bulk Plant: U6-090-00221

**7 CONTRACTOR'S OR LANDOWNER'S CERTIFICATION:** This water well was plugged under my jurisdiction and was completed on (mo/day/year) 8/31/17 and this record is true to the best of my knowledge and belief. Kansas Water Well Contractor's License No. 735. This Water Well Record was completed on (mo/day/year) 11/9/17 under the business name of MILCO Environmental Services, Inc. by (signature) *[Signature]*

Send one white copy to Kansas Department of Health & Environment, Geology Section, 1000 SW Jackson Street, Ste. 420, Topeka, KS 66612-1367. Send one copy to WATER WELL OWNER and retain one for your records.  
 Visit us at <http://www.kdheks.gov/waterwell/index.html> Telephone 785-296-5524.

C:\Projects\258\258-P1\_258P1001\New Quarterly Reports 1-19-2010\fig4-1.dwg  
 SAVED: 5/8/2017 2:32 PM  
 PLOTTED: 5/8/2017 2:33 PM

REVISIONS	BY

**MILCO**  
 Environmental  
 Services, Inc.  
 Kearney, NE (308) 237-5923  
 McCook, NE (308) 345-4741

HOME OIL  
**BTEX ISOCONCENTRATION MAP**  
 SELDEN, KANSAS U6-090-221  
This document, and the ideas and designs incorporated herein, as an instrument of professional service, is the property of Miller & Associates and is not to be used in whole or in part for any other project without the written authorization of Miller & Associates.

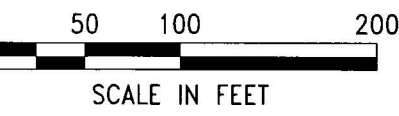
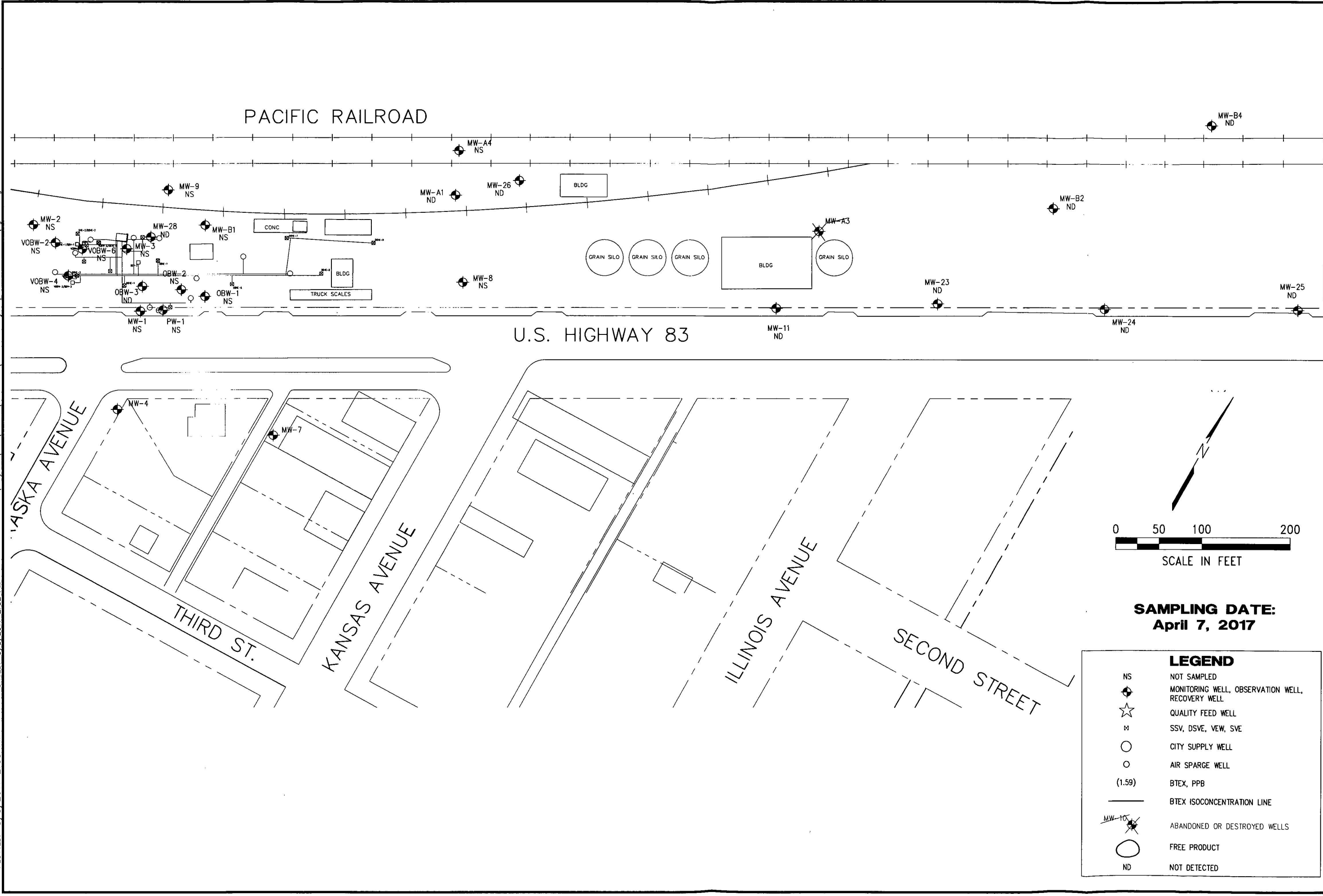

**SAMPLING DATE:**  
 April 7, 2017

LEGEND	
NS	NOT SAMPLED
◆	MONITORING WELL, OBSERVATION WELL, RECOVERY WELL
☆	QUALITY FEED WELL
M	SSV, DSVE, VEW, SVE
○	CITY SUPPLY WELL
○	AIR SPARGE WELL
(1.59)	BTEX, PPB
—	BTEX ISOCONCENTRATION LINE
◆ (with slash)	ABANDONED OR DESTROYED WELLS
○	FREE PRODUCT
ND	NOT DETECTED

VERIFY SCALES	
BAR IS ONE INCH ON ORIGINAL DRAWING	
IF NOT ONE INCH ON THIS SHEET, ADJUST SCALES ACCORDINGLY.	
SCALE:	1" = 100'
PROJECT NO.	M258-P1-001
DATE:	MAY, 2017
FIELD BOOK	M&A DWG NO.
DRAWN BY:	APRVD BY:
BSF	
SHEET	

**FIGURE 4-1**