

WATER WELL PLUGGING RECORD Form WWC-5P

KSA 82a-1212

ID NO.

OBW-3

1 LOCATION OF WATER WELL: County: <u>Sheridan</u>	Fraction <u>1/4 SE 1/4 NW 1/4 SW 1/4</u>	Section Number <u>9</u>	Township Number <u>T 6 S</u>	Range Number <u>29</u> <input type="checkbox"/> E <input checked="" type="checkbox"/> W
Street/Rural Address of Well Location; if unknown, distance & direction from nearest town or intersection: If at owner's address, check here <input type="checkbox"/>		Global Positioning Systems (GPS) information: Latitude: _____ (in decimal degrees) Longitude: _____ (in decimal degrees) Elevation: _____ Horizontal Datum: <input type="checkbox"/> WGS84, <input type="checkbox"/> NAD83, <input type="checkbox"/> NAD27 Collection Method: _____ <input type="checkbox"/> GPS unit (Make/Model: _____) <input type="checkbox"/> Digital Map/Photo, <input type="checkbox"/> Topographic Map, <input type="checkbox"/> Land Survey Est. Accuracy: <input type="checkbox"/> < 3 m, <input type="checkbox"/> 3-5 m, <input type="checkbox"/> 5-15 m, <input type="checkbox"/> > 15 m		

2 WATER WELL OWNER: Home Oil Company
 RR#, St. Address, Box #:
 City, State ZIP Code: Selden, KS 67757

3 MARK WELL'S LOCATION WITH AN "X" IN SECTION BOX:

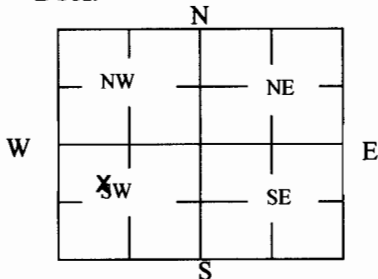

4 DEPTH OF WELL 136.20 **ft.**

WELL'S STATIC WATER LEVEL 132.20 **ft**

WELL WAS USED AS:

- | | | |
|-------------------------------------|---|---|
| <input type="checkbox"/> Domestic | <input type="checkbox"/> Public Water Supply | <input type="checkbox"/> Dewatering |
| <input type="checkbox"/> Irrigation | <input type="checkbox"/> Oil Field Water Supply | <input checked="" type="checkbox"/> Monitoring OBW-3 |
| <input type="checkbox"/> Feedlot | <input type="checkbox"/> Domestic (Lawn & Garden) | <input type="checkbox"/> Injection Well |
| <input type="checkbox"/> Industrial | <input type="checkbox"/> Air Conditioning | <input type="checkbox"/> Other _____ |

Was a chemical/bacteriological sample submitted to Department? Yes ☐ No ☒

5 TYPE OF BLANK CASING USED:

- | | | | | |
|---|-----------------------------------|--|--|--|
| <input checked="" type="checkbox"/> Steel | <input type="checkbox"/> RMP (SR) | <input type="checkbox"/> Wrought | <input type="checkbox"/> Fiberglass | <input type="checkbox"/> Other (Specify below) _____ |
| <input type="checkbox"/> PVC | <input type="checkbox"/> ABS | <input type="checkbox"/> Asbestos-Cement | <input type="checkbox"/> Concrete Tile | |

Blank casing diameter 4 in. Was casing pulled? Yes ☐ No ☒ If yes, how much _____
 Casing height above or below land surface >-12 in.

6 GROUT PLUG MATERIAL: ☐ Neat cement ☐ Cement grout ☒ Bentonite ☐ Other _____

Grout Plug Intervals: From 4 ft. to 136.20 ft., From _____ ft. to _____ ft., From _____ ft. to _____ ft.

What is the nearest source of possible contamination:

- | | | | |
|---|---|--|--|
| <input type="checkbox"/> Septic tank | <input type="checkbox"/> Seepage pit | <input checked="" type="checkbox"/> Fuel storage | <input type="checkbox"/> Other (specify below) _____ |
| <input type="checkbox"/> Sewer lines | <input type="checkbox"/> Pit privy | <input type="checkbox"/> Fertilizer storage | |
| <input type="checkbox"/> Watertight sewer lines | <input type="checkbox"/> Sewage lagoon | <input type="checkbox"/> Insecticide storage | |
| <input type="checkbox"/> Lateral lines | <input type="checkbox"/> Feedyard | <input type="checkbox"/> Abandoned water well | Direction from well? _____ |
| <input type="checkbox"/> Cess pool | <input type="checkbox"/> Livestock pens | <input type="checkbox"/> Oil well/Gas well | How many feet? _____ |

FROM	TO	PLUGGING MATERIALS	FROM	TO	PLUGGING MATERIALS
0	4	Native Soil			Notes:
4	136.20	Bentonite Grout			Well vault & pad were left in place,
					approx. 1' bgs per Pam Chaffee/BOW
					approval
					Home Oil Bulk Plant: U6-090-00221

7 CONTRACTOR'S OR LANDOWNER'S CERTIFICATION: This water well was plugged under my jurisdiction and was completed on (mo/day/year) 8/31/17 and this record is true to the best of my knowledge and belief. Kansas Water Well Contractor's License No. 735. This Water Well Record was completed on (mo/day/year) 11/9/17 under the business name of MILCO Environmental Services, Inc. by (signature) [Signature]

Send one white copy to Kansas Department of Health & Environment, Geology Section, 1000 SW Jackson Street, Ste. 420, Topeka, KS 66612-1367. Send one copy to WATER WELL OWNER and retain one for your records.

Visit us at <http://www.kdheks.gov/waterwell/index.html> Telephone 785-296-5524.

KSA82a-1212

Revised 1/20/2015

C:\Projects\258\258-P1\258P1001\New Quarterly Reports 1-19-2010\fig4-1.dwg

SAVED: 5/8/2017 2:32 PM

PLOTTED: 5/8/2017 2:33 PM

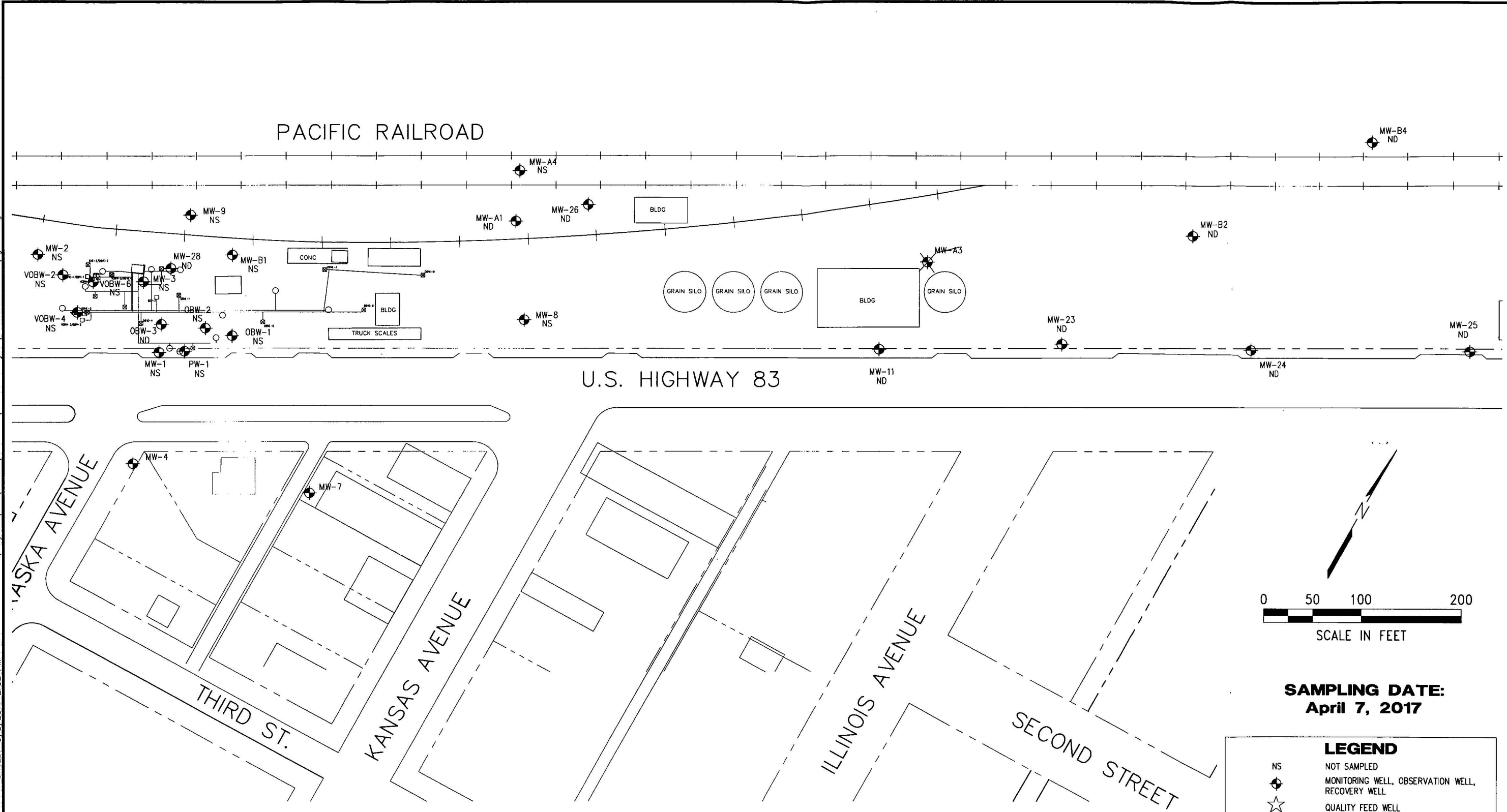

LEGEND

NS	NOT SAMPLED
◆	MONITORING WELL, OBSERVATION WELL, RECOVERY WELL
☆	QUALITY FEED WELL
M	SSV, DSVE, VEW, SVE
○	CITY SUPPLY WELL
○	AIR SPARGE WELL
(1.59)	BTEX, PPB
---	BTEX ISOCONCENTRATION LINE
✕	ABANDONED OR DESTROYED WELLS
○	FREE PRODUCT
ND	NOT DETECTED

REVISIONS	BY
MILCO Environmental Services, Inc. Kearney, NE (308) 237-5923 McCook, NE (308) 345-4741	
HOME OIL BTEX ISOCONCENTRATION MAP SELDEN, KANSAS U6-090-221	
This document, and the ideas and designs incorporated herein, as an instrument of professional service, is the property of Milco & Associates and is not to be used in whole or in part for any other project without the written authorization of Milco & Associates.	
VERIFY SCALES BAR IS ONE INCH ON ORIGINAL DRAWING 0 1" IF NOT ONE INCH ON THIS SHEET, ADJUST SCALES ACCORDINGLY. SCALE: 1" = 100' PROJECT NO. M258-P1-001 DATE: MAY, 2017 FIELD BOOK M&A DWG NO. DRAWN BY: BSF APRVD BY: SHEET	
FIGURE 4-1	