

WATER WELL PLUGGING RECORD Form WWC-5P

KSA 82a-1212 ID NO.

PW-1

1 LOCATION OF WATER WELL: Fraction 1/4 SE 1/4 NW 1/4 SW 1/4 Section Number 9 Township Number T 6 S Range Number 29 E W
 County: Sheridan

Street/Rural Address of Well Location; if unknown, distance & direction from nearest town or intersection: If at owner's address, check here

Global Positioning Systems (GPS) information:
 Latitude: _____ (in decimal degrees)
 Longitude: _____ (in decimal degrees)
 Elevation: _____
Horizontal Datum: WGS84, NAD83, NAD27
Collection Method:
 GPS unit (Make/Model: _____)
 Digital Map/Photo, Topographic Map, Land Survey
 Est. Accuracy: < 3 m, 3-5 m, 5-15 m, > 15 m

2 WATER WELL OWNER: Home Oil Company
 RR#, St. Address, Box #:
 City, State ZIP Code: Selden, KS 67557

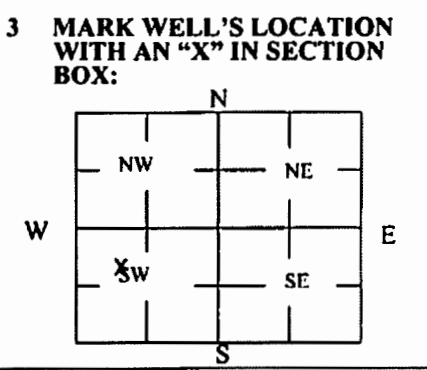

4 DEPTH OF WELL 154.45 ft.
 WELL'S STATIC WATER LEVEL 132.00 ft.
 WELL WAS USED AS:
 Domestic
 Irrigation
 Feedlot
 Industrial
 Public Water Supply
 Oil Field Water Supply
 Domestic (Lawn & Garden)
 Air Conditioning
 Dewatering Monitoring **PW-1**
 Injection Well
 Other _____
 Was a chemical/bacteriological sample submitted to Department? Yes No

5 TYPE OF BLANK CASING USED:
 Steel RMP (SR) Wrought Fiberglass Other (Specify below) _____
 PVC ABS Asbestos-Cement Concrete Tile
 Blank casing diameter 4 in. Was casing pulled? Yes No If yes, how much 3'
 Casing height above or below land surface -36 in.

6 GROUT PLUG MATERIAL: Neat cement Cement grout Bentonite Other _____
 Grout Plug Intervals: From 3 ft. to 154.45 ft., From _____ ft. to _____ ft., From _____ ft. to _____ ft.
 What is the nearest source of possible contamination:
 Septic tank Sewer lines Watertight sewer lines Lateral lines Cess pool
 Seepage pit Pit privy Sewage lagoon Feedyard Livestock pens
 Fuel storage Fertilizer storage Insecticide storage Abandoned water well Oil well/Gas well
 Other (specify below) _____
 Direction from well? _____
 How many feet? _____

FROM	TO	PLUGGING MATERIALS	FROM	TO	PLUGGING MATERIALS
0	3	Native Soil			Notes:
3	154.45	Bentonite Grout			Fraction listed as NW SW NE on original well record
					Home Oil Bulk Plant: U6-090-00221

7 CONTRACTOR'S OR LANDOWNER'S CERTIFICATION: This water well was plugged under my jurisdiction and was completed on (mo/day/year) 8/31/17 and this record is true to the best of my knowledge and belief. Kansas Water Well Contractor's License No. 735. This Water Well Record was completed on (mo/day/year) revised 12/10/17 under the business name of MILCO Environmental Services, Inc. by (signature) _____

Send one white copy to Kansas Department of Health & Environment, Geology Section, 1000 SW Jackson Street, Ste. 420, Topeka, KS 66612-1367. Send one copy to WATER WELL OWNER and retain one for your records.
 Visit us at <http://www.kdheks.gov/waterwell/index.html> Telephone 785-296-5524.

C:\Projects\258\258-P1_258P1001\New Quarterly Reports 1-19-2010\fig4-1.dwg
 SAVED: 5/8/2017 2:32 PM
 PLOTTED: 5/8/2017 2:33 PM

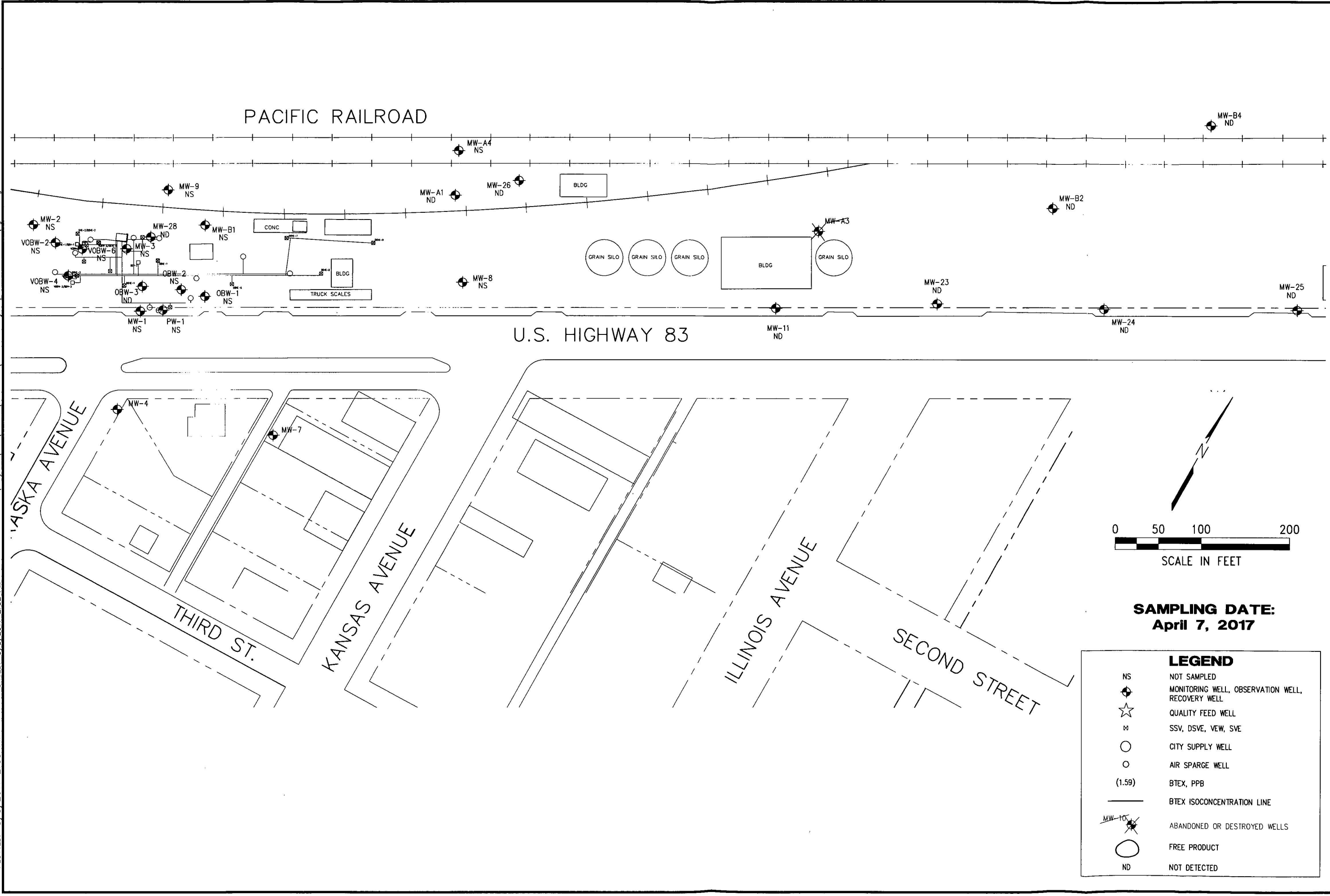

LEGEND

- NS NOT SAMPLED
- ◆ MONITORING WELL, OBSERVATION WELL, RECOVERY WELL
- ☆ QUALITY FEED WELL
- M SSV, DSVE, VEW, SVE
- CITY SUPPLY WELL
- AIR SPARGE WELL
- (1.59) BTEX, PPB
- BTEX ISOCONCENTRATION LINE
- ◆ (with slash) ABANDONED OR DESTROYED WELLS
- FREE PRODUCT
- ND NOT DETECTED

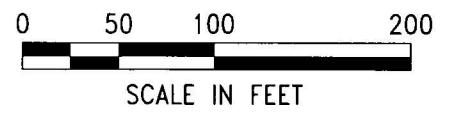

SAMPLING DATE:
April 7, 2017

REVISIONS	BY

MILCO
Environmental
Services, Inc.
Kearney, NE (308) 237-5923
McCook, NE (308) 345-4741

HOME OIL
BTEX ISOCONCENTRATION MAP
 SELDEN, KANSAS U6-090-221

This document, and the ideas and designs incorporated herein, as an instrument of professional service, is the property of Miller & Associates and is not to be used in whole or in part for any other project without the written authorization of Miller & Associates.

VERIFY SCALES
 BAR IS ONE INCH ON ORIGINAL DRAWING
 0 1"
 IF NOT ONE INCH ON THIS SHEET, ADJUST SCALES ACCORDINGLY.

SCALE: 1" = 100'
 PROJECT NO. M258-P1-001
 DATE: MAY, 2017
 FIELD BOOK M&A DWG NO.
 DRAWN BY: BSF APRVD BY:
 SHEET

FIGURE 4-1