

WATER WELL PLUGGING RECORD Form WWC-5P

KSA 82a-1212 ID NO.

DSVE-6

1 LOCATION OF WATER WELL: County: <u>Sheridan</u>	Fraction <u>¼ SE ¼ NW ¼ SW ¼</u>	Section Number <u>9</u>	Township Number <u>T 6 S</u>	Range Number <u>29</u> <input type="checkbox"/> E <input checked="" type="checkbox"/> W
---	-------------------------------------	----------------------------	---------------------------------	--

Street/Rural Address of Well Location; if unknown, distance & direction from nearest town or intersection: If at owner's address, check here Nebraska Avenue and Hwy 83

Global Positioning Systems (GPS) information:
 Latitude: _____ (in decimal degrees)
 Longitude: _____ (in decimal degrees)
 Elevation: _____
 Horizontal Datum: WGS84, NAD83, NAD27
 Collection Method: _____

2 WATER WELL OWNER: Don Porsch (deceased)
 RR#, St. Address, Box #:
 City, State ZIP Code: Selden, KS 67557

GPS unit (Make/Model): _____
 Digital Map/Photo, Topographic Map, Land Survey
 Est. Accuracy: < 3 m, 3-5 m, 5-15 m, > 15 m

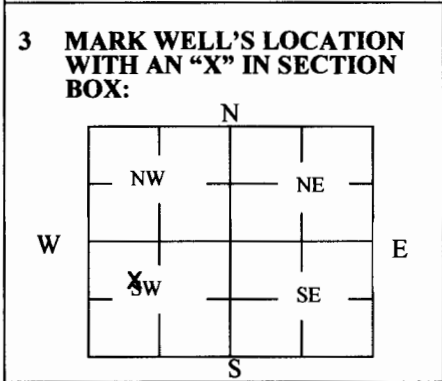

4 DEPTH OF WELL 122.10 ft.
 WELL'S STATIC WATER LEVEL DRY ft
 WELL WAS USED AS:
 Domestic Public Water Supply Dewatering
 Irrigation Oil Field Water Supply Monitoring
 Feedlot Domestic (Lawn & Garden) Injection Well
 Industrial Air Conditioning Other Remedial Well
 Was a chemical/bacteriological sample submitted to Department? Yes No DSVE-6

5 TYPE OF BLANK CASING USED:
 Steel RMP (SR) Wrought Fiberglass Other (Specify below)
 PVC ABS Asbestos-Cement Concrete Tile
 Blank casing diameter 4 in. Was casing pulled? Yes No If yes, how much _____
 Casing height above or below land surface >-12 in.

6 GROUT PLUG MATERIAL: Neat cement Cement grout Bentonite Other _____
 Grout Plug Intervals: From 4 ft. to 122.10 ft., From _____ ft. to _____ ft., From _____ ft. to _____ ft.
 What is the nearest source of possible contamination:
 Septic tank Seepage pit Fuel storage Other (specify below)
 Sewer lines Pit privy Fertilizer storage
 Watertight sewer lines Sewage lagoon Insecticide storage
 Lateral lines Feedyard Abandoned water well Direction from well? _____
 Cess pool Livestock pens Oil well/Gas well How many feet? _____

FROM	TO	PLUGGING MATERIALS	FROM	TO	PLUGGING MATERIALS
0	4	Native Soil			Notes:
4	122.10	Bentonite Grout			Well vault & pad were left in place, approx. 1' bgs per Pam Chaffee/BOW approval
					Home Oil Bulk Plant: U6-090-00221

7 CONTRACTOR'S OR LANDOWNER'S CERTIFICATION: This water well was plugged under my jurisdiction and was completed on (mo/day/year) 8/31/17 and this record is true to the best of my knowledge and belief. Kansas Water Well Contractor's License No. 735. This Water Well Record was completed on (mo/day/year) 11/9/17 under the business name of MILCO Environmental Services, Inc. by (signature) *[Signature]*

Send one white copy to Kansas Department of Health & Environment, Geology Section, 1000 SW Jackson Street, Ste. 420, Topeka, KS 66612-1367. Send one copy to WATER WELL OWNER and retain one for your records.
 Visit us at <http://www.kdheks.gov/waterwell/index.html> Telephone 785-296-5524.

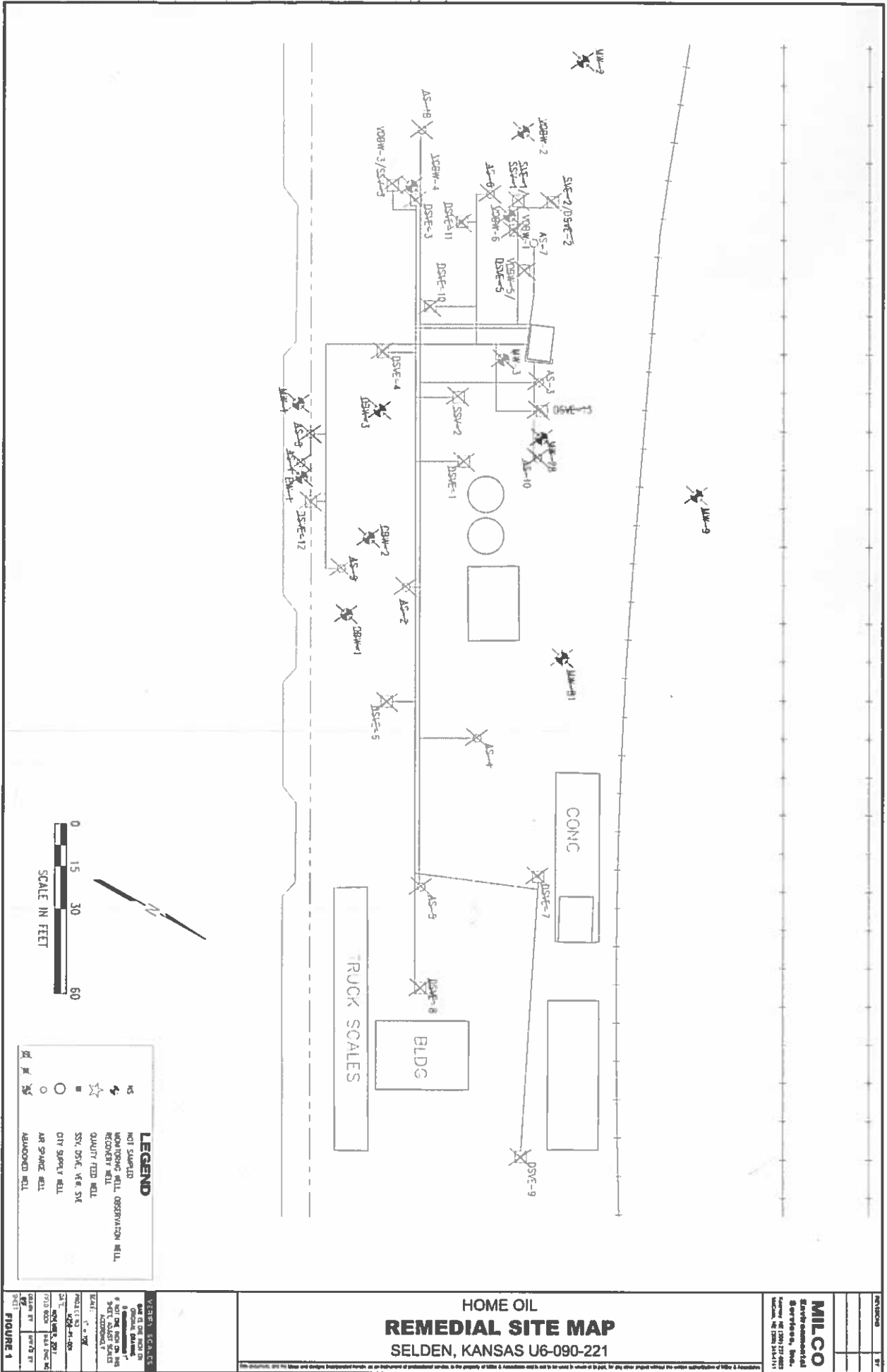

LEGEND

AS	NOT SAMPLED MONITORING WELL
DS	MONITORING WELL, OBSERVATION WELL
SS	RECOVERY WELL
VOBW	QUALITY FEED WELL
SSN	SSN, DSAC, VOBW
○	CITY SUPPLY WELL
○	AIR SPARGE WELL
○	ABANDONED WELL

FIGURE 1

DATE: 01/19/10
 DRAWN BY: JLD
 CHECKED BY: JLD
 SCALE: 1" = 60'
 PROJECT NO: U6-090-221
 SHEET NO: 10
 TOTAL SHEETS: 10

**HOME OIL
 REMEDIAL SITE MAP
 SELDEN, KANSAS U6-090-221**

MILCO
 Environmental
 2000 W. 10th St., Suite 100
 Selden, KS 66885
 Phone: 785.833.4477
 Fax: 785.833.4478

This document, and the data and design developed herein, are the property of remedial services, in the capacity of Miller & Associates and shall not be used in whole or in part, for any other project without the written authorization of Miller & Associates.