

WATER WELL PLUGGING RECORD Form WWC-5P

KSA 82a-1212

ID NO.

MW-3

1 LOCATION OF WATER WELL: County: Sheridan	Fraction ¼ SE ¼ NW ¼ SW ¼	Section Number 9	Township Number T 6 S	Range Number 29 <input type="checkbox"/> E <input checked="" type="checkbox"/> W
---	-------------------------------------	----------------------------	---------------------------------	--

Street/Rural Address of Well Location; if unknown, distance & direction from nearest town or intersection: If at owner's address, check here ☐

Global Positioning Systems (GPS) information:

Latitude: _____ (in decimal degrees)
 Longitude: _____ (in decimal degrees)
 Elevation: _____
 Horizontal Datum: ☐ WGS84, ☐ NAD83, ☐ NAD27
 Collection Method: _____

2 WATER WELL OWNER: Home Oil Company
 RR#, St. Address, Box #:
 City, State ZIP Code: **Selden, KS 67757**

☐ GPS unit (Make/Model: _____)
☐ Digital Map/Photo, ☐ Topographic Map, ☐ Land Survey
 Est. Accuracy: ☐ < 3 m, ☐ 3-5 m, ☐ 5-15 m, ☐ > 15 m

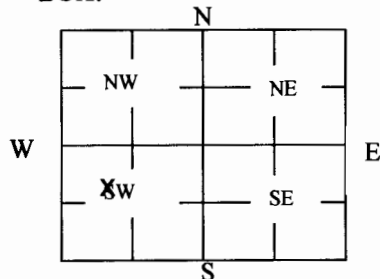
3 MARK WELL'S LOCATION WITH AN "X" IN SECTION BOX:**4 DEPTH OF WELL** 135.70 **ft.**WELL'S STATIC WATER LEVEL 133.38 **ft**

WELL WAS USED AS:

- | | | |
|-------------------------------------|---|---|
| <input type="checkbox"/> Domestic | <input type="checkbox"/> Public Water Supply | <input type="checkbox"/> Dewatering |
| <input type="checkbox"/> Irrigation | <input type="checkbox"/> Oil Field Water Supply | <input checked="" type="checkbox"/> Monitoring MW-3 |
| <input type="checkbox"/> Feedlot | <input type="checkbox"/> Domestic (Lawn & Garden) | <input type="checkbox"/> Injection Well |
| <input type="checkbox"/> Industrial | <input type="checkbox"/> Air Conditioning | <input type="checkbox"/> Other _____ |

Was a chemical/bacteriological sample submitted to Department? Yes ☐ No ☒**5 TYPE OF BLANK CASING USED:**

- ☐ Steel ☐ RMP (SR) ☐ Wrought ☐ Fiberglass ☐ Other (Specify below) _____
☒ PVC ☐ ABS ☐ Asbestos-Cement ☐ Concrete Tile

Blank casing diameter 4 in. Was casing pulled? Yes ☒ No ☐ If yes, how much 3'
 Casing height above or below land surface -36 in.

6 GROUT PLUG MATERIAL: ☐ Neat cement ☐ Cement grout ☒ Bentonite ☐ Other _____Grout Plug Intervals: From 3 ft. to 135.70 ft., From _____ ft. to _____ ft., From _____ ft. to _____ ft.

What is the nearest source of possible contamination:

- | | | | |
|---|---|--|--|
| <input type="checkbox"/> Septic tank | <input type="checkbox"/> Seepage pit | <input checked="" type="checkbox"/> Fuel storage | <input type="checkbox"/> Other (specify below) _____ |
| <input type="checkbox"/> Sewer lines | <input type="checkbox"/> Pit privy | <input type="checkbox"/> Fertilizer storage | |
| <input type="checkbox"/> Watertight sewer lines | <input type="checkbox"/> Sewage lagoon | <input type="checkbox"/> Insecticide storage | |
| <input type="checkbox"/> Lateral lines | <input type="checkbox"/> Feedyard | <input type="checkbox"/> Abandoned water well | Direction from well? _____ |
| <input type="checkbox"/> Cess pool | <input type="checkbox"/> Livestock pens | <input type="checkbox"/> Oil well/Gas well | How many feet? _____ |

FROM	TO	PLUGGING MATERIALS	FROM	TO	PLUGGING MATERIALS
0	3	Native Soil			Notes:
3	135.70	Bentonite Grout			Home Oil Bulk Plant: U6-090-00221

7 CONTRACTOR'S OR LANDOWNER'S CERTIFICATION: This water well was plugged under my jurisdiction and was completed on (mo/day/year) 8/31/17 and this record is true to the best of my knowledge and belief. Kansas Water Well Contractor's License No. 735. This Water Well Record was completed on (mo/day/year) 11/9/17 under the business name of MILCO Environmental Services, Inc. by (signature) [Signature]

Send one white copy to Kansas Department of Health & Environment, Geology Section, 1000 SW Jackson Street, Ste. 420, Topeka, KS 66612-1367. Send one copy to WATER WELL OWNER and retain one for your records.

Visit us at <http://www.kdheks.gov/waterwell/index.html> Telephone 785-296-5524.

KSA82a-1212

Revised 1/20/2015

C:\Projects\258\258-P1\258P1001\New Quarterly Reports 1-19-2010\fig4-1.dwg

SAVED: 5/8/2017 2:32 PM

PLOTTED: 5/8/2017 2:33 PM

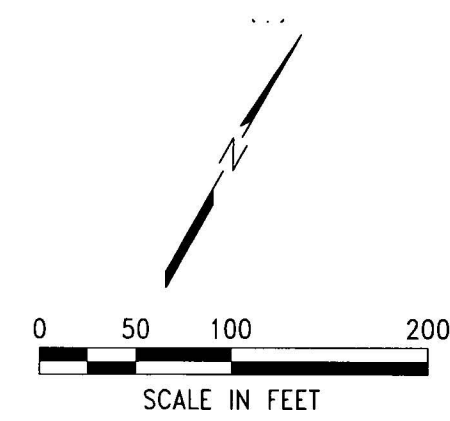
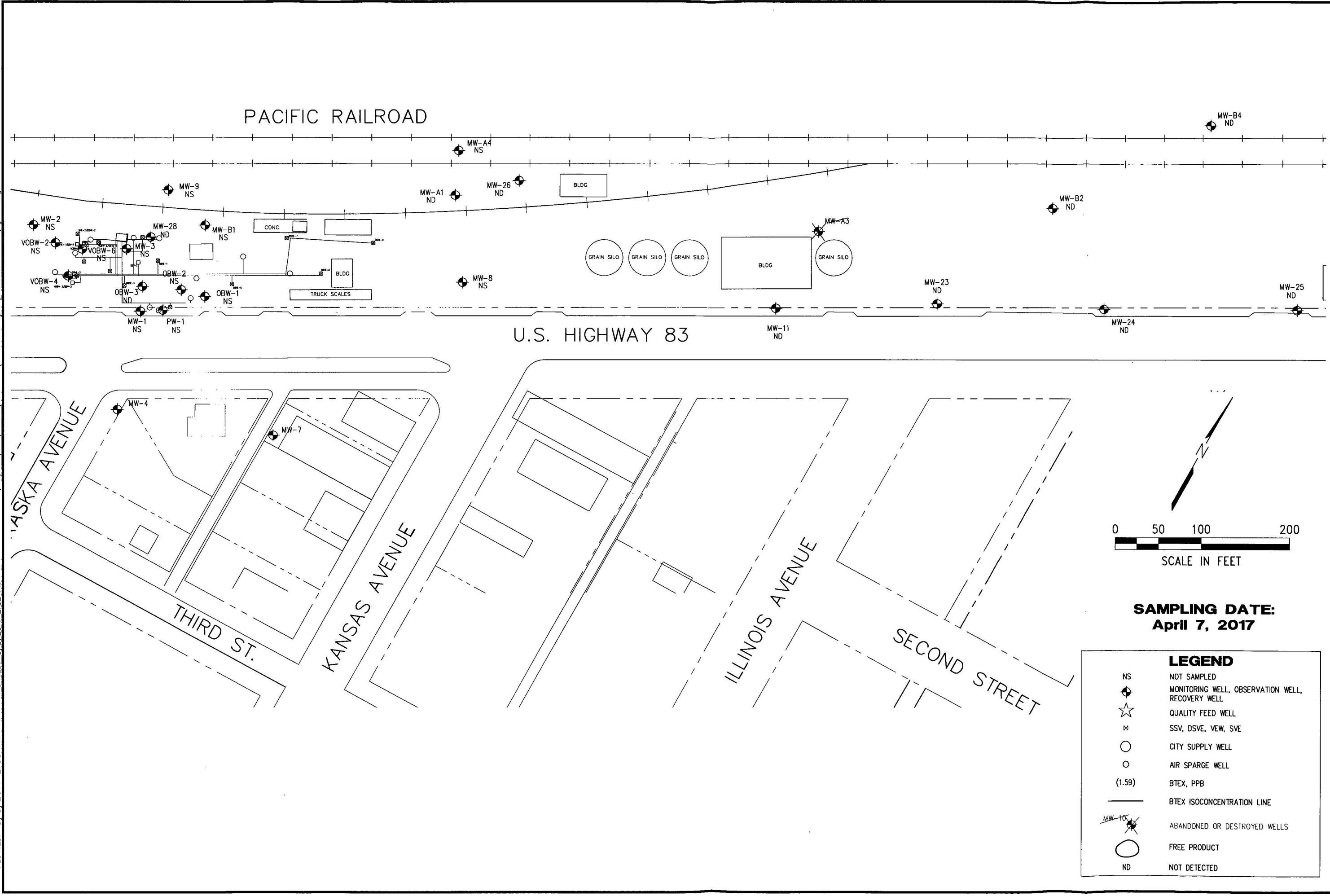

SAMPLING DATE:
April 7, 2017

LEGEND	
NS	NOT SAMPLED
MW	MONITORING WELL, OBSERVATION WELL, RECOVERY WELL
VOBW	QUALITY FEED WELL
OBW	SSV, DSVE, VEW, SVE
PW	CITY SUPPLY WELL
MW-A	AIR SPARGE WELL
MW-B	BTEX, PPB
MW-C	BTEX ISOCONCENTRATION LINE
MW-D	ABANDONED OR DESTROYED WELLS
MW-E	FREE PRODUCT
MW-F	NOT DETECTED

REVISIONS	BY

MILCO
Environmental
Services, Inc.
Kearney, NE (308) 237-5923
McCook, NE (308) 345-4741

HOME OIL
BTEX ISOCONCENTRATION MAP
SELDEN, KANSAS U6-090-221

VERIFY SCALES
BAR IS ONE INCH ON ORIGINAL DRAWING
0 1"
IF NOT ONE INCH ON THIS SHEET, ADJUST SCALES ACCORDINGLY.
SCALE: 1" = 100'
PROJECT NO. M258-P1-001
DATE: MAY, 2017
FIELD BOOK M&A DWG NO.
DRAWN BY: BSF
APRVD BY: SHEET

FIGURE 4-1