

**WATER WELL PLUGGING RECORD Form WWC-5P**

KSA 82a-1212

ID NO.

VOBW-2

<b>1 LOCATION OF WATER WELL:</b> County: <b>Sheridan</b>	Fraction <b>¼SW ¼ NW ¼ SW ¼</b>	Section Number <b>9</b>	Township Number <b>T 6 S</b>	Range Number <b>29</b> <input type="checkbox"/> E <input checked="" type="checkbox"/> W
---	------------------------------------	----------------------------	---------------------------------	--

Street/Rural Address of Well Location; if unknown, distance & direction from nearest town or intersection: If at owner's address, check here

**Global Positioning Systems (GPS) information:**  
 Latitude: \_\_\_\_\_ (in decimal degrees)  
 Longitude: \_\_\_\_\_ (in decimal degrees)  
 Elevation: \_\_\_\_\_  
 Horizontal Datum:  WGS84,  NAD83,  NAD27  
 Collection Method: \_\_\_\_\_

**2 WATER WELL OWNER:** Home Oil Company  
 RR#, St. Address, Box #:  
 City, State ZIP Code: **Selden, KS 67757**

GPS unit (Make/Model): \_\_\_\_\_  
 Digital Map/Photo,  Topographic Map,  Land Survey  
 Est. Accuracy:  < 3 m,  3-5 m,  5-15 m,  > 15 m

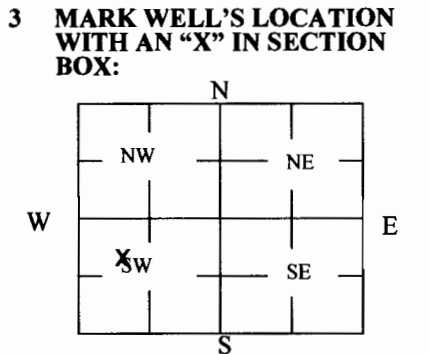

**4 DEPTH OF WELL** 54.00 ft.  
 WELL'S STATIC WATER LEVEL DRY ft.  
 WELL WAS USED AS:  
 Domestic Irrigation Feedlot Industrial  
 Public Water Supply Oil Field Water Supply Domestic (Lawn & Garden) Air Conditioning  
 Dewatering Monitoring **VOBW-2**  
 Injection Well  
 Other \_\_\_\_\_  
 Was a chemical/bacteriological sample submitted to Department? Yes  No

**5 TYPE OF BLANK CASING USED:**

Steel  PVC  RMP (SR)  ABS  Wrought  Asbestos-Cement  Fiberglass  Concrete Tile  Other (Specify below) \_\_\_\_\_

Blank casing diameter 2 in. Was casing pulled? Yes  No  If yes, how much 3'  
 Casing height above or below land surface -36 in.

**6 GROUT PLUG MATERIAL:**  Neat cement  Cement grout  Bentonite  Other \_\_\_\_\_

Grout Plug Intervals: From 3 ft. to 54.00 ft., From \_\_\_\_\_ ft. to \_\_\_\_\_ ft., From \_\_\_\_\_ ft. to \_\_\_\_\_ ft.

What is the nearest source of possible contamination:  
 Septic tank  Sewer lines  Watertight sewer lines  Lateral lines  Cess pool  
 Seepage pit  Pit privy  Sewage lagoon  Feedyard  Livestock pens  
 Fuel storage  Fertilizer storage  Insecticide storage  Abandoned water well  Oil well/Gas well  
 Other (specify below) \_\_\_\_\_  
 Direction from well? \_\_\_\_\_  
 How many feet? \_\_\_\_\_

FROM	TO	PLUGGING MATERIALS	FROM	TO	PLUGGING MATERIALS
0	3	Native Soil			Notes:
3	54.00	Bentonite Grout			Home Oil Bulk Plant:U6-090-00221

**7 CONTRACTOR'S OR LANDOWNER'S CERTIFICATION:** This water well was plugged under my jurisdiction and was completed on (mo/day/year) 8/31/17 and this record is true to the best of my knowledge and belief. Kansas Water Well Contractor's License No. 735. This Water Well Record was completed on (mo/day/year) 11/9/17 under the business name of MILCO Environmental Services, Inc. by (signature) *[Signature]*

Send one white copy to Kansas Department of Health & Environment, Geology Section, 1000 SW Jackson Street, Ste. 420, Topeka, KS 66612-1367. Send one copy to WATER WELL OWNER and retain one for your records.  
 Visit us at <http://www.kdheks.gov/waterwell/index.html> Telephone 785-296-5524.

C:\Projects\258\258-P1\_258P1001\New Quarterly Reports 1-19-2010\fig4-1.dwg  
 PLOTTED: 5/8/2017 2:33 PM  
 SAVED: 5/8/2017 2:32 PM

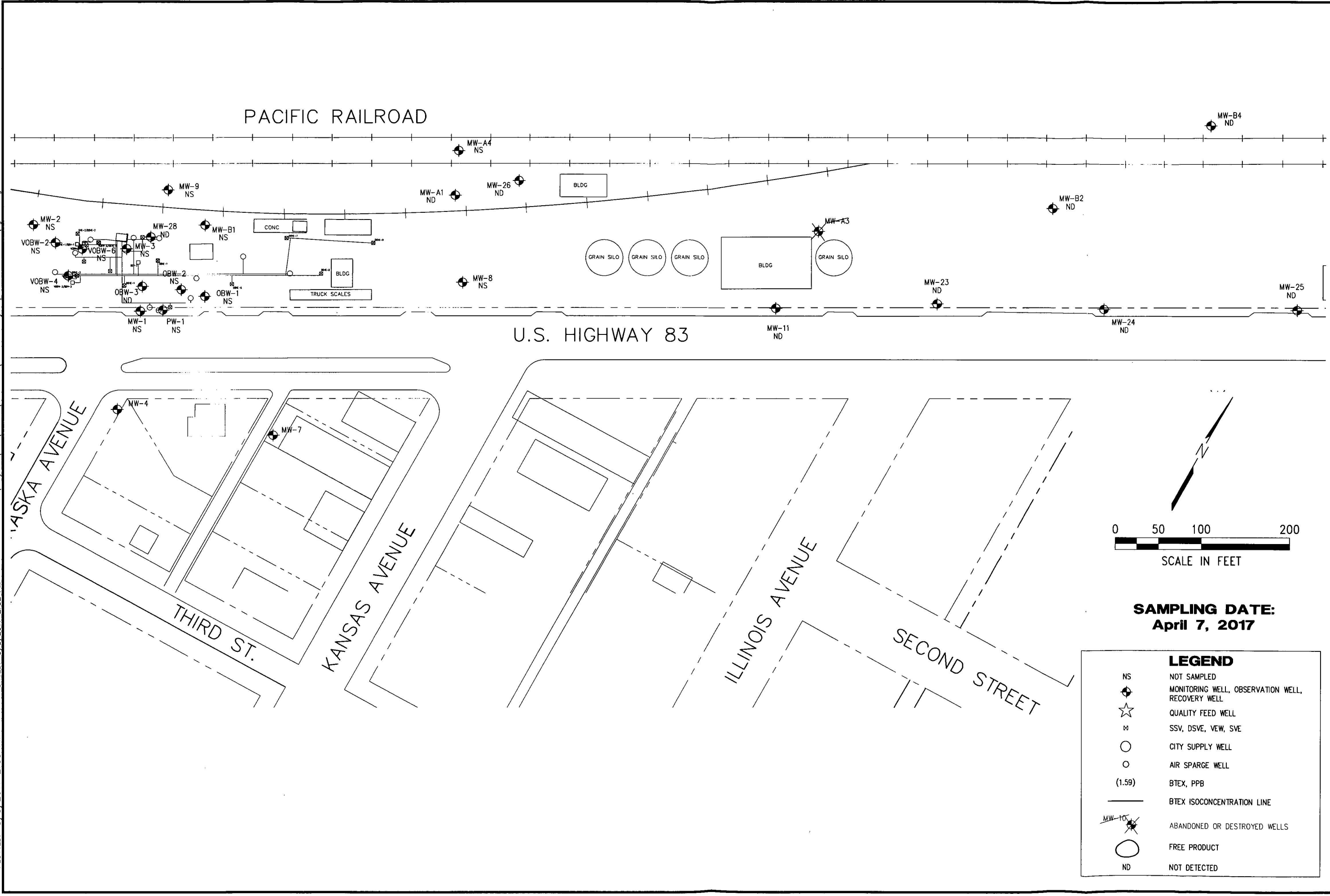

**SAMPLING DATE:**  
April 7, 2017

**LEGEND**

- NS NOT SAMPLED
- ◆ MONITORING WELL, OBSERVATION WELL, RECOVERY WELL
- ☆ QUALITY FEED WELL
- M SSV, DSVE, VEW, SVE
- CITY SUPPLY WELL
- AIR SPARGE WELL
- (1.59) BTEX, PPB
- BTEX ISOCONCENTRATION LINE
- ◆ (with slash) ABANDONED OR DESTROYED WELLS
- FREE PRODUCT
- ND NOT DETECTED

REVISIONS	BY

**MILCO**  
Environmental Services, Inc.  
Kearney, NE (308) 237-5923  
McCook, NE (308) 345-4741

HOME OIL  
**BTEX ISOCONCENTRATION MAP**  
 SELDEN, KANSAS U6-090-221

This document, and the ideas and designs incorporated herein, as an instrument of professional service, is the property of Miller & Associates and is not to be used in whole or in part for any other project without the written authorization of Miller & Associates.

**VERIFY SCALES**  
 BAR IS ONE INCH ON ORIGINAL DRAWING  
 0 1"  
 IF NOT ONE INCH ON THIS SHEET, ADJUST SCALES ACCORDINGLY.

SCALE: 1" = 100'  
 PROJECT NO. M258-P1-001  
 DATE: MAY, 2017  
 FIELD BOOK M&A DWG NO.  
 DRAWN BY: BSF APRVD BY:  
 SHEET

**FIGURE 4-1**