

**WATER WELL PLUGGING RECORD Form WWC-5P**

KSA 82a-1212 ID NO.

**VOBW-6**

<b>1 LOCATION OF WATER WELL:</b> County: <b>Sheridan</b>	Fraction <b>¼ SW ¼ NW ¼ SW ¼</b>	Section Number <b>9</b>	Township Number <b>T 6 S</b>	Range Number <b>29</b> <input type="checkbox"/> E <input checked="" type="checkbox"/> W
---	-------------------------------------	----------------------------	---------------------------------	--

Street/Rural Address of Well Location; if unknown, distance & direction from nearest town or intersection: If at owner's address, check here

**Global Positioning Systems (GPS) information:**  
 Latitude: \_\_\_\_\_ (in decimal degrees)  
 Longitude: \_\_\_\_\_ (in decimal degrees)  
 Elevation: \_\_\_\_\_  
**Horizontal Datum:**  WGS84,  NAD83,  NAD27  
**Collection Method:**  
 GPS unit (Make/Model: \_\_\_\_\_)  
 Digital Map/Photo,  Topographic Map,  Land Survey  
 Est. Accuracy:  < 3 m,  3-5 m,  5-15 m,  > 15 m

**2 WATER WELL OWNER:** Home Oil Company  
 RR#, St. Address, Box #:  
 City, State ZIP Code: **Selden, KS 67757**

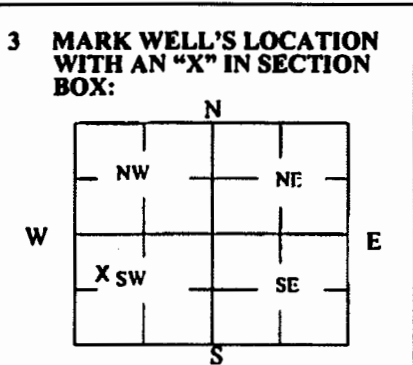

**4 DEPTH OF WELL** 136.70 ft.  
**WELL'S STATIC WATER LEVEL** 133.03 ft  
**WELL WAS USED AS:**  
 Domestic Irrigation  Public Water Supply  Dewatering Monitoring **VOBW-6**  
 Feedlot  Oil Field Water Supply  Injection Well  
 Industrial  Air Conditioning  Other \_\_\_\_\_  
 Was a chemical/bacteriological sample submitted to Department? Yes  No

**5 TYPE OF BLANK CASING USED:**  
 Steel  RMP (SR)  Wrought  Fiberglass  Other (Specify below)  
 PVC  ABS  Asbestos-Cement  Concrete Tile  
 Blank casing diameter 4 in. Was casing pulled? Yes  No  If yes, how much 3'  
 Casing height above or below land surface -.36 in.

**6 GROUT PLUG MATERIAL:**  Neat cement  Cement grout  Bentonite  Other \_\_\_\_\_  
 Grout Plug Intervals: From 3 ft. to 136.70 ft., From \_\_\_\_\_ ft. to \_\_\_\_\_ ft., From \_\_\_\_\_ ft. to \_\_\_\_\_ ft.  
**What is the nearest source of possible contamination:**  
 Septic tank  Seepage pit  Fuel storage  Other (specify below)  
 Sewer lines  Pit privy  Fertilizer storage  
 Watertight sewer lines  Sewage lagoon  Insecticide storage  
 Lateral lines  Feedyard  Abandoned water well Direction from well? \_\_\_\_\_  
 Cess pool  Livestock pens  Oil well/Gas well How many feet? \_\_\_\_\_

FROM	TO	PLUGGING MATERIALS	FROM	TO	PLUGGING MATERIALS
0	3	Native Soil			Notes:
3	136.70	Bentonite Grout			Home Oil Bulk Plant: U6-090-00221

**7 CONTRACTOR'S OR LANDOWNER'S CERTIFICATION:** This water well was plugged under my jurisdiction and was completed on (mo/day/year) 8/31/17 and this record is true to the best of my knowledge and belief. Kansas Water Well Contractor's License No. 735. This Water Well Record was completed on (mo/day/year) Revised 12/15/17 under the business name of MILCO Environmental Services, Inc. by (signature) *[Signature]*

C:\Projects\258\258-P1\_258P1001\New Quarterly Reports 1-19-2010\fig4-1.dwg  
 SAVED: 5/8/2017 2:32 PM  
 PLOTTED: 5/8/2017 2:33 PM

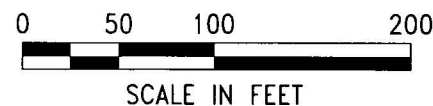
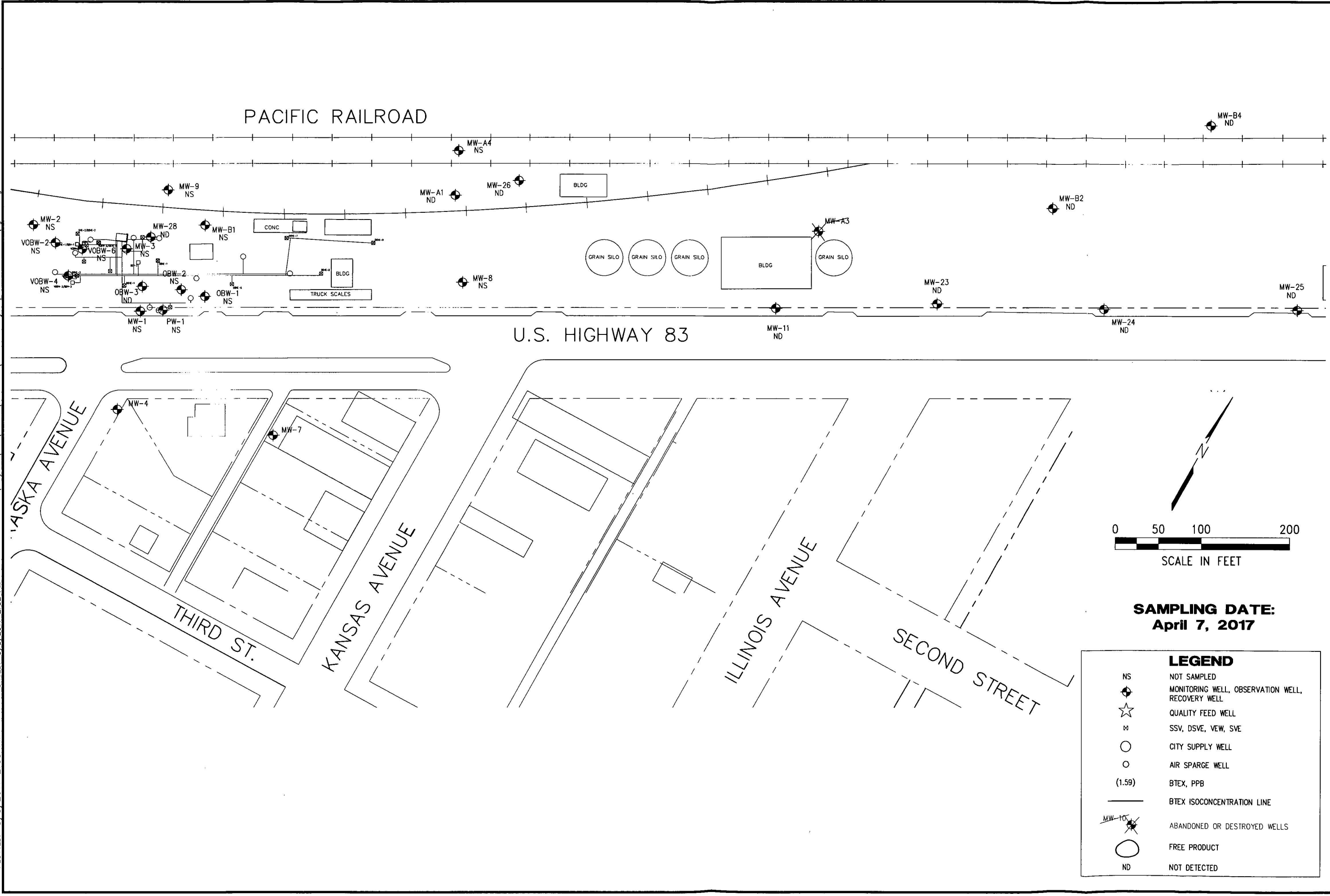

**SAMPLING DATE:**  
April 7, 2017

LEGEND	
NS	NOT SAMPLED
◆	MONITORING WELL, OBSERVATION WELL, RECOVERY WELL
☆	QUALITY FEED WELL
M	SSV, DSVE, VEW, SVE
○	CITY SUPPLY WELL
○	AIR SPARGE WELL
(1.59)	BTEX, PPB
---	BTEX ISOCONCENTRATION LINE
⊗	ABANDONED OR DESTROYED WELLS
○	FREE PRODUCT
ND	NOT DETECTED

REVISIONS BY

**MILCO**  
Environmental Services, Inc.  
Kearney, NE (308) 237-5923  
McCook, NE (308) 345-4741

HOME OIL  
**BTEX ISOCONCENTRATION MAP**  
 SELDEN, KANSAS U6-090-221

This document, and the ideas and designs incorporated herein, as an instrument of professional service, is the property of Miller & Associates and is not to be used in whole or in part for any other project without the written authorization of Miller & Associates.

VERIFY SCALES	
BAR IS ONE INCH ON ORIGINAL DRAWING	
IF NOT ONE INCH ON THIS SHEET, ADJUST SCALES ACCORDINGLY.	
SCALE:	1" = 100'
PROJECT NO.	M258-P1-001
DATE:	MAY, 2017
FIELD BOOK	M&A DWG NO.
DRAWN BY:	APRVD BY:
BSF	
SHEET	

**FIGURE 4-1**