

| | | | | | |
|--|----|---|--|--|--|
| 1 LOCATION OF WATER WELL: County: Sheridan | | Fraction NE NW SW NW 1/4 SW 1/4 NE 1/4 | Section Number 9 | Township Number T 6 S | Range Number R 29 EW |
| Distance and direction from nearest town or city street address of well if located within city? | | | | | |
| 2 WATER WELL OWNER: Home Oil Co. RR#, St. Address, Box # : 212 W. Railroad City, State, ZIP Code : Selden, Ks. 67757 | | | | | |
| | | | Board of Agriculture, Division of Water Resources MW #8 Application Number: | | |
| 3 LOCATE WELL'S LOCATION WITH AN "X" IN SECTION BOX: | | 4 DEPTH OF COMPLETED WELL 145 ft. ELEVATION: | | | |
| | | Depth(s) Groundwater Encountered 1. ft. 2. ft. 3. ft. | | | |
| | | WELL'S STATIC WATER LEVEL 123.01 ft. below land surface measured on mo/day/yr | | | |
| | | Pump test data: Well water was ft. after hours pumping gpm | | | |
| | | Est. Yield gpm Well water was ft. after hours pumping gpm | | | |
| | | Bore Hole Diameter in. to 145 ft., and in. to ft. | | | |
| | | WELL WATER TO BE USED AS: | | | |
| | | 5 Public water supply 8 Air conditioning 11 Injection well 1 Domestic 3 Feedlot 6 Oil field water supply 9 Dewatering 12 Other (Specify below) 2 Irrigation 4 Industrial 7 Lawn and garden only 10 Monitoring well | | | |
| | | Was a chemical/bacteriological sample submitted to Department? Yes No X If yes, mo/day/yr sample was submitted | | | |
| | | Water Well Disinfected? Yes No X | | | |
| 5 TYPE OF BLANK CASING USED: | | | | | |
| 1 Steel 3 RMP (SR) | | 5 Wrought iron 8 Concrete tile | | CASING JOINTS: Glued Clamped | |
| 2 PVC 4 ABS | | 6 Asbestos-Cement 9 Other (specify below) | | Welded | |
| | | 7 Fiberglass | | Threaded X | |
| Blank casing diameter 4 in. to 115 ft. Dia | | in. to ft. Dia | | in. to ft. | |
| Casing height above land surface 0 in., weight 2.071 lbs./ft. | | Wall thickness or gauge No. 237 | | | |
| TYPE OF SCREEN OR PERFORATION MATERIAL: | | | | | |
| 1 Steel 3 Stainless steel 5 Fiberglass 8 RMP (SR) | | 7 PVC 10 Asbestos-cement | | 11 Other (specify) | |
| 2 Brass 4 Galvanized steel 6 Concrete tile 9 ABS | | 12 None used (open hole) | | | |
| SCREEN OR PERFORATION OPENINGS ARE: | | | | | |
| 1 Continuous slot 3 Mill slot 5 Gauzed wrapped 8 Saw cut 11 None (open hole) | | 6 Wire wrapped 9 Drilled holes | | | |
| 2 Louvered shutter 4 Key punched 7 Torch cut 10 Other (specify) | | | | | |
| SCREEN-PERFORATED INTERVALS: From 115 ft. to 145 ft. From ft. to ft. | | | | | |
| GRAVEL PACK INTERVALS: From 110 ft. to 145 ft. From ft. to ft. | | | | | |
| 6 GROUT MATERIAL: 1 Neat cement 2 Cement grout 3 Bentonite 4 Other | | | | | |
| Grout Intervals: From 0 ft. to 3 ft. From 3 ft. to 110 ft. From ft. to ft. | | | | | |
| What is the nearest source of possible contamination: | | | | | |
| 1 Septic tank 4 Lateral lines 7 Pit privy 10 Livestock pens 14 Abandoned water well | | 11 Fuel storage 15 Oil well/Gas well | | 16 Other (specify below) | |
| 2 Sewer lines 5 Cess pool 8 Sewage lagoon 12 Fertilizer storage 13 Insecticide storage | | Removed Fuel Storage | | | |
| 3 Watertight sewer lines 6 Seepage pit 9 Feedyard | | | | | |
| Direction from well? How many feet? | | | | | |
| FROM TO LITHOLOGIC LOG | | | FROM TO PLUGGING INTERVALS | | |
| 0 | 2 | Surface | 92 | 95 | Med. Sand & Gravel w/Clay St. |
| 2 | 20 | Loess | 95 | 99.5 | Sandy Clay Caliche & S.Sand |
| 20 | 34 | Sandy Clay, Caliche & Some Sand | 99.5 | 120 | Sandy Clay & Caliche w/ |
| 34 | 42 | Fine Sand w/Clay Strks. | | | Cemented Sand Strks. |
| 42 | 46 | Clay Caliche, Cemented Sand & a little Fine Sand | 120 | 127 | Caliche, Cemented Sand, Clay & Hard Sand |
| 46 | 50 | Fine Sand w/a few Clay Strks. | 127 | 140 | Fine to Med. Sand w/Clay & Cemented Strks. |
| 50 | 60 | Med. Sand & Gravel | | | |
| 60 | 68 | Cemented Sand w/Fine Sand & Clay Strks. | 140 | 145 | Fine to Med. Sand w/a few Clay Strks. |
| 68 | 70 | Sandy Clay | | | |
| 70 | 78 | Fine to Med. Sand & Gravel w/ Clay Strks. | | | |
| 78 | 80 | Sandy Clay w/Sand Strks. | | | |
| 80 | 92 | Sandy Clay & Caliche w/a little Sand | | | |
| 7 CONTRACTOR'S OR LANDOWNER'S CERTIFICATION: This water well was (1) constructed, (2) reconstructed, or (3) plugged under my jurisdiction and was completed on (mo/day/year) 3-30-95 and this record is true to the best of my knowledge and belief. Kansas Water Well Contractor's License No. 554 This Water Well Record was completed on (mo/day/yr) 3-31-95 under the business name of Woofter Pump & Well, Inc. by (signature) <i>[Signature]</i> | | | | | |
| INSTRUCTIONS: Use typewriter or ball point pen. PLEASE PRESS FIRMLY and PRINT clearly. Please fill in blanks, underline or circle the correct answers. Send top three copies to Kansas Department of Health and Environment, Bureau of Water, Topeka, Kansas 66620-0001. Telephone: 913-296-5545. Send one to WATER WELL OWNER and retain one for your records. | | | | | |

PLOTTED: 5/8/2017 2:33 PM
SAVED: 5/8/2017 2:32 PM
C:\Projects\258\258-P1\258P1001\New Quarterly Reports 1-19-2010\fig4-1.dwg

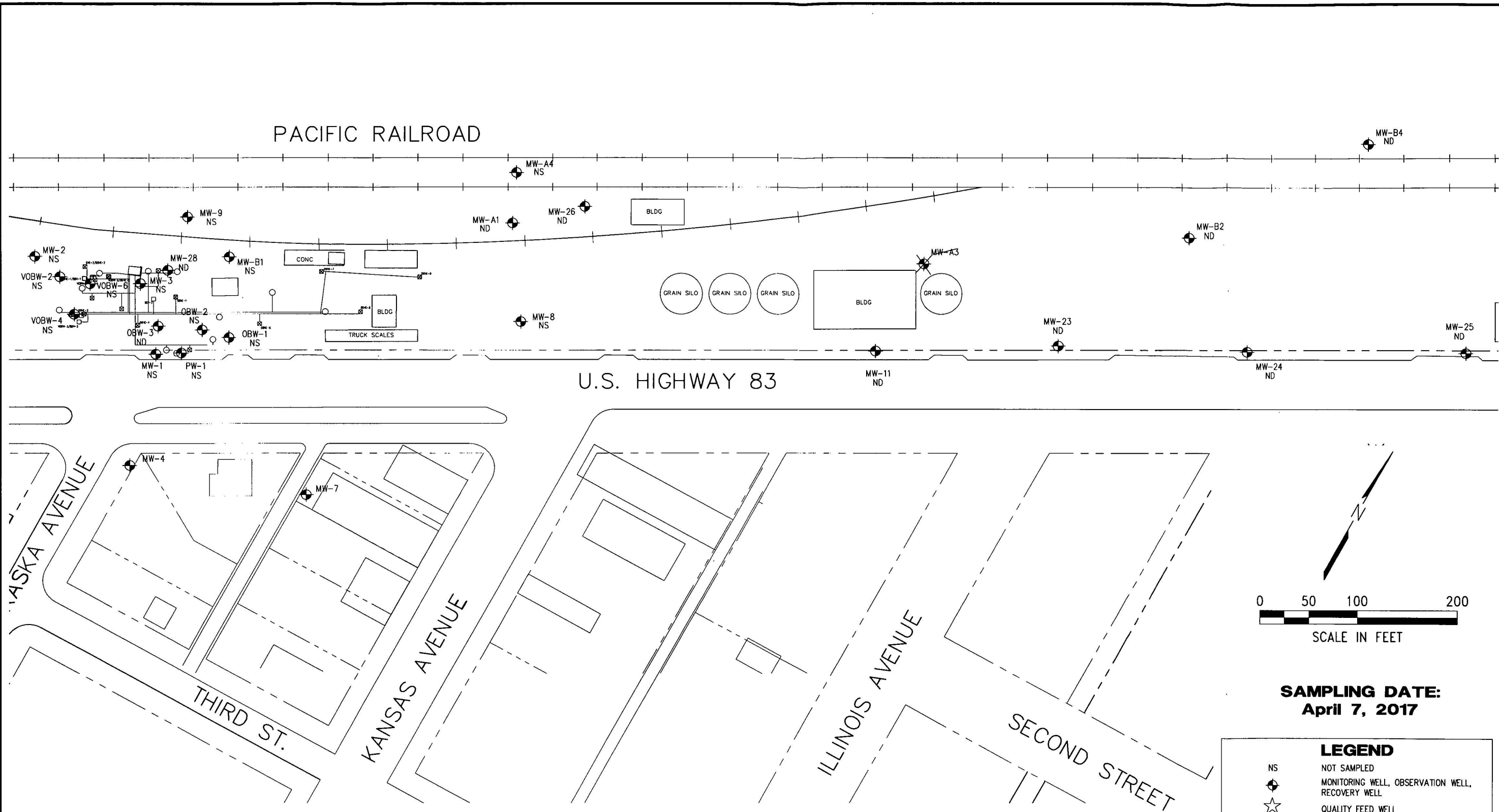

LEGEND

- NS NOT SAMPLED
- MW MONITORING WELL, OBSERVATION WELL, RECOVERY WELL
- VOBW QUALITY FEED WELL
- SSV SSV, DSVE, VEW, SVE
- CITY SUPPLY WELL
- AIR SPARGE WELL
- (1.59) BTEX, PPB
- BTEX ISOCONCENTRATION LINE
- ABANDONED OR DESTROYED WELLS
- FREE PRODUCT
- ND NOT DETECTED

| REVISIONS | BY |
|-----------|----|
| | |
| | |
| | |

MILCO
Environmental
Services, Inc.
Kearney, NE (308) 237-5923
McCook, NE (308) 345-4741

HOME OIL
BTEX ISOCONCENTRATION MAP
SELDEN, KANSAS U6-090-221

This document and the ideas and designs incorporated herein, as an instrument of professional service, is the property of Milco & Associates and is not to be used in whole or in part for any other project without the written authorization of Milco & Associates.

VERIFY SCALES
BAR IS ONE INCH ON ORIGINAL DRAWING
0 1"
IF NOT ONE INCH ON THIS SHEET, ADJUST SCALES ACCORDINGLY.

SCALE: 1" = 100'
PROJECT NO. M258-P1-001
DATE: MAY, 2017
FIELD BOOK M&A DWG NO.
DRAWN BY: BSF
APRVD BY: SHEET

FIGURE 4-1