

OBW 1
 Range Number 29

1 LOCATION OF WATER WELL: County: **Sheridan** Fraction **SE NW SW** Section Number **9** Township Number **T 6 S** Range Number **R 29**

Distance and direction from nearest town or city street address of well if located within city?

2 WATER WELL OWNER: **Home Oil Co.**
 RR#, St. Address, Box #: **212 W. Railroad** Board of Agriculture, Division of Water Resources
 City, State, ZIP Code: **Selden, Ks. 67757** OBW #1 Application Number:

3 LOCATE WELL'S LOCATION WITH AN "X" IN SECTION BOX:

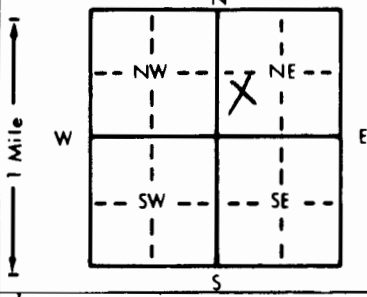

4 DEPTH OF COMPLETED WELL: **145** ft. ELEVATION:
 Depth(s) Groundwater Encountered 1. ft. 2. ft. 3. ft.
 WELL'S STATIC WATER LEVEL **123.83** ft. below land surface measured on mo/day/yr
 Pump test data: Well water was ft. after hours pumping gpm
 Est. Yield gpm: Well water was ft. after hours pumping gpm
 Bore Hole Diameter: **8** in. to **145** ft., and in. to ft.
 WELL WATER TO BE USED AS: 5 Public water supply 8 Air conditioning 11 Injection well
 1 Domestic 3 Feedlot 6 Oil field water supply 9 Dewatering 12 Other (Specify below)
 2 Irrigation 4 Industrial 7 Lawn and garden only 10 Monitoring well
 Was a chemical/bacteriological sample submitted to Department? Yes No **X** If yes, mo/day/yr sample was submitted
 Water Well Disinfected? Yes No **X**

5 TYPE OF BLANK CASING USED: 5 Wrought iron 8 Concrete tile CASING JOINTS: Glued Clamped
 1 Steel 3 RMP (SR) 6 Asbestos-Cement 9 Other (specify below) Welded
 2 PVC 4 ABS 7 Fiberglass Threaded **X**
 Blank casing diameter **4** in. to **115** ft., Dia in. to ft., Dia in. to ft.
 Casing height above land surface **0** in., weight **2.071** lbs./ft. Wall thickness or gauge No. **.237**

TYPE OF SCREEN OR PERFORATION MATERIAL: 7 PVC 10 Asbestos-cement
 1 Steel 3 Stainless steel 5 Fiberglass 8 RMP (SR) 11 Other (specify)
 2 Brass 4 Galvanized steel 6 Concrete tile 9 ABS 12 None used (open hole)

SCREEN OR PERFORATION OPENINGS ARE: 5 Gauzed wrapped 8 Saw cut 11 None (open hole)
 1 Continuous slot 3 Mill slot 6 Wire wrapped 9 Drilled holes
 2 Louvered shutter 4 Key punched 7 Torch cut 10 Other (specify)

SCREEN-PERFORATED INTERVALS: From **115** ft. to **145** ft., From ft. to ft.
 From ft. to ft., From ft. to ft.
 GRAVEL PACK INTERVALS: From **110** ft. to **145** ft., From ft. to ft.
 From ft. to ft., From ft. to ft.

6 GROUT MATERIAL: 1 Neat cement 2 Cement grout 3 Bentonite 4 Other
 Grout Intervals: From **0** ft. to **3** ft., From **3** ft. to **110** ft., From ft. to ft.

What is the nearest source of possible contamination:
 1 Septic tank 4 Lateral lines 7 Pit privy 10 Livestock pens 14 Abandoned water well
 2 Sewer lines 5 Cess pool 8 Sewage lagoon 11 Fuel storage 15 Oil well/Gas well
 3 Watertight sewer lines 6 Seepage pit 9 Feedyard 12 Fertilizer storage 16 Other (specify below)
 13 Insecticide storage **Removed Fuel Storage**

Direction from well? How many feet?

FROM	TO	LITHOLOGIC LOG	FROM	TO	PLUGGING INTERVALS
0	.8	Rock	99	102	Cemented Sand w/Clay & Some Sand Strks.
.8	2	Surface			
2	20	Loess	102	111	Clay & Caliche w/a few Sand Strks.
20	25	Sandy Clay & Caliche			
25	35	Sandy Clay, Caliche & S.Sand	111		
35	45	Fine Sand w/Clay Strks.			
45	58	Fine to Med. Sand w/Clay Strk			
58	62	Sandy Clay w/Caliche Strks.			
62	74	Tight Fine Sand w/Clay & Caliche Strks.			
74	84	Med. Sand & Gravel w/a few Clay Strks.			
84	90	Clay w/Caliche Strks.			
90	98	Fine to Med. Sand w/Clay Str.			
98	99	Clay			

7 CONTRACTOR'S OR LANDOWNER'S CERTIFICATION: This water well was (1) constructed, (2) reconstructed, or (3) plugged under my jurisdiction and was completed on (mo/day/year) **4-3-95** and this record is true to the best of my knowledge and belief. Kansas Water Well Contractor's License No. **554** This Water Well Record was completed on (mo/day/yr) **4-28-95** under the business name of **Woofter Pump & Well, Inc.** by (signature) *[Signature]*

INSTRUCTIONS: Use typewriter or ball point pen. PLEASE PRESS FIRMLY and PRINT clearly. Please fill in blanks, underline or circle the correct answers. Send top three copies to Kansas Department of Health and Environment, Bureau of Water, Topeka, Kansas 66620-0001. Telephone: 913-296-5545. Send one to WATER WELL OWNER and retain one for your records.

OFFICE USE ONLY
 T
 R
 EW
 SEC.
 1/4
 1/4
 1/4

C:\Projects\258-P1-25BP1001\New Quarterly Reports 1-19-2010\fig4-1.dwg
 SAVED: 5/8/2017 2:32 PM
 PLOTTED: 5/8/2017 2:33 PM

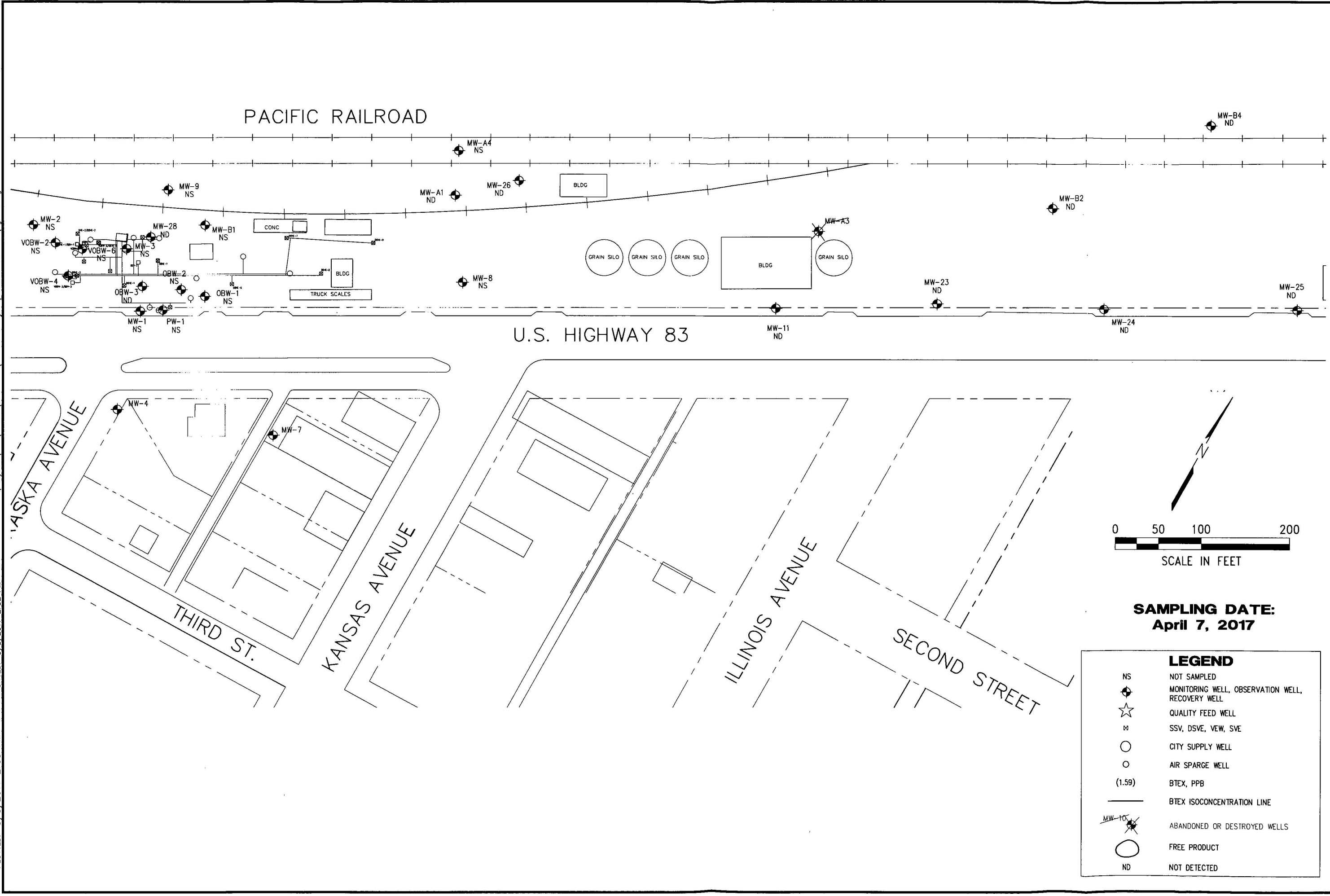

SAMPLING DATE:
April 7, 2017

LEGEND

- NS NOT SAMPLED
- ◆ MONITORING WELL, OBSERVATION WELL, RECOVERY WELL
- ☆ QUALITY FEED WELL
- M SSV, DSVE, VEW, SVE
- CITY SUPPLY WELL
- AIR SPARGE WELL
- (1.59) BTEX, PPB
- BTEX ISOCONCENTRATION LINE
- ◆ (with slash) ABANDONED OR DESTROYED WELLS
- FREE PRODUCT
- ND NOT DETECTED

REVISIONS

	BY

MILCO
Environmental Services, Inc.
Kearney, NE (308) 237-5923
McCook, NE (308) 345-4741

HOME OIL
BTEX ISOCONCENTRATION MAP
 SELDEN, KANSAS U6-090-221

This document, and the ideas and designs incorporated herein, as an instrument of professional service, is the property of Miller & Associates and is not to be used in whole or in part for any other project without the written authorization of Miller & Associates.

VERIFY SCALES
 BAR IS ONE INCH ON ORIGINAL DRAWING
 0 1"
 IF NOT ONE INCH ON THIS SHEET, ADJUST SCALES ACCORDINGLY.

SCALE: 1" = 100'
 PROJECT NO. M258-P1-001
 DATE: MAY, 2017
 FIELD BOOK M&A DWG NO.
 DRAWN BY: BSF APRVD BY:
 SHEET

FIGURE 4-1