

WATER WELL RECORD Form WWC-5

Original Record Correction Change in Well Use

Division of Water Resources App. No.

Well ID

1 LOCATION OF WATER WELL: County:	Fraction ¼ ¼ ¼ ¼	Section Number	Township Number T S	Range Number R <input type="checkbox"/> E <input type="checkbox"/> W
---	---------------------	----------------	------------------------	---

2 WELL OWNER: Last Name: _____ Business: _____ Address: _____ Address: _____ City: _____ State: _____ ZIP: _____	First: _____ Street or Rural Address where well is located (if unknown, distance and direction from nearest town or intersection): If at owner's address, check here: <input type="checkbox"/>
---	---

<p>3 LOCATE WELL WITH "X" IN SECTION BOX: N NW NE W SE E S -----1 mile-----</p>	<p>4 DEPTH OF COMPLETED WELL: ft. Depth(s) Groundwater Encountered: 1) ft. 2) ft. 3) ft., or 4) <input type="checkbox"/> Dry Well WELL'S STATIC WATER LEVEL: ft. <input type="checkbox"/> below land surface, measured on (mo-day-yr)..... <input type="checkbox"/> above land surface, measured on (mo-day-yr)..... Pump test data: Well water was ft. after hours pumping gpm Well water was ft. after hours pumping gpm Estimated Yield:gpm Bore Hole Diameter: in. to ft. and in. to ft.</p>	<p>5 Latitude:(decimal degrees) Longitude:(decimal degrees) Datum: <input type="checkbox"/> WGS 84 <input type="checkbox"/> NAD 83 <input type="checkbox"/> NAD 27 Source for Latitude/Longitude: <input type="checkbox"/> GPS (unit make/model:) (WAAS enabled? <input type="checkbox"/> Yes <input type="checkbox"/> No) <input type="checkbox"/> Land Survey <input type="checkbox"/> Topographic Map <input type="checkbox"/> Online Mapper:</p> <p>6 Elevation:ft. <input type="checkbox"/> Ground Level <input type="checkbox"/> TOC Source: <input type="checkbox"/> Land Survey <input type="checkbox"/> GPS <input type="checkbox"/> Topographic Map <input type="checkbox"/> Other</p>
--	---	---

7 WELL WATER TO BE USED AS:

1. Domestic: <input type="checkbox"/> Household <input type="checkbox"/> Lawn & Garden <input type="checkbox"/> Livestock	2. <input type="checkbox"/> Irrigation	3. <input type="checkbox"/> Feedlot	4. <input type="checkbox"/> Industrial	5. <input type="checkbox"/> Public Water Supply: well ID	6. <input type="checkbox"/> Dewatering: how many wells?	7. <input type="checkbox"/> Aquifer Recharge: well ID	8. <input type="checkbox"/> Monitoring: well ID	9. Environmental Remediation: well ID	<input type="checkbox"/> Air Sparge <input type="checkbox"/> Soil Vapor Extraction <input type="checkbox"/> Recovery <input type="checkbox"/> Injection	10. <input type="checkbox"/> Oil Field Water Supply: lease	11. Test Hole: well ID	12. Geothermal: how many bores?	13. <input type="checkbox"/> Other (specify):
--	--	-------------------------------------	--	--	---	---	---	---	--	--	------------------------------	---------------------------------------	---

Was a chemical/bacteriological sample submitted to KDHE? Yes No If yes, date sample was submitted:
Water well disinfected? Yes No

8 TYPE OF CASING USED: Steel PVC Other CASING JOINTS: Glued Clamped Welded Threaded
Casing diameter in. to ft., Diameter in. to ft., Diameter in. to ft.
Casing height above land surface in. Weight lbs./ft. Wall thickness or gauge No.
TYPE OF SCREEN OR PERFORATION MATERIAL:
 Steel Stainless Steel PVC Other (Specify)
 Brass Galvanized Steel None used (open hole)
SCREEN OR PERFORATION OPENINGS ARE:
 Continuous Slot Mill Slot Gauze Wrapped Torch Cut Drilled Holes Other (Specify)
 Louvered Shutter Key Punched Wire Wrapped Saw Cut None (Open Hole)
SCREEN-PERFORATED INTERVALS: From ft. to ft., From ft. to ft., From ft. to ft.
GRAVEL PACK INTERVALS: From ft. to ft., From ft. to ft., From ft. to ft.

9 GROUT MATERIAL: Neat cement Cement grout Bentonite Other
Grout Intervals: From ft. to ft., From ft. to ft., From ft. to ft.

Nearest source of possible contamination: No potential source of contamination within 200 ft.
 Septic Tank Lateral Lines Pit Privy Livestock Pens Insecticide Storage
 Sewer Lines Cess Pool Sewage Lagoon Fuel Storage Abandoned Water Well
 Watertight Sewer Lines Seepage Pit Feedyard Fertilizer Storage Oil Well/Gas Well
 Other (Specify)
Direction from well? Distance from well? ft.

10 FROM	TO	LITHOLOGIC LOG	FROM	TO	LITHO. LOG (cont.) or PLUGGING INTERVALS

Notes:

11 CONTRACTOR'S OR LANDOWNER'S CERTIFICATION: This water well was constructed, reconstructed, or plugged under my jurisdiction and was completed on (mo-day-year) and this record is true to the best of my knowledge and belief. Kansas Water Well Contractor's License No. This Water Well Record was completed on (mo-day-year) under the business name of

Send one copy to WATER WELL OWNER and retain one for your records. Fee of \$5.00 for each constructed well.

KS Department of Health and Environment, Bureau of Water, Geology Section, 1000 SW Jackson St., Suite 420, Topeka, Kansas 66612-1367. Telephone 785-296-3565.

Visit us at <http://www.kdheks.gov/waterwell/index.html>

KSA 82a-1212

FULL SITE SURVEY

City of Aurora
City of Aurora, Cloud County, Kansas

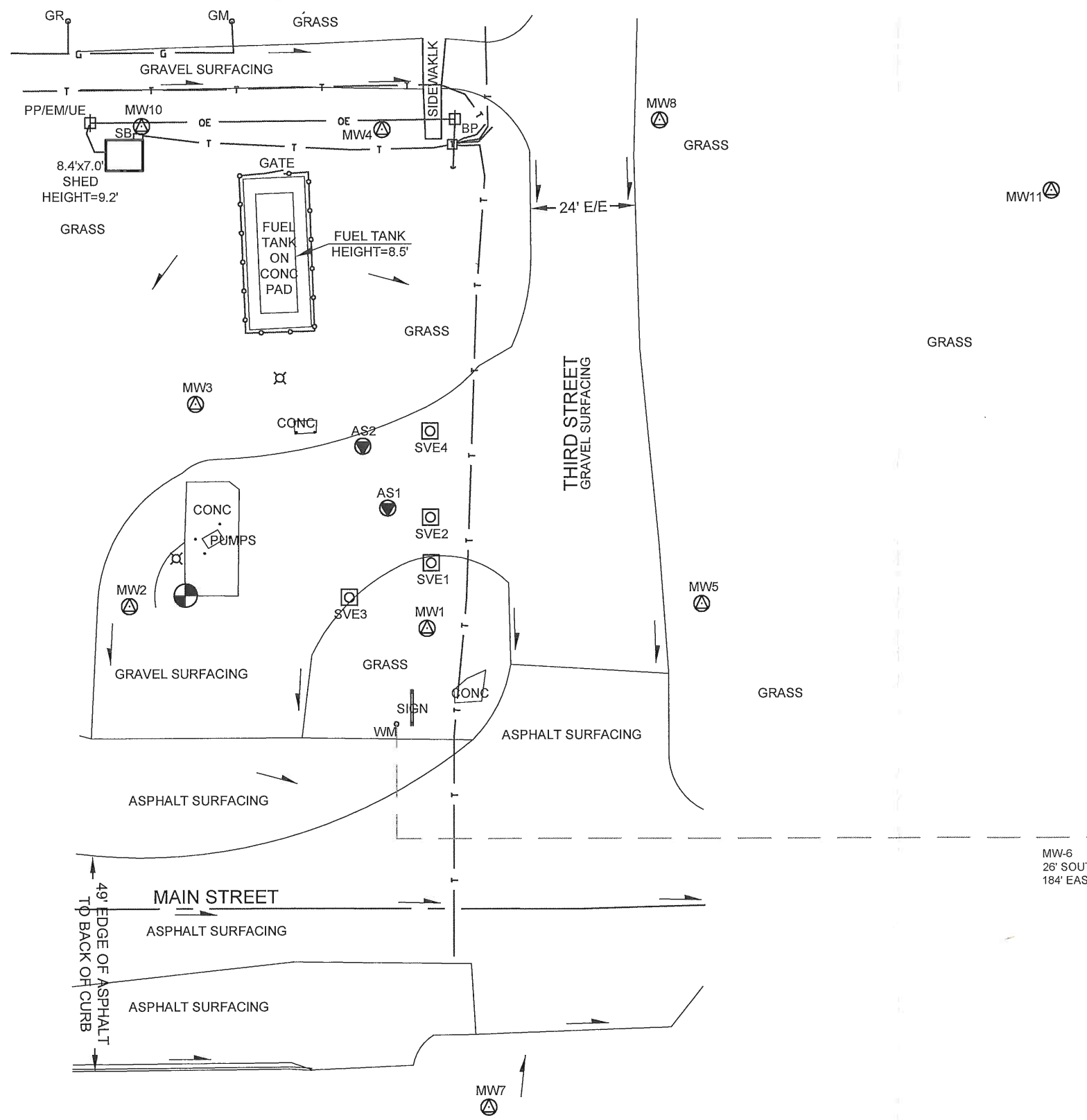

Point	North Coordinate	East Coordinate	Distance From SE Cor. Sec. 10		* Elev. Top of Rim or PK Nail	Elev. Top of PVC Pipe	Latitude North	Longitude West
			North	West				
SE Cor. Sec. 10-T7S-R2w	20000	20000						
Well - M.W. - 1	20072.27	16597.68	72.27	3402.32	1499.53	1499.28	39.45221	97.52975
Well - M.W. - 2	20077.31	16530.58	77.31	3469.42	1502.74	1502.54	39.45222	97.52998
Well - M.W. - 3	20122.89	16545.12	122.89	3454.88	1502.26	1501.94	39.45235	97.52993
Well - M.W. - 4	20184.76	16586.49	184.76	3413.51	1502.50	1502.09	39.45252	97.52978
Well - M.W. - 5	20077.77	16659.60	77.77	3340.40	1497.27	1496.85	39.45222	97.52953
Well - M.W. - 6	20024.81	16775.01	24.81	3224.99	1493.97	1493.79	39.45208	97.52912
Well - M.W. - 7	19964.14	16612.19	35.86 S	3387.81	1499.27	1498.87	39.45191	97.52970
Well - M.W. - 8	20186.79	16649.02	186.79	3350.98	1500.06	1499.26	39.45252	97.52956
Well - M.W. - 9	19976.14	16466.57	23.86 S	3533.43	1502.01	1501.79	39.45195	97.53021
Well - M.W. - 10	20185.48	16532.34	185.48	3467.66	1503.24	1502.85	39.45252	97.52997
Well - M.W. - 11	20170.87	16737.68	170.87	3262.32	1595.89	1595.64	39.45248	97.52925
Well - A.S. - 1	20099.43	16588.56	99.43	3411.44	1500.85	1500.58	39.45228	97.52978
Well - A.S. - 2	20113.42	16582.83	113.42	3417.17	1501.20	1500.76	39.45232	97.52980
Well - S.V.E. - 1	20087.05	16598.49	87.05	3401.51	1499.91	1499.64	39.45225	97.52974
Well - S.V.E. - 2	20097.35	16598.23	97.35	3401.77	1500.28	1499.98	39.45223	97.52981
Well - S.V.E. - 3	20079.27	16580.10	79.27	3419.90	1500.76	1500.49	39.45223	97.52981
Well - S.V.E. - 4	20116.81	16597.96	116.81	3402.04	1500.62	1500.35	39.45233	97.52974
Site B.M.	20079.77	16543.29	79.77	3456.71		B.M. Elev. = 1502.07		

Description: "□" cut on southwest corner of pump pad.

LEGEND

- SITE BENCHMARK
- POWER POLE
- POWER POLE W/ ELECTRIC METER & UNDERGROUND ELECTRIC
- BRACE POLE
- DEADMAN ANCHOR
- LIGHT POLE
- TELEPHONE PEDESTAL
- TELEPHONE SPLICE BOX
- GAS METER
- GASLINE RISER
- WATER METER
- BOLLARD
- DRAINAGE DIRECTION
- MONITOR WELL
- AIR SPARGE WELL
- SOIL VAPOR EXTRACTION WELL
- E/E EDGE TO EDGE OF GRAVEL ROAD
- OVERHEAD ELECTRIC LINE
- UNDERGROUND ELECTRIC LINE
- GAS LINE
- UNDERGROUND TELEPHONE LINE
- CENTERLINE TRAVELWAY
- 6' CHAIN LINK FENCE

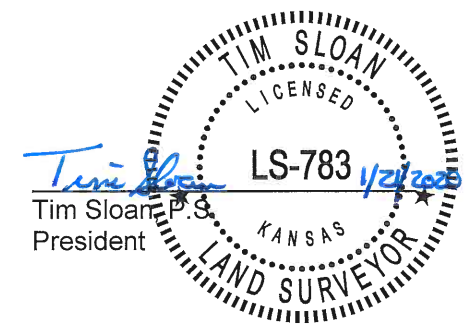

SMH CONSULTANTS

SCALE: 1"=50'

0 25' 50'

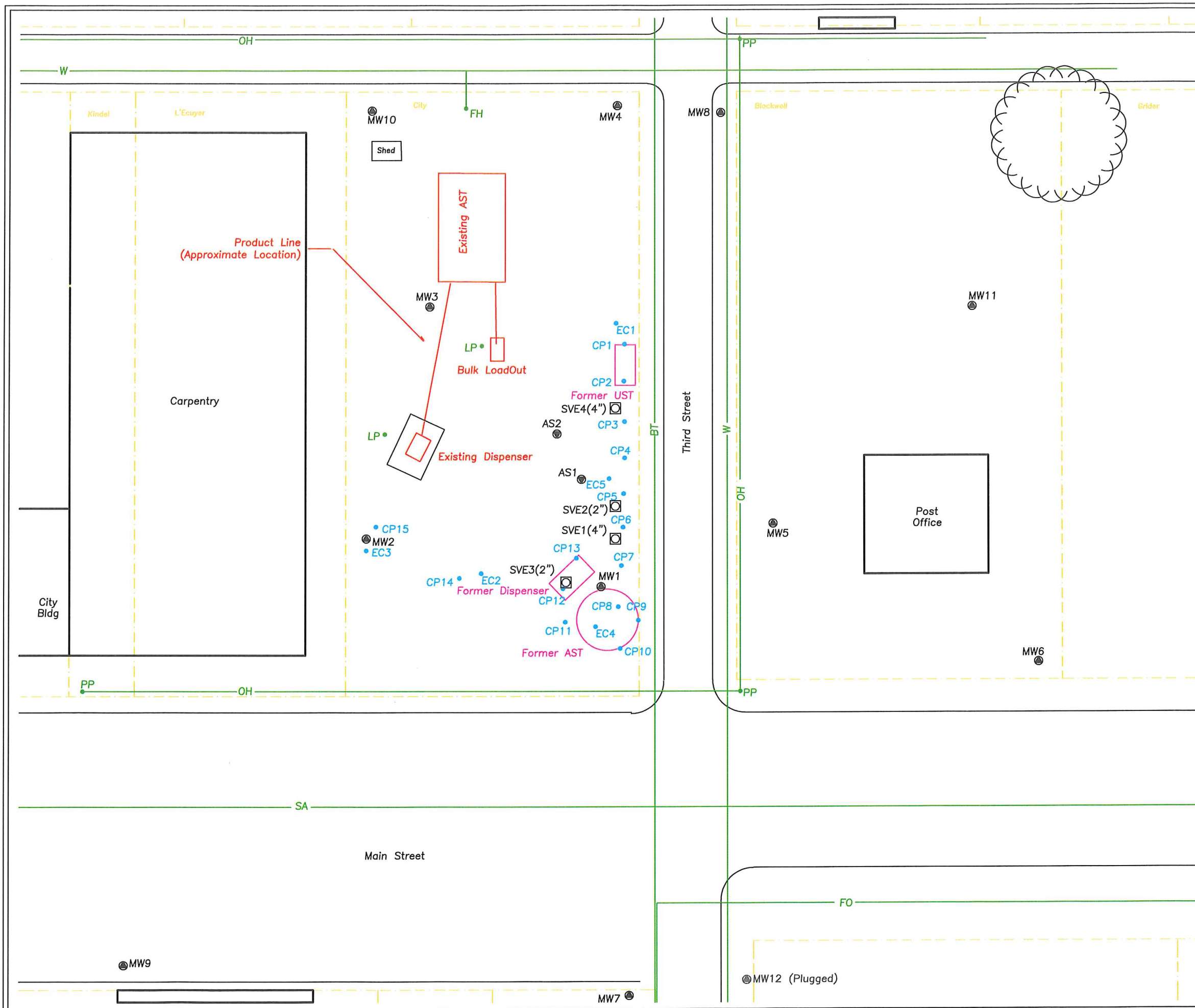

Legend

- - Existing Monitoring Well Location
MW1
- CP1 - Continuous Probe Locations
- EC1 - Electric Conductivity Probe Locations
- - Soil Vapor Extraction Wells
SVE1
- - Air Sparge Wells
AS1
- - Active AST or Dispenser Location
- - Historical AST/UST or Dispenser Location
- Property Line
- Blackwell - Property Owner Name
- OH — Overhead Power Line
- SA — Sanitary Sewer Line (~4' deep)
- BT — Buried Cable/Telephone Line (~3' deep)
- W — Water Line (~4' deep)
- G — Gas Line (~3' deep)
- BE — Buried Electric Line (~2' deep)
- FO — Fiber Optic Line (~3' deep)
- PP - Power Pole
- LP - Light Pole
- BP - Brace Pole
- EO - Electrical Outlet
- WM - Water Meter
- EM - Electrical Meter
- GV - Gate Valve
- SB - Steel Bollard
- TS - Traffic Signal Manhole
- SS - Sanitary Sewer
- FH - Fire Hydrant
- - Tree

Scale In Feet
0 30 60

Site Detail Map
 City of Aurora
 Aurora, Kansas
 KDHE Project: U5-015-13668
 Remedial Design Report
 CGP Project #19876K
 Prepared By: MK Date: 12-24-2019
 Reviewed By: MK Date: 12-24-2019
 Figure 1.4
 CGP, Inc. PO Box 23, Wahoo, NE 68066