

Bureau of Water  
Geology Section  
1000 SW Jackson St, Ste 420  
Topeka, KS 66612-1367



COPY

Phone: 785-296-3565  
Fax: 785-296-5509  
rharper@kdheks.gov  
www.kdheks.gov/geo

15-7-23W  
SE NE NW

Robert Moser, MD, Secretary

Department of Health & Environment

Sam Brownback, Governor

October 7, 2011

H & C OIL OPERATING INC  
PO BOX 86  
PLAINVILLE, KS 67663

Re: Appropriation of Water, Application Number 20110100 00

Dear Sir/Madam:

The Division of Water Resources, Kansas Department of Agriculture (DWR) has notified the Kansas Department of Health and Environment (KDHE) the above described Temporary Permit has been issued. The Temporary Permit originally authorized the use of groundwater to be withdrawn by means of the water supply well located as described below:

1 well located in the SE NE NW of SECT 15, T7S, R23W, Graham County, Kansas.

Temporary Permits are issued for a duration of 6 months by the DWR. After the Temporary Permit expires KDHE considers the water well abandoned and Kansas Administrative Regulation (K.A.R.) 28-30-7(a) requires abandoned water wells to be plugged or caused to be plugged by the landowner. Once a water well has been plugged, K.A.R. 28-30-4 requires a plugging report (Form WWC-5 or WWC-5 "P") to be completed and returned to KDHE.

Please answer the following question concerning the water well. Sign on the signature line and return this letter to: KDHE, Attn: Geology Section, Bureau of Water, 1000 SW Jackson St., Suite 420, Topeka, Kansas 66612-1367 within two weeks from the date of this letter. If this form is not returned within two weeks, this may result in a follow-up by KDHE to determine the status of the well. If you have questions or need assistance with the form please contact Richard Harper at (785) 296-3565 or by e-mail at [rharper@kdheks.gov](mailto:rharper@kdheks.gov).

Sincerely,

Richard Harper, LG  
Water Well Unit Chief  
Geology Section/Bureau of Water

cc: KDHE  
NWDO  
Graham 01

RECEIVED

OCT 18 2011

BUREAU OF WATER

**WATER WELL RECORD**

**Form WWC-5**

Division of Water Resources App. No. 20110100

<b>1 LOCATION OF WATER WELL:</b> <b>Graham</b>	Fraction NW ¼ SE ¼ NE ¼ NW ¼	Section Number <b>15</b>	Township Number T <b>7</b> S	Range Number R <b>23</b> <input type="checkbox"/> E <input checked="" type="checkbox"/> W
---	---------------------------------	-----------------------------	---------------------------------	--

Street/Rural Address of Well Location; if unknown, distance & direction from nearest town or intersection: If at owner's address, check here   
**6 miles north of Hill city—2 ½ west**

**Global Positioning System (GPS) information:**  
 Latitude: \_\_\_\_\_ (in decimal degrees)  
 Longitude: \_\_\_\_\_ (in decimal degrees)  
 Elevation: \_\_\_\_\_  
 Datum:  WGS 84,  NAD 83,  NAD 27  
 Collection Method:  
 GPS unit (Make/Model: \_\_\_\_\_)  
 Digital Map/Photo,  Topographic Map,  Land Survey  
 Est. Accuracy:  <3 m,  3-5 m,  5-15 m,  >15 m

**2 WATER WELL OWNER** **Allen Trexler**  
 RR#, St. Address, Box # **2753 Q Terrace**  
 City, State, ZIP Code **Hill city, KS 67642**

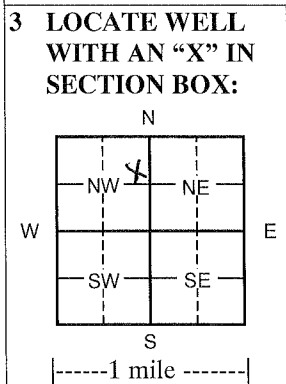

**4 DEPTH OF COMPLETED WELL** **160** ft.  
 Depth(s) Groundwater Encountered (1) \_\_\_\_\_ ft. (2) \_\_\_\_\_ ft. (3) \_\_\_\_\_ ft.  
 WELL'S STATIC WATER LEVEL \_\_\_\_\_ ft. below land surface measured on mo/day/yr  
 Pump test data: Well water was \_\_\_\_\_ ft. after \_\_\_\_\_ hours pumping \_\_\_\_\_ gpm  
 EST. YIELD \_\_\_\_\_ gpm: Well water was \_\_\_\_\_ ft. after \_\_\_\_\_ hours pumping \_\_\_\_\_ gpm  
 WELL WATER TO BE USED AS:  Public water supply  Geothermal  Injection well  
 Domestic  Feedlot  Oil field water supply  Dewatering  Other (Specify below)  
 Irrigation  Industrial  Domestic-lawn & garden  Monitoring well  
 Was a chemical/bacteriological sample submitted to Department?  Yes  No  
 If yes, mo/day/yr sample was submitted \_\_\_\_\_  
 Water Well Disinfected?  Yes  No

**5 TYPE OF CASING USED:**  Steel  PVC  Other  
 CASING JOINTS:  Glued  Clamped  Welded  Threaded  
 Casing diameter **4.5** in. to **120** ft., Diameter \_\_\_\_\_ in. to \_\_\_\_\_ ft., Diameter \_\_\_\_\_ in. to \_\_\_\_\_ ft.  
 Casing height above land surface **18** in., Weight **2.38** lbs./ft. Wall thickness or gauge No. **.248**  
 TYPE OF SCREEN OR PERFORATION MATERIAL:  
 Steel  Stainless Steel  PVC  Other (Specify) \_\_\_\_\_  
 Brass  Galvanized Steel  None used (open hole)  
 SCREEN OR PERFORATION OPENINGS ARE:  
 Continuous Slot  Mill slot  Gauze wrapped  Torch cut  Drilled holes  None (open hole)  
 Louvered shutter  Key punched  Wire wrapped  Saw cut  Other (specify) \_\_\_\_\_  
 SCREEN-PERFORATED INTERVALS:  
 From **120** ft. to **160** ft., From \_\_\_\_\_ ft. to \_\_\_\_\_ ft.  
 From \_\_\_\_\_ ft. to \_\_\_\_\_ ft., From \_\_\_\_\_ ft. to \_\_\_\_\_ ft.  
 GRAVEL PACK INTERVALS:  
 From **20** ft. to **160** ft., From \_\_\_\_\_ ft. to \_\_\_\_\_ ft.  
 From \_\_\_\_\_ ft. to \_\_\_\_\_ ft., From \_\_\_\_\_ ft. to \_\_\_\_\_ ft.

**6 GROUT MATERIAL:**  Neat cement  Cement grout  Bentonite  Other \_\_\_\_\_  
 Grout Intervals From **0** ft. to **20** ft. From \_\_\_\_\_ ft. to \_\_\_\_\_ ft. From \_\_\_\_\_ ft. to \_\_\_\_\_ ft.  
 What is the nearest source of possible contamination:  
 Septic tank  Lateral lines  Pit privy  Livestock pens  Insecticide storage  Other (specify below)  
 Sewer lines  Cesspool  Sewage lagoon  Fuel storage  Abandoned water well  
 Watertight sewer lines  Seepage pit  Feedyard  Fertilizer storage  Oil well/gas well **None**  
 Direction from well \_\_\_\_\_ Distance from well \_\_\_\_\_

FROM	TO	LITHOLOGIC LOG	FROM	TO	LITHO. LOG (cont.) or PLUGGING INTERVALS
<b>0</b>	<b>2</b>	<b>Surface</b>			
<b>2</b>	<b>15</b>	<b>Loess</b>			
<b>15</b>	<b>37</b>	<b>Caliche w/sandstone strks</b>			
<b>37</b>	<b>66</b>	<b>Clay &amp; caliche w/sand lenses</b>			
<b>60</b>	<b>160</b>	<b>Fine sand w/clay &amp; caliche strks</b>			

**7 CONTRACTOR'S OR LANDOWNER'S CERTIFICATION:** This water well was constructed, reconstructed, or  plugged under my jurisdiction and was completed on (mo/day/year) **3/4/11** and this record is true to the best of my knowledge and belief.  
 Kansas Water Well Contractor's License No. **(554 or 783)**. This Water Well Record was completed on (mo/day/year) **3-15-2011**  
 under the business name of **Woofter Pump & Well Inc.** by (signature) *Gary C. Woofter*

**INSTRUCTIONS:** Please fill in blanks and check the correct answers. Send three copies (white, blue, pink) to Kansas Department of Health and Environment, Bureau of Water, Geology Section, 1000 SW Jackson St., Suite 420, Topeka, Kansas 66612-1367. Telephone 785-296-5522. Send one to WATER WELL OWNER and retain one for your records. Include fee of \$5.00 for each constructed well. Visit us at <http://www.kdheks.gov/waterwell/index.html>.

**Water Well Question**

Will the water well mentioned above be plugged by you after the Permit expires?  
(please circle) Yes or **No**

If you circled No, please explain.

WATER WELL OWNERSHIP TRANSFERED TO LANDOWNER

---

---

---

Please sign this form and return to:     KDHE - Bureau of Water  
  Geology Section  
  1000 SW Jackson St, Ste 420  
  Topeka, KS 66612-1367

Your telephone number would be appreciated in case we need to contact you.

Signature: Charles R Ramsay

Name Printed: CHARLES R RAMSAY

Telephone No. 785-434-7434

RH:db

Temp

c/DWR letters/Merge Letter - Exp Temp - DB 2011

**H & C OIL OPERATING, INC.**  
**P.O. Box 86**  
**Plainville, KS 67663**  
**785-434-7434 Phone/785-688-4200 Fax**

**Water Well**

I, Allen Trexler, hereby after this date, September 1, 2010 or  
after H & C Oil Operating, Inc. moves off (well name) Trexler 15-1  
Sec. 15 T. 7S R. 23W. County Graham State Kansas takes all and  
full responsibilities of water well drilled on lease.

Drilled for the purpose of supplying H & C Oil Operating, Inc. with water to drill  
above said lease.

Signed: Allen Trexler  
Allen Trexler, LAND OWNER

Signed: Charles R Ramsey Pres.  
H & C Oil Operating Representative