

WATER WELL RECORD Form WWC-5 KSA 82a-1212

1 LOCATION OF WATER WELL: Fraction SE 1/4 NE 1/4 SE 1/4 Section Number 33 Township Number T 7 S Range Number R 26 **W**
 County: Sheridan

Distance and direction from nearest town or city street address of well if located within city?

2 WATER WELL OWNER: Bill Nondorf
 RR#, St. Address, Box #: Rt. 1 Box 65 Board of Agriculture, Division of Water Resources
 City, State, ZIP Code: Hoxie, KS 67740 Application Number: 42,623

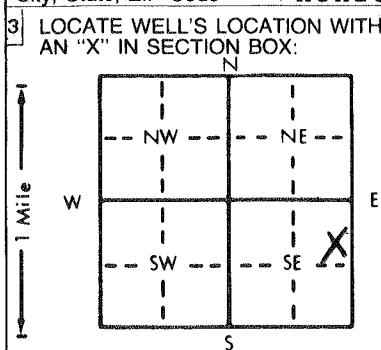

4 DEPTH OF COMPLETED WELL: 216 ft. ELEVATION:
 Depth(s) Groundwater Encountered 1. ft. 2. ft. 3. ft.
 WELL'S STATIC WATER LEVEL: 134 ft. below land surface measured on mo/day/yr
 Pump test data: Well water was ft. after hours pumping gpm
 Est. Yield gpm: Well water was ft. after hours pumping gpm
 Bore Hole Diameter: 24 in. to 216 ft., and in. to ft.
 WELL WATER TO BE USED AS:
 5 Public water supply 8 Air conditioning 11 Injection well
 1 Domestic 3 Feedlot 6 Oil field water supply 9 Dewatering 12 Other (Specify below)
 2 Irrigation 4 Industrial 7 Lawn and garden only 10 Monitoring well
 Was a chemical/bacteriological sample submitted to Department? Yes. No. **X**; If yes, mo/day/yr sample was sub-
 mitted Water Well Disinfected? Yes No **X**

5 TYPE OF BLANK CASING USED:
 1 Steel 3 RMP (SR) 5 Wrought iron 8 Concrete tile CASING JOINTS: Glued **X** Clamped
 2 PVC 4 ABS 6 Asbestos-Cement 9 Other (specify below) Welded
 7 Fiberglass Threaded
 Blank casing diameter: 16 in. to 156 ft., Dia. in. to ft., Dia. in. to ft.
 Casing height above land surface: 24 in., weight: 16.15 lbs./ft. Wall thickness or gauge No. 500
 TYPE OF SCREEN OR PERFORATION MATERIAL:
 1 Steel 3 Stainless steel 5 Fiberglass 7 PVC 10 Asbestos-cement
 2 Brass 4 Galvanized steel 6 Concrete tile 8 RMP (SR) 11 Other (specify)
 9 ABS 12 None used (open hole)
 SCREEN OR PERFORATION OPENINGS ARE:
 1 Continuous slot 3 Mill slot 5 Gauzed wrapped 8 Saw cut 11 None (open hole)
 2 Louvered shutter 4 Key punched 6 Wire wrapped 9 Drilled holes
 7 Torch cut 10 Other (specify)
 SCREEN-PERFORATED INTERVALS: From 156 ft. to 216 ft., From ft. to ft.
 GRAVEL PACK INTERVALS: From 20 ft. to 216 ft., From ft. to ft.

6 GROUT MATERIAL: 1 Neat cement 2 Cement grout 3 Bentonite 4 Other
 Grout Intervals: From 0 ft. to 20 ft., From ft. to ft., From ft. to ft.
 What is the nearest source of possible contamination: NONE
 1 Septic tank 4 Lateral lines 7 Pit privy 10 Livestock pens 14 Abandoned water well
 2 Sewer lines 5 Cess pool 8 Sewage lagoon 11 Fuel storage 15 Oil well/Gas well
 3 Watertight sewer lines 6 Seepage pit 9 Feedyard 12 Fertilizer storage 16 Other (specify below)
 13 Insecticide storage
 Direction from well? How many feet?

| FROM | TO | LITHOLOGIC LOG | FROM | TO | PLUGGING INTERVALS |
|------|------|--|-------|-------|---|
| 0 | 2 | Surface | 110 | 111 | Cemented Sand |
| 2 | 11 | Loess | 111 | 120 | Sandy Clay, Caliche, Cemented Sand & Clay Mix |
| 11 | 15 | Caliche | | | |
| 15 | 20 | Hard Caliche & Cemented Sand | 120 | 157 | Sandy Clay w/a Few Caliche ST |
| 20 | 34 | Sandy Clay, Caliche & Cem. Sand | 157 | 165 | Sandy Clay w/Fine Sand Strks. |
| 34 | 43 | Med. Sand | 165 | 183 | Med. Sand & Gravel w/a Few Fine Clay Layers |
| 43 | 52 | Sandy Clay w/Sand Strks. | | | |
| 52 | 57 | Med. Sand | 183 | 184.5 | Sandy Clay |
| 57 | 64 | Sandy Clay w/Caliche | 184.5 | 196 | Med. Sand & Gravel |
| 64 | 67 | Cemented Sand | 196 | 200 | Med. Sand & Gravel w/a Few Clay Lenses |
| 67 | 69.5 | Sandy Clay w/Sand Strks. | | | |
| 69.5 | 99 | Sandy Clay w/Caliche w/a Few Sand Strks. | 200 | 208 | Med. Sand & Gravel |
| | | | 208 | 209 | Flint |
| 99 | 107 | Cemented Sand w/Clay & Caliche | 209 | | Ochre |
| 107 | 110 | Sandy Clay w/Some Sand | | | |

7 CONTRACTOR'S OR LANDOWNER'S CERTIFICATION: This water well was (1) constructed, (2) reconstructed, or (3) plugged under my jurisdiction and was completed on (mo/day/year) 4-11-97 and this record is true to the best of my knowledge and belief. Kansas Water Well Contractor's License No. 554 This Water Well Record was completed on (mo/day/yr) 4-21-97 under the business name of Woofter Pump & Well, Inc. by (signature) Gayle Woofter

INSTRUCTIONS: Use typewriter or ball point pen. PLEASE PRESS FIRMLY and PRINT clearly. Please fill in blanks, underline or circle the correct answers. Send top three copies to Kansas Department of Health and Environment, Bureau of Water, Topeka, Kansas 66620-0001. Telephone: 913-296-5545. Send one to WATER WELL OWNER and retain one for your records.