

WATER WELL RECORD

Form WWC-5

Division of Water Resources App. No. [ ]

1 LOCATION OF WATER WELL: Fraction 1/4 SW 1/4 NE 1/4 SW 1/4 Section Number 32 Township Number T 7 S Range Number R 26

Street/Rural Address of Well Location; if unknown, distance & direction from nearest town or intersection: East of Hoxie rd 110E—north to Rd 30—west 1/2 mile Global Positioning System (GPS) information: Latitude: Longitude: Elevation: Datum: Collection Method: Est. Accuracy:

2 WATER WELL OWNER: Ray Schamberger RR#, St. Address, Box #: 5185Rd 70E City, State, ZIP Code: Hoxie, KS 67740

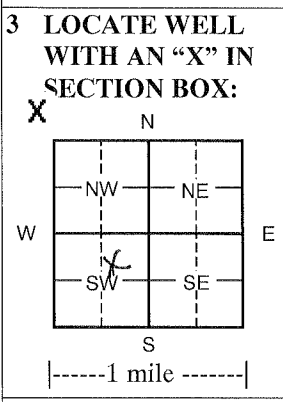

3 LOCATE WELL WITH AN "X" IN SECTION BOX: 4 DEPTH OF COMPLETED WELL 180 ft. Depth(s) Groundwater Encountered (1) ft. (2) ft. (3) ft. WELL'S STATIC WATER LEVEL ft. below land surface measured on mo/day/yr Pump test data: Well water was ft. after hours pumping gpm EST. YIELD gpm: Well water was ft. after hours pumping gpm WELL WATER TO BE USED AS: Public water supply Geothermal Injection well Domestic Feedlot Oil field water supply Dewatering Other (Specify below) Irrigation Industrial Domestic-lawn & garden Monitoring well Was a chemical/bacteriological sample submitted to Department? Yes No If yes, mo/day/yr sample was submitted Water Well Disinfected? Yes No

5 TYPE OF CASING USED: Steel PVC Other CASING JOINTS: Glued Clamped Welded Threaded Casing diameter 4.5 in. to 140 ft., Diameter in. to ft., Diameter in. to ft. Casing height above land surface 18 in., Weight 2.38 lbs./ft. Wall thickness or gauge No. .248

TYPE OF SCREEN OR PERFORATION MATERIAL: Steel Stainless Steel PVC Other (Specify) Brass Galvanized Steel None used (open hole) SCREEN OR PERFORATION OPENINGS ARE: Continuous Slot Mill slot Gauze wrapped Torch cut Drilled holes None (open hole) Louvered shutter Key punched Wire wrapped Saw cut Other (specify) SCREEN-PERFORATED INTERVALS: From 140 ft. to 180 ft., From ft. to ft. GRAVEL PACK INTERVALS: From 20 ft. to 180 ft., From ft. to ft.

6 GROUT MATERIAL: Neat cement Cement grout Bentonite Other Grout Intervals From 0 ft. to 20 ft. From ft. to ft. From ft. to ft. What is the nearest source of possible contamination: Septic tank Lateral lines Pit privy Livestock pens Insecticide storage Other (specify below) Sewer lines Cesspool Sewage lagoon Fuel storage Abandoned water well Watertight sewer lines Seepage pit Feedyard Fertilizer storage Oil well/gas well None Direction from well Distance from well

Table with columns: FROM, TO, LITHOLOGIC LOG, FROM, TO, LITHO. LOG (cont.) or PLUGGING INTERVALS. Rows include Surface, Loess, Sandy clay w/clay & caliche strks, Caliche w/clay strks, Fine to some med sand w/caliche lenses, Caliche w/sand lenses, Sandy clay w/caliche & clay strks, Caliche & clay w/sand lenses, Sandy clay w/clay & caliche strks, Clay & caliche w/sand strks.

7 CONTRACTOR'S OR LANDOWNER'S CERTIFICATION: This water well was constructed, reconstructed, or plugged under my jurisdiction and was completed on (mo/day/year) 3/12/12 and this record is true to the best of my knowledge and belief. Kansas Water Well Contractor's License No. 554 This Water Well Record was completed on (mo/day/year) 4/3/12 under the business name of Woofter Pump & Well Inc. by (signature)

INSTRUCTIONS: Please fill in blanks and check the correct answers. Send three copies (white, blue, pink) to Kansas Department of Health and Environment, Bureau of Water, Geology Section, 1000 SW Jackson St., Suite 420, Topeka, Kansas 66612-1367. Telephone 785-296-5522. Send one to WATER WELL OWNER and retain one for your records. Include fee of \$5.00 for each constructed well. Visit us at http://www.kdheks.gov/waterwell/index.html.