

WATER WELL RECORD Form WWC-5

Division of Water Resources App. No.

Well ID MW 2013

Original Record Correction Change in Well Use

1 LOCATION OF WATER WELL: County: Thomas	Fraction SW ¼ SW ¼ SE ¼ SE ¼	Section Number 36	Township Number T 7 S	Range Number R 34 <input type="checkbox"/> E <input checked="" type="checkbox"/> W
---	---------------------------------	-----------------------------	---------------------------------	--

2 WELL OWNER: Last Name: City of Colby Business: City of Colby Address: 585 N. Franklin Address: City: Colby State: KS ZIP: 67701	Street or Rural Address where well is located (if unknown, distance and direction from nearest town or intersection): If at owner's address, check here: <input type="checkbox"/> Colby Public Power - 120 N. Sterling, Colby, KS 67701
--	--

3 LOCATE WELL WITH "X" IN SECTION BOX:
N

NW	NE
SW	SE

S

----- 1 mile -----

4 DEPTH OF COMPLETED WELL:160..... ft.
 Depth(s) Groundwater Encountered: 1) ft.
 2) ft. 3) ft., or 4) Dry Well
WELL'S STATIC WATER LEVEL:142.13..... ft.
 below land surface, measured on (mo-day-yr).....9-6-16.....
 above land surface, measured on (mo-day-yr).....
 Pump test data: Well water was ft.
 after..... hours pumping gpm
 Well water was ft.
 after..... hours pumping gpm
 Estimated Yield: gpm
 Bore Hole Diameter:8.6..... in. to ft. and
 in. to ft.

5 Latitude:39.3943947.....(decimal degrees)
Longitude:101.0588298.....(decimal degrees)
 Horizontal Datum: WGS 84 NAD 83 NAD 27
Source for Latitude/Longitude:
 GPS (unit make/model: **EPOCH**)
 (WAAS enabled? Yes No)
 Land Survey Topographic Map
 Online Mapper:

6 Elevation: **3164.16**.....ft. Ground Level TOC
 Source: Land Survey GPS Topographic Map
 Other

7 WELL WATER TO BE USED AS:

1. Domestic: <input type="checkbox"/> Household <input type="checkbox"/> Lawn & Garden <input type="checkbox"/> Livestock 2. <input type="checkbox"/> Irrigation 3. <input type="checkbox"/> Feedlot 4. <input type="checkbox"/> Industrial	5. <input type="checkbox"/> Public Water Supply: well ID	6. <input type="checkbox"/> Dewatering: how many wells?	10. <input type="checkbox"/> Oil Field Water Supply: lease
7. <input type="checkbox"/> Aquifer Recharge: well ID	8. <input checked="" type="checkbox"/> Monitoring: well ID MW-20R	9. Environmental Remediation: well ID	11. Test Hole: well ID
<input type="checkbox"/> Air Sparge <input type="checkbox"/> Soil Vapor Extraction <input type="checkbox"/> Recovery <input type="checkbox"/> Injection	12. Geothermal: how many bores?	13. <input type="checkbox"/> Other (specify):	a) Closed Loop <input type="checkbox"/> Horizontal <input type="checkbox"/> Vertical b) Open Loop <input type="checkbox"/> Surface Discharge <input type="checkbox"/> Inj. of Water

Was a chemical/bacteriological sample submitted to KDHE? Yes No If yes, date sample was submitted:

Water well disinfected? Yes No

8 TYPE OF CASING USED: Steel PVC Other **CASING JOINTS:** Glued Clamped Welded Threaded
 Casing diameter4..... in. to130..... ft., Diameter in. to ft., Diameter in. to ft.
 Casing height above land surface5.4..... in. Weight lbs./ft. Wall thickness or gauge No. **Sch. 80**.....
TYPE OF SCREEN OR PERFORATION MATERIAL:
 Steel Stainless Steel Fiberglass PVC Other (Specify)

SCREEN OR PERFORATION OPENINGS ARE:
 Continuous Slot Mill Slot Gauze Wrapped Torch Cut Drilled Holes Other (Specify)

SCREEN-PERFORATED INTERVALS: From130..... ft. to160..... ft., From ft. to ft., From ft. to ft.
GRAVEL PACK INTERVALS: From126.5..... ft. to160..... ft., From ft. to ft., From ft. to ft.

9 GROUT MATERIAL: Neat cement Cement grout Bentonite Other **concrete 0-1ft**.....
 Grout Intervals: From1..... ft. to126.5..... ft., From ft. to ft., From ft. to ft.
Nearest source of possible contamination:
 Septic Tank Lateral Lines Pit Privy Livestock Pens Insecticide Storage
 Sewer Lines Cess Pool Sewage Lagoon Fuel Storage Abandoned Water Well
 Watertight Sewer Lines Seepage Pit Feedyard Fertilizer Storage Oil Well/Gas Well
 Other (Specify)

Direction from well? Distance from well? ft.

10 FROM	TO	LITHOLOGIC LOG	FROM	TO	LITHO. LOG (cont.) or PLUGGING INTERVALS
0	0.5	Concrete			
0.5	25	Silt			
25	42	Silty Clay with caliche and sand			
42	68	Sand with caliche, gravel, and clay			
68	81	Clay with sand			
81	89	Gravelly Sand, caliche, and clay			
89	122	Sand with gravel, caliche, and clay			Notes:
122	145	Sand with gravel and clay			
145	162	Sand with trace clay			

11 CONTRACTOR'S OR LANDOWNER'S CERTIFICATION: This water well was constructed, reconstructed, or plugged under my jurisdiction and was completed on (mo-day-year) **8-31-16**..... and this record is true to the best of my knowledge and belief.
 Kansas Water Well Contractor's License No. **881**..... This Water Well Record was completed on (mo-day-year) **9-28-16**.....
 under the business name of **Wootter Pump & Well**..... Signature *[Signature]*.....

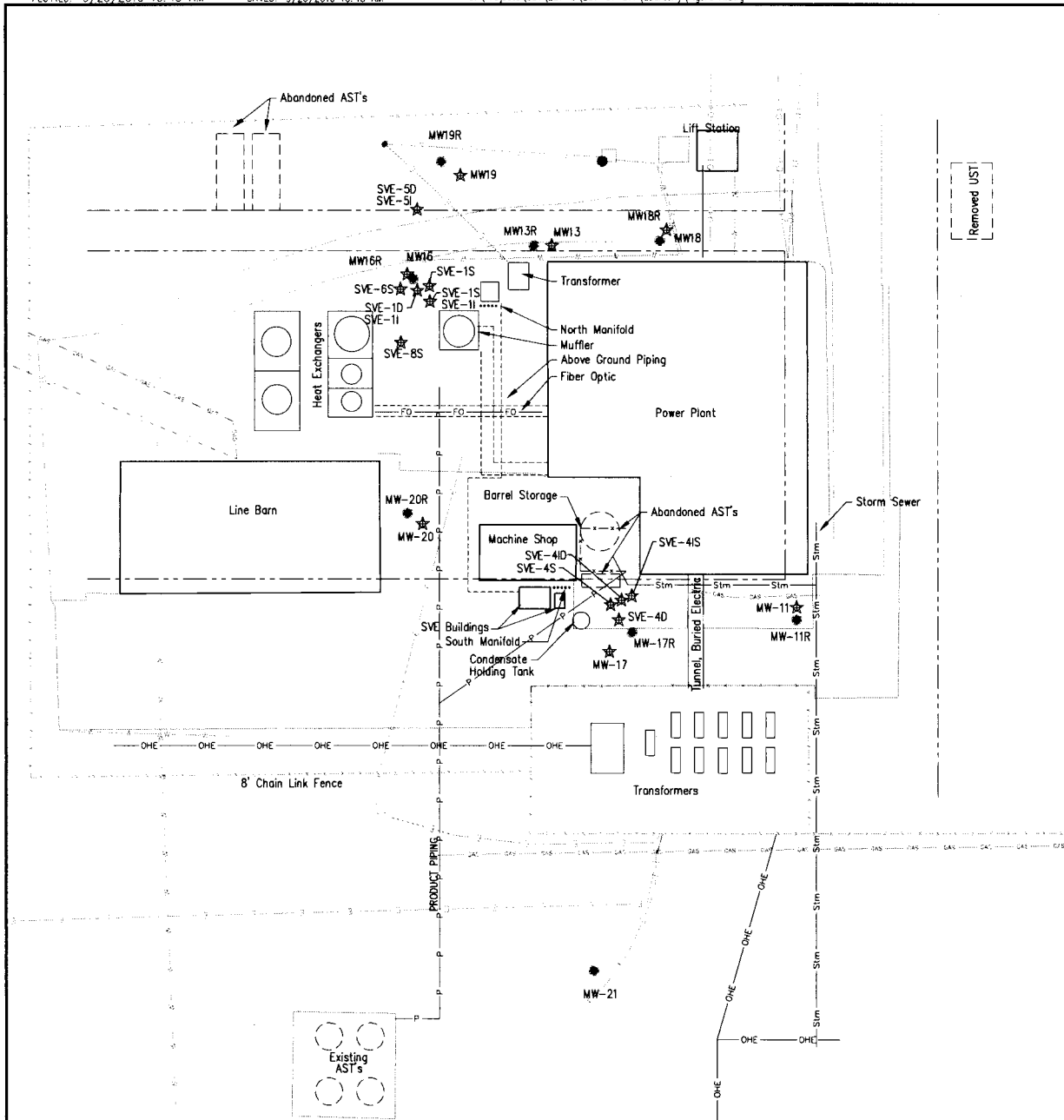

Point Designation	Coordinates		Latitude	Longitude	Top of Rim Elevation	Top of Casing Elevation
	North	West				
MW-11R	26.042	1000.73	39.3942772	101.0582967	3164.18	3163.79
MW-12R	-196.765	1191.15	39.3936718	101.0589795	3162.60	3162.30
MW-13R	170.13	1102.90	39.3946760	101.0586522	3165.00	3164.31
MW-16R	157.456	1149.72	39.3946427	101.0588184	3165.15	3164.75
MW-17R	21.12	1064.83	39.3942658	101.0585237	3164.55	3164.16
MW-18R	172.084	105388	39.3946798	101.0584788	3164.87	3164.45
MW-19R	202.526	1138.74	39.3947661	101.0587776	3165.34	3165.05
MW-20R	67.06	1151.91	39.3943947	101.0588298	3164.61	3164.16
MW-21	-109.27	1079.71	39.3939084	101.0585817	3163.04	3162.41

NAD 83

(per surveyor via drifter)

LEGEND

- ⊕ = MONITORING WELL
- ☆ = ABANDONED MONITORING WELL

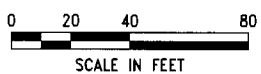

SCALE: AS SHOWN
 PROJECT NO: 251-G1-011
 DATE: 08-24-11
 DRAWN BY: JAR/DB
 CHECKED BY: JAR/DB
 FIELD BOOK: 1048 (1048)
 SHEET: 12

COLBY PUBLIC POWER
SITE PLAN
 120 NORTH STERLING, COLBY, KS A6-097-40187

MILCO
 Environmental Services, Inc.
 1000 N. 10th St. Suite 200
 Colby, KS 67801-1596
 Phone: 785.938.2422
 Fax: 785.938.2423
 Email: info@milco.com

FIGURE A

This document, and the ideas and designs incorporated herein, are an instrument of professional service. It is the property of MILCO and is not to be used in whole or in part, for any other project without the written authorization of © 2005 MILCO.