

WATER WELL PLUGGING RECORD Form WWC-5P

KSA 82a-1212

ID NO.

SVE 5 IS

1 LOCATION OF WATER WELL: County: Thomas	Fraction SW ¼ SW ¼ SE ¼ SE ¼	Section Number 36	Township Number T 7 S	Range Number 34 <input type="checkbox"/> E <input checked="" type="checkbox"/> W
--	---------------------------------	----------------------	--------------------------	---

Street/Rural Address of Well Location; if unknown, distance & direction from nearest town or intersection: If at owner's address, check here Colby Public Power, Kansas

Global Positioning Systems (GPS) information:

Latitude: _____ (in decimal degrees)
 Longitude: _____ (in decimal degrees)
 Elevation: _____
 Horizontal Datum: WGS84, NAD83, NAD27
 Collection Method: _____

2 WATER WELL OWNER: City of Colby
 RR#, St. Address, Box #: 585 N. Franklin
 City, State ZIP Code: Colby, Kansas 67701

GPS unit (Make/Model: _____)
 Digital Map/Photo, Topographic Map, Land Survey
 Est. Accuracy: <3 m, 3-5 m, 5-15 m, >15 m

3 MARK WELL'S LOCATION WITH AN "X" IN SECTION BOX:

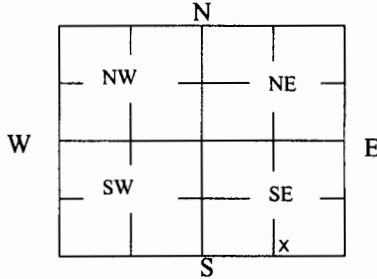

4 DEPTH OF WELL 69.47 **ft.**

WELL'S STATIC WATER LEVEL DRY ft

WELL WAS USED AS:

- | | | |
|-------------------------------------|---|---|
| <input type="checkbox"/> Domestic | <input type="checkbox"/> Public Water Supply | <input type="checkbox"/> Dewatering |
| <input type="checkbox"/> Irrigation | <input type="checkbox"/> Oil Field Water Supply | <input checked="" type="checkbox"/> Monitoring SVE-5-IS |
| <input type="checkbox"/> Feedlot | <input type="checkbox"/> Domestic (Lawn & Garden) | <input type="checkbox"/> Injection Well |
| <input type="checkbox"/> Industrial | <input type="checkbox"/> Air Conditioning | <input type="checkbox"/> Other _____ |

Was a chemical/bacteriological sample submitted to Department? Yes No

5 TYPE OF BLANK CASING USED:

- Steel RMP (SR) Wrought Fiberglass Other (Specify below) _____
 PVC ABS Asbestos-Cement Concrete Tile

Blank casing diameter 2 in. Was casing pulled? Yes No If yes, how much 3'
 Casing height above or below land surface 36 in.

6 GROUT PLUG MATERIAL: Neat cement Cement grout Bentonite Other _____

Grout Plug Intervals: From 3 ft. to 69.47 ft., From _____ ft. to _____ ft., From _____ ft. to _____ ft.

What is the nearest source of possible contamination:

- | | | | |
|---|---|--|--|
| <input type="checkbox"/> Septic tank | <input type="checkbox"/> Seepage pit | <input checked="" type="checkbox"/> Fuel storage | <input type="checkbox"/> Other (specify below) _____ |
| <input type="checkbox"/> Sewer lines | <input type="checkbox"/> Pit privy | <input type="checkbox"/> Fertilizer storage | |
| <input type="checkbox"/> Watertight sewer lines | <input type="checkbox"/> Sewage lagoon | <input type="checkbox"/> Insecticide storage | |
| <input type="checkbox"/> Lateral lines | <input type="checkbox"/> Feedyard | <input type="checkbox"/> Abandoned water well | Direction from well? _____ |
| <input type="checkbox"/> Cess pool | <input type="checkbox"/> Livestock pens | <input type="checkbox"/> Oil well/Gas well | How many feet? _____ |

FROM	TO	PLUGGING MATERIALS	FROM	TO	PLUGGING MATERIALS
0	3	Native soil			Note: Location of well listed incorrectly as SW1/4 SW1/4 SE1/4 on original well record.
3	69.47	Bentonite grout			

7 CONTRACTOR'S OR LANDOWNER'S CERTIFICATION: This water well was plugged under my jurisdiction and was completed on (mo/day/year) 8-22-16 and this record is true to the best of my knowledge and belief. Kansas Water Well Contractor's License No. 735. This Water Well Record was completed on (mo/day/year) 9/27/16 under the business name of MILCO Environmental Services, Inc. by (signature) *[Signature]*

Send one white copy to Kansas Department of Health & Environment, Geology Section, 1000 SW Jackson Street, Ste. 420, Topeka, KS 66612-1367. Send one copy to WATER WELL OWNER and retain one for your records.
 Visit us at <http://www.kdheks.gov/waterwell/index.html> Telephone 785-296-5524.

KSA82a-1212

Revised 1/20/2015

Note: Location of well listed incorrectly on original WWC5

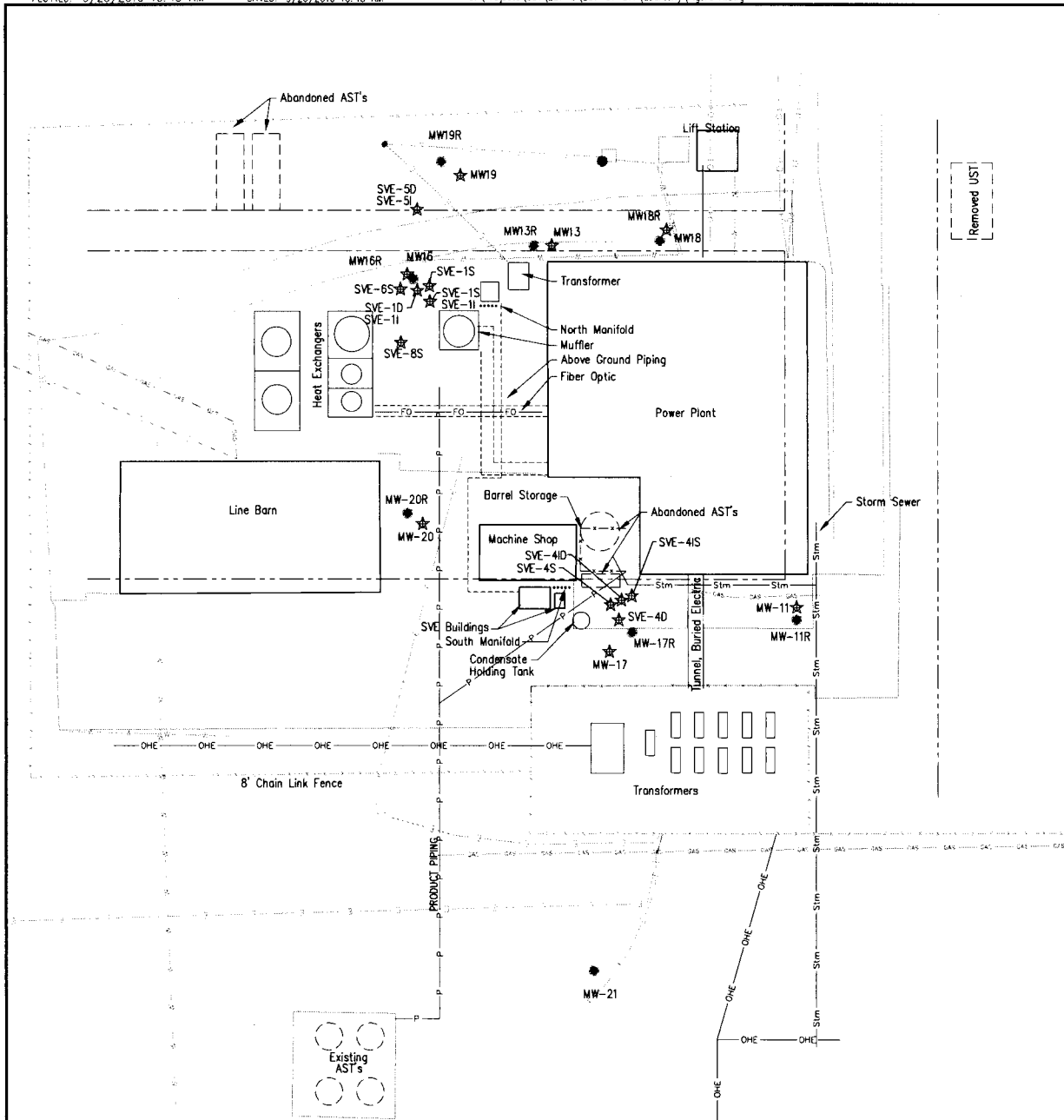

Point Designation	Coordinates		Latitude	Longitude	Top of Rim Elevation	Top of Casing Elevation
	North	West				
MW-11R	26.042	1000.73	39.3942772	101.0582967	3164.18	3163.79
MW-12R	-196.765	1191.15	39.3936718	101.0589795	3162.60	3162.30
MW-13R	170.13	1102.90	39.3946760	101.0586522	3165.00	3164.31
MW-16R	157.456	1149.72	39.3946427	101.0588184	3165.15	3164.75
MW-17R	21.12	1064.83	39.3942658	101.0585237	3164.55	3164.16
MW-18R	172.084	105388	39.3946798	101.0584788	3164.87	3164.45
MW-19R	202.526	1138.74	39.3947661	101.0587776	3165.34	3165.05
MW-20R	67.06	1151.91	39.3943947	101.0588298	3164.61	3164.16
MW-21	-109.27	1079.71	39.3939084	101.0585817	3163.04	3162.41

MW-12R
★ MW-12

NAD 83

(per surveyor via driller)

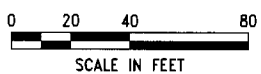

LEGEND

- ⊕ = MONITORING WELL
- ★ = ABANDONED MONITORING WELL

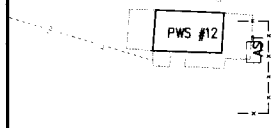

COLBY PUBLIC POWER
SITE PLAN
120 NORTH STERLING, COLBY, KS A6-097-40187

SCALE: AS SHOWN
PROJECT NO. 16-01-11
DATE: 08-24-16
FIELD BOOK: 16A-097-40187
DRAWN BY: JAR/DB
SHEET: 1

MILCO
Environmental Services, Inc.
1200 N. 10th St. Suite 200
Colby, KS 67705-1586
Phone: 785.963.1586
Fax: 785.963.1587

REVISIONS

NO.	DATE	DESCRIPTION
1		

This document, and the ideas and designs incorporated herein, are an instrument of professional service. In the property of MILCO and is not to be used in whole or in part, for any other project without the written authorization of © 2005 MILCO.