

WATER WELL PLUGGING RECORD Form WWC-5P

KSA 82a-1212 ID NO.

MW 17

1 LOCATION OF WATER WELL: County: Thomas	Fraction SW ¼ SW ¼ SE ¼ SE ¼	Section Number 36	Township Number T 7 S	Range Number 34 <input type="checkbox"/> E <input checked="" type="checkbox"/> W
Street/Rural Address of Well Location; if unknown, distance & direction from nearest town or intersection: If at owner's address, check here <input type="checkbox"/> Colby Public Power, Colby		Global Positioning Systems (GPS) information: Latitude: _____ (in decimal degrees) Longitude: _____ (in decimal degrees) Elevation: _____ Horizontal Datum: <input type="checkbox"/> WGS84, <input type="checkbox"/> NAD83, <input type="checkbox"/> NAD27 Collection Method: _____ <input type="checkbox"/> GPS unit (Make/Model: _____) <input type="checkbox"/> Digital Map/Photo, <input type="checkbox"/> Topographic Map, <input type="checkbox"/> Land Survey Est. Accuracy: <input type="checkbox"/> < 3 m, <input type="checkbox"/> 3-5 m, <input type="checkbox"/> 5-15 m, <input type="checkbox"/> > 15 m		

2 WATER WELL OWNER: City of Colby RR#, St. Address, Box #: 585 N. Franklin City, State ZIP Code: Colby, Kansas 67701	
---	--

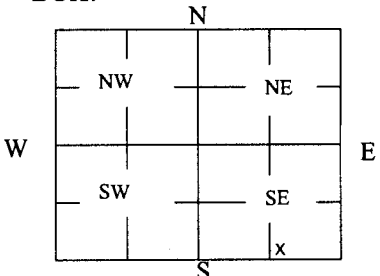
3 MARK WELL'S LOCATION WITH AN "X" IN SECTION BOX: 	4 DEPTH OF WELL <u>139.80</u> ft. WELL'S STATIC WATER LEVEL <u>139.75</u> ft WELL WAS USED AS: <input type="checkbox"/> Domestic <input type="checkbox"/> Public Water Supply <input type="checkbox"/> Dewatering <input type="checkbox"/> Irrigation <input type="checkbox"/> Oil Field Water Supply <input checked="" type="checkbox"/> Monitoring MW-17 <input type="checkbox"/> Feedlot <input type="checkbox"/> Domestic (Lawn & Garden) <input type="checkbox"/> Injection Well <input type="checkbox"/> Industrial <input type="checkbox"/> Air Conditioning <input type="checkbox"/> Other _____ Was a chemical/bacteriological sample submitted to Department? Yes <input type="checkbox"/> No <input type="checkbox"/>
---	--

5 TYPE OF BLANK CASING USED:

Steel RMP (SR) Wrought Fiberglass Other (Specify below) _____
 PVC ABS Asbestos-Cement Concrete Tile _____

Blank casing diameter 4 in. Was casing pulled? Yes No If yes, how much 3'
 Casing height above or below land surface 36 in.

6 GROUT PLUG MATERIAL: Neat cement Cement grout Bentonite Other _____

Grout Plug Intervals: From 3 ft. to 139.7 ft., From _____ ft. to _____ ft., From _____ ft. to _____ ft.

What is the nearest source of possible contamination:
 Septic tank Seepage pit Fuel storage Other (specify below) _____
 Sewer lines Pit privy Fertilizer storage _____
 Watertight sewer lines Sewage lagoon Insecticide storage _____
 Lateral lines Feedyard Abandoned water well Direction from well? _____
 Cess pool Livestock pens Oil well/Gas well How many feet? _____

FROM	TO	PLUGGING MATERIALS	FROM	TO	PLUGGING MATERIALS
0	0.5	Concrete			Note: Location of well listed incorrectly as SW1/4 SW1/4 SE1/4 on original well record.
0.5	3	Native soil			
3	139.80	Bentonite grout			

7 CONTRACTOR'S OR LANDOWNER'S CERTIFICATION: This water well was plugged under my jurisdiction and was completed on (mo/day/year) 8-22-16 and this record is true to the best of my knowledge and belief. Kansas Water Well Contractor's License No. 735. This Water Well Record was completed on (mo/day/year) 9/27/16 under the business name of MILCO Environmental Services, Inc. by (signature) *Kathy Stehling*

Send one white copy to Kansas Department of Health & Environment, Geology Section, 1000 SW Jackson Street, Ste. 420, Topeka, KS 66612-1367. Send one copy to WATER WELL OWNER and retain one for your records.
 Visit us at <http://www.kdheks.gov/waterwell/index.html> Telephone 785-296-5524.

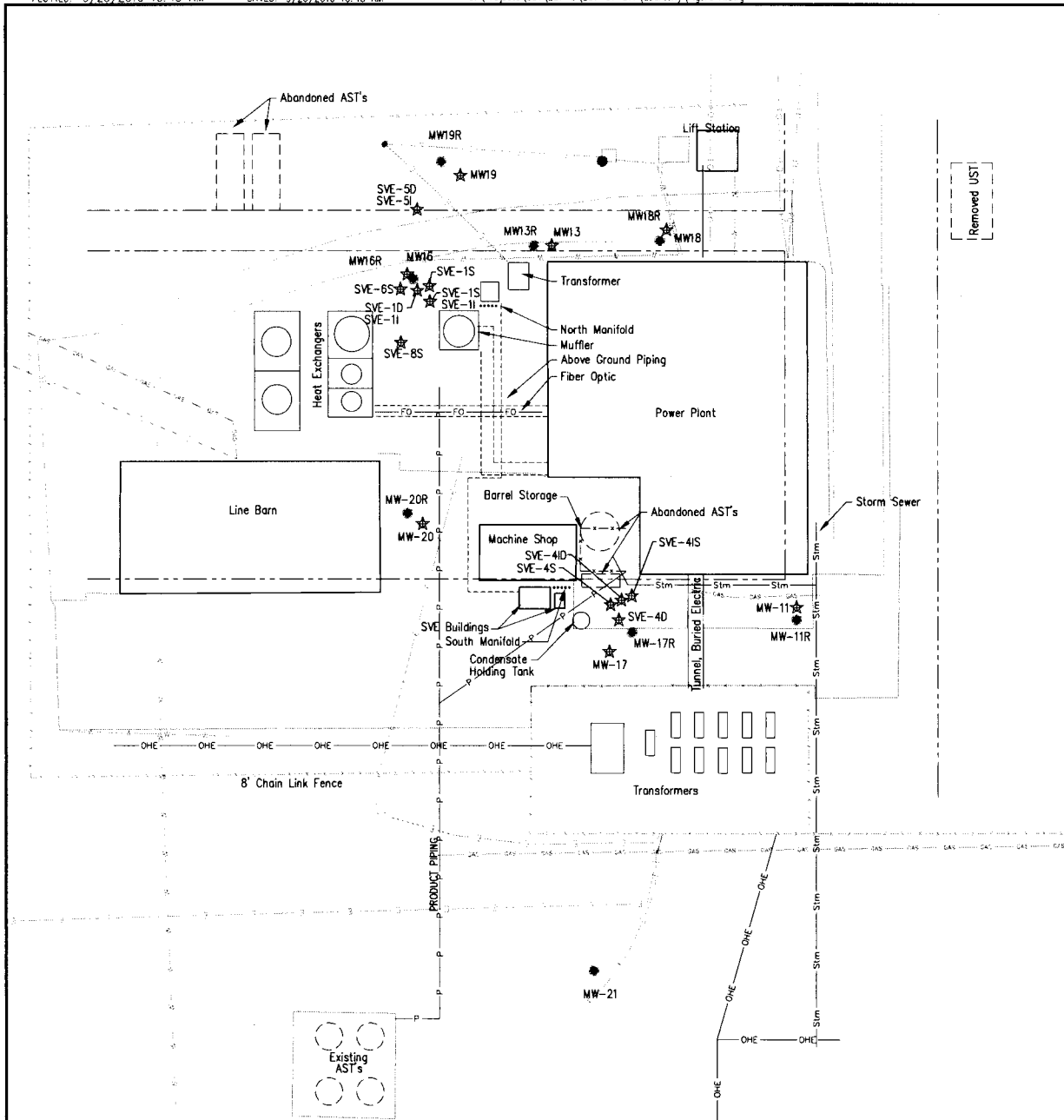

Point Designation	Coordinates		Latitude	Longitude	Top of Rim Elevation	Top of Casing Elevation
	North	West				
MW-11R	26.042	1000.73	39.3942772	101.0582967	3164.18	3163.79
MW-12R	-196.765	1191.15	39.3936718	101.0589795	3162.60	3162.30
MW-13R	170.13	1102.90	39.3946760	101.0586522	3165.00	3164.31
MW-16R	157.456	1149.72	39.3946427	101.0588184	3165.15	3164.75
MW-17R	21.12	1064.83	39.3942658	101.0585237	3164.55	3164.16
MW-18R	172.084	105388	39.3946798	101.0584788	3164.87	3164.45
MW-19R	202.526	1138.74	39.3947661	101.0587776	3165.34	3165.05
MW-20R	67.06	1151.91	39.3943947	101.0588298	3164.61	3164.16
MW-21	-109.27	1079.71	39.3939084	101.0585817	3163.04	3162.41

NAD 83

(per surveyor via driller)

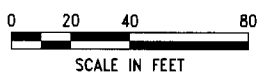

LEGEND	
⊕	= MONITORING WELL
☆	= ABANDONED MONITORING WELL

FIGURE A

DATE: 08-24-11

SCALE: AS SHOWN

PROJECT NO: 08-01-11

DRAWN BY: JAR/DS

CHECKED BY: JAR/DS

COLBY PUBLIC POWER

SITE PLAN

120 NORTH STERLING, COLBY, KS A6-097-40187

MILCO

Environmental Services, Inc.

1200 N. 10th St. Suite 200

Colby, KS 67801-1506

Phone: 785.838.4422

Fax: 785.838.4422

www.milcoenv.com