

**WATER WELL PLUGGING RECORD Form WWC-5P**

KSA 82a-1212

ID NO.

SVE-15

<b>1 LOCATION OF WATER WELL:</b> County: Thomas	Fraction SW ¼ SW ¼ SE ¼ SE ¼	Section Number 36	Township Number T 7 S	Range Number 34 <input type="checkbox"/> E <input checked="" type="checkbox"/> W
----------------------------------------------------	---------------------------------	----------------------	--------------------------	-------------------------------------------------------------------------------------

Street/Rural Address of Well Location; if unknown, distance & direction from nearest town or intersection: If at owner's address, check here  Colby Public Power, Colby

**Global Positioning Systems (GPS) information:**

Latitude: \_\_\_\_\_ (in decimal degrees)  
 Longitude: \_\_\_\_\_ (in decimal degrees)  
 Elevation: \_\_\_\_\_  
 Horizontal Datum:  WGS84,  NAD83,  NAD27  
 Collection Method: \_\_\_\_\_

**2 WATER WELL OWNER:** City of Colby  
 RR#, St. Address, Box #: 585 N. Franklin  
 City, State ZIP Code: Colby, Kansas 67701

GPS unit (Make/Model: \_\_\_\_\_)  
 Digital Map/Photo,  Topographic Map,  Land Survey  
 Est. Accuracy:  < 3 m,  3-5 m,  5-15 m,  > 15 m

**3 MARK WELL'S LOCATION WITH AN "X" IN SECTION BOX:**

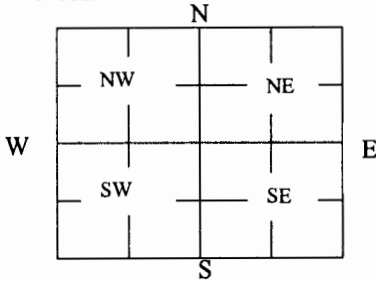

**4 DEPTH OF WELL** 32.00 **ft.**

WELL'S STATIC WATER LEVEL Dry ft

WELL WAS USED AS:

- |                                     |                                                   |                                                       |
|-------------------------------------|---------------------------------------------------|-------------------------------------------------------|
| <input type="checkbox"/> Domestic   | <input type="checkbox"/> Public Water Supply      | <input type="checkbox"/> Dewatering                   |
| <input type="checkbox"/> Irrigation | <input type="checkbox"/> Oil Field Water Supply   | <input checked="" type="checkbox"/> Monitoring SVE-1S |
| <input type="checkbox"/> Feedlot    | <input type="checkbox"/> Domestic (Lawn & Garden) | <input type="checkbox"/> Injection Well               |
| <input type="checkbox"/> Industrial | <input type="checkbox"/> Air Conditioning         | <input type="checkbox"/> Other _____                  |

Was a chemical/bacteriological sample submitted to Department? Yes  No

**5 TYPE OF BLANK CASING USED:**

- Steel  PVC  RMP (SR)  ABS  Wrought  Asbestos-Cement  Fiberglass  Concrete Tile  Other (Specify below) \_\_\_\_\_

Blank casing diameter 4 in. Was casing pulled? Yes  No  If yes, how much 3'  
 Casing height above or below land surface 36 in.

**6 GROUT PLUG MATERIAL:**  Neat cement  Cement grout  Bentonite  Other \_\_\_\_\_

Grout Plug Intervals: From 3 ft. to 32.00 ft., From \_\_\_\_\_ ft. to \_\_\_\_\_ ft., From \_\_\_\_\_ ft. to \_\_\_\_\_ ft.

What is the nearest source of possible contamination:

- |                                                 |                                         |                                                  |                                                      |
|-------------------------------------------------|-----------------------------------------|--------------------------------------------------|------------------------------------------------------|
| <input type="checkbox"/> Septic tank            | <input type="checkbox"/> Seepage pit    | <input checked="" type="checkbox"/> Fuel storage | <input type="checkbox"/> Other (specify below) _____ |
| <input type="checkbox"/> Sewer lines            | <input type="checkbox"/> Pit privy      | <input type="checkbox"/> Fertilizer storage      |                                                      |
| <input type="checkbox"/> Watertight sewer lines | <input type="checkbox"/> Sewage lagoon  | <input type="checkbox"/> Insecticide storage     |                                                      |
| <input type="checkbox"/> Lateral lines          | <input type="checkbox"/> Feedyard       | <input type="checkbox"/> Abandoned water well    | Direction from well? _____                           |
| <input type="checkbox"/> Cess pool              | <input type="checkbox"/> Livestock pens | <input type="checkbox"/> Oil well/Gas well       | How many feet? _____                                 |

FROM	TO	PLUGGING MATERIALS	FROM	TO	PLUGGING MATERIALS
0	3	Native soil			Note: Location of well listed incorrectly as
3	32.00	Bentonite grout			SW1/4 SW1/4 SE1/4 on original well record.

**7 CONTRACTOR'S OR LANDOWNER'S CERTIFICATION:** This water well was plugged under my jurisdiction and was completed on (mo/day/year) 8-22-16 and this record is true to the best of my knowledge and belief. Kansas Water Well Contractor's License No. 735. This Water Well Record was completed on (mo/day/year) 9/27/16 under the business name of MILCO Environmental Services, Inc. by (signature) *Kathy Johnson*

Send one white copy to Kansas Department of Health & Environment, Geology Section, 1000 SW Jackson Street, Ste. 420, Topeka, KS 66612-1367. Send one copy to WATER WELL OWNER and retain one for your records.  
 Visit us at <http://www.kdheks.gov/waterwell/index.html> Telephone 785-296-5524.

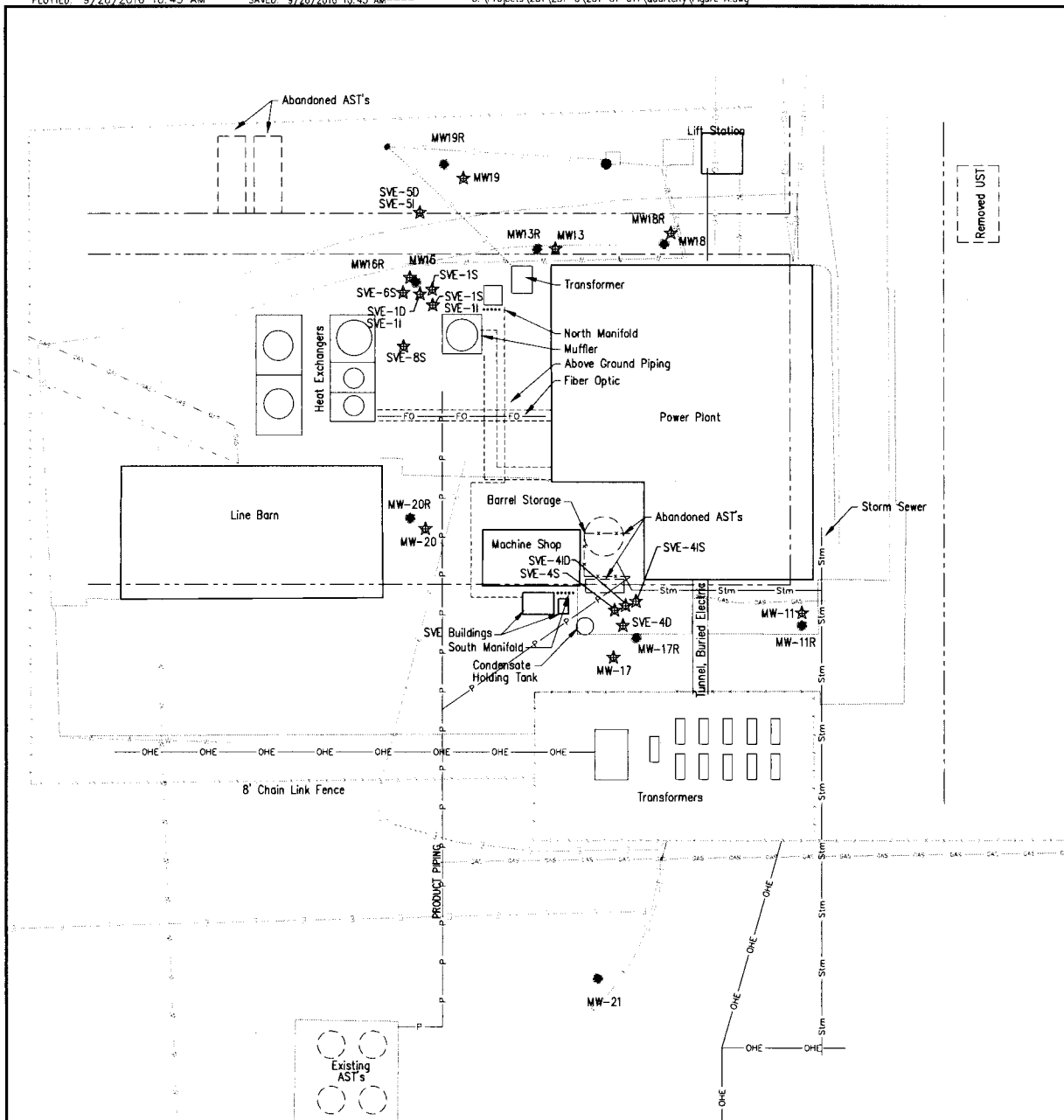

Point Designation	Coordinates		Latitude	Longitude	Top of Rim Elevation	Top of Casing Elevation
	North	West				
MW-11R	26.042	1000.73	39.3942772	101.0582967	3164.18	3163.79
MW-12R	-196.765	1191.15	39.3936718	101.0589795	3162.60	3162.30
MW-13R	170.13	1102.90	39.3946760	101.0586522	3165.00	3164.31
MW-16R	157.456	1149.72	39.3946427	101.0588184	3165.15	3164.75
MW-17R	21.12	1064.83	39.3942658	101.0585237	3164.55	3164.16
MW-18R	172.084	105388	39.3946798	101.0584788	3164.87	3164.45
MW-19R	202.526	1138.74	39.3947661	101.0587776	3165.34	3165.05
MW-20R	67.06	1151.91	39.3943947	101.0588298	3164.61	3164.16
MW-21	-109.27	1079.71	39.3939084	101.0585817	3163.04	3162.41

NAD 83

(per surveyor via driller)

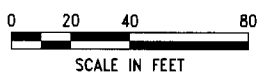

LEGEND	
⊕	= MONITORING WELL
☆	= ABANDONED MONITORING WELL

**FIGURE A**

DATE: 08-24-11

SCALE: AS SHOWN

PROJECT NO: 08-01-11

DRAWN BY: JAR/DS

CHECKED BY: JAR/DS

**COLBY PUBLIC POWER**

**SITE PLAN**

120 NORTH STERLING, COLBY, KS A6-097-40187

**MILCO**

Environmental Services, Inc.

1200 N. 10th St., Suite 200

Colby, KS 66705-1586

Phone: 785.868.1586

Fax: 785.868.1586