

WATER WELL RECORD

Form WWC-5

Division of Water Resources App. No.

1 LOCATION OF WATER WELL: Fraction NE 1/4 SE 1/4 NE 1/4 1/4 Section Number 19 Township No. T 7 S Range Number R 5 E W

County: Cloud
Street/Rural Address of Well Location; if unknown, distance & direction from nearest town or intersection; If at owner's address, check here
From Glasco 60 1/2 mi. N 5073 Rd.

Global Positioning System (GPS) information:
Latitude: (in decimal degrees)
Longitude: (in decimal degrees)
Elevation:
Datum: WGS 84, NAD 83, NAD 27
Collection Method:
 GPS unit (Make/Model:)
 Digital Map/Photo, Topographic Map, Land Survey
Est. Accuracy: <3 m, 3-5 m, 5-15 m, >15 m

2 WATER WELL OWNER: Richard Trasky
RR#, Street Address, Box #: 987 N 5573 Rd.
City, State, ZIP Code: Glasco, KS 67445

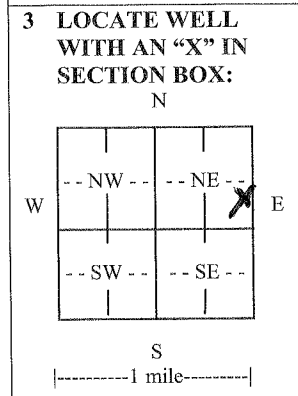

4 DEPTH OF COMPLETED WELL 240' ft.
Depth(s) Groundwater Encountered (1).....136' ft. (2)..... ft. (3)..... ft.
WELL'S STATIC WATER LEVEL.....132' ft. below land surface measured on mo/day/yr.....
Pump test data: Well water was..... ft. after..... hours pumping..... gpm
EST. YIELD.. 6 gpm Well water was..... ft. after..... hours pumping..... gpm
Bore Hole Diameter 9 in. to 240' ft., and in. to ft.
WELL WATER TO BE USED AS: Public water supply Geothermal Injection well
 Domestic Feedlot Oil field water supply Dewatering Other (Specify below)
 Irrigation Industrial Domestic-lawn & garden Monitoring well Livestock
Was a chemical/bacteriological sample submitted to Department? Yes No
If yes, mo/day/yr sample was submitted.....
Water well disinfected? Yes No

5 TYPE OF CASING USED: Steel PVC Other
CASING JOINTS: Glued Clamped, Welded Threaded
Casing diameter 5 in. to 180 ft., Diameter in. to ft., Diameter in. to ft.
Casing height above land surface..... 3' in., Weight Sch 40 lbs./ft., Wall thickness or gauge No.
TYPE OF SCREEN OR PERFORATION MATERIAL:
 Steel Stainless Steel PVC Other (Specify)
 Brass Galvanized Steel None used (open hole)
SCREEN OR PERFORATION OPENINGS ARE:
 Continuous slot Mill slot 25/1000 Gauze wrapped Torch cut Drilled holes None (open hole)
 Louvered shutter Key punched Wire wrapped Saw cut Other (specify)
SCREEN-PERFORATED INTERVALS: From..... 180 ft. to 240 ft., From ft. to ft.
From ft. to ft., From ft. to ft.
GRAVEL PACK INTERVALS: From..... 25 ft. to 240 ft., From ft. to ft.
From ft. to ft., From ft. to ft.

6 GROUT MATERIAL: Neat cement Cement grout Bentonite Other
Grout Intervals: From..... 5 ft. to 25 ft., From ft. to ft., From ft. to ft.
What is the nearest source of possible contamination: Non Clost
 Septic tank Lateral lines Pit privy Livestock pens Insecticide storage Other (specify below)
 Sewer lines Cesspool Sewage lagoon Fuel storage Abandoned water well
 Watertight sewer lines Seepage pit Feedyard Fertilizer storage Oil well/gas well
Direction from well Distance from well

FROM	TO	LITHOLOGIC LOG	FROM	TO	LITHO. LOG (cont.) or PLUGGING INTERVALS
0	1	Top Soil	151	162	Sand Stone
1	14	Brown Clay	162	200	Gray Shale
14	20	Tan Shale	200	218	Brown Shale
20	34	Yellow Shale	218	240	Sand Stone
34	46	Limestone			
46	105	Gray oily shale			
105	109	Limestone			
109	136	Gray oily shale			
136	146	Sand Stone			
146	151	Limestone			

7 CONTRACTOR'S OR LANDOWNER'S CERTIFICATION: This water well was constructed, reconstructed, or plugged under my jurisdiction and was completed on (mo/day/year) 6/6/2013 and this record is true to the best of my knowledge and belief.
Kansas Water Well Contractor's License No. US 1 This Water Well Record was completed on (mo/day/year) 6/7/2013
under the business name of Waldman Well Drilling by (signature) Waldman

INSTRUCTIONS: Use typewriter or ball point pen. PLEASE PRESS FIRMLY and PRINT clearly. Please fill in blanks and check the correct answers. Send three copies (white, blue, pink) to Kansas Department of Health and Environment, Bureau of Water, Geology Section, 1000 SW Jackson St., Suite 420, Topeka, Kansas 66612-1367. Telephone 785-296-5524. Send one copy to WATER WELL OWNER and retain one for your records. Include fee of \$5.00 for each constructed well. Visit us at <http://www.kdheks.gov/waterwell/index.html>.