

**WATER WELL RECORD**

**Form WWC-5**

Division of Water Resources App. No.  

**1 LOCATION OF WATER WELL:** Fraction NW 1/4 NW 1/4 SW 1/4 1/4 Section Number 7 Township No. T 12 N Range Number R 4 E  W  W

County: Dickinson Co.  
 Street/Rural Address of Well Location; if unknown, distance & direction from nearest town or intersection: If at owner's address, check here  From Chapman Co North 3 miles to 18 May on Upland Rd. Then Co W 1/2 1 mile to Quail Rd.

**2 WATER WELL OWNER:** Steve Hodges  
 RR#, Street Address, Box #: Maple Leaf Court  
 City, State, ZIP Code: Baldwin City, MO 66006

**Global Positioning System (GPS) information:**  
 Latitude: ..... (in decimal degrees)  
 Longitude: ..... (in decimal degrees)  
 Elevation: .....  
 Datum:  WGS 84,  NAD 83,  NAD 27  
 Collection Method:  
 GPS unit (Make/Model: .....)  
 Digital Map/Photo,  Topographic Map,  Land Survey  
 Est. Accuracy:  <3 m,  3-5 m,  5-15 m,  >15 m

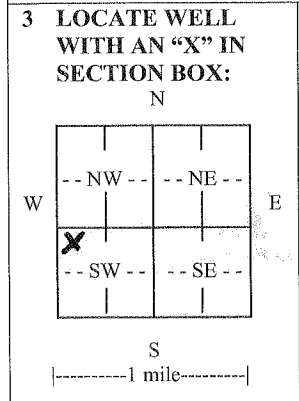

**4 DEPTH OF COMPLETED WELL** ..... 130' ft.

Depth(s) Groundwater Encountered (1). 104' ft. (2)..... ft. (3)..... ft.

WELL'S STATIC WATER LEVEL.. 80' ft. below land surface measured on mo/day/yr.....

Pump test data: Well water was ..... ft. after ..... hours pumping..... gpm

EST. YIELD. 1.5 gpm. Well water was ..... ft. after ..... hours pumping..... gpm

Bore Hole Diameter ..... 9" in. to 150' ft., and ..... in. to ..... ft.

WELL WATER TO BE USED AS:  Public water supply  Geothermal  Injection well  
 Domestic  Feedlot  Oil field water supply  Dewatering  Other (Specify below)  
 Irrigation  Industrial  Domestic-lawn & garden  Monitoring well

Was a chemical/bacteriological sample submitted to Department?  Yes  No

If yes, mo/day/yr sample was submitted.....

Water well disinfected?  Yes  No

**5 TYPE OF CASING USED:**  Steel  PVC  Other .....

CASING JOINTS:  Glued  Clamped  Welded  Threaded

Casing diameter ..... 5" in. to 110' ft., Diameter ..... in. to ..... ft., Diameter ..... in. to ..... ft.

Casing height above land surface..... 21' in., Weight sch 40 lbs./ft., Wall thickness or gauge No. ....

TYPE OF SCREEN OR PERFORATION MATERIAL:  
 Steel  Stainless Steel  PVC  Other (Specify) .....  
 Brass  Galvanized Steel  None used (open hole)

SCREEN OR PERFORATION OPENINGS ARE:  
 Continuous slot  Mill slot 25/5000  Gauze wrapped  Torch cut  Drilled holes  None (open hole)  
 Louvered shutter  Key punched  Wire wrapped  Saw cut  Other (specify) .....

SCREEN-PERFORATED INTERVALS: From..... 110 ft. to 130 ft., From ..... ft. to ..... ft.  
 From..... ft. to ..... ft., From ..... ft. to ..... ft.

GRAVEL PACK INTERVALS: From..... 27 ft. to 130 ft., From ..... ft. to ..... ft.  
 From..... ft. to ..... ft., From ..... ft. to ..... ft.

**6 GROUT MATERIAL:**  Neat cement  Cement grout  Bentonite  Other .....

Grout Intervals: From..... 5 ft. to 27 ft., From ..... ft. to ..... ft., From ..... ft. to ..... ft.

What is the nearest source of possible contamination:  
 Septic tank  Lateral lines  Pit privy None Close  Livestock pens  Insecticide storage  Other (specify below)  
 Sewer lines  Cesspool  Sewage lagoon  Fuel storage  Abandoned water well  
 Watertight sewer lines  Seepage pit  Feedyard  Fertilizer storage  Oil well/gas well .....

Direction from well ..... Distance from well .....

FROM	TO	LITHOLOGIC LOG	FROM	TO	LITHO. LOG (cont.) or PLUGGING INTERVALS
0	-1	Top Soil	130	150	Guy Oil Shell - (Filled in 20' before we could case well)
1	14	Brown Clay			
14	17	Limestone			
17	27	Brown Shell			
27	58	Limestone			
58	72	Brown Shell			
72	75	Limestone			
75	104	Brown Shell			
104	118	Limestone			
118	130	Brown Shell			

**CONTRACTOR'S OR LANDOWNER'S CERTIFICATION:** This water well was  constructed,  reconstructed, or  plugged under my jurisdiction and was completed on (mo/day/year) 6/19/2012 and this record is true to the best of my knowledge and belief.

Kansas Water Well Contractor's License No. 451 This Water Well Record was completed on (mo/day/year) 6/23/2013 under the business name of Waldman Well Drilling by (signature) Wayne Waldman

**INSTRUCTIONS:** Use typewriter or ballpoint pen. PLEASE PRESS FIRMLY and PRINT clearly. Please fill in blanks and check the correct answers. Send three copies (white, blue, pink) to Kansas Department of Health and Environment, Bureau of Water, Geology Section, 1000 SW Jackson St., Suite 420, Topeka, Kansas 66612-1367. Telephone 785-296-5524. Send one copy to WATER WELL OWNER and retain one for your records. Include fee of \$5.00 for each constructed well. Visit us at <http://www.kdheks.gov/waterwell/index.html>.