

WATER WELL RECORD Form WWC-5

Division of Water Resources App. No.

MW-9

Original Record Correction Change in Well Use

Well ID

1 LOCATION OF WATER WELL: County: Mitchell Fraction NE 1/4 NW 1/4 NE 1/4 NW 1/4 Section Number 9 Township Number T 7 S Range Number R 7 E W

2 WELL OWNER: Last Name: Business: KDHE Address: 1000 SW Jackson St., Ste. 410 City: Topeka State: KS ZIP: 66612 Street or Rural Address where well is located: 109 E. 7th St., approx. 5' S, 5' W of SE corner of garage - Beloit, KS

3 LOCATE WELL WITH 'X' IN SECTION BOX: N W E S 1 mile 4 DEPTH OF COMPLETED WELL: 23.5 ft. 5 Latitude: 39.46550 Longitude: 98.10974 6 Elevation: 1442.64 ft. TOC

7 WELL WATER TO BE USED AS: 1. Domestic: 2. Irrigation 3. Feedlot 4. Industrial 5. Public Water Supply 6. Dewatering 7. Aquifer Recharge 8. Monitoring 9. Environmental Remediation 10. Oil Field Water Supply 11. Test Hole 12. Geothermal 13. Other

Was a chemical/bacteriological sample submitted to KDHE? No If yes, date sample was submitted: Water well disinfected? No

8 TYPE OF CASING USED: PVC CASING JOINTS: Threaded Casing diameter: 2 in. to 13.5 ft. Diameter: 0 in. to lbs./ft. Wall thickness or gauge No. 40 TYPE OF SCREEN OR PERFORATION MATERIAL: PVC SCREEN OR PERFORATION OPENINGS ARE: Mill Slot SCREEN-PERFORATED INTERVALS: 13.5 ft. to 23.5 ft. GRAVEL PACK INTERVALS: 11.5 ft. to 23.5 ft.

9 GROUT MATERIAL: Bentonite Grout Intervals: 1 ft. to 11.5 ft. Nearest source of possible contamination: West Direction from well? Distance from well? 100 ft.

Table with columns: 10 FROM TO LITHOLOGIC LOG FROM TO LITHO. LOG (cont.) or PLUGGING INTERVALS. Rows include Topsoil, Lean Clay, Pily Grd Sand, Silty Clay, and Shale.

11 CONTRACTOR'S OR LANDOWNER'S CERTIFICATION: This water well was constructed, reconstructed, or plugged under my jurisdiction and was completed on (mo-day-year) 06/22/2018 and this record is true to the best of my knowledge and belief. Kansas Water Well Contractor's License No. 531 This Water Well Record was completed on (mo-day-year) 07/25/2018 under the business name of GSI Engineering, LLC

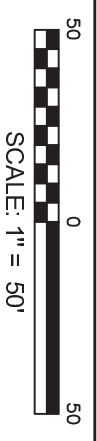
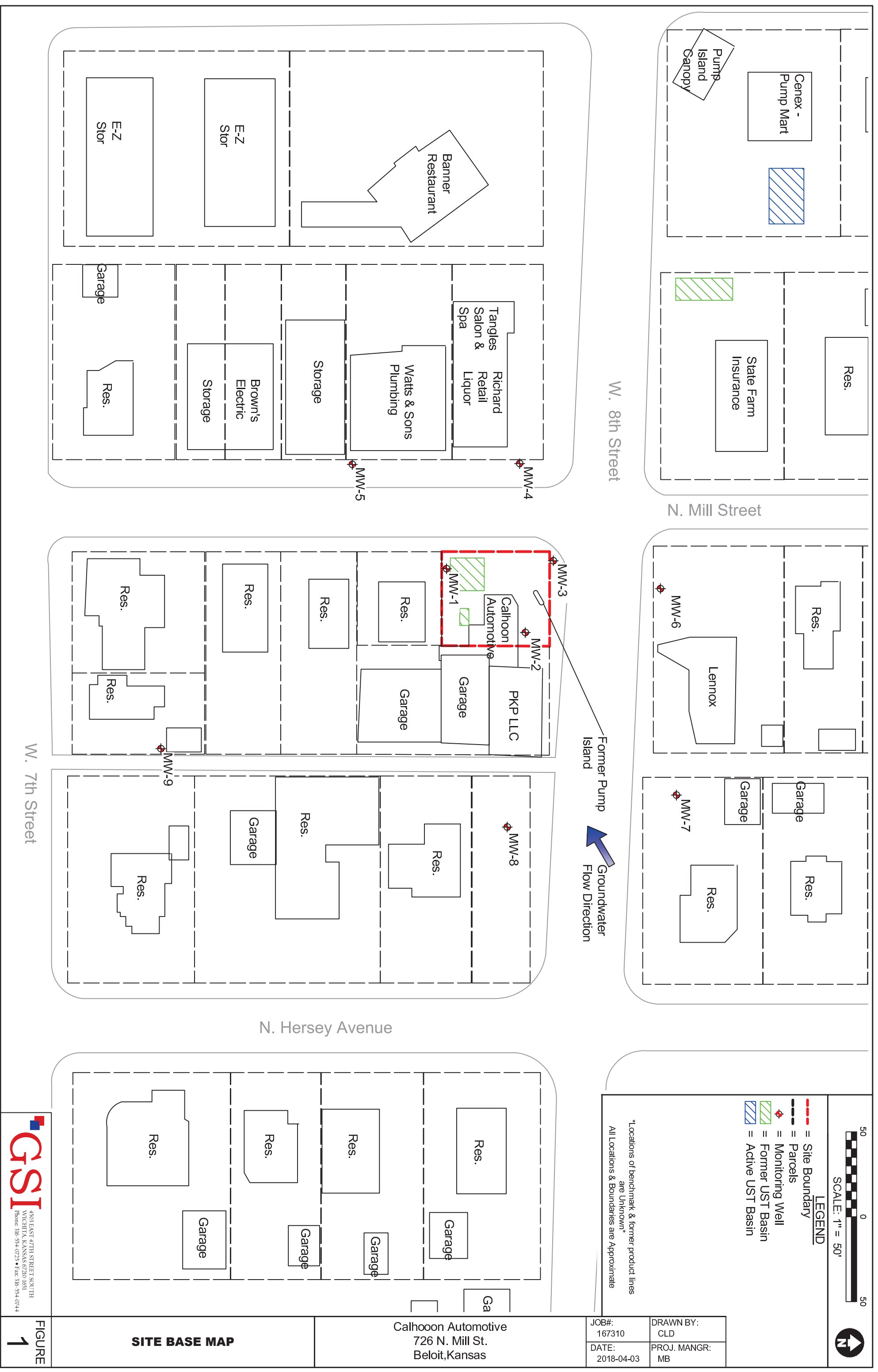

**LEGEND**

- = Site Boundary
- = Parcels
- ◆ = Monitoring Well
- = Former UST Basin
- = Active UST Basin

\*Locations of benchmark & former product lines are Unknown\*  
 All Locations & Boundaries are Approximate

JOB#: 167310	DRAWN BY: CLD
DATE: 2018-04-03	PROJ. MANGR: MB

Calhoon Automotive  
 726 N. Mill St.  
 Beloit, Kansas

**SITE BASE MAP**