

WATER WELL RECORD Form WWC-5

Original Record Correction Change in Well Use

Division of Water Resources App. No.

Well ID

1 LOCATION OF WATER WELL: County: Fraction Section Number Township Number Range Number

2 WELL OWNER: Last Name: First: Street or Rural Address where well is located

3 LOCATE WELL WITH 'X' IN SECTION BOX: 4 DEPTH OF COMPLETED WELL: 5 Latitude: Longitude: Datum: Source for Latitude/Longitude: 6 Elevation:

7 WELL WATER TO BE USED AS: 1. Domestic: 2. Irrigation: 3. Feedlot: 4. Industrial: 5. Public Water Supply: well ID: 6. Dewatering: how many wells?: 7. Aquifer Recharge: well ID: 8. Monitoring: well ID: 9. Environmental Remediation: well ID: 10. Oil Field Water Supply: lease: 11. Test Hole: well ID: 12. Geothermal: how many bores?: 13. Other (specify):

Was a chemical/bacteriological sample submitted to KDHE? Water well disinfected?

8 TYPE OF CASING USED: CASING JOINTS: Casing diameter: Casing height above land surface: TYPE OF SCREEN OR PERFORATION MATERIAL: SCREEN OR PERFORATION OPENINGS ARE: SCREEN-PERFORATED INTERVALS: GRAVEL PACK INTERVALS:

9 GROUT MATERIAL: Grout Intervals: Nearest source of possible contamination: Direction from well? Distance from well?

Table with columns: FROM, TO, LITHOLOGIC LOG, FROM, TO, LITHO. LOG (cont.) or PLUGGING INTERVALS. Includes a Notes section.

11 CONTRACTOR'S OR LANDOWNER'S CERTIFICATION: This water well was constructed, reconstructed, or plugged under my jurisdiction and was completed on (mo-day-year) and this record is true to the best of my knowledge and belief.

Send one copy to WATER WELL OWNER and retain one for your records. Fee of \$5.00 for each constructed well.

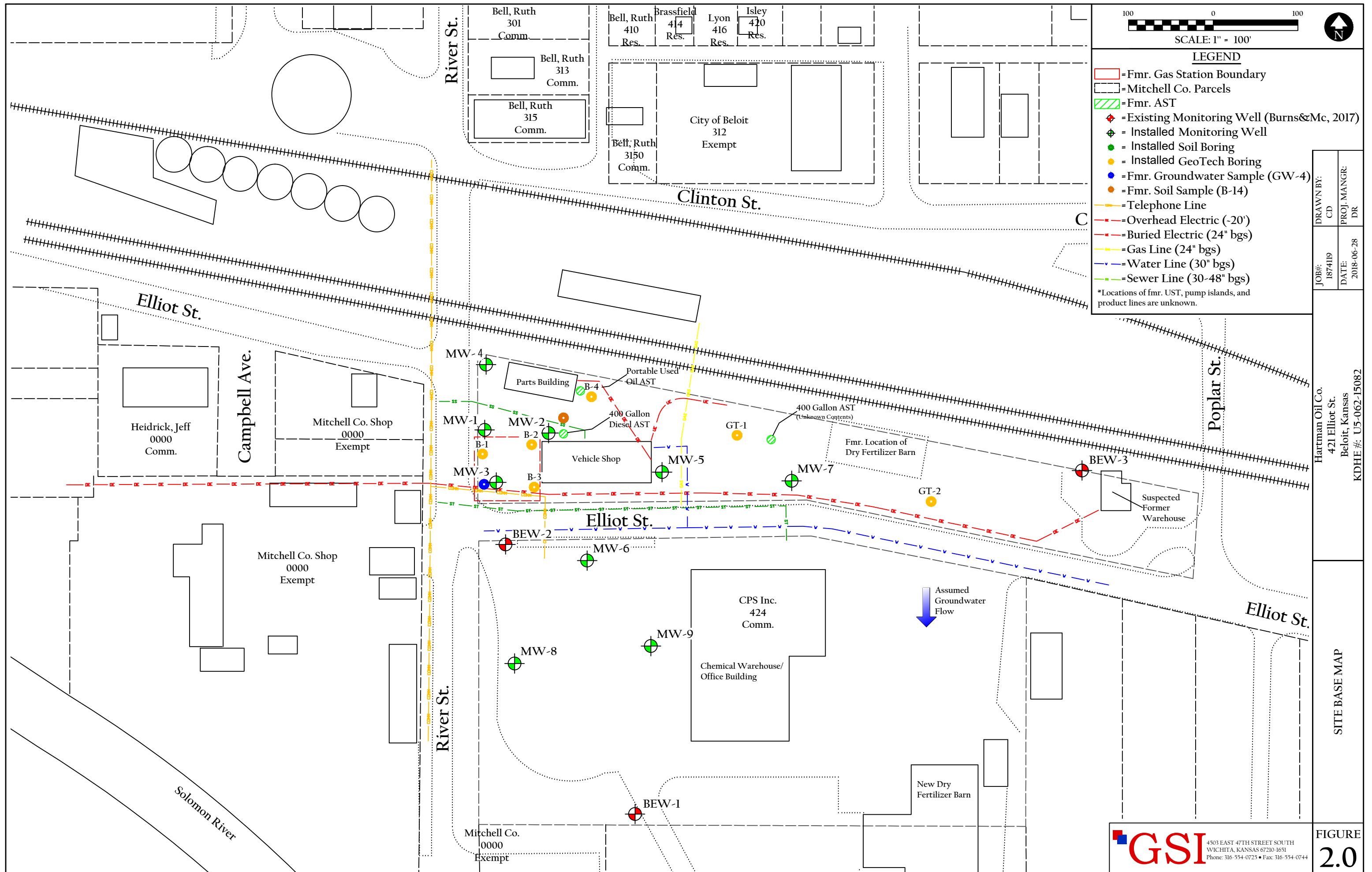

DRAWN BY:	CD
PROJECT MGR:	DR
JOB#:	187419
DATE:	2018-06-28

Hartman Oil Co.  
421 Elliot St.  
Beloit, Kansas  
KDHE #: U5-062-15082

SITE BASE MAP